

**Quick Change Series Power Collet Chucks**

- Quick Change chuck design for first or second operation.
- Ideally suited for use with barfeeders.
- Fixed Length collet – no part movement.
- Quick change cap with safety catch.
- Uses Varibore, spring and master collets.
- Exceptional accuracy in small package.

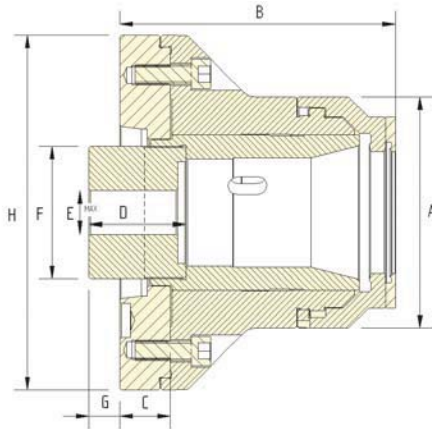

SPECIFICATIONS		QCRL 42(I)	QCRL 42	QCRL 54	QCRL 60
		Inch	Din	Inch	Din
Gripping Range - Round	Max mm	42	42	54	60
	Min mm	1.6	4	1.6	4
Collet Increment	mm	3	2	3	2
Sleeve Stroke	mm	7	7	7	7
Max Input Force	kN	25	25	30	30
Max Gripping Force	kN	55	55	60	60
Max Speed (r.p.m.)	min <sup>-1</sup>	7100	7100	6300	6300
Net Weight	kg	13.5	13.5	29	29
Matching Cylinder		S1246	S1246	S1552/75	S1552/75
Collet Ref	Varibore	D-850	D-673	D-120	D-677
	Spring	D-286	D173E	D-853	D185E

DIMENSIONS	QCRL 42(I)/QCRL 42			QCRL 54				QCRL 60			
	140 x 6	A5	A6	170 x 6	A5	A6	A8	170	A5	A6	A8
A	113			143				143			
B	149	143	143	181	190	175	175	177	186	171	171
C	31.5	25	25	36.5	45	36.5	36.5	36.5	46.5	36.5	36.5
D	60			60				60			
E Max	M58 x 1.5			M75 x 1.5				M75 x 1.5			
F	65			82				82			
G Max	17	23	23	15	25	21	21	14	5	21	21
G Min	10	16	16	5	15	11	11	7	-2	14	14
H	165	165	165	220	220	220	220	220	220	220	220

QCRL54 and 60 models can be supplied with additional 42 mm Inch and Din collet reduction sleeves and caps. See Accessory page for details and part numbers.