

Point

Three-jaw wedge style power chucks slash downtime and maximize productivity through unique change locking mechanism

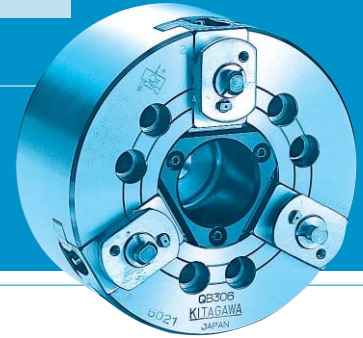

Open Center Chuck

Dimensional Drawings

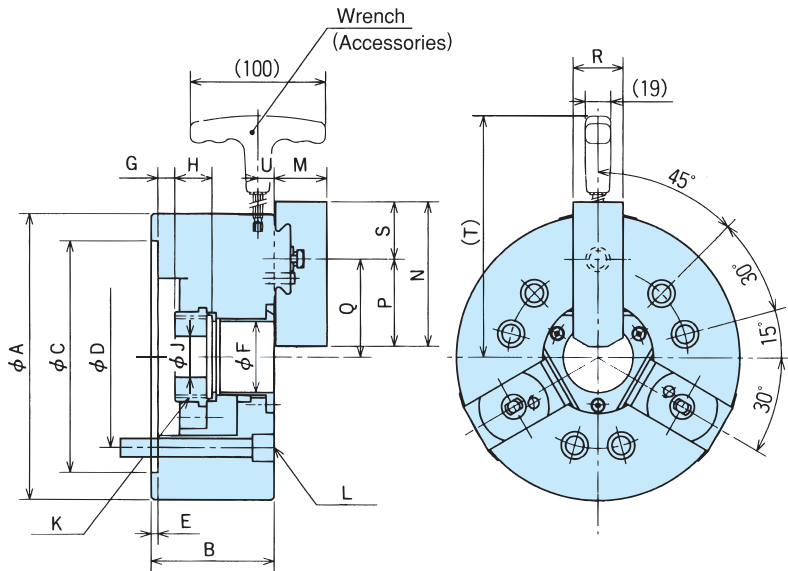
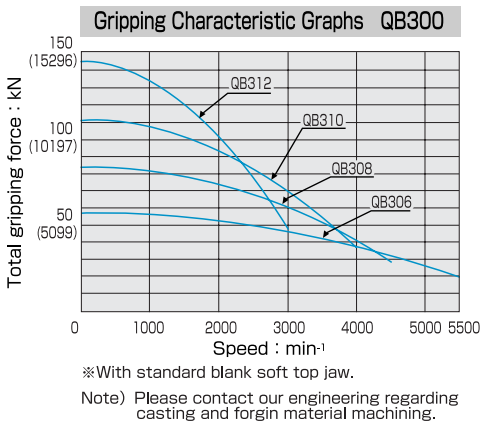

Dimensions

Dimensions Model	A	B	C (H6)	D	E	F	G max.	G min.	H	J	K max.	L	M	N	P	Q max.	Q min.	R	S	T	U
QB306	169	81	140	104.8	5	45	11	-1	19	20	M55x2.0	6-M10	31	90	54	58.5	55.75	32	36	192.5	13
QB308	210	91	170	133.4	5	52	14.5	-1.5	20.5	30	M60x2.0	6-M12	39	106	64	72	68.3	37	42	220.7	13
QB310	254	100	220	171.4	5	75	8.5	-10.5	25	45	M85x2.0	6-M16	43	125	76	88	83.6	42	49	242	15.5
QB312	304	110	220	171.4	6	91	8	-15	28	50	M100x2.0	6-M16	51	139	90	106.3	101	42	49	269	15.5

※Blank draw nut equipped. ※Max speed is shown using actual data.

Specifications

Specifications Model	Thru-Hole mm	Plunger Stroke mm	Outer gripping range mm	Jaw Stroke (diameter) mm	Max. Draw Bar Pull Force kN (kgf)	Max. Gripping Force kN (kgf)	Max. Speed min⁻¹ (r.p.m)	Net Weight with Soft top jaws kg	Moment of inertia kg·m²	Matching Cylinder	Max. pressure MPa(kgf/cm²)	Matching Soft top jaw
QB306	45	12	φ10~φ140	5.5	22 (2243)	57 (5812)	5500	12.6	0.058	S1246	2.8 (28.6)	SB06BB
QB308	52	16	φ18~φ180	7.4	34 (3467)	84 (8565)	4500	23.2	0.173	S1552	2.6 (26.5)	SB08BB
QB310	75	19	φ22~φ210	8.8	43 (4385)	111 (11319)	4000	35	0.318	S1875	2.7 (27.5)	SB10BB
QB312	91	23	φ30~φ250	10.6	55 (5608)	144 (14684)	3000	56	0.745	S2091	2.7 (27.5)	SB12BB

Soft Top Jaw Dimensions

Soft Top Jaw Dimensional Drawings

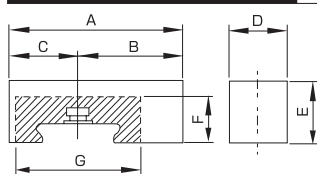

Note) No modification is allowed in shaded area.

Model	6"		8"		10"		12"	
	SB06BB	SB06BB-040	SB08BB	SB08BB-056	SB10BB	SB10BB-060	SB12BB	SB12BB-070
A	90	90	106	106	125	125	139	139
B	54	54	64	64	76	76	90	90
C	36	36	42	42	49	49	49	49
D	32	32	37	37	42	42	42	42
E	30	40	38	56	42	60	50	70
F	24	24	28	28	31	31	34	34
G	68	68	76	76	88	88	92	92
Min.gripper range	10	10	18	18	22	22	30	30