

EasyChange Basic Holder

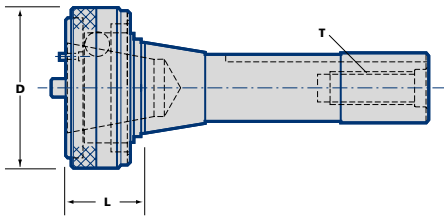

Ordering No.	Stock	Back End	L	D	T
R8-EC-027	•	R8	27	60	7/16" UNF
QC30-EC-060	•	ISO30	60	60	M12
QC40-EC-049	•	ISO40	50	60	M16
QC40I-EC-050	○	ISO40	50	60	5/8" UNC
MT3-EC-051	○	3 MORSE	51	60	TANG
SS320-EC-027	○	32mm S/S	27	60	-
SS1250-EC-027	○	1 1/4" S/S	27	60	-

ER Single Angle Collet Chucks

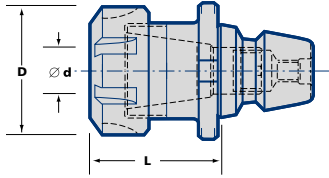

Ordering No.	Stock	Capacity d	L	D
EC-ER16-040	•	1-10	40	28
EC-ER20-040	•	1-13	40	34
EC-ER25-045	•	1-16	45	42
EC-ER32-050	•	2-20	50	50

Ancillaries

Wrenches	Locknuts	Collets	Screws
See page 130	See page 138	See page 121	See page 138

DA Double Angle Collet Chucks

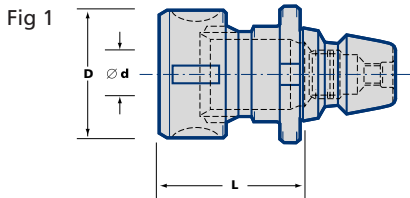

Ordering No.	Stock	Style	Capacity d	L	D	A/F
EC-DA 208-041	•	2	1-10	41	27	24
EC-DA188-049	•	1	3-20	49	43	-

Ancillaries

Wrenches	Locknuts	Collets	Screws
See page 130	See page 138	See page 121	See page 138

■ Morse Taper Adaptors (Tang Type)

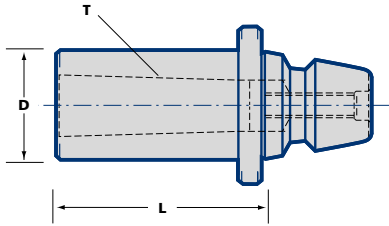

Ordering No.	Stock	MT	L	D
EC-MT1-051	•	1	051	25
EC-MT2-062	•	2	062	32
EC-MT3-117	•	3	117	40

■ Jacobs/DIN 238 Adaptors

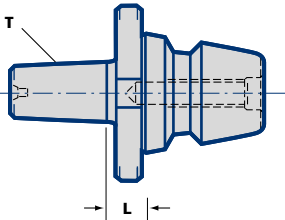

Ordering No.	Stock	JT	L
EC-JT2-010	•	2	10
EC-JT3-011	•	3	11
EC-JT33-010	•	33	10
EC-JT6-010	•	6	10

■ Greenstock Bar Blanks

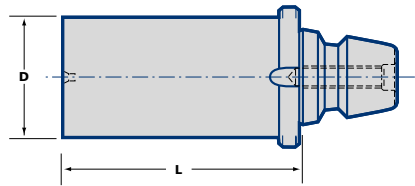

Ordering No.	Stock	D	L
EC-BB-040-080	•	40	80
EC-BB-040-120	•	40	120

All blanks have hardened and ground shanks with a machinable plain portion

■ Tightening Fixture

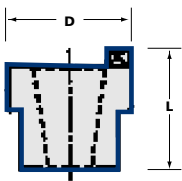

Ordering No.	Stock	D	L
TF-EC	•	58	58

■ Boring Head Adaptor

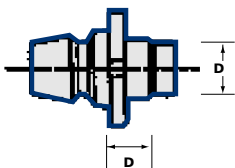

Ordering No.	Stock	D	L
EC-CBI0875-015	•	7/8"X20	15

End Mill/Sidelock Adaptors

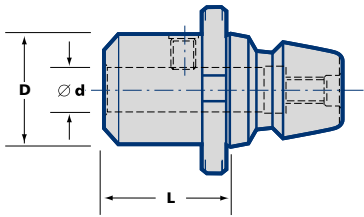

Ordering No.	Stock	d	D	L
EC-EM06-035	•	6	30	35
EC-EM10-035	•	10	30	35
EC-EM12-035	•	12	30	35
EC-EM16-035	•	16	30	35
EC-EM20-055	○	20	45	55
EC-EM25-075	○	25	55	75
EC-EMI0187-035	•	3/16"	19	35
EC-EMI0250-035	•	1/4"	19	35
EC-EMI0375-035	•	3/8"	26	35
EC-EMI0500-035	•	1/2"	32	35
EC-EMI0625-040	•	5/8"	41	35
EC-EMI0750-055	•	3/4"	46	35
EC-EMI1000-075	•	1"	51	75

Face Mill/Shell Mill Adaptors

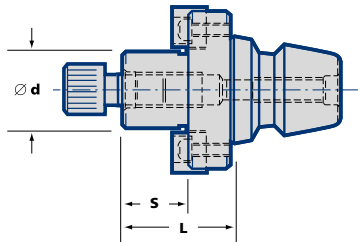

Ordering No.	Stock	d	D	L	S
EC-SM16-014	○	16	44	14	17
EC-SM22-014	•	22	50	14	19
EC-SMI0500-014	•	1/2"	32	14	15
EC-SMI0750-014	•	3/4"	44	14	18

Spare parts

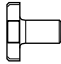
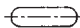
Wrenches	Retaining Screws	Drive Keys
 See page 131	 See page 140	 See page 140

EasyChange Tray



Ordering No.	Stock
TS-ECTRAY	•