



Precision Finish Boring Head Sets



Boring diameter Ø 6-90 mm

NEW

● Boring Bar
PAGE C85

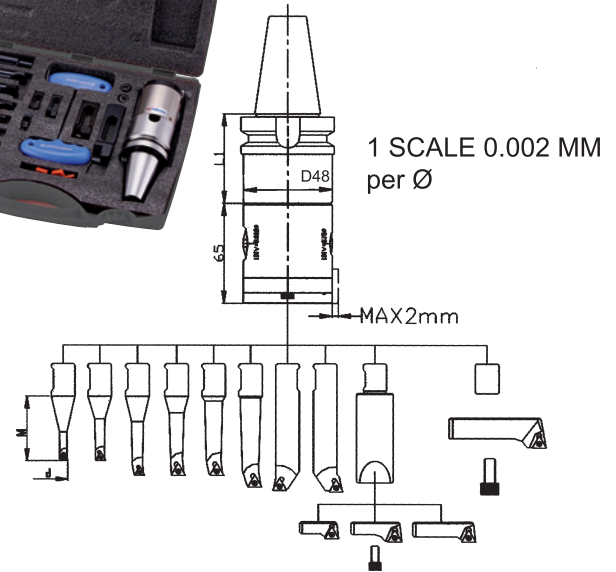

- Processing range Ød 6-90 mm.
- This slim set allows customer to process boring work in the narrow space with high precision.
- Precisely ground and hardened shank integrating with boring head for routing and smooth operation.
- Please keep boring head clean and lubricate constantly.



SET TYPE

VBHD SHANK

ORDER NO.	Boring Range Ø	Shank	L1	Head Dia. ØD	PCS/SET	CODE NO.	ORDER NO.	L	WEIGHT	CODE NO.
VBHD-BT-30	6-90	BT30-VCK4-45	45	48	14 PCS/SET	3320-450	BT30-VCK4-45	45		3320-450S
VBHD-BT-40		BT40-VCK4-60	60			3320-451	BT40-VCK4-60	60		3320-451S
VBHD-BT-50		BT50-VCK4-75	75			3320-452	BT50-VCK4-75	75		3320-452S
VBHD-SK-40		SK40-VCK4-65	65			3320-453	SK40-VCK4-65	65		3320-453S
VBHD-SK-50		SK50-VCK4-75	75			3320-454	SK50-VCK4-75	75		3320-454S
VBHD-NT-40		NT40-40-VCK4-60	60			3320-455	NT40-40-VCK4-60	60		3320-455S
VBHD-NT-50		NT50-50-VCK4-60	60			3320-456	NT50-50-VCK4-60	60		3320-456S
VBHD-HSK63A		HSK63A-VCK4-75	75			3320-457	HSK63A-VCK4-75	75		3320-457S
VBHD-HSK100A		HSK100A-VCK4-75	75			3320-458	HSK100A-VCK4-75	75		3320-458S

ACCESSORIES: BORING BAR SIZE FOR SET TYPE

Boring Bar	Range d	Depth m	Insert	Screw	Wrench	Feed mm/REV.
BR-1606-20	6-9	20	WBGT060102L	TS2	T6	0.05-0.1
BR-1608-28	8-11	28	TBGT060102L			0.05-0.1
BR-1610-36	10-13	36	TBGT060104L			0.07-0.15
BR-1612-42	12-15	42	TPGT090202L	TS25	T8	0.05-0.1
BR-1614-50	14-17	50				0.07-0.15
BR-1616-60	16-20	60				0.07-0.15
BR-1620-63	20-24	63	TPGT090204L	M5 X15 CAP	4	0.05-0.1
BR-1624-64	24-28	64				
BM5		60+SRTP2838/SRTP3652/SRTP4470		M5 X15 CAP	4	0.05-0.1
SRTP2838	28-38	+10	TPGT090202L	TS25	T8	
SRTP3652	36-52	+12				
SRTP4470	44-70	+12	TPGT090204L			0.07-0.15
BM8				M8 X 15 CAP	6	
SRTP58-90	58-90	+20	TPGT090204L	TS25	T8	



Precision Finish Boring Head Sets



Boring diameter Ø 6-150 mm

● Boring Bar
PAGE C85

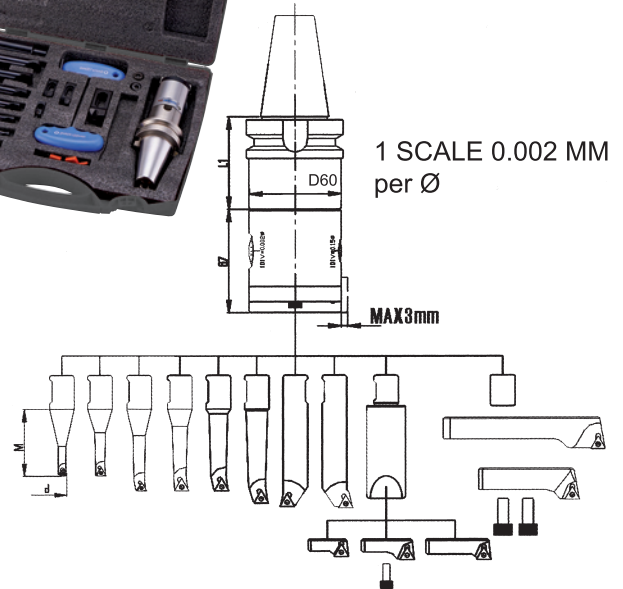

- Processing range Ød 6-150 mm.
- This slim set allows customer to process boring work in the narrow space with high precision.
- Please keep boring head clean and lubricate constantly.
- Precisely ground and hardened shank integrating with boring head for routing and smooth operation.



BORING HEAD SETS

SET TYPE

VBHE SHANK

ORDER NO.	Boring Range Ø	Shank	L1	Head Dia. ØD	PCS/SET	CODE NO.
VBHE-BT-40	6-150	BT40-VCK5-60	60	60	15 PCS/SET	3320-460
VBHE-BT-50		BT50-VCK5-75	75			3320-461
VBHE-SK-40		SK40-VCK5-65	65			3320-462
VBHE-SK-50		SK50-VCK5-75	75			3320-463
VBHE-NT-40		NT40-40-VCK5-60	60			3320-464
VBHE-NT-50		NT50-50-VCK5-75	75			3320-465
VBHE-HSK63A		HSK63A-VCK5-75	75			3320-466
VBHE-HSK100A		HSK100A-VCK5-75	75			3320-467

ORDER NO.	L	WEIGHT	CODE NO.
BT40-VCK5-60	60		3320-460S
BT50-VCK5-75	75		3320-461S
SK40-VCK5-65	95		3320-462S
SK50-VCK5-75	75		3320-463S
NT40-40-VCK5-60	60		3320-464S
NT50-50-VCK5-75	75		3320-465S
HSK63A-VCK5-75	75		3320-466S
HSK100A-VCK5-75	75		3320-467S

ACCESSORIES: BORING BAR SIZE FOR SET TYPE

Boring Bar	Range d	Depth m	Insert	Screw	Wrench	Feed mm/REV.
BR-1606-20	6-9	20	WBGT060102L	TS2	T6	0.05-0.1
BR-1608-28	8-11	28	TBGT060102L			0.05-0.1
BR-1610-36	10-13	36	TBGT060104L			0.07-0.15
BR-1612-42	12-15	42	TPGT090202L	TS25	T8	0.05-0.1
BR-1614-50	14-17	50				0.07-0.15
BR-1616-60	16-20	60				
BR-1620-63	20-24	63	TPGT090204L			0.05-0.1
BR-1624-64	24-28	64				0.07-0.15
BM5		60+SRTP2838/SRTP3652/SRTP4470		M5 X15 CAP	4	
SRTP2838	28-38	+10	TPGT090202L	TS25	T8	0.05-0.1
SRTP3652	36-52	+12				0.07-0.15
SRTP4470	44-70	+12				TPGT090204L
BM8				M8 X 15 CAP	6	
SRTP70110	70-110	+20	TPGT090202L	TS25	T8	0.05-0.1
SRTP110150	110-150	+20	TPGT090204L			0.07-0.15



Micro Boring Head Set



I Scale 0.002 mm Boring diameter from Ø6 - Ø154mm

NEW

● Boring Bar
PAGE C85



- Processing range Ø6-154 mm.
- Precisely ground and hardened shank integrating with boring head for routing and smooth operation.
- Please keep boring head clean and lubricated constantly.
- Easy & Simple operation.
- Complete set.
- Fine adjustment.
- Luxury box.
- Material : tool steel



SET TYPE

ORDER NO.	Boring Range Ø	Shank	L	Pcs/SET	Weight (kgs)	CODE NO.
VBH55-BT40	6-154	BT40-VBK5-75	75	18		3320-470
VBH55-BT50		BT50-VBK5-105	105	18		3320-471

INCLUDING ACCESSORIES : BORING BAR SIZE FOR SET TYPE

Boring Bar		Range	Insert	Screw	Wrench
BR1606A-21		Ø6 - Ø9	WBGT060102	Ø3 x M2	T6
BR1608A-28		Ø8 - Ø11	TBGT060102	Ø2.7 x M2	T6
BR1610A-35		Ø10 - Ø13			
BR1612A-42		Ø12 - Ø15	TPGT090204	M2.5	T8
BR1614A-50		Ø14 - Ø17			
BR1616A-60		Ø16 - Ø20			
BR1620A-65		Ø20 - Ø24			
BR1624A-68		Ø24 - Ø28			
C16-BRM-SP27		Ø27 - Ø40			
C16-BRM-SP35		Ø35 - Ø50			
C16-BRM-SP45		Ø45 - Ø68			
CB-M10-SP55		Ø55 - Ø80			
CB-M10-SP68		Ø68 - Ø104			
CB-M10-SP100		Ø100 - Ø154			



Micro Boring Head Set



I Scale 0.002 mm Boring diameter from Ø6 - Ø204mm

NEW

• Boring Bar
PAGE C85



- Processing range Ø6-204 mm.
- Precisely ground and hardened shank integrating with boring head for routing and smooth operation.
- Please keep boring head clean and lubricated constantly.
- Easy & Simple operation.
- Complete set.
- Fine adjustment.
- Luxury box.
- Material : tool steel



SET TYPE

ORDER NO.	Boring Range Ø	Shank	L	Pcs/SET	Weight (kgs)	CODE NO.
VBH68-BT40	6-204	BT40-VBK6-65	65	19		3320-476
VBH68-BT50		BT50-VBK6-95	95	19		3320-477

INCLUDING ACCESSORIES : BORING BAR SIZE FOR SET TYPE

Boring Bar		Range	Insert	Screw	Wrench
BR1606A-21		Ø6 - Ø9	WBGT060102	Ø3 x M2	T6
BR1608A-28		Ø8 - Ø11	TBGT060102	Ø2.7 x M2	T6
BR1610A-35		Ø10 - Ø13			
BR1612A-42		Ø12 - Ø15	TPGT090204	M2.5	T8
BR1614A-50		Ø14 - Ø17			
BR1616A-60		Ø16 - Ø20			
BR1620A-65		Ø20 - Ø24			
BR1624A-68		Ø24 - Ø28			
C16-BRM-SP27		Ø27 - Ø40			
C16-BRM-SP35		Ø35 - Ø50			
C16-BRM-SP45		Ø45 - Ø68			
CB-M10-SP68		Ø68 - Ø104			
CB-M10-SP100		Ø100 - Ø154			
CB150-RCM100-SP100		Ø150 - Ø204			

BORING HEAD SETS



High Precision Boring Head Set



NEW

1 SCALE 0.005 mm

0.01 mm per Ø

BORING CAPACITY Ø8-Ø46

● Boring Bar
PAGE C85



Clamping Screw For Boring Bar

VBH 620

- Good for high speed, high precision boring work.
- Made of tool steel, high rigidity, no deformation.
- Each dividing scale is 0.005 mm, total stroke: 6 mm. For Ø diameter is 0.01 mm
- Can choose any taper (BT40, BT50, SK40, SK50) shank.
- Include 8 boring bars, range Ø8 ~ Ø46 mm.
- Boring bar size = Ø16 x 8 pcs
- Insert locking screw 8 x 3 = 24 pcs
- Wrench x 6 pcs
- 4 mm T wrench x 1 pcs



SET TYPE

ORDER NO.	SHANK TYPE	DRAWBAR	THREAD	Weight (kgs)	CODE NO.
		S.A.E	METRIC		
VBH620-NT40	NT-40	5/8"-11W	M16X2.0P	6.5	3320-480
VBH620-NT50	NT-50	1"-8W	M24X3.0P	7.8	3320-481
VBH620-BT40	BT-40		M16X2.0P	6.5	3320-482
VBH620-BT50	BT-50		M24X3.0P	8	3320-483
VBH620-SK40	SK-40		M16X2.0P	6.5	3320-484
VBH620-SK50	SK-50		M24X3.0P	7.8	3320-485

BORING BAR FOR BORING HEAD

BORING BAR	RANGE d	DEPTH m	SHANK L	INSERT	SCREW	WRENCH
BRB1608-32	8-11	32	80	TBGT060102L	TS2001	T6
BRB1610-40	10-13	40	80			
BRB1612-53	12-15	53	85	TPGH090204L	TS2504	T8
BRB1616-68	16-21	68	100			
BRB1620-83	20-26	83	115	TPGH110304L	TS3005	T10
BRB1625-90	25-31	90	122			
BRB1630-90	30-36	90	122			
BRB1640-90	40-46	90	122			



High Precision Boring Head Set



NEW

1 SCALE 0.005 mm
0.01 mm per Ø
BORING CAPACITY Ø8-Ø280

• Boring Bar
PAGE C85

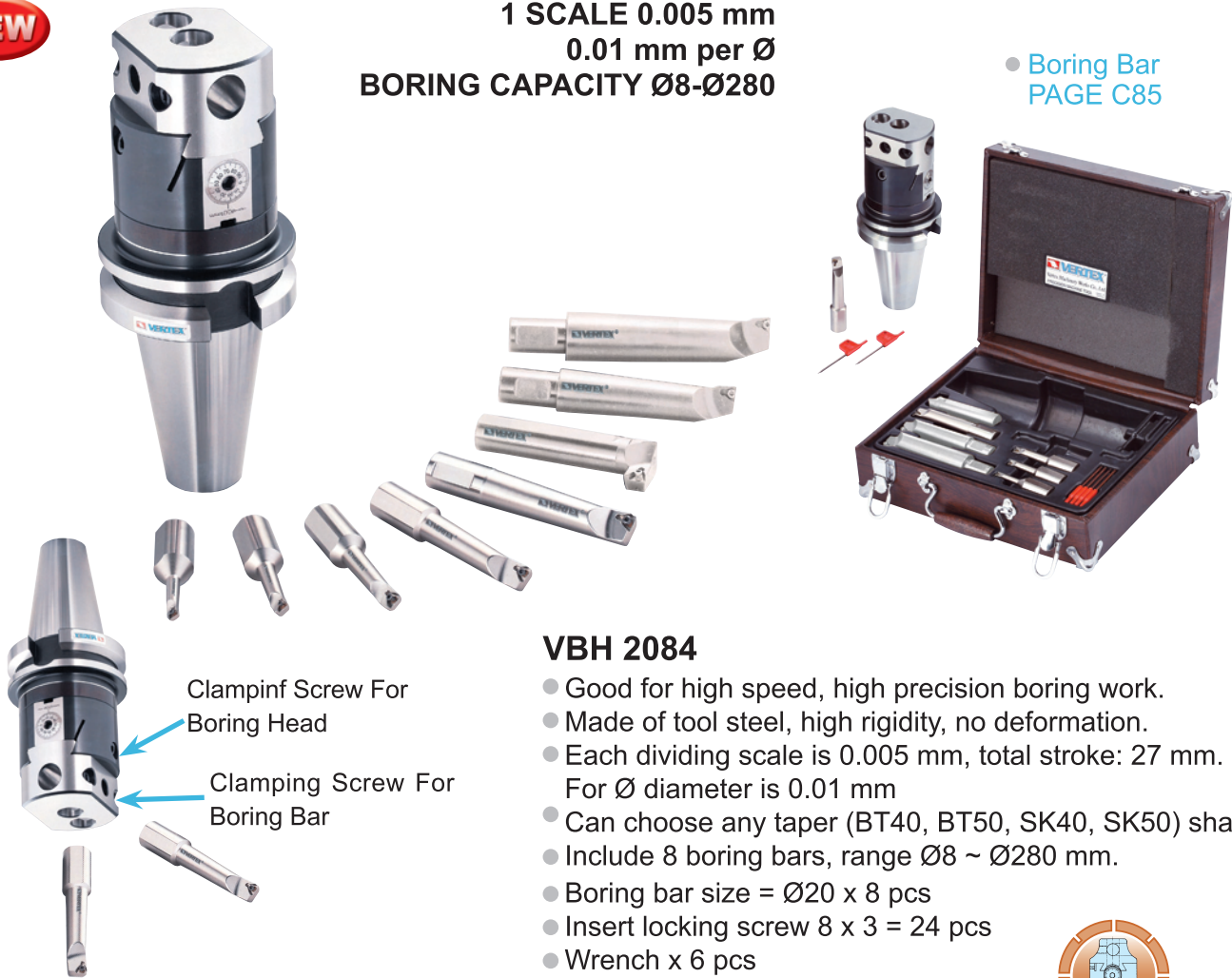

VBH 2084

- Good for high speed, high precision boring work.
- Made of tool steel, high rigidity, no deformation.
- Each dividing scale is 0.005 mm, total stroke: 27 mm. For Ø diameter is 0.01 mm
- Can choose any taper (BT40, BT50, SK40, SK50) shank.
- Include 8 boring bars, range Ø8 ~ Ø280 mm.
- Boring bar size = Ø20 x 8 pcs
- Insert locking screw 8 x 3 = 24 pcs
- Wrench x 6 pcs
- Hexa 6 wrench x 1 pcs



SET TYPE

ORDER NO.	SHANK TYPE	DRAWBAR	THREAD	Weight (kgs)	CODE NO.
		S.A.E	METRIC		
VBH2084-R8	R-8	7/16"-20UNF	n/a	6.6	3320-491
VBH2084-NT30	NT-30	1/2"-12W	M12X1.75P	6.6	3320-492
VBH2084-NT40	NT-40	5/8"-11W	M16X2.0P	7	3320-493
VBH2084-NT50	NT-50	1"-8W	M24X3.0P	9	3320-494
VBH2084-BT40	BT-40		M16X2.0P	8	3320-495
VBH2084-BT50	BT-50		M24X3.0P	10.4	3320-496
VBH2084-SK40	SK-40		M16X2.0P	8	3320-497
VBH2084-SK50	SK-50		M24X3.0P	10.5	3320-501
VBH2084-MT3	MT-3		M12X1.5P	6.6	3320-498
VBH2084-MT4	MT-4		M16X2.0P	7	3320-499
VBH2084-MT5	MT-5		M24X3.0P	8	3320-500
VBH2084-C25	C25			7	3320-502
VBH2084-C32	C32			8	3320-203

BORING BAR FOR BORING HEAD

BORING BAR	RANGE d	DEPTH m	SHANK L	INSERT	SCREW	WRENCH
BRB2008-32	8-11	32	80	TBGT060102L SUMITOMO	TS2001	T6
BRB2010-40	10-13	40	80			
BRB2012-53	12-17	53	85	TPGH090204L MITSUBISHI	TS2504	T8
BRB2016-68	16-21	68	100			
BRB2020-83	20-130	83	115	TPGH110304L MITSUBISHI	TS3005	T10
BRB2025-96	25-135	96	135			
BRB2030-115	30-140	115	154			
BRB2035-97-L	120-280	14	99			

BORING HEAD SETS



Universal Boring And Facing Master Head

**BORING CAPACITY Ø5-Ø250
FOR VERTICAL HOLE BORING IS Ø110**

1 SCALE 0.01 mm per Ø



● Boring Bar
PAGE C85

ORDER NO.	SHANK TYPE	DRAWBAR THREAD		Weight (kg)	CODE NO.
		S.A.E	METRIC		
VBHU-202	MT-3	1/2"-12W	M12X1.5P	6	3401-001
VBHU-203	MT-4	5/8"-11W	M16X2.0P	6.3	3401-002
VBHU-204	MT-5	1"-8W	M24X3.0P	7	3401-003
VBHU-205	R-8	7/16"-20UNF	n/a	6.2	3401-004
VBHU-206	NT-30	1/2"-12W	M12X1.75P	6	3401-005
VBHU-207	NT-40	5/8"-11W	M16X2.0P	6.2	3401-006
VBHU-208	NT-50	1"-8W	M24X3.0P	8.5	3401-007
VBHU-209	BT-40		M16X2.0P	6.9	3401-008
VBHU-210	C-25			4.5	3401-009
VBHU-211	SK-40		M16X2.0P	5.6	3401-010
VBHU-212	SK-50		M24X3.0P	8.3	3401-011
VBHU-213	BT-50		M24X3.0P	9.7	3401-012
VBHU-214	C-20			6	3401-013

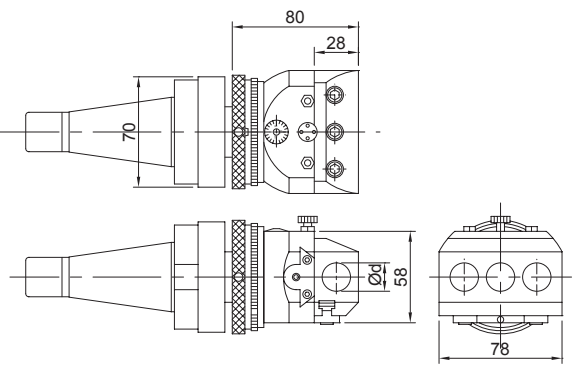

SPECIFICATION VBHU

Unit:mm

ACTUAL SIZE	OVERING BAR HOLE SIZE	BORING BAR HOLE SIZE	CENTER DIST BETWEEN HOLES.	CROSS HOLE DIA	OFFSET
78	100	18	23	18	15

It is construction with precision parts, freedom of selection feeding quantity, auto feed and stop. Processing range from 5mm to 250mm.

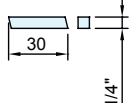
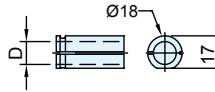
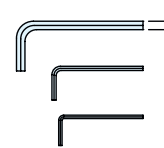
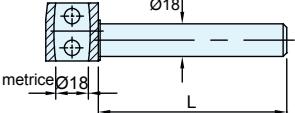
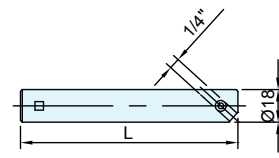
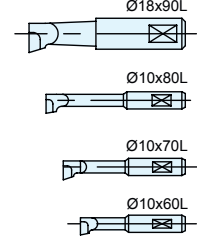
 <p>Stop Rod BP-17</p>	 <p>Square Bit(HSS) BP-18</p>	 <table border="1"> <thead> <tr> <th colspan="2">Clamping Sleeve</th> </tr> </thead> <tbody> <tr> <td>metrice</td> <td>D</td> </tr> <tr> <td>BP-7</td> <td>Ø10</td> </tr> <tr> <td>BP-8</td> <td>Ø12</td> </tr> </tbody> </table>	Clamping Sleeve		metrice	D	BP-7	Ø10	BP-8	Ø12																
Clamping Sleeve																										
metrice	D																									
BP-7	Ø10																									
BP-8	Ø12																									
 <table border="1"> <thead> <tr> <th colspan="2">Allen Key</th> </tr> </thead> <tbody> <tr> <td></td> <td>A</td> </tr> <tr> <td>BP-14</td> <td>4</td> </tr> <tr> <td>BP-15</td> <td>5</td> </tr> <tr> <td>BP-16</td> <td>6</td> </tr> </tbody> </table>	Allen Key			A	BP-14	4	BP-15	5	BP-16	6	 <table border="1"> <thead> <tr> <th colspan="2">Boring Bar</th> </tr> </thead> <tbody> <tr> <td>metrice</td> <td>L</td> </tr> <tr> <td>BP-21</td> <td>104</td> </tr> </tbody> </table>	Boring Bar		metrice	L	BP-21	104	 <table border="1"> <thead> <tr> <th colspan="2">Boring Bar</th> </tr> </thead> <tbody> <tr> <td>metrice</td> <td>L</td> </tr> <tr> <td>BP-1</td> <td>90</td> </tr> <tr> <td>BP-2</td> <td>120</td> </tr> </tbody> </table>	Boring Bar		metrice	L	BP-1	90	BP-2	120
Allen Key																										
	A																									
BP-14	4																									
BP-15	5																									
BP-16	6																									
Boring Bar																										
metrice	L																									
BP-21	104																									
Boring Bar																										
metrice	L																									
BP-1	90																									
BP-2	120																									
<table border="1"> <thead> <tr> <th colspan="2">Boring Bar</th> </tr> </thead> <tbody> <tr> <td>metric</td> <td>ØxL</td> </tr> <tr> <td>BP-9</td> <td>Ø18x90</td> </tr> <tr> <td>BP-10</td> <td>Ø10x80</td> </tr> <tr> <td>BP-11</td> <td>Ø10x70</td> </tr> <tr> <td>BP-12</td> <td>Ø10x60</td> </tr> </tbody> </table> 	Boring Bar		metric	ØxL	BP-9	Ø18x90	BP-10	Ø10x80	BP-11	Ø10x70	BP-12	Ø10x60														
Boring Bar																										
metric	ØxL																									
BP-9	Ø18x90																									
BP-10	Ø10x80																									
BP-11	Ø10x70																									
BP-12	Ø10x60																									



Interchangeable Shanks



SHANK

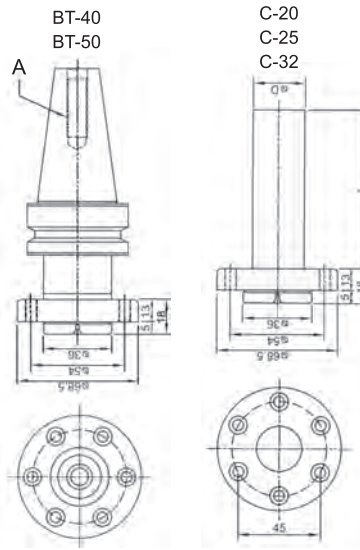
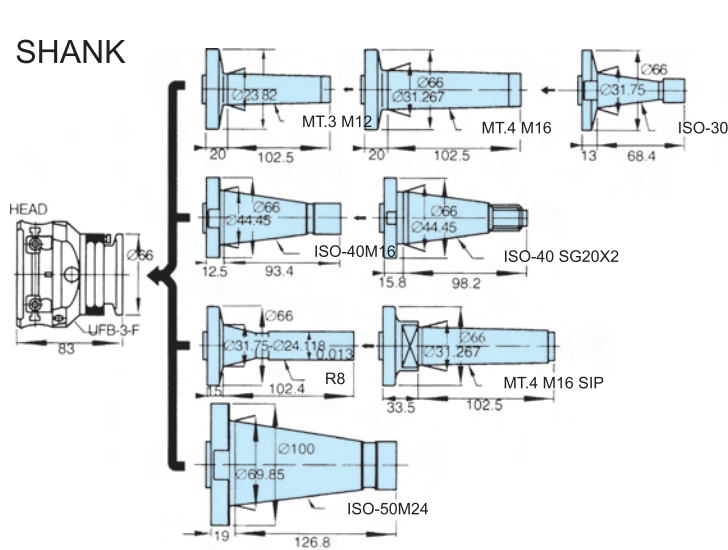

SHANK CHANGEABLE

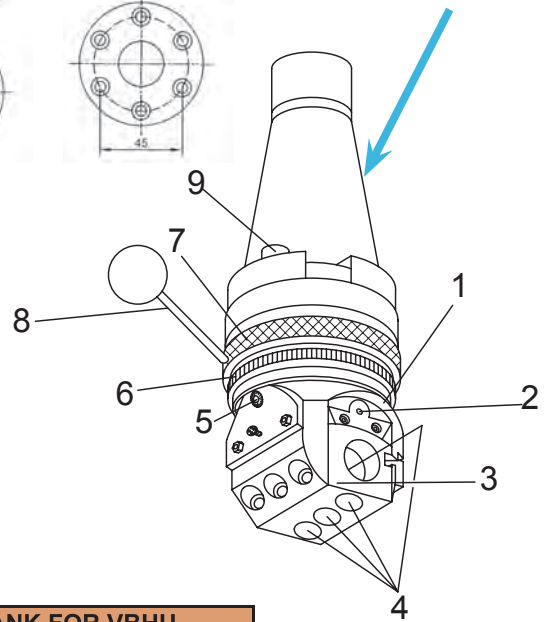

Main part of the universal boring heads is the body(1), in which the tool slide (3) moves on dovetail guideways. The tool slide is provided with holes for accommodation of tools and tool holders(4). In boring holes or turning external cylindrical surfaces, the tool is adjusted with the aid of the graduated dial for fine setting of tool slide(5), one division of which means a change in diameter of bored hole by .0005". On the types rapid adjustment of the tool slide(3) can be produced by rotating the graduated dial for quick adjustment of the tool slide(2). During recessing, turning of front or rear facings or similar jobs calling for automatic transverse feed movement to the tool slide, the preselected feed movement to the tool slide is engaged with the aid of the engagement ring (6). After setting of tool, the automatic transverse feed movement to the tool slide is started by braking of the brake ring(7), by means of the handle(8). The clutch(9) provides for tripping of the automatic feed movement when cutting resistance increases or when the trip dog is approached. Mechanism of the boring heads has a lubrication circuit delivering oil from two lubricators to all friction surfaces. All parts are hardened and working surfaces are ground.

SHANK FOR VBHU-		
MT-3	MT-4	MT-5
NT-30	NT-40	NT-50
R-8		
C-20	C25	C-32
BT-40		BT-50
	SK-40	SK-50

BORING HEAD SETS

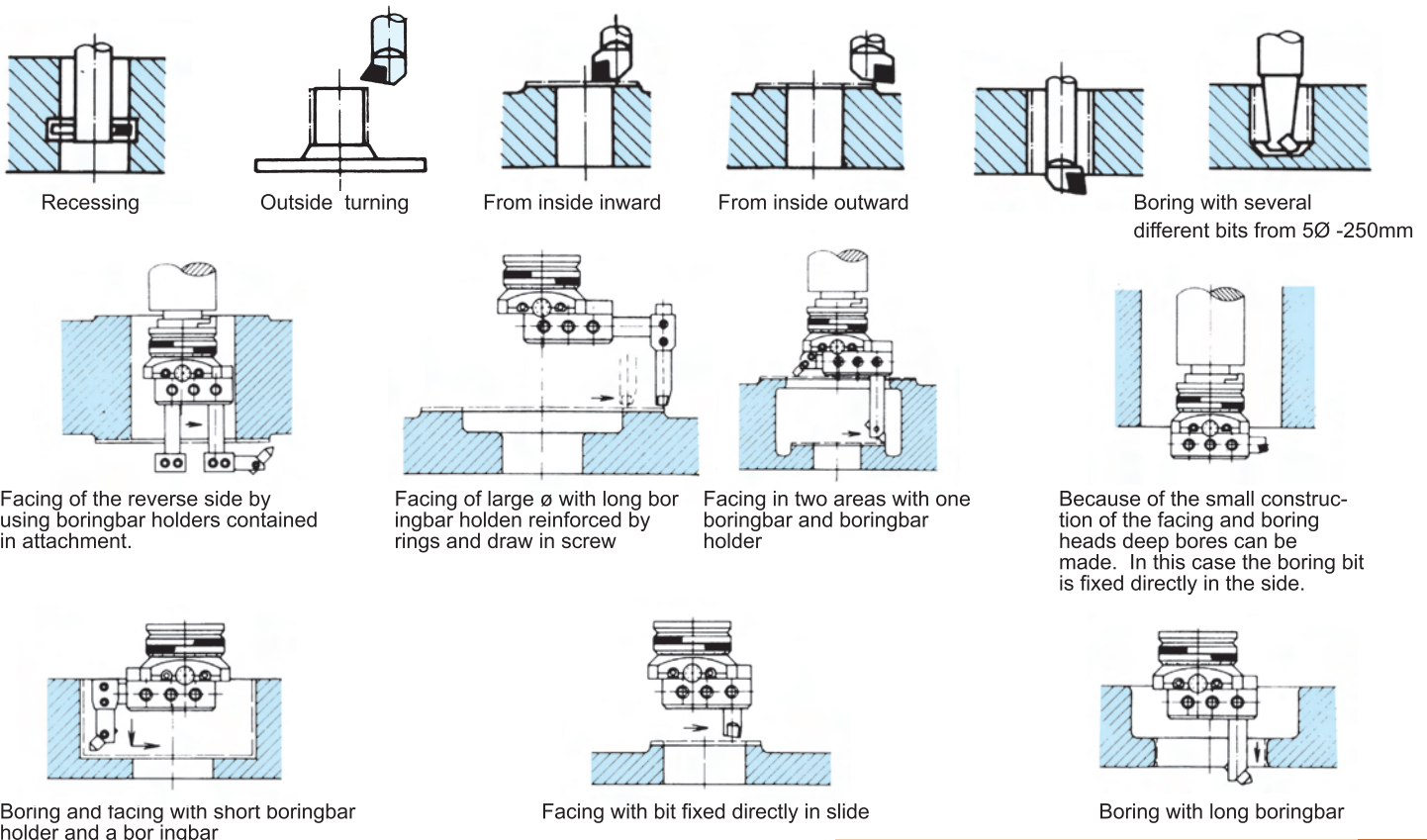

Because of the small construction of the facing and boring heads deep bores can be made. In this case the boring bit is fixed directly in the side.



Boring Head Sets



STANDARD TYPE

● Boring Bar
PAGE C85

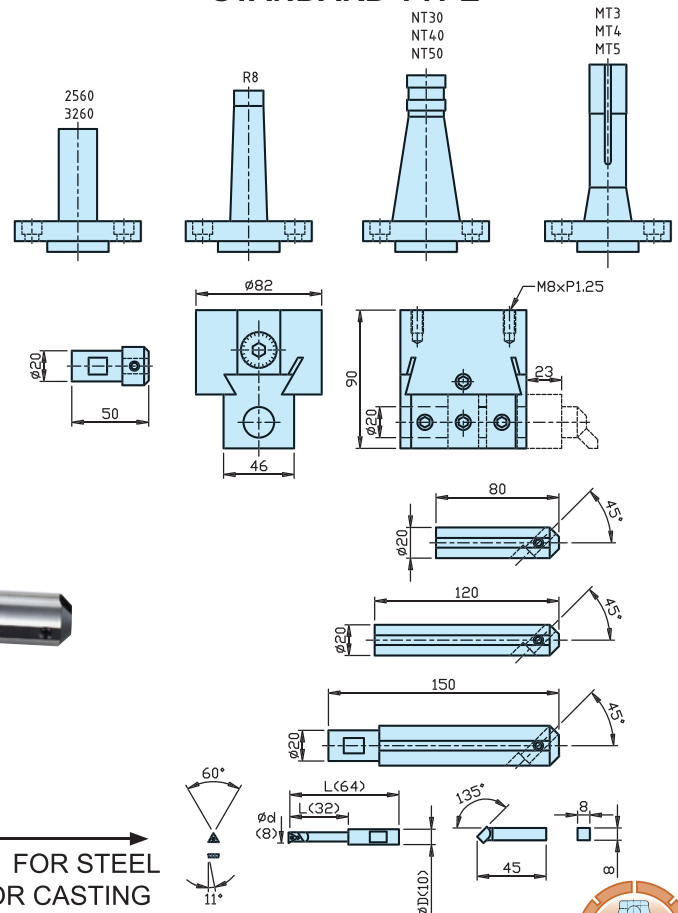

INSERT NO. →
TBGT060102L-W-T1200A FOR STEEL
TBGT060102L-W-G11 FOR CASTING
"SUMITOMO" BRAND



1 SCALE 0.005 mm, 0.01 mm per Ø Processing Range ø10 ~ ø240 mm

Simple, extremely rigid construction, Finest materials and craftsmanship are employed to combine strength, flexibility and accuracy in a tool of unique design. 2 vertical boring tool holes: one centered and one offset. One cross hole for greater versatility and capacity. Dependable adjustment --- far spread graduation for closer reading. Perfectly balanced for high speed operation. Precision ground & hardened shank are integrating with the head for routing and smoother operation.



MT-3, 4, 5
NT-30, 40, 50
BT-40, 50
SK-40, 50
C-25, 32

FULL SET

ORDER NO.	SHANK TYPE	DRAWBAR THREAD		Weight (kgs)	CODE NO.
		S.A.E	METRIC		
VBH-102	MT-3		M12X1.75P	5.9	3401-101
VBH-103	MT-4		M16X2.0P	6.1	3401-102
VBH-104	MT-5		M20X3.0P	7	3401-103
VBH-105	R-8	7/16" ~20UNF		5.9	3401-104
VBH-106	NT-30	1/2"-12W or 1/2"-13UNC	M12X1.75P	5.8	3401-105
VBH-107	NT-40	5/8"-11W	M16X2.0P	6	3401-106
VBH-108	NT-50	1"-8W	M24X3.0P	8.9	3401-107
VBH-109	BT-40	-	M16X2.0P	7.1	3401-108
VBH-110	SK-40	-	M16X2.0P	6.8	3401-109
VBH-111	C-25			5.7	3401-110
VBH-112	BT-50		M24X3.0P	9.4	3401-111
VBH-113	SK-50		M24X3.0P	5.9	3401-112
VBH-114	C-32			5.9	3401-113

SHANK FOR BORING HEAD

ORDER NO.	VBH-MT3	VBH-MT4	VBH-MT5	VBH-R8
WEIGHT (KG)	0.6	1.2	2.1	1
CODE NO.	3401-120	3401-121	3401-122	3401-123

ORDER NO.	VBH-NT30	VBH-NT40	VBH-NT50	VBH-BT40
WEIGHT (KG)	1.1	1.2	3.9	1.9
CODE NO.	3401-124	3401-125	3401-126	3401-127

ORDER NO.	VBH-SK40	VBH-C25	VBH-BT50	VBH-SK50
WEIGHT (KG)	1.9	1.5	3.1	3.98
CODE NO.	3401-128	3401-129	3401-130	3401-131



Boring Head Set C-Type



1 SCALE 0.01 mm
0.02 mm per Ø

• Boring Bar
PAGE C85



VBHC-BC2 SET TYPE



MAX. BORING DEPTH 50 mm

Here is a sturdy unit of extended boring range, capable of peeling off heavy roughing cuts as well as a tool of extreme sensitivity.

The use of a wide base bar holder, resting securely on the body, eliminates the need for a separate side plate. You will note this has now become an integral part of the body.

The direct reading adjusting screw is ground after hardening and a plainly marked dial face in nonreflecting satin chrome allows easy reading and adjustments of 0.01 or less.

All Criterion Boring Heads have threaded backs for use with a variety of shanks. This model takes a 1-1/2"-18 threaded shank.

SHANK SIZE: NT-30,40,50, MT-3,4,5,R8



VBHC-BC3 SET TYPE



BORING CAPACITY Ø10~Ø110

ORDER NO.	WEIGHT (kgs)	CODE NO.
VBHC-R-8-BC-2	2	3401-150
VBHC-MT-2-BC-2	1.66	3401-149
VBHC-MT-3-BC-2	1.9	3401-151
VBHC-MT-4-BC-2	2.1	3401-152
VBHC-NT-30-BC-2	2.2	3401-153
VBHC-NT-40-BC-2	2.8	3401-154
VBHC-BT-30-BC-2	2.65	3401-155
VBHC-BT-40-BC-2	2.65	3401-156
VBHC-BT-50-BC-2	5.65	3401-157
VBHC-C-20-BC-2	1.75	3401-158
VBHC-SK-40-BC-2		3401-174
VBHC-SK-50-BC-2		3401-176

BORING CAPACITY Ø10~Ø220

ORDER NO.	WEIGHT (kgs)	CODE NO.
VBHC-R-8-BC-3	4.2	3401-160
VBHC-MT-2-BC-3	4	3401-148
VBHC-MT-3-BC-3	4	3401-161
VBHC-MT-4-BC-3	4.3	3401-162
VBHC-NT-30-BC-3	4.1	3401-163
VBHC-NT-40-BC-3	4.7	3401-164
VBHC-NT-50-BC-3	6.9	3401-165
VBHC-BT-30-BC-3	4.34	3401-166
VBHC-BT-40-BC-3	4.7	3401-167
VBHC-BT-50-BC-3	7.7	3401-168
VBHC-C-20-BC-3	4	3401-169
VBHC-SK-40-BC-3		3401-175
VBHC-SK-50-BC-3		3401-177