



# Milling Collet Chuck



OZ-25  
COLLET HOLDER WITH BT-SHANK

DIN 6388 # 25 SERIES MAS 403  
BT-SHANK

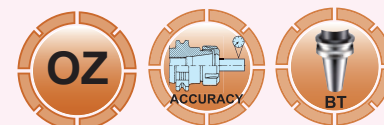

ORDER NO.	TAPER	DIN 6388	L	DRAW BAR	WEIGHT KGS	CODE NO.
VB-BT40	BT40	#25	80	M16X2.0P	1.7	3101-009
VB-BT50	BT50	#25	100	M24X3.0P	4.6	3101-010

## Milling Collet Chuck Kit

Including Shank, full set of collets, wrench and case.

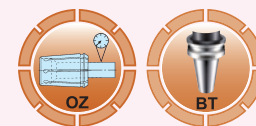

### METRIC COLLET SYSTEM

ORDER NO.	TAPER	PCS/SET	WEIGHT KGS	CODE NO.
VB-241	BT40	7	4.4	3101-117
VB-242		15	5.9	3101-118
VB-251	BT50	7	7.5	3101-119
VB-252		15	9.5	3101-120

### CONTENT COLLET SET SIZE

METRIC RANGE SET SIZE
7PCS: 6, 8, 10, 12, 16, 20, 25mm
15PCS: 3, 4, 5, 6, 7, 8, 9, 10, 11, 12, 13, 16, 18, 20, 25mm

### INCH COLLET SET SIZE

ORDER NO.	TAPER	PCS/SET	WEIGHT KGS	CODE NO.
VB-231	BT40	7	4.4	3101-121
VB-232		15	5.9	3101-122
VB-233	BT50	7	7.5	3101-123
VB-234		15	9.5	3101-124

INCH RANGE SET SIZE
7PCS: 1/4", 5/16", 3/8", 1/2", 5/8", 3/4", 1"
15PCS: 1/8", 3/16", 1/4", 5/16", 3/8", 7/16", 1/2", 9/16", 5/8", 11/16", 3/4", 13/16", 7/8", 15/16", 1"



# Milling Collet Chuck



COLLET HOLDER WITH BT-SHANK  
OZ-32 MAS 403

DIN 6388 # 32 SERIES



ORDER NO.	TAPER	DIN 6388	L	DRAW BAR	WEIGHT KGS	CODE NO.
VB-226	BT40-OZ-32	#32	90	M16X2.0P	2.3	3102-003
VB-227	BT50-OZ-32	#32	100	M24X3.0P	5.1	3102-004
VB-228			150	M24X3.0P	6.8	3102-005

OZ SYSTEM

## Milling Collet Chuck Kit

Including Shank, full set of collets, wrench and case.

**#32 SERIES BT-TYPE  
MAS 403 BT-SHANK**

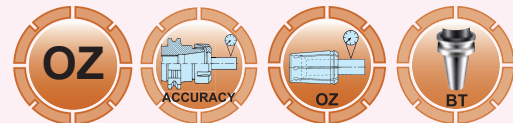

### METRIC COLLET SYSTEM SET

ORDER NO.	TAPER	PCS/SET	WEIGHT KGS	CODE NO.
VB-243	BT40	8	7.4	3102-109
VB-244		15	9.4	3102-110
VB-253	BT50	8	10	3102-111
VB-254		15	12	3102-112

### CONTENT COLLET SET SIZE

METRIC RANGE SET SIZE
8PCS:6, 8, 10, 12, 16, 20, 25, 32mm
15PCS:6, 8, 9, 10, 12, 13, 14, 15, 16, 18, 20, 22, 25, 26, 30, 32mm

### INCH COLLET SYSTEM SET

ORDER NO.	TAPER	PCS/SET	WEIGHT KGS	CODE NO.
VB-256	BT40	10	7.4	3102-113
VB-257		15	9.4	3102-114
VB-258	BT50	10	10	3102-115
VB-259		15	12	3102-116

INCH RANGE SET SIZE
10PCS: $1/4$ " $5/16$ " $3/8$ " $1/2$ " $5/8$ " $3/4$ " $7/8$ " $1$ " $1-1/8$ " $1-1/4$ "
15PCS: $1/4$ " $5/16$ " $3/8$ " $7/16$ " $1/2$ " $9/16$ " $5/8$ " $11/16$ " $3/4$ "
$13/16$ " $7/8$ " $15/16$ " $1$ " $1-1/8$ " $1-1/4$ "





# Milling Collet Chuck



COLLET HOLDER WITH ISO-SHANK  
OZ-32

DIN 6388 # 32 SERIES  
DIN 2080 NT-SHANK



ORDER NO.	TAPER	DIN 6388	DRAW BAR	WEIGHT KGS	CODE NO.
VB-130	NT30	#32	1.M12X1.75P	2	3102-006
VB-131	NT40	#32	1.M16X2.0P 2.5/8"-11W	2.2	3102-001
VB-132	NT50	#32	1.M24X3.0P 2.1"-8W	3.9	3102-002



## METRIC COLLET SYSTEM

ORDER NO.	TAPER	PCS/SET	WEIGHT KGS	CODE NO.
VB-121	NT40	8	7.5	3102-101
VB-121B	NT40	15	9.2	3102-102
VB-122	NT50	8	9.8	3102-103
VB-122B	NT50	15	11.8	3102-104
VB-123	NT30	8	7	3102-090
VB-123B	NT30	15	9	3102-091
VB-124	MTB5	8	8	3102-092
VB-124B	MTB5	15	10	3102-093



## Milling Collet Chuck Kit

Including Shank, full set of collets, wrench and case.  
**OZ-32 DIN 6388**



## CONTENT COLLET SET SIZE

METRIC RANGE SET SIZE
8PCS:6, 8, 10, 12, 16, 20, 25, 32mm
15PCS:6, 7, 8, 9, 10, 11, 12, 13, 16, 18, 20, 25, 26,30, 32mm



## INCH COLLET SYSTEM

ORDER NO.	TAPER	PCS/SET	WEIGHT KGS	CODE NO.
VB-162	NT30	10	7	3102-094
VB-162B	NT30	15	9	3102-095
VB-163	NT40	10	7.2	3102-105
VB-164	NT40	15	9.2	3102-106
VB-165	NT50	10	9.8	3102-107
VB-166	NT50	15	11.8	3102-108
VB-167	MTB5	10	8	3102-096
VB-167B	MTB5	15	10	3102-097



INCH RANGE SET SIZE
10PCS:1/4", 5/16", 3/8", 1/2", 5/8", 3/4", 7/8", 1", 1-1/8", 1-1/4"
15PCS:1/4", 5/16", 3/8", 7/16", 1/2", 9/16", 5/8", 11/16", 3/4", 13/16", 7/8", 15/16", 1", 1-1/8", 1-1/4"



# Milling Collet Chuck



COLLET HOLDER WITH  
DIN 69871 & CAT TPE

DIN 6388 # 25, #32 SERIES

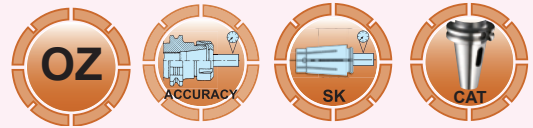

## DIN 69871A & CAT SHANK

ORDER NO.	TAPER	DIN 6388	DRAW BAR	WEIGHT KGS	CODE NO.
VB-261	SK40-OZ25-80L	#25	M16X2.0P	1.6	3101-011
VB-262	SK50-OZ25-100L		M24X3.0P	4.2	3101-012
VB-263	CAT40-OZ25-3"L		5/8"-11W	1.9	3101-013
VB-264	CAT50-OZ25-3 1/2"L		1"-8W	4	3101-014
VB-265	SK40-OZ32-80L	#32	M16X2.0P	2.3	3102-011
VB-266	SK50-OZ32-100L		M24X3.0P	5	3102-012

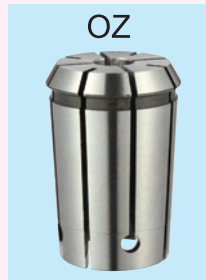

## Milling Collet Chuck Kit

Including Shank, full set of collets, wrench and case.

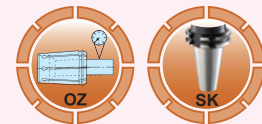

## METRIC COLLET SYSTEM SET DIN69871A SK-TYPE WITH #25,#32

ORDER NO.	COLLET HOLDER	TYPE	DIN 6388	RANGE	SET PCS	KGS	CODE NO.
VB-271	SK40-OZ25-80L	SK40	#25	3.0-25	15PCS	5.7	3101-125
VB-272	SK40-OZ25-80L		#25	6.0-25	7PCS	4.2	3101-126
VB-273	SK40-OZ32-80L	SK40	#32	6.0-32	15PCS	9.2	3101-127
VB-274	SK40-OZ32-80L		#32	6.0-32	8PCS	7.2	3101-128
VB-275	SK50-OZ25-100L	SK50	#25	3.0-25	15PCS	9.3	3101-129
VB-276	SK50-OZ25-100L		#25	6.0-25	7PCS	7.3	3101-130
VB-277	SK50-OZ32-100L	SK50	#32	6.0-32	15PCS	11.8	3102-117
VB-278	SK50-OZ32-100L		#32	6.0-32	8PCS	9.8	3102-118

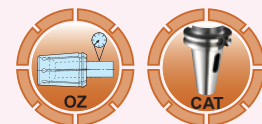

## INCH COLLET SYSTEM SET CAT-TYPE WITH #25,#32

ORDER NO.	COLLET HOLDER	TYPE	DIN 6388	RANGE	SET PCS	KGS	CODE NO.
VB-281	CAT40-OZ25-3"L	CAT40	#25	1/8"-1"	15PCS	5.7	3101-131
VB-282	CAT40-OZ25-3"L		#25	1/4"-1"	7PCS	4.2	3101-132
VB-286	CAT40-OZ32-3"L	CAT40	#32	1/4"-1 1/4"	15PCS	9.2	3102-119
VB-287	CAT40-OZ32-3"L		#32	1/4"-1 1/4"	10PCS	7.2	3102-120
VB-288	CAT50-OZ25-3 1/2"L	CAT50	#25	1/8"-1"	15PCS	9.3	3101-133
VB-289	CAT50-OZ25-3 1/2"L		#25	1/4"-1"	7PCS	7.3	3101-134
VB-290	CAT50-OZ32-3 1/2"L	CAT50	#32	1/4"-1 1/4"	15PCS	11.8	3102-121
VB-291	CAT50-OZ32-3 1/2"L		#32	1/4"-1 1/4"	10PCS	10	3102-122



# Multi-Lock Milling Chuck



COLLET HOLDER WITH ISO, BT & SK TAPER SHANK  
STRAIGHT COLLET TYPE

C-32 C-42

DIN 2080, MAS 403 DIN 69871A

C-20,25,32,42 TYPE



C TYPE

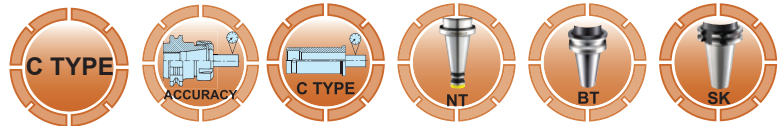
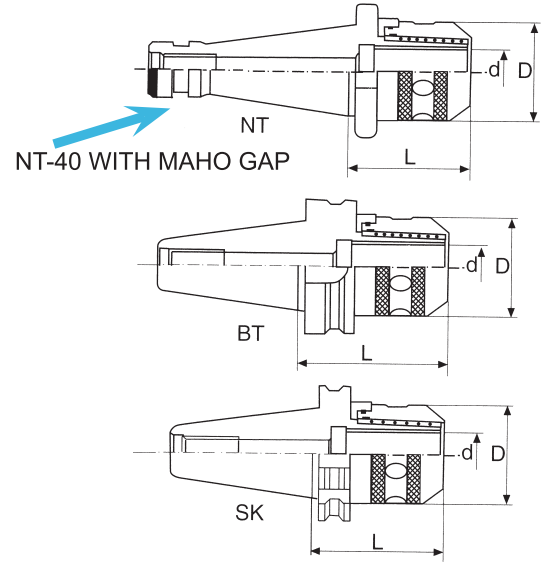

ORDER NO.	TAPER	CHUCK	d	D	L	DRAW BAR	KGS	CODE NO.
VB-431	NT40	NT40-MC32-95L	32	75	95	5/8"-11	3	3202-001
VB-432		NT40-MC32-95L	32	75	95	M16x2.0P	3.1	3202-002
VB-433	NT50	NT50-MC32-100L	32	75	100	1"-8	4.8	3202-003
VB-434		NT50-MC32-100L	32	75	100	M24x3.0P	5.1	3202-004
VB-435A	BT40	BT40-MC32-105L	32	75	105	M16x2.0P	3.2	3202-005
VB-435B		BT40-MC32-150L	32	75	150	M16x2.0P	3.5	3202-020
VB-436	BT50	BT50-MC32-110L	32	75	110	M24x3.0P	5.2	3202-006
VB-437		BT50-MC32-150L	32	75	135	M24x3.0P	7	3202-007
VB-438	NT50	NT50-MC42-110L	42	87	110	1"-8	6	3202-008
VB-439		NT50-MC42-110L	42	87	110	M24x3.0P	6.1	3202-009
VB-440	BT50	BT50-MC42-115L	42	87	115	M24x3.0P	6.1	3202-010
VB-441		BT50-MC42-150L	42	87	140	M24x3.0P	7.8	3202-011
VB-442	SK40	SK40-MC32-100L	32	75	100	M16x2.0P	3.1	3202-012
VB-443	SK50	SK50-MC32-105L	32	75	105	M24x3.0P	5.3	3202-013
VB-444A	BT30	BT30-MC20-95	20	52	95	M12x1.75P	1.3	3202-014
VB-446A	BT40	BT40-MC20-80	20	52	80	M16x2.0P	3	3202-016
VB-446B		BT40-MC20-120	20	52	120	M16x2.0P	2.7	3202-017
VB-447A		BT40-MC25-90	25	58	90	M16x2.0P	4.5	3202-018
VB-447B		BT40-MC25-135	25	58	135	M16x2.0P	3.2	3202-019
VB-448A	NT30	NT30-MC20-80	20	52	80	1. M12X1.75P 2. 1/2"-12	1.5	3202-030
VB-448B		NT30-MC25-85	25	58	85	1. M12X1.75P 2. 1/2"-12	1.5	3202-031
VB-451A	SK40	SK40-MC20-80	20	52	80	M16X2.0P	2	3202-035
VB-451B		SK40-MC25-90	25	58	90	M16X2.0P	2	3202-036
VB-452	SK50	SK50-MC42-110	42	87	110	M24X3.0P	5.7	3202-037



# Multi-Lock Milling Chuck



## MULTI-LOCK MILLING CHUCK KIT

Including shank, full set of collets, wrench and case.

**DIN 2080 NT-SHANK**

**MAS 403 BT-SHANK**

**DIN 69871A SK-SHANK**



MILLING CHUCK

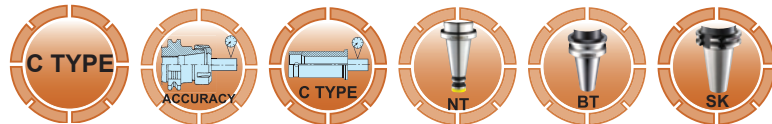

ORDER NO.	TAPER	CHUCK	COLLET	DRAW BAR	KGS	CODE NO.
VB-444I	NT40	NT40-MC32-95L	7PCS	5/8"-11	7	3202-101
VB-444		NT40-MC32-95L	7PCS	M16x2.0P	7	3202-102
VB-454I	NT50	NT50-MC32-100L	7PCS	1"-8	9	3202-103
VB-454		NT50-MC32-100L	7PCS	M24x3.0P	9	3202-104
VB-344A	BT40	BT40-MC32-105L	7PCS	M16x2.0P	7	3202-105
VB-344B		BT40-MC32-150L	7PCS	M16x2.0P	11.5	3202-118
VB-354A	BT50	BT50-MC32-110L	7PCS	M24x3.0P	9.5	3202-106
VB-354B		BT50-MC32-150L	7PCS	M24x3.0P	13	3202-119
VB-554	NT50	NT50-MC42-110L	8PCS	M24x3.0P	12	3202-107
VB-554I		NT50-MC42-110L	8PCS	1"-8	12	3202-108
VB-564A	BT50	BT50-MC42-115L	8PCS	M24x3.0P	12	3202-109
VB-564B		BT50-MC42-150L	8PCS	M24x3.0P	14	3202-109B
VB-565	SK-40	SK40-MC32-100L	7PCS	M16x2.0P	7	3202-110
VB-566	SK-50	SK50-MC32-105L	7PCS	M24x3.0P	9.5	3202-111
VB-567	BT-30	BT30-MC20-95	6PCS	M12x1.75P	6	3202-112
VB-569A	BT-40	BT40-MC20-80	6PCS	M16x2.0P	7	3202-114
VB-569B		BT40-MC20-120	6PCS	M16x2.0P	8	3202-115
VB-570A		BT40-MC25-90	7PCS	M16x2.0P	9.5	3202-116
VB-570B		BT40-MC25-135	7PCS	M16x2.0P	10.5	3202-117
VB-571	NT30	NT30-MC20-80L	6PCS	1. M12X1.75P 2. 1/2"-12	4	3202-120
VB-572		NT30-MC25-85L	7PCS	1. M12X1.75P 2. 1/2"-12	4	3202-121
VB-574	NT40	NT40-MC25-85L	7PCS	1. M16X2.0P 2. 5/8"-11	4.5	3202-123
VB-576	SK40	SK40-MC20-80L	6PCS	M16X2.0P	4.5	3202-125
VB-577		SK40-MC25-90L	7PCS	M16X2.0P	4.8	3202-126
VB-578	SK50	SK50-MC42-110L	8PCS	M24X3.0P	12	3202-127



# C-20,25,32,42 Collet

C-TYPE COLLET

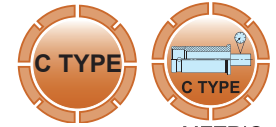

METRIC



C TYPE

## 20, 25, 32, 42 STRAIGHT COLLET

ORDER NO.	COLLET	COLLETS SIZE d INSIDE DIAMETER	D1 O.D.	D2	L	PCS/SET	CODE NO.
C-20-6P	C-20	4, 6, 8, 10, 12, 16	20	25	52	6	3202-180
C-25-7P	C-25	4, 6, 8, 10, 12, 16, 20	25	31	60	7	3202-181
C-32-7P	C-32	6, 8, 10, 12, 16, 20, 25	32	37	73	7	3202-182
C-42-8P	C-42	6, 8, 10, 12, 16, 20, 25, 32	42	48	80	8	3202-183

## 20, 25, 32, 42 STRAIGHT COLLET

INCH

ORDER NO.	COLLET	COLLETS SIZE d INSIDE DIAMETER	D1 O.D.	D2	L	PCS/SET	CODE NO.
C-20-6I	C-20	1/4", 5/16", 3/8", 1/2", 5/8", 3/16"	20	25	52	6	3202-184
C-25-6I	C-25	1/4", 5/16", 3/8", 1/2", 5/8", 3/4"	25	31	60	7	3202-185
C-32-7I	C-32	1/4", 5/16", 3/8", 1/2", 5/8", 3/4", 1"	32	37	73	7	3202-186
C-42-8I	C-42	1/4", 5/16", 3/8", 1/2", 5/8", 3/4", 1", 1 1/4"	42	48	80	8	3202-187



METRIC

ORDER NO.	d	CODE NO.
C-20-4	4	3202-200
C-20-6	6	3202-201
C-20-8	8	3202-202
C-20-10	10	3202-203
C-20-12	12	3202-204
C-20-16	16	3202-205
C-25-4	4	3202-229
C-25-6	6	3202-230
C-25-8	8	3202-231
C-25-10	10	3202-232
C-25-12	12	3202-233
C-25-16	16	3202-234
C-25-20	20	3202-235
C-32-6	6	3202-250
C-32-8	8	3202-251
C-32-10	10	3202-252
C-32-12	12	3202-253
C-32-16	16	3202-254
C-32-20	20	3202-255
C-32-25	25	3202-256
C-42-6	6	3202-280
C-42-8	8	3202-281
C-42-10	10	3202-282
C-42-12	12	3202-283
C-42-16	16	3202-284
C-42-20	20	3202-285
C-42-25	25	3202-286
C-42-32	32	3202-287

INCH

ORDER NO.	d	CODE NO.
C-20-3/16"	3/16"	3202-210
C-20-1/4"	1/4"	3202-211
C-20-5/16"	5/16"	3202-212
C-20-3/8"	3/8"	3202-213
C-20-1/2"	1/2"	3202-214
C-20-5/8"	5/8"	3202-215
C-25-1/4"	1/4"	3202-241
C-25-5/16"	5/16"	3202-242
C-25-3/8"	3/8"	3202-243
C-25-1/2"	1/2"	3202-244
C-25-5/8"	5/8"	3202-245
C-25-3/4"	3/4"	3202-246
C-32-3/16"	3/16"	3202-260
C-32-1/4"	1/4"	3202-261
C-32-5/16"	5/16"	3202-262
C-32-3/8"	3/8"	3202-263
C-32-1/2"	1/2"	3202-264
C-32-5/8"	5/8"	3202-265
C-32-3/4"	3/4"	3202-266
C-32-7/8"	7/8"	3202-267
C-32-1"	1"	3202-268
C-42-1/4"	1/4"	3202-290
C-42-5/16"	5/16"	3202-291
C-42-3/8"	3/8"	3202-292
C-42-1/2"	1/2"	3202-293
C-42-5/8"	5/8"	3202-294
C-42-3/4"	3/4"	3202-295
C-42-7/8"	7/8"	3202-296
C-42-1"	1"	3202-297
C-42-1 1/4"	1 1/4"	3202-298

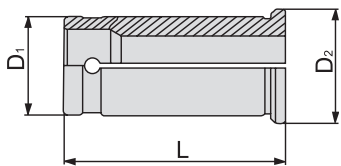

ORDER NO.	WEIGHT
C-20	0.1
C-25	0.18
C-32	0.22
C-42	0.35



# C-20,25,32,42 Wrenches

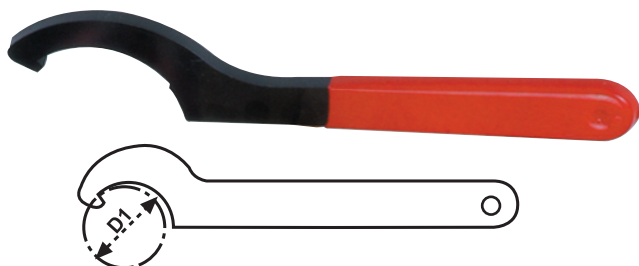

ORDER NO.	L	D	WEIGHT KGS	COLLETS	CODE NO.
C-20W	227	52	0.22	C-20	3202-311
C-25W	227	58	0.22	C-25	3202-312
C-32W	260	75	0.33	C-32	3202-313
C-42W	270	87	0.35	C42	3202-314



# Quick-Change Tooling System



MILLING-QUICK CHANGE HOLDER

OZ DIN 6388

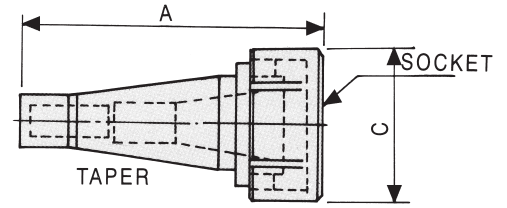

- QUICK-CHANG CHUCK TAPER ACCORDING TO DIN 2080 SPECIFICATION.
- EASY AND FAST CHANGING MILLING CHUCK(HOLDER).
- CHUCK TAPER PRECISELY MACHINED SUITABLE FOR HEAVY CUTTING.
- ALL THE HOLDER SIZE ARE SPECIAL FOR THIS QUICK-CHANGE TOOLING SYSTEM ONLY.



QUICK-CHANGE TOOLING

ORDER NO.	TAPER	SOCKET	A	C	WEIGHT KGS	CODE NO.
VD-103	NT40	NT40	181	89	2.4	3201-003
VD-105	NT50	NT40	175	89	3.8	3201-004

## MILLING-QUICK CHANGE SYSTEM KIT



ORDER NO.	TAPER	SOCKET	FULL SET	WEIGHT KGS	CODE NO.
VD-113	NT40	NT40	1. MILLING QUICK-CHANGE HOLDER 2. DRILL CHUCK HOLDER 3. MORSE TAPER HOLDER 4. FACE MILL HOLDER 5. DIN6388 #25 COLLET CHUCK HOLDER 6. DIN6388 #25 15PCS COLLET 7. WRENCH 8. WOODEN BOX	14	3201-008
VD-115	NT50	NT40		16	3201-009





# TG 100 Collet System



DIN 464E

● PRECISION TG10 COLLET WITHIN 20 MICRON

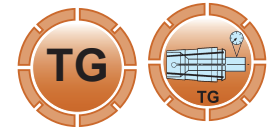
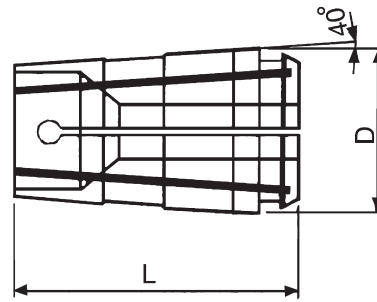

■ RANGE SIZE:1/8"-63/64"

TG-100 ■ D:35 ■ L:61 ■ TAPER:4 ■ WEIGHT:0.2KGS ■ HRC:47°

ORDER NO.	INCH	CODE NO.
TG10-01	1/8"	3204-001
TG10-02	3/6"	3204-002
TG10-03	1/4"	3204-003
TG10-04	5/16"	3204-004
TG10-05	3/8"	3204-005
TG10-06	7/16"	3204-006
TG10-07	1/2"	3204-007
TG10-08	9/16"	3204-008
TG10-09	5/8"	3204-009
TG10-10	11/16"	3204-010
TG10-11	3/4"	3204-011
TG10-12	13/16"	3204-012
TG10-13	7/8"	3204-013
TG10-14	15/16"	3204-014
TG10-15	1"	3204-015
TG10-16	5/32"	3204-016
TG10-17	7/32"	3204-017
TG10-18	9/32"	3204-018
TG10-19	11/32"	3204-019
TG10-20	13/32"	3204-020
TG10-21	15/32"	3204-021
TG10-22	17/32"	3204-022
TG10-23	19/32"	3204-023
TG10-24	21/32"	3204-024
TG10-25	23/32"	3204-025
TG10-26	25/32"	3204-026
TG10-27	27/32"	3204-027
TG10-28	29/32"	3204-028
TG10-29	31/32"	3204-029

ORDER NO.	INCH	CODE NO.
TG10-30	9/64"	3204-030
TG10-31	11/64"	3204-031
TG10-32	13/64"	3204-032
TG10-33	15/64"	3204-033
TG10-34	17/64"	3204-034
TG10-35	19/64"	3204-035
TG10-36	21/64"	3204-036
TG10-37	23/64"	3204-037
TG10-38	25/64"	3204-038
TG10-39	27/64"	3204-039
TG10-40	29/64"	3204-040
TG10-41	31/64"	3204-041
TG10-42	33/64"	3204-042
TG10-43	35/64"	3204-043
TG10-44	37/64"	3204-044
TG10-45	39/64"	3204-045
TG10-46	41/64"	3204-046
TG10-47	43/64"	3204-047
TG10-48	45/64"	3204-048
TG10-49	47/64"	3204-049
TG10-50	49/64"	3204-050
TG10-51	51/64"	3204-051
TG10-52	53/64"	3204-052
TG10-53	55/64"	3204-053
TG10-54	57/64"	3204-054
TG10-55	59/64"	3204-055
TG10-56	61/64"	3204-056
TG10-57	63/64"	3204-057



# 5C Collet System



## 5C RANGE



5C Collet

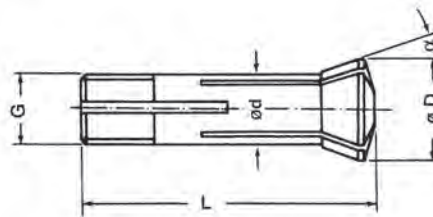

- L:87 ■ D:37.5 ■ G:31.75 ■ Accuracy: ±0.02mm
- α:10° ■ WEIGHT:0.21KGS ■ Hardness: HRC47°

ORDER NO.	Q'TY	RANGE SIZE
5C-□	1 PC	Ø 3, 4, 5, 6, 7, 8, 9, 10, 11, 12, 13, 14, 15, 16, 17, 18, 19, 20, 21, 22, 23, 24, 25MM
5C-□	1 PC	Ø 1/8", 3/16", 1/4", 5/16", 3/8", 7/16", 1/2", 9/16", 5/8", 11/16", 3/4", 13/16", 7/8", 15/16", 1"

### COMPLETE SET AVAILABLE SIZE

ORDER NO.	Q'TY	RANGE SIZE	PACKING	WEIGHT KGS	CODE NO.
VE-102	7PCS	6, 8, 10, 12, 16, 20, 25	CARTON	1.5	3205-100
VE-102I	7PCS	1/4", 5/16", 3/8", 1/2", 5/8", 3/4", 1"	CARTON	1.5	3205-101



### EMERGENCY TYPE SOFT COLLET

ORDER NO.	MATERIAL	kgs	CODE NO.
VE-5CS	STEEL		3205-201
VE-5CB	BRASS	0.35	3205-202
VE-5CN	NYLON		3205-203

● CAN BE MACHINED FOR INSIDE HOLE

ORDER NO.	Ø d	CODE NO.
5C-3	3	3205-001
5C-4	4	3205-002
5C-5	5	3205-003
5C-6	6	3205-004
5C-7	7	3205-005
5C-8	8	3205-006
5C-9	9	3205-007
5C-10	10	3205-008
5C-11	11	3205-009
5C-12	12	3205-010
5C-13	13	3205-011
5C-14	14	3205-012
5C-15	15	3205-013
5C-16	16	3205-014
5C-17	17	3205-015
5C-18	18	3205-016
5C-19	19	3205-017
5C-20	20	3205-018
5C-21	21	3205-019
5C-22	22	3205-020
5C-23	23	3205-021
5C-24	24	3205-022
5C-25	25	3205-023

mm

inch

ORDER NO.	Ø d	CODE NO.
5C-1/8	1/8"	3205-024
5C-3/16	3/16"	3205-025
5C-1/4	1/4"	3205-026
5C-5/16	5/16"	3205-027
5C-3/8	3/8"	3205-028
5C-7/16	7/16"	3205-029
5C-1/2	1/2"	3205-030
5C-9/16	9/16"	3205-031
5C-5/8	5/8"	3205-032
5C-11/16	11/16"	3205-033
5C-3/4	3/4"	3205-034
5C-13/16	13/16"	3205-035
5C-7/8	7/8"	3205-036
5C-15/16	15/16"	3205-037
5C-1	1"	3205-038

COLLET SYSTEM



# R8 Collet System



R8 Collet

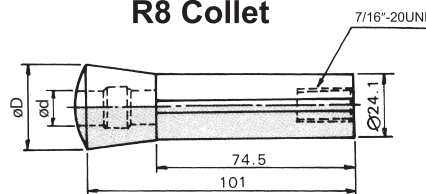

- L:101 ■ D:31.75 ■ Accuracy: ±0.02mm
- G:7/16"-20UNF ■ α:8°30' ■ WEIGHT:0.21KGS ■ Hardness: HRC47°

ORDER NO.	Q'TY	RANGE SIZE
R8-□	1 PC	Ø 3, 4, 5, 6, 7, 8, 9, 10, 11, 12, 13, 14, 15, 16, 17, 18, 19, 20 MM
R8-□	1 PC	Ø 1/8", 3/16", 1/4", 5/16", 3/8", 7/16", 1/2", 9/16", 5/8", 11/16", 3/4"

### COMPLETE SET AVAILABLE SIZE

ORDER NO.	Q'TY	RANGE SIZE	WEIGHT KGS	CODE NO.
VE-110	6PCS	6, 8, 10, 12, 16, 20 MM	1.5	3206-100
VE-114	7PCS	6, 8, 10, 12, 14, 16, 20 MM	1.5	3206-101

### EMERGENCY TYPE SOFT COLLET

ORDER NO.	Q'TY	RANGE SIZE	WEIGHT KGS	CODE NO.
VE-109I	5PCS	1/4", 3/8", 1/2", 5/8", 3/4"	1.1	3206-102
VE-110I	6PCS	1/4", 5/16", 3/8", 1/2", 5/8", 3/4"	1.5	3206-103
VE-114I	7PCS	3/16", 1/4", 5/16", 3/8", 1/2", 5/8", 3/4"	1.5	3206-104

ORDER NO.	Ø d	CODE NO.
R8-3	3	3206-001
R8-4	4	3206-002
R8-5	5	3206-003
R8-6	6	3206-004
R8-7	7	3206-005
R8-8	8	3206-006
R8-9	9	3206-007
R8-10	10	3206-008
R8-11	11	3206-009
R8-12	12	3206-010
R8-13	13	3206-011
R8-14	14	3206-012
R8-15	15	3206-013
R8-16	16	3206-014
R8-17	17	3206-015
R8-18	18	3206-016
R8-19	19	3206-017
R8-20	20	3206-018

mm

inch

ORDER NO.	Ø d	CODE NO.
R8-1/8	1/8"	3206-019
R8-3/16	3/16"	3206-020
R8-1/4	1/4"	3206-021
R8-5/16	5/16"	3206-022
R8-3/8	3/8"	3206-023
R8-7/16	7/16"	3206-024
R8-1/2	1/2"	3206-025
R8-9/16	9/16"	3206-026
R8-5/8	5/8"	3206-027
R8-11/16	11/16"	3206-028
R8-3/4	3/4"	3206-029