



ER Spring Collet Chuck System



Collet Holders With Extension Type BT Taper Shank

ER-16, ER-20

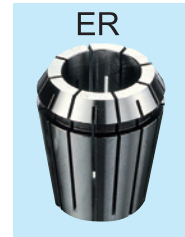

BT-40-ER20

ACCURACY
RUNOUT 0.005mm
TAPER SHANK AT-3
R.P.M. 7000

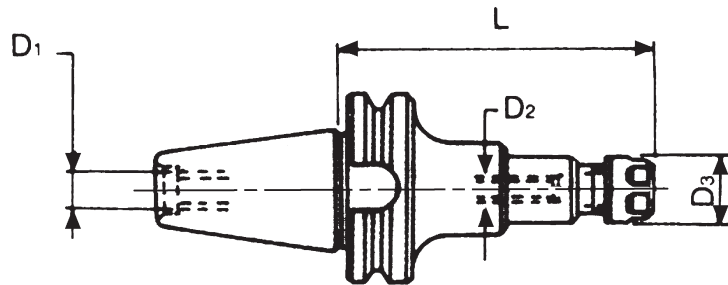

| ORDER NO. | TAPER | COLLET TYPE | D3 | L | D1 | WEIGHT KGS | CODE NO. |
|-----------|-------|-------------|------|------|-----|------------|----------|
| V-770 | BT30 | ER16 | 28 | 60 | M12 | 0.6 | 3031-301 |
| V-772 | BT40 | ER16 | 28 | 70 | M16 | 1.2 | 3032-301 |
| V-773 | | | 28 | 100 | M16 | 1.4 | 3032-302 |
| V-774A | | | 28 | 150 | M16 | 1.7 | 3032-308 |
| V-774 | | | BT40 | ER20 | 34 | 70 | M16 |
| V-775 | 34 | 100 | | | M16 | 1.5 | 3032-304 |
| V-775A | 34 | 135 | | | M16 | 1.6 | 3032-309 |
| V-775B | 34 | 150 | | | M16 | 1.9 | 3032-310 |
| V-775C | BT40 | ER25 | 42 | 150 | M16 | 2.1 | 3032-311 |
| V-733 | BT40 | ER32 | 50 | 150 | M16 | 2 | 3033-354 |
| V-776 | BT50 | ER16 | 28 | 100 | M24 | 2.3 | 3033-301 |
| V-777 | | | 28 | 150 | M24 | 4.3 | 3033-302 |
| V-743A | | | 28 | 200 | M24 | 7.5 | 3033-364 |
| V-778 | BT50 | ER20 | 34 | 100 | M24 | 4.1 | 3033-303 |
| V-779 | | | 34 | 150 | M24 | 4.8 | 3033-304 |
| V-735 | | | 34 | 200 | M24 | 5 | 3033-356 |
| V-736 | BT50 | ER25 | 42 | 100 | M24 | 4.3 | 3033-357 |
| V-737A | | | 42 | 150 | M24 | 4.8 | 3033-358 |
| V-744A | | | 42 | 200 | M24 | 8 | 3033-365 |
| V-738A | BT50 | ER32 | 50 | 150 | M24 | 5.5 | 3033-359 |
| V-739A | | | 50 | 200 | M24 | 6.5 | 3033-360 |
| V-741A | BT50 | ER40 | 63 | 200 | M24 | 7.5 | 3033-362 |
| V-742A | BT50 | ER50 | 78 | 150 | M24 | 6.7 | 3033-363 |



ER Spring Collet Chuck System

**VERTEX**

MAS403 BT-SHANK DIN 6499

ER



Collet Chuck Kit With BT Taper Shank

Including shank, full set of collets, wrench and case.

- 1.ER16, ER20 PACKED IN WOODEN BOX
- 2.ER32, ER40, ER50, PACKED IN PLASTIC BOX
- 3.PACKAGE INCLUDING : CHUCK, COLLET, WRENCH, BOX

Caution:

Please notify the taper size, collet type, set range, and set numbers when ordering.

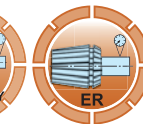

ER SYSTEM

| ORDER NO. | BT TAPER | COLLET TYPE | SET RANGE | COLLET PCS | WEIGHT KGS | CODE NO. |
|-----------|-----------|-------------|-----------|------------|------------|----------|
| V-780 | BT30-60L | ER16 | 1-10 | 10 | 1.9 | 3031-401 |
| V-780A | BT30-100L | ER16 | 1-10 | 10 | 2 | 3031-406 |
| V-781 | BT40-70L | ER16 | 1-10 | 10 | 2.3 | 3032-401 |
| V-782 | BT40-100L | ER16 | 1-10 | 10 | 2.7 | 3032-402 |
| V-783 | BT30-60L | ER20 | 2-13 | 12 | 2.5 | 3031-402 |
| V-783A | BT30-100L | ER20 | 2-13 | 12 | 2.6 | 3032-413 |
| V-783B | BT30-60L | ER25 | 2-16 | 15 | 2.5 | 3032-414 |
| V-783C | BT30-60L | ER25 | 4-16 | 7 | 2.8 | 3032-415 |
| V-784 | BT40-100L | ER20 | 2-13 | 12 | 3 | 3032-403 |
| V-784A | BT40-70L | ER20 | 2-13 | 12 | 2.8 | 3032-416 |
| V-784B | BT40-70L | ER25 | 2-16 | 15 | 3.2 | 3032-417 |
| V-784C | BT40-100L | ER25 | 4-16 | 7 | 3 | 3032-418 |
| V-785 | BT30-60L | ER32 | 3-20 | 18 | 4.4 | 3031-403 |
| V-786 | BT30-60L | ER32 | 4-20 | 11 | 3.8 | 3031-404 |
| V-787 | BT30-60L | ER32 | 6-20 | 6 | 3.4 | 3031-405 |
| V-788 | BT40-70L | ER32 | 3-20 | 18 | 5.2 | 3032-404 |
| V-789 | BT40-70L | ER32 | 4-20 | 11 | 4.2 | 3032-405 |
| V-790 | BT40-70L | ER32 | 6-20 | 6 | 3.8 | 3032-406 |
| V-791 | BT40-100L | ER32 | 3-20 | 18 | 5.7 | 3032-407 |
| V-792 | BT40-100L | ER32 | 4-20 | 11 | 4.7 | 3032-408 |
| V-793 | BT40-100L | ER32 | 6-20 | 6 | 4.3 | 3032-409 |
| V-794 | BT40-80L | ER40 | 4-26 | 23 | 8.9 | 3032-410 |
| V-795 | BT40-80L | ER40 | 4-26 | 15 | 7.6 | 3032-411 |
| V-796 | BT40-80L | ER40 | 6-25 | 7 | 6 | 3032-412 |
| V-797 | BT50-100L | ER40 | 4-26 | 23 | 11.3 | 3033-401 |
| V-798 | BT50-100L | ER40 | 4-26 | 15 | 10 | 3033-402 |
| V-799 | BT50-100L | ER40 | 6-26 | 7 | 8.5 | 3033-403 |
| V-737 | BT50-150L | ER40 | 4-26 | 23 | 12.2 | 3033-404 |
| V-738 | BT50-150L | ER40 | 4-26 | 15 | 11 | 3033-405 |
| V-739 | BT50-150L | ER40 | 6-26 | 7 | 9.5 | 3033-406 |
| V-740 | BT50-100L | ER50 | 12-34 | 12 | 12 | 3033-407 |
| V-740C | BT40-90L | ER50 | 12-34 | 12 | 9 | 3033-408 |
| V-740B | BT50-100L | ER32 | 3-20 | 18 | 7.5 | 3033-409 |



ST/ER Straight Shank With Double Head Spindle



M TYPE DOUBLE HEAD

FOR CNC LATHE ONLY

UM TYPE

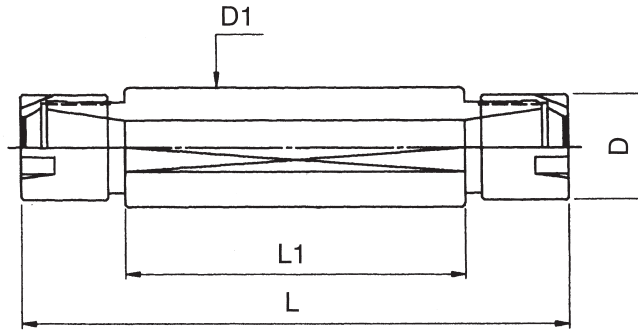

M TYPE

| ORDER NO. | COLLET TYPE | SHANK (ØD1-ER-L1) | L | L1 | D | WEIGHT (KGS) | CODE NO. |
|-----------|-------------|-------------------|-----|----|----|--------------|----------|
| V-830 | ER11 | ø20-ER11M2-50 | 70 | 50 | 16 | 0.2 | 3032-430 |
| V-831 | | ø20-ER11M2-78 | 108 | 78 | 16 | 0.3 | 3032-431 |
| V-832 | ER16 | ø20-ER16M2-50 | 82 | 50 | 22 | 0.2 | 3032-432 |
| V-833 | | ø20-ER16M2-70 | 112 | 70 | 22 | 0.32 | 3032-433 |
| V-834 | ER16 | ø25-ER16M2-50 | 92 | 50 | 22 | 0.25 | 3032-434 |
| V-835 | | ø25-ER16M2-80 | 122 | 80 | 22 | 0.35 | 3032-435 |
| V-836 | ER20 | ø25-ER20M2-50 | 92 | 50 | 28 | 0.3 | 3032-436 |
| V-837 | | ø25-ER20 M2-80 | 122 | 80 | 28 | 0.35 | 3032-437 |

UM TYPE

| ORDER NO. | COLLET TYPE | SHANK (ØD1-ER-L1) | L | L1 | D | WEIGHT (KGS) | CODE NO. |
|-----------|-------------|-------------------|-----|----|----|--------------|----------|
| V-855 | ER11 | ø20-ER11 UM2-50 | 80 | 50 | 19 | 0.15 | 3032-428 |
| V-856 | | ø20-ER11 UM2-70 | 100 | 70 | 19 | 0.19 | 3032-429 |
| V-859 | ER16 | ø25-ER16 UM2-80 | 124 | 80 | 28 | 0.35 | 3032-439 |
| V-862 | ER20 | ø25-ER20 UM2-80 | 134 | 80 | 34 | 0.38 | 3032-438 |



ST/ER Straight Shank With Single Head Spindle

FOR CNC LATHE ONLY

M TYPE SINGLE HEAD

UM TYPE

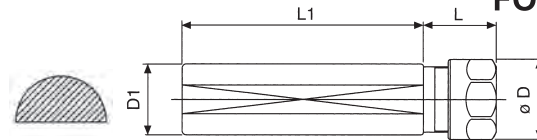

M TYPE SINGLE HEAD

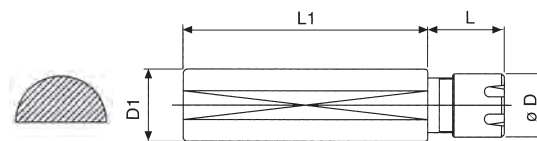

UM TYPE



| ORDER NO. | COLLET TYPE | SHANK (ØD1-ER-L1) | L | L1 | D | WEIGHT (KGS) | CODE NO. |
|-----------|-------------|-------------------|----|----|----|--------------|----------|
| V-841 | ER16 | ø20-ER16M-70 | 21 | 70 | 22 | 0.2 | 3032-441 |
| V-842 | | ø25-ER16M-70 | 21 | 70 | 22 | 0.25 | 3032-442 |
| V-843 | | ø3/4"-ER16M-70 | 21 | 70 | 22 | 0.2 | 3032-443 |
| V-844 | ER16 | ø20-ER16UM-70 | 21 | 70 | 28 | 0.2 | 3032-444 |
| V-845 | | ø25-ER16UM-70 | 21 | 70 | 28 | 0.25 | 3032-445 |
| V-846 | | ø3/4"-ER16UM-70 | 21 | 70 | 28 | 0.2 | 3032-446 |
| V-847 | ER20 | ø22-ER20UM-70 | 23 | 70 | 34 | 0.25 | 3032-447 |
| V-848 | | ø25-ER20UM-70 | 23 | 70 | 34 | 0.3 | 3032-448 |



ER Collet Chuck System



MAS403 BT30/40/50 SHANK

ER

ULTRA PRECISION TYPE
MAX. SPEED: 15,000RPM; G2.5
DYNAMIC BALANCE TESTED

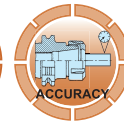

| ORDER NO. | L | ØD | COLLET | WEIGHT (kg) | CODE NO. |
|------------------|-----|----|--------|-------------|----------|
| BT30-ER11-60-B | 60 | 19 | ER11 | 0.5 | 3033-500 |
| BT30-ER11-100-B | 100 | 19 | ER11 | 0.55 | 3033-501 |
| BT30-ER16-60-B | 60 | 28 | ER16 | 0.5 | 3033-502 |
| BT30-ER16-100-B | 100 | 28 | ER16 | 0.7 | 3033-503 |
| BT30-ER20-60-B | 60 | 34 | ER20 | 0.55 | 3033-504 |
| BT30-ER20-100-B | 100 | 34 | ER20 | 0.8 | 3033-505 |
| BT30-ER25-60-B | 60 | 42 | ER25 | 0.6 | 3033-506 |
| BT30-ER32-60-B | 60 | 50 | ER32 | 0.65 | 3033-507 |
| BT40-ER11-70-B | 70 | 19 | ER11 | 1 | 3033-509 |
| BT40-ER11-100-B | 100 | 19 | ER11 | 1.1 | 3033-510 |
| BT40-ER16-70-B | 70 | 28 | ER16 | 1.1 | 3033-511 |
| BT40-ER16-100-B | 100 | 28 | ER16 | 1.2 | 3033-512 |
| BT40-ER20-70-B | 70 | 34 | ER20 | 1.2 | 3033-514 |
| BT40-ER20-100-B | 100 | 34 | ER20 | 1.4 | 3033-515 |
| BT40-ER25-70-B | 70 | 42 | ER25 | 1.2 | 3033-518 |
| BT40-ER25-100-B | 100 | 42 | ER25 | 1.45 | 3033-519 |
| BT40-ER32-70-B | 70 | 50 | ER32 | 1.3 | 3033-521 |
| BT40-ER32-100-B | 100 | 50 | ER32 | 1.5 | 3033-522 |
| BT30-ER11M-100-B | 100 | 16 | ER11 | 0.5 | 3033-523 |
| BT30-ER16M-100-B | 100 | 22 | ER16 | 0.55 | 3033-524 |
| BT30-ER20M-100-B | 100 | 28 | ER20 | 0.65 | 3033-525 |
| BT40-ER11M-100-B | 100 | 16 | ER11 | 1.05 | 3033-526 |
| BT40-ER16M-100-B | 100 | 22 | ER16 | 1.1 | 3033-527 |
| BT40-ER20M-100-B | 100 | 28 | ER20 | 1.2 | 3033-528 |

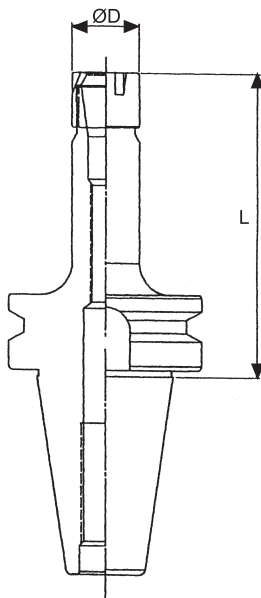
**ER SYSTEM**



ER-SK Taper Shank



COLLET HOLDER WITH SK-SHANK
DIN 69871

ER

& COLLET CHUCK SET DIN 69871

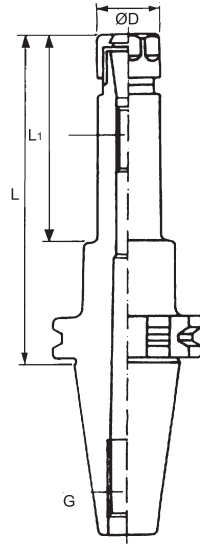
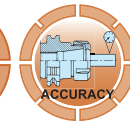

| ORDER NO. | COLLET TYPE | TAPER | D | L | G | WEIGHT KGS | CODE NO. |
|-----------|-------------|-------|----|-----|-----|------------|----------|
| V-741 | ER16 | SK40 | 28 | 100 | M16 | 1.5 | 3029-301 |
| V-741K | ER16 | SK30 | 28 | 60 | M12 | 0.45 | 3029-311 |
| V-741B | ER16 | SK50 | 28 | 100 | M24 | 3.5 | 3029-317 |
| V-742 | ER20 | SK40 | 34 | 100 | M16 | 1.5 | 3029-302 |
| V-742C | ER16 | SK40 | 28 | 70 | M16 | 1.1 | 3029-315 |
| V-742D | ER20 | SK40 | 34 | 70 | M16 | 1.2 | 3029-316 |
| V-742E | ER20 | SK50 | 34 | 100 | M24 | 3.5 | 3029-318 |
| V-744 | ER20 | SK50 | 34 | 150 | M24 | 4.8 | 3030-302 |

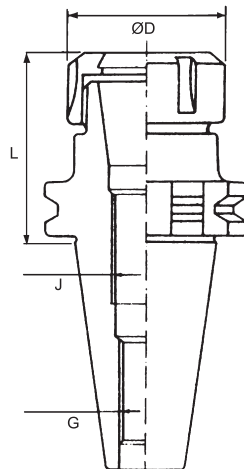

| ORDER NO. | COLLET TYPE | TAPER | D | L | G | WEIGHT KGS | CODE NO. |
|-----------|-------------|-------|----|-----|-----|------------|----------|
| V-745 | ER32 | SK40 | 50 | 70 | M16 | 1.2 | 3029-303 |
| V-745A | ER32 | SK30 | 50 | 60 | M12 | 0.8 | 3029-314 |
| V-745B | ER32 | SK50 | 50 | 100 | M24 | 3.7 | 3029-320 |
| V-746 | ER40 | SK40 | 63 | 80 | M16 | 1.6 | 3029-304 |
| V-747 | ER40 | SK50 | 63 | 100 | M24 | 4.2 | 3030-303 |
| V-749 | ER25 | SK40 | 42 | 70 | M16 | 1.1 | 3030-304 |
| V-749A | ER25 | SK50 | 42 | 100 | M24 | 3.4 | 3029-319 |

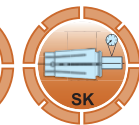

COLLET CHUCK KIT WITH SK-SHANK DIN 69871

INCLUDING SHANK, FULL SET OF COLLETS, WRENCH AND CASE.

ER



| ORDER NO. | ER TYPE | SK TAPER | SET RANGE | SET PCS | WEIGHT KGS | CODE NO. |
|-----------|---------|-----------|-----------|---------|------------|----------|
| V-751 | ER16 | SK40-70L | 1-10 | 10PCS | 2.3 | 3029-401 |
| V-751A | ER16 | SK30-60L | 1-10 | 10PCS | 1.8 | 3029-420 |
| V-752 | ER20 | SK40-70L | 2-13 | 12PCS | 3 | 3029-402 |
| V-753 | ER32 | SK40-70L | 3-20 | 18PCS | 5.2 | 3029-403 |
| V-754 | ER32 | SK40-70L | 4-20 | 11PCS | 4.2 | 3029-404 |
| V-754A | ER32 | SK30-60L | 3-20 | 18PCS | 4.2 | 3029-423 |
| V-754B | ER32 | SK50-100L | 3-20 | 18PCS | 7 | 3029-424 |
| V-755 | ER32 | SK40-70L | 6-20 | 6PCS | 3.8 | 3029-405 |
| V-756 | ER40 | SK40-80L | 4-26 | 23PCS | 8.9 | 3029-406 |
| V-757 | ER40 | SK40-80L | 4-26 | 15PCS | 7.6 | 3029-407 |
| V-758 | ER40 | SK40-80L | 6-25 | 7PCS | 6 | 3029-408 |
| V-759 | ER40 | SK50-100L | 4-26 | 23PCS | 11.3 | 3030-401 |
| V-760 | ER40 | SK50-100L | 4-26 | 15PCS | 10 | 3030-402 |
| V-761 | ER40 | SK50-100L | 6-26 | 7PCS | 8.5 | 3030-403 |
| V-762 | ER25 | SK40-70L | 2-16 | 15PCS | 3.5 | 3029-409 |
| V-763 | ER25 | SK40-70L | 4-26 | 7PCS | 3.2 | 3029-410 |

ER16, ER20 PACKED IN WOODEN CASE
ER32, ER40 PACKED IN PLASTIC CASE



ER Spring Collet Chuck System



COLLET HOLDER WITH CAT-SHANK

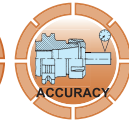
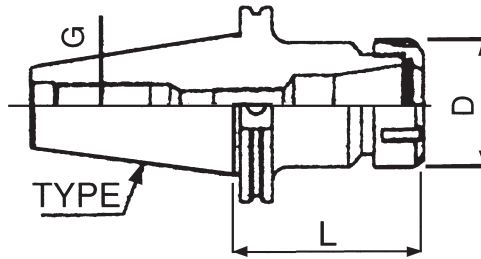

| ORDER NO. | COLLET TYPE | TAPER | D | L | G | WEIGHT KGS | CODE NO. |
|-----------|-------------|-------|-------|--------|---------|------------|----------|
| V-870 | ER16 | CAT30 | 28 | 2" | 1/2"-13 | 0.8 | 3034-301 |
| V-871 | ER16 | CAT40 | 28 | 3" | 5/8"-11 | 1.1 | 3035-301 |
| V-872 | ER20 | | 34 | 3" | | 1.2 | 3035-302 |
| V-873 | ER25 | | 42 | 2-1/2" | | 1.2 | 3035-303 |
| V-874 | ER32 | | 50 | 2-1/2" | | 1.2 | 3035-304 |
| V-875 | ER40 | | 63 | 3" | | 1.5 | 3035-305 |
| V-876 | ER40 | | CAT50 | 63 | | 3-1/2" | 1/8" |

COLLET CHUCK KIT WITH CAT-SHANK

INCLUDING SHANK, FULL SET OF COLLET, WRENCH AND CASE.

1. ER16, ER20, ER25 PACKED IN WOODEN BOX.
2. ER32, ER40, PACKED IN PLASTIC BOX.
3. PACKAGE INCLUDING: CHUCK, COLLET, WRENCH, BOX.



| ORDER NO. | COLLET TYPE | CAT TAPER | SET RANGE | SET PCS | WEIGHT KGS | CODE NO. |
|-----------|-------------|---------------|-----------|---------|------------|----------|
| V-878 | ER16 | CAT40-3"L | 1.0-10 | 10 | 2.3 | 3035-401 |
| V-879 | ER20 | CAT40-3"L | 2.0-13 | 12 | 2.5 | 3035-402 |
| V-880 | ER25 | CAT40-2 1/2"L | 2.0-16 | 15 | 3 | 3035-403 |
| V-881 | | CAT40-2 1/2"L | 4.0-16 | 7 | 2.8 | 3035-404 |
| V-882 | ER32 | CAT40-2 1/2"L | 3.0-20 | 18 | 5.2 | 3035-405 |
| V-883 | | CAT40-2 1/2"L | 4.0-20 | 11 | 4.2 | 3035-406 |
| V-884 | | CAT40-2 1/2"L | 6.0-20 | 6 | 3.8 | 3035-407 |
| V-885 | ER40 | CAT40-3"L | 4.0-26 | 23 | 8.9 | 3035-408 |
| V-886 | | CAT40-3"L | 4.0-26 | 15 | 7.6 | 3035-409 |
| V-887 | | CAT40-3"L | 6.0-25 | 7 | 6 | 3035-410 |
| V-888 | ER40 | CAT50-3 1/2"L | 4.0-26 | 23 | 11.2 | 3036-401 |
| V-889 | | CAT50-3 1/2"L | 4.0-26 | 15 | 9.8 | 3036-402 |
| V-890 | | CAT50-3 1/2"L | 6.0-25 | 7 | 8.3 | 3036-403 |

ER SYSTEM



Milling Chuck



COLLET HOLDER WITH #25
COLLET CHUCK DIN 6388 TYPE A
OZ-25

DIN 6388 # 25 SERIES
DIN 2080 NT-SHANK



VB-MT40



VB-MT3



VB-R8



OZ-25 SERIES

1. Best selected quality tool steel hardened & Precision ground.
2. Accuracy of concentric to within 0.008" per inch. (0.02mm per 25 mm)
3. High rigidity & Clamping force.
4. 1 set including : 1 chuck shank holder
1 wrench ; 1 case.
7 or 15 pcs of collet.

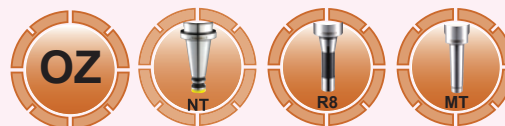

CHUCK SHANK ONLY

| ORDER NO. | CHUCK SHANK | DRAW BAR THREADS | | WEIGHT(kg) | | MEAS. CFT | CODE NO. |
|-----------|-------------|------------------|-----------|------------|--------|-----------|----------|
| | | SAE | METRIC | SAE | METRIC | | |
| VB-MT-2 | MT2 | | M10X1.5P | 1 | 1 | 0.3 | 3101-001 |
| VB-MT-3 | MT3 | 3/8"-16 | M10X1.5P | 1.1 | 1 | 0.3 | 3101-002 |
| | | 1/2"-12 | M12X1.75P | | | | |
| | | 1/2"-13 | M12X1.75P | | | | |
| VB-MT-4 | MT4 | 5/8"-11 | M16X2.0P | | 1.4 | 0.3 | 3101-003 |
| VB-MT-5 | MT5 | 1"-8 | M24X3.0P | | 2 | 0.5 | 3101-004 |
| VB-R8 | R-8 | 7/16"-20 | | 1.3 | | 0.3 | 3101-005 |
| VB-NT30 | NT30 | 1/2"-12 | M12X1.75P | 1.1 | 1.1 | 0.3 | 3101-006 |
| | | 1/2"-13 | M12X1.75P | | | | |
| VB-NT40 | NT40 | 5/8"-11 | M16X2.0P | 1.5 | 1.5 | 0.3 | 3101-007 |
| VB-NT50 | NT50 | 1"-8 | M24X3.0P | 3.4 | 3.4 | 0.5 | 3101-008 |

Please Notify the Draw Bar Thread Size When ordering.



Milling Collet Chuck Kit



INCLUDING SHANK, FULL SET OF COLLETS, WRENCH AND CASE, COOLET CHUCK KIT

DIN 6388 OZ-25 TYPE



VB-MT3



VB-R8



OZ-25



DIFFERENT SHANK STYLE

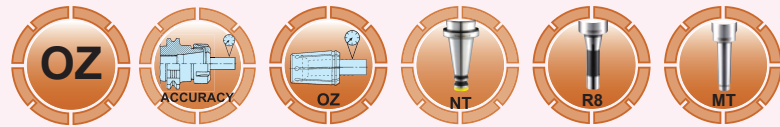

FULL SET

| ORDER NO. | COLLETS SIZE OZ-25 | | PCS | WEIGHT (KGS) | CODE NO. |
|-----------|--------------------|---|-----|--------------|----------|
| | TAPER | COLLETS | | | |
| VB-101 | NT30 | Inch 1/8"-1" 15PCS 1/4"-1" 7PCS Metric 3mm-25mm 15pcs 6mm-25mm 7pcs | 7 | 3.7 | 3101-101 |
| VB-102 | | | 15 | 5.2 | 3101-102 |
| VB-103 | NT40 | | 7 | 4 | 3101-103 |
| VB-104 | | | 15 | 5.5 | 3101-104 |
| VB-105 | NT50 | | 7 | 6.5 | 3101-105 |
| VB-106 | | | 15 | 8.5 | 3101-106 |
| VB-107 | MT3 | | 7 | 3.3 | 3101-107 |
| VB-108 | | | 15 | 5.2 | 3101-108 |
| VB-109 | MT4 | | 7 | 3.9 | 3101-109 |
| VB-110 | | | 15 | 5.4 | 3101-110 |
| VB-111 | MT5 | | 7 | 4.7 | 3101-111 |
| VB-112 | | | 15 | 6.2 | 3101-112 |
| VB-113 | R8 | | 7 | 3.7 | 3101-113 |
| VB-114 | | | 15 | 5.2 | 3101-114 |
| VB-115 | MT2 | | 7 | 3.6 | 3101-115 |
| VB-116 | | 15 | 5.1 | 3101-116 | |

NEW

Please Notify the Type Size, Collet Type, Set Range, and Set Numbers When Ordering.

CONTENT COLLET SET SIZE

| | | |
|------------|------|--|
| 7 PCS/SET | MM | 6, 8, 10, 12, 16, 20, 25MM |
| | INCH | 1/4", 5/16", 3/8", 1/2", 5/8", 3/4", 1"v |
| 15 PCS/SET | MM | 3, 4, 5, 6, 7, 8, 9, 10, 11, 12, 13, 16, 18, 20, 25MM |
| | INCH | 1/8", 3/16", 1/4", 5/16", 3/8", 7/16", 1/2", 9/16", 5/8", 11/16", 3/4", 13/16", 7/8", 15/16", 1" |

OZ SYSTEM



DIN 6388 Collet For Milling Chuck

COLLET DIN 6388, TYPE A

DIN 6388 #16,#25,#32 SERIES

COLLET MUST BE ASSEMBLED INTO THE CLAMPING NUT BEFORE INSERTING INTO THE CHUCK

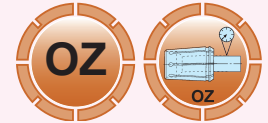
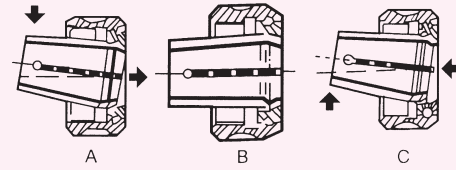
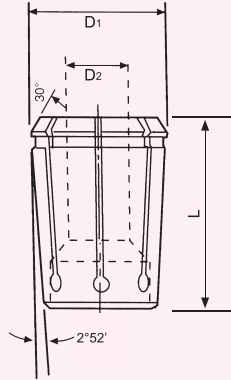

METRIC

| ORDER NO. | D1 | L | D2(MM) |
|-----------|-------|----|---|
| OZ-25-□ | 35.05 | 52 | 3, 4, 5, 6, 7, 8, 9, 10, 11, 12, 13, 14, 15, 16, 18, 20, 25 |
| OZ-32-□ | 44 | 60 | 6, 8, 10, 12, 16, 20, 25, 32 |

INCH

| ORDER NO. | D1 | L | D2(INCH) |
|-----------|-------|----|---|
| OZ-25-□ | 35.05 | 52 | 1/8", 3/16", 1/4", 5/16", 3/8", 7/16", 1/2", 9/16", 5/8", 11/16", 3/4", 13/16", 7/8", 15/16", 1" |
| OZ-32-□ | 43.7 | 60 | 1/4", 5/16", 3/8", 7/16", 1/2", 9/16", 5/8", 11/16", 3/4", 13/16", 7/8", 15/16", 1", 1 1/8", 1 1/4" |

■ RANGE SIZE:3-25(1/8"-1")

OZ-25 ■ D:35.05 ■ L:52 ■ TAPER:1:10 ■ WEIGHT:0.18KGS

| ORDER NO. | MM SIZE | CODE NO. |
|-----------|---------|----------|
| OZ-2503 | 3.0 | 3100-101 |
| OZ-2504 | 4.0 | 3100-102 |
| OZ-2505 | 5.0 | 3100-103 |
| OZ-2506 | 6.0 | 3100-104 |
| OZ-2507 | 7.0 | 3100-105 |
| OZ-2508 | 8.0 | 3100-106 |
| OZ-2509 | 9.0 | 3100-107 |
| OZ-2510 | 10 | 3100-108 |
| OZ-2511 | 11 | 3100-109 |
| OZ-2512 | 12 | 3100-110 |
| OZ-2513 | 13 | 3100-111 |
| OZ-2514 | 14 | 3100-112 |
| OZ-2515 | 15 | 3100-113 |
| OZ-2516 | 16 | 3100-114 |
| OZ-2517 | 17 | 3100-115 |
| OZ-2518 | 18 | 3100-116 |
| OZ-2519 | 19 | 3100-117 |
| OZ-2520 | 20 | 3100-118 |
| OZ-2521 | 21 | 3100-119 |
| OZ-2522 | 22 | 3100-120 |
| OZ-2523 | 23 | 3100-121 |
| OZ-2524 | 24 | 3100-122 |
| OZ-2525 | 25 | 3100-123 |

| ORDER NO. | INCH SIZE | CODE NO. |
|-----------|-----------|----------|
| OZ-2526 | 1/8" | 3100-124 |
| OZ-2527 | 3/16" | 3100-125 |
| OZ-2528 | 1/4" | 3100-126 |
| OZ-2529 | 5/16" | 3100-127 |
| OZ-2530 | 3/8" | 3100-128 |
| OZ-2531 | 7/16" | 3100-129 |
| OZ-2532 | 1/2" | 3100-130 |
| OZ-2533 | 9/16" | 3100-131 |
| OZ-2534 | 5/8" | 3100-132 |
| OZ-2535 | 11/16" | 3100-133 |
| OZ-2536 | 3/4" | 3100-134 |
| OZ-2537 | 13/16" | 3100-135 |
| OZ-2538 | 7/8" | 3100-136 |
| OZ-2539 | 15/16" | 3100-137 |
| OZ-2540 | 1" | 3100-138 |



DIN 6388 Collet For Milling Chuck



COLLET DIN 6388, TYPE A

DIN 6388 #16,#25,#32 SERIES

COLLET MUST BE ASSEMBLED INTO THE CLAMPING NUT BEFORE INSERTING INTO THE CHUCK

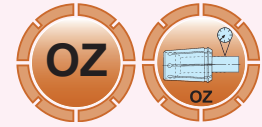

DIN6388 32# ■ RANGE SIZE:6-32(1/4"-1 1/4")
 OZ-32 ■ D:43.7 ■ L:60 ■ TAPER:1:10
 ■ WEIGHT:0.25KGS

| ORDER NO. | MM SIZE | CODE NO. |
|-----------|---------|----------|
| OZ-3206 | 6.0 | 3100-201 |
| OZ-3207 | 7.0 | 3100-202 |
| OZ-3208 | 8.0 | 3100-203 |
| OZ-3209 | 9.0 | 3100-204 |
| OZ-3210 | 10 | 3100-205 |
| OZ-3211 | 11 | 3100-206 |
| OZ-3212 | 12 | 3100-207 |
| OZ-3213 | 13 | 3100-208 |
| OZ-3214 | 14 | 3100-209 |
| OZ-3215 | 15 | 3100-210 |
| OZ-3216 | 16 | 3100-211 |
| OZ-3217 | 17 | 3100-212 |
| OZ-3218 | 18 | 3100-213 |
| OZ-3219 | 19 | 3100-214 |
| OZ-3220 | 20 | 3100-215 |
| OZ-3221 | 21 | 3100-216 |
| OZ-3222 | 22 | 3100-217 |
| OZ-3223 | 23 | 3100-218 |
| OZ-3224 | 24 | 3100-219 |
| OZ-3225 | 25 | 3100-220 |
| OZ-3226 | 26 | 3100-221 |

| ORDER NO. | INCH SIZE | CODE NO. |
|-----------|-----------|----------|
| OZ-3227 | 27 | 3100-222 |
| OZ-3228 | 28 | 3100-223 |
| OZ-3229 | 29 | 3100-224 |
| OZ-3230 | 30 | 3100-225 |
| OZ-3231 | 31 | 3100-226 |
| OZ-3232 | 32 | 3100-227 |
| OZ-3233 | 1/4" | 3100-228 |
| OZ-3234 | 5/16" | 3100-229 |
| OZ-3235 | 3/8" | 3100-230 |
| OZ-3236 | 7/16" | 3100-231 |
| OZ-3237 | 1/2" | 3100-232 |
| OZ-3238 | 9/16" | 3100-233 |
| OZ-3239 | 5/8" | 3100-234 |
| OZ-3240 | 11/16" | 3100-235 |
| OZ-3241 | 3/4" | 3100-236 |
| OZ-3242 | 13/16" | 3100-237 |
| OZ-3243 | 7/8" | 3100-238 |
| OZ-3244 | 15/16" | 3100-239 |
| OZ-3245 | 1" | 3100-240 |
| OZ-3246 | 1-1/8" | 3100-241 |
| OZ-3247 | 1-1/4" | 3100-242 |

OZ SYSTEM



DIN 6388 Nuts & Wrench

BALL BEARING, NUTS FOR COLLETS DIN6388, TYPE A

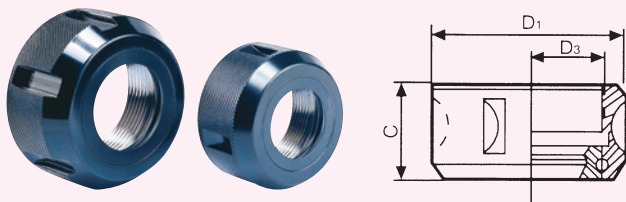

Unit:mm

| ORDER NO. | C | D1 | D3 | COLLETS | WEIGHT kgs | CODE NO. |
|-----------|----|----|---------|---------|------------|----------|
| OZ-25N | 33 | 60 | M48X2 | OZ-25 | 0.3 | 3100-301 |
| OZ-32N | 40 | 72 | M60X2.5 | OZ-32 | 0.7 | 3100-302 |

WRENCH FOR COLLETS DIN6388 TYPE A

Unit:mm



| ORDER NO. | D1 | COLLETS | WEIGHT kgs | CODE NO. |
|-----------|----|---------|------------|----------|
| OZ-25W | 60 | OZ-25 | 0.35 | 3100-310 |
| OZ-32W | 72 | OZ-32 | 0.4 | 3100-311 |