

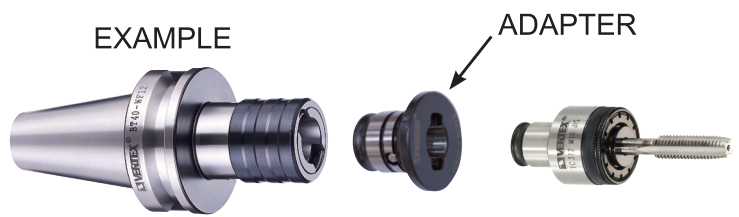

# Tapping Collet Reducer Adapter



This adapter is for transforming  
This adapter allows the tapping chuck to use smaller size.  
Transforming the big tapping size to smaller one.  
large range type for tap M3~M24, TC312, TC820, TC1433  
COST SAVING!

## SIZE CONVERTER

ORDER NO.	TRANSFORMING SIZE	WIGHT	CODE NO.
TC820/TC312-AD	TC820 TO TC312	0.2	3404-461
TC1433/TC820-AD	TC1433 TO TC820	0.6	3404-462

※ Every tap needs a match size tapping collet.



# Adjustable Wrenches

For Tapping Collet's Torque Force Adjustment

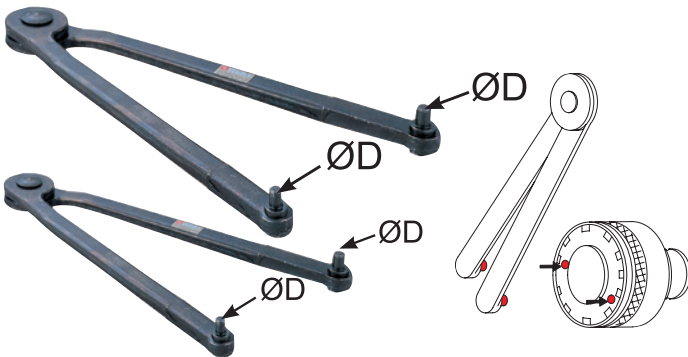

- Tool for Setting
- Time Saving

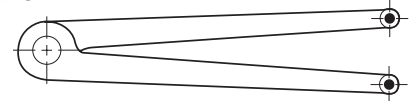

EXAMPLE



ORDER NO.	SIZE	ØD	COLLETS	WEIGHT	CODE NO.
VWR-40	7-40	2.5	TC-820	0.15 kgs	3404-150
VWR-60	11-60	4	TC-1433	0.15 kgs	3404-151



# Quick Change Tapping Collet TC312 8PCS/SET

ORDER NO. TC-312-DIN371-A

CODE NO. 3404-175



**QUICK CHANGE TAP COLLETS**  
(with overload safety collet)



TC-312 DIN371 8PCS/SET  
(M1, M2, M3, M3.5, M4, M4.5, M8, M10)

NO.	ØD X □ SIZE SAME AS DIN371 TC312
1	M1, M1.1~M1.8
2	M2, M2.5, M2~M2.5
3	M3
4	M3.5
5	M4
6	M4.5, M5, M6
7	M8
8	M10



# Quick Change Tapping Collet TC312 8PCS/SET

ORDER NO. TC-312-DIN376-B

CODE NO. 3404-176



**QUICK CHANGE TAP COLLETS**  
(with overload safety collet)



TC-312 DIN376 8PCS/SET  
(M4, M5, M6, M7, M8, M10, M12 M14)

NO.	ØD X □ SIZE SAME AS DIN376 TC312
1	M4
2	M5, M4.5
3	M6
4	M7
5	M8
6	M10
7	M12
8	M14



# Quick Change Tapping Collet TC820 8PCS/SET



ORDER NO. TC820-DIN 376-C

CODE NO. 3404-177



**QUICK CHANGE TAP COLLETS**  
(with overload safety collet)



**TC-820 DIN376 8PCS/SET**  
(M8, M10, M12, M14, M16, M18, M20, M22)

NO.	ØD X □ SIZE SAME AS DIN376 TC820
1	M8
2	M10
3	M12
4	M14
5	M16
6	M18
7	M20
8	M22, M24



# Quick Change Tapping Collet TC820 4PCS/SET

ORDER NO. TC820-DIN 371-D

CODE NO. 3404-178



**QUICK CHANGE TAP COLLETS**  
(with overload safety collet)



**TC-820 DIN371 4PCS/SET**  
(M5, M6, M8, M10)

NO.	ØD X □ SIZE SAME AS DIN371 TC820
1	M5, M6
2	M6, M5
3	M8
4	M10



# Quick Change Tapping Collet TC820 8PCS/SET

ORDER NO. TC820-ISO2283-E

CODE NO. 3404-179



**QUICK CHANGE TAP COLLETS**  
(with overload safety collet)



**TC-820 ISO2283 8PCS/SET**  
(M8, M10, M12, M14, M16, M18, M22, M24)

NO.	ØD X □ SIZE SAME AS ISO2283 TC820
1	M8
2	M10
3	M12
4	M14
5	M16
6	M18, M20
7	M22
8	M24

TAPPING CHUCKS



# Quick Change Tapping Collet



**QUICK CHANGE TAP COLLETS**  
(with overload safety collet)

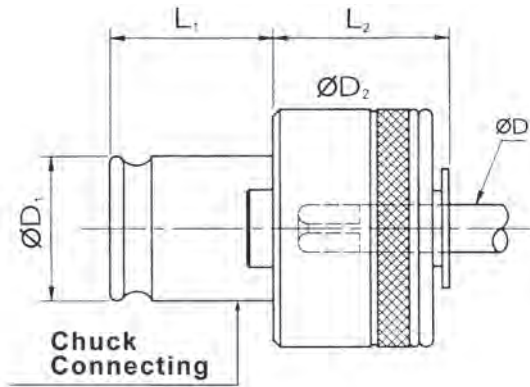

CHUCK SUIT FOR DIA. ØD1  
TC-312,312B IS Ø19 MM  
TC-820,820B IS Ø31 MM  
TC-1433,1433B IS Ø48 MM

- Torque is factory-set to protect the tap. Small adjustments can be made by a trained user to accommodate tap strength and material variations.
- Collet stops driving when set torque is exceeded.
- Every tap needs a match size tapping collet.
- ØD1 is chuck suit for dia.

Tapping Collet  
Reducer / Adapter

This adapter is for transforming  
This adapter allows the VAT-tapping spindle to use smaller size.  
Transforming the big tapping size to smaller one.

Large range type for tap M3~M24,  
TC312, TC820, TC1433  
COST SAVING!  
Please see the page C121



## Connecting Size List

**QUICK CHANGE TAP COLLETS**  
(with overload safety collet)



1PC ≙ 0.18kg

**JIS SYSTEM SIZE** ※ORDER NO. SAME COLOR ARE INTER-CHANGEABLE

Size	Thread	Tap Shank		Ø D1	L1	L2	ORDER NO.	CODE NO.	ØD x □ Size same as JIS inch or mm
		ØD	□						
TC 312 (#1)	M2	3	2.5	Suit for DIA. 19	22	25	<b>312-00</b>	3404-200A	
	M3	4	3.2				<b>312-01</b>	3404-200	W1/8"
	M4	5	4				<b>312-02</b>	3404-201	M4.5
	M5	5.5	4.5				<b>312-03</b>	3404-202	M5.5, W3/16"
	M6	6	4.5				<b>312-04</b>	3404-203	W1/4", UNC1/4"
	M7	6.2	5				<b>312-05</b>	3404-204	M8
	M8	6.2	5				<b>312-06</b>	3404-205	M7
	M9	7	5.5				<b>312-07</b>	3404-206	M10, W3/8", UNC3/8"
	M10	7	5.5				<b>312-08</b>	3404-207	M9, W3/8", UNC3/8"
	M11	8	6				<b>312-09</b>	3404-208	W7/16", PT1/8", PS1/8", PF1/8", UNC7/16"
	M12	8.5	6.5				<b>312-10</b>	3404-209	
	•M14	10.5	8				<b>•312-11</b>	3404-210	M15, W9/16", UNC9/16"
	•M15	10.5	8				<b>•312-12</b>	3404-211	M14, W9/16", UNC9/16"
	UNC 1/4	6	4.5				<b>312-13</b>	3404-212	M6, W1/4"
	UNC 5/16	6.1	5				<b>312-14</b>	3404-213	
	UNC 3/8	7	5.5				<b>312-15</b>	3404-214	M9, M10, W3/8"
	UNC 7/16	8	6				<b>312-16</b>	3404-215	M11, W7/16", PT1/8", PS1/8", PF1/8"
	UNC 1/2	9	7				<b>312-17</b>	3404-216	W1/2"
	•UNC 9/16	10.5	8				<b>•312-18</b>	3404-217	M14, M15, W9/16"
	PT 1/8	8	6				<b>312-19</b>	3404-218	M11, W7/16, PS1/8", PF1/8", UNC7/16"
PT 1/4	11	9	<b>312-20</b>	3404-219	PS1/4, PF1/4				



# Matching Size List



## JIS SYSTEM SIZE

※ORDER NO. SAME COLOR ARE INTER-CHANGEABLE

1PC ≒ 0.6kg

Size	Thread	Tap Shank		ØD1	L1	L2	ORDER NO.	CODE NO.	ØD x □ Size same as JIS inch or mm
		ØD	□						
TC820 (#2)	M6	6	4.5	Suit for DIA. 31	36	30.5	820-00A	3404-228	W1/4", UNC1/4"
	M7	6.2	5				820-01	3404-230	M8
	M8	6.2	5				820-02	3404-231	M7
	M9	7	5.5				820-03	3404-232	M10, W3/8", UNC3/8"
	M10	7	5.5				820-04	3404-233	M9, W3/8", UNC3/8"
	M11	8	6				820-05	3404-234	W7/16", UNC7/16", PT1/8", PS1/8", PF1/8"
	M12	8.5	6.5				820-06	3404-235	
	M14	10.5	8				820-07	3404-226	M15, W9/16", UNC9/16"
	M15	10.5	8				820-08	3404-237	M14, W9/16", UNC9/16"
	M16	12.5	10				820-09	3404-238	
	M18	14	11				820-11	3404-240	W3/4", PT3/8", PS3/8", PF3/8", UNC3/4"
	M20	15	12				820-12	3404-241	
	M22	17	13				820-13	3404-242	W7/8", UNC7/8"
	UNC 3/8	7	5.5				820-14	3404-243	M9, M10, W3/8"
	UNC 7/16	8	6				820-15	3404-244	M11, W7/16", PT1/8", PS1/8", PF1/8"
	UNC 1/2	9	7				820-16	3404-245	W1/2"
	UNC 9/16	10.5	8				820-17	3404-246	M14, M15, W9/16"
	UNC 5/8	12	9				820-18	3404-247	W5/8"
	UNC 3/4	14	11				820-19	3404-248	M18, W3/4", PT3/8", PS3/8", PF3/8"
	UNC 7/8	17	13				820-20	3404-249	M22, W7/8"
	PT 1/8	8	6				820-21	3404-250	M11, W7/16", UNC7/16", PS1/8", PF1/8"
	PT 1/4	11	9				820-22	3404-251	PS1/4", PF1/4"
	PT 3/8	14	11				820-23	3404-252	M18, W3/4", PS3/8", PF3/8", UNC3/4"
	PT 1/2	18	14				820-24	3404-253	PS1/2", PF1/2"
	M24	19	15				820-25	3404-254	M25, PF5/8"

TAPPING CHUCKS

## JIS SYSTEM SIZE

※ORDER NO. SAME COLOR ARE INTER-CHANGEABLE

1PC ≒ 1.8kg

Size	Thread	Tap Shank		ØD1	L1	L2	ORDER NO.	CODE NO.	ØD x □ Size same as JIS inch or mm
		ØD	□						
TC 1433 (#3)	M14	10.5	8	Suit for DIA. 48	56	45	1433-01	3404-260	M15, W9/16", UNC9/16"
	M15	10.5	8				1433-02	3404-261	M14, W9/16", UNC9/16"
	M16	12.5	10				1433-03	3404-262	
	M18	14	11				1433-05	3404-264	W3/4", UNC3/4", PT3/8", PS3/8", PF3/8"
	M20	15	12				1433-06	3404-265	
	M22	17	13				1433-07	3404-266	W7/8", UNC7/8"
	M24	19	15				1433-08	3404-267	M25, PF5/8"
	M25	19	15				1433-09	3404-268	M24, PF5/8"
	M26	20	15				1433-10	3404-269	M27, W1", UNC1"
	M27	20	15				1433-11	3404-270	M26, W1", UNC1"
	M28	21	17				1433-12	3404-271	
	M30	23	17				1433-13	3404-272	PT3/4", PS3/4", PF3/4"
	M32	24	19				1433-14	3404-273	W1-1/4", PF7/8", UNC1-1/4"
	M33	25	19				1433-15	3404-274	
	M34	26	21				1433-16	3404-275	M35, W1-3/8", PT1", PS1", PF1", UNC1-3/8"
	M35	26	21				1433-17	3404-276	M34, W1-3/8", PT1", PS1", PF1", UNC1-3/8"
	M36	28	21				1433-18	3404-277	
	UNC 9/16	10.5	8				V433-19	3404-278	M14, M15, W9/16"
	UNC 5/8	12	9				1433-20	3404-279	
	UNC 3/4	14	11				1433-21	3404-280	M18, W3/4", PT3/8", PS3/8", PF3/8"
	UNC 7/8	17	13				1433-22	3404-281	M22, W7/8"
	UNC 1	20	15				1433-23	3404-282	M26, M27, W1"
	UNC 1 1/8	22	17				1433-24	3404-283	
	UNC 1 1/4	24	19				1433-25	3404-284	M32, W1-1/4", PF7/8"
	UNC 1 3/8	26	21				1433-26	3404-285	M34, M35, W1-3/8", PT1", PS1", PF1"
	PT 1/4	11	9				1433-27	3404-286	
	PT 3/8	14	11				1433-28	3404-287	M18, W3/4", PT3/8", PS3/8", PF3/8", UNC3/4"
	PT 1/2	18	14				1433-29	3404-288	
	PT 3/4	23	17				1433-30	3404-289	M30, PS3/4", PF3/4"
	PT 1	26	21				1433-31	3404-290	M34, M35, W1-3/8", PS1", PF1", UNC1-3/8"



# Quick Change Tapping Collet



✳️ ORDER NO. SAME COLOR ARE INTER-CHANGEABLE

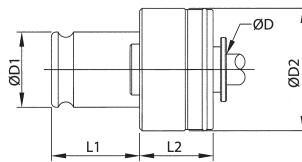

- Torque is factory-set to protect the tap for which a particular collet is designed. Small adjustments can be made by a trained user to accommodate tap strength and material variations.
- Collet stops driving when set torque is exceeded.
- Every tap needs a match size tapping collet.
- ØD1 is chuck suit for dia.

## With Overload Safety Collet (With Clutch)

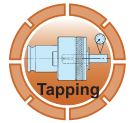

### DIN 371 Type

ORDER NO.	Size	TC312 DIN 371 Tap	Tap Shank		Capacity	L1 (m/m)	L2 (m/m)	ØD1 (m/m)	ØD2 (m/m)	CODE NO.	ØD x □ Size same as DIN 371
			ØD	□							
312-01D	TC 312 DIN 371	M1~M1.8	2.5	2.1	M1~M14	22.5	25	Suit for DIA. 19	32	3404-501	
312-02D		M2~M2.5	2.8	2.1						3404-502	M2,M2.5
312-02DA		M2	2.8	2.1						3404-502A	M2~M2.5,M2.5
312-02DB		M2.5	2.8	2.1						3404-502B	M2,M2~M2.5
312-03D		M3	3.5	2.7						3404-503	
312-04D		M3.5	4.0	3.0						3404-504	
312-05D		M4	4.5	3.4						3404-505	
312-06D		M4.5	6.0	4.9						3404-506	M5,M6
312-07D		M5	6.0	4.9						3404-507	M4.5,M6
312-08D		M6	6.0	4.9						3404-508	M4.5,M5
312-09D	M8	8.0	6.2	3404-509							
312-10D	M10	10.0	8.0	3404-510							
ORDER NO.	Size	TC820 DIN 371 Tap	Tap Shank		Capacity	L1 (m/m)	L2 (m/m)	ØD1 (m/m)	ØD2 (m/m)	CODE NO.	ØD x □ Size same as DIN 371
			ØD	□							
820-01D	TC 820 DIN 371	M5	6.0	4.9	M5~M24	35	30.5	Suit for DIA. 31	50	3404-521	M6
820-02D		M6	6.0	4.9						3404-522	M5
820-03D		M8	8.0	6.2						3404-523	
820-04D		M10	10.0	8.0						3404-524	

### DIN 376 Type

\*Custom-build products are available on request.

ORDER NO.	Size	TC312 DIN 376 Tap	Tap Shank		Capacity	L1 (m/m)	L2 (m/m)	ØD1 (m/m)	ØD2 (m/m)	CODE NO.	ØD x □ Size same as DIN 376
			ØD	□							
312-21D	TC 312 DIN 376	M3.5	2.5	2.1	M3~M14	22.5	25	Suit for DIA. 19	32	3404-531	
312-22D		M4	2.8	2.1						3404-532	
312-23D		M4.5	3.5	2.7						3404-533	M5
312-24D		M5	3.5	2.7						3404-534	M4.5
312-25D		M6	4.5	3.4						3404-535	
312-26D		M7	5.5	4.3						3404-536	
312-27D		M8	6.0	4.9						3404-537	
312-28D		M10	7.0	5.5						3404-538	
312-29D		M12	9.0	7.0						3404-539	
312-30D		M14	11.0	9.0						3404-540	
ORDER NO.	Size	TC820 DIN 376 Tap	Tap Shank		Capacity	L1 (m/m)	L2 (m/m)	ØD1 (m/m)	ØD2 (m/m)	CODE NO.	ØD x □ Size same as DIN 376
			ØD	□							
820-21D	TC 820 DIN 376	M8	6.0	4.9	M8~M24	35	30.5	Suit for DIA. 31	50	3404-551	
820-22D		M10	7.0	5.5						3404-552	
820-23D		M12	9.0	7.0						3404-553	
820-24D		M14	11.0	9.0						3404-554	
820-25D		M16	12.0	9.0						3404-555	
820-26D		M18	14.0	11.0						3404-556	
820-27D		M20	16.0	12.0						3404-557	
820-28D		M22	18.0	14.5						3404-558	M24
820-29D		M24	18.0	14.5						3404-559	M22
ORDER NO.	Size	TC1433 DIN 376 Tap	Tap Shank		Capacity	L1 (m/m)	L2 (m/m)	ØD1 (m/m)	ØD2 (m/m)	CODE NO.	ØD x □ Size same as DIN 376
			ØD	□							
1433-01D	TC 1433 DIN 376	M14	11.0	9.0	M14~M36	55.5	45	Suit for DIA. 48	72	3404-571	
1433-02D		M16	12.0	9.0						3404-572	
1433-03D		M18	14.0	11.0						3404-573	
1433-04D		M20	16.0	12.0						3404-574	
1433-05D		M22	18.0	14.5						3404-575	M24
1433-06D		M24	18.0	14.5						3404-576	M22
1433-07D		M27	20.0	16.0						3404-577	
1433-08D		M30	22.0	18.0						3404-578	
1433-09D		M33	25.0	20.0						3404-579	
1433-10D		M36	28.0	22.0						3404-580	



# Quick Change Tapping Collet



✳️ ORDER NO. SAME COLOR ARE INTER-CHANGEABLE

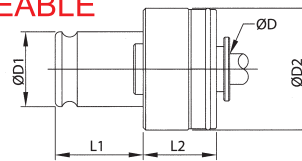
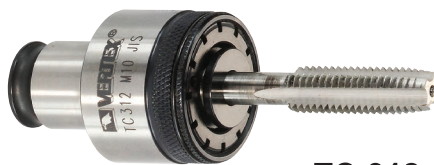

With Overload Safety Collet

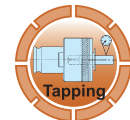

TC-312

## ISO 529/2283 Type

\*Custom-build products are available on request.

ORDER NO.	Size	TC312 ISO 529/2283 Tap	Tap Shank		Capacity	L1 (m/m)	L2 (m/m)	ØD1 (m/m)	ØD2 (m/m)	CODE NO.	ØD x □ Size same as ISO 529
			ØD	□							
312-21I	TC 312 ISO 529/2283	M3	2.24	1.8	M3~M14	22.5	25	Suit for DIA. 19	32	3404-631	
312-22I		M3.5	2.5	2.0						3404-632	M1~M2,M2
312-23I		M4	3.15	2.5						3404-633	M3
312-24I		M4.5	3.55	2.8						3404-634	M3.5
312-25I		M5	4.0	3.15						3404-635	M4
312-26I		M6	4.5	3.55						3404-636	M4.5
312-27I		M7	5.6	4.5						3404-637	
312-28I		M8	6.3	5.0						3404-638	M6
312-29I		M9	7.1	5.6						3404-639	M7
312-30I		M10	8.0	6.3						3404-640	M8
312-31I		M12	9.0	7.1						3404-641	M9
312-32I		M14	11.2	9.0						3404-642	

ORDER NO.	Size	TC820 ISO 529/2283 Tap	Tap Shank		Capacity	L1 (m/m)	L2 (m/m)	ØD1 (m/m)	ØD2 (m/m)	CODE NO.	ØD x □ Size same as ISO 529 / 2283	ØD x □ Size same as ISO 529
			ØD	□								
820-21I	TC 820 ISO 529/2283	M8	6.3	5.0	M8~M24	35	30.5	Suit for DIA. 31	50	3404-651		M6
820-22I		M9	7.1	5.6						3404-652	M7	
820-23I		M10	8.0	6.3						3404-653	M8	
820-24I		M12	9.0	7.1						3404-654	M9	
820-25I		M14	11.2	9.0						3404-655		
820-26I		M16	12.5	10.0						3404-656		
820-27I		M18	14.0	11.2						3404-657	M20	
820-29I		M20	14.0	11.2						3404-658	M18	
820-30I		M22	16.0	12.5						3404-659		
820-31I		M24	18.0	14.0						3404-660		

ORDER NO.	Size	TC1433 ISO 529/2283 Tap	Tap Shank		Capacity	L1 (m/m)	L2 (m/m)	ØD1 (m/m)	ØD2 (m/m)	CODE NO.	ØD x □ Size same as ISO 529 / 2283
			ØD	□							
1433-01I	TC 1433 ISO 529/2283	M14	11.2	9.0	M14~M36	55.5	45	Suit for DIA. 48	72	3404-671	
1433-02I		M16	12.5	10.0						3404-672	
1433-03I		M18	14.0	11.2						3404-673	M20
1433-04I		M20	14.0	11.2						3404-674	M18
1433-05I		M22	16.0	12.5						3404-675	
1433-06I		M24	18.0	14.0						3404-676	
1433-07I		M27	20.0	16.0						3404-677	M30
1433-08I		M30	20.0	16.0						3404-678	M27
1433-09I		M33	22.4	18.0						3404-679	
1433-10I		M36	25.0	20.0						3404-680	

## ISO 529 Type

ORDER NO.	Size	TC312 IOS 529 Tap	Tap Shank		Capacity	L1 (m/m)	L2 (m/m)	ØD1 (m/m)	ØD2 (m/m)	CODE NO.	ØD x □ Size same as ISO 529 / 2283	ØD x □ Size same as ISO 529
			ØD	□								
312-01I	TC 312 ISO 529	M1~M2	2.5	2.0	M1~M14	22.5	25	Suit for DIA. 19	32	3404-601	M3.5	M2
312-01IA		M2	2.5	2.0						3404-601A	M3.5	M1~M2
312-02I		M2.2~M2.5	2.8	2.24						3404-602		M2.5
312-02IA		M2.5	2.8	2.24						3404-602A		M2.2~M2.5
312-03I		M3	3.15	2.5						3404-603	M4	
312-04I		M3.5	3.55	2.8						3404-604	M4.5	
312-05I		M4	4.0	3.15						3404-605	M5	
312-06I		M4.5	4.5	3.55						3404-606	M6	
312-07I		M5	5.0	4.0						3404-607		
312-08I		M6	6.3	5.0						3404-608	M8	
312-09I		M7	7.1	5.6						3404-609	M9	
312-10I		M8	8.0	6.3						3404-610	M10	
312-11I	M9	9.0	7.1	3404-611	M12							
312-12I	M10	10.0	8.0	3404-612								

ORDER NO.	Size	TC820 ISO 529 Tap	Tap Shank		Capacity	L1 (m/m)	L2 (m/m)	ØD1 (m/m)	ØD2 (m/m)	CODE NO.	ØD x □ Size same as ISO 529 / 2283
			ØD	□							
820-01I	TC 820 ISO 529	M6	6.3	5.0	M6~M24	35	30.5	Suit for DIA. 31	50	3404-621	M8
820-02I		M7	7.1	5.6						3404-622	M9
820-03I		M8	8.0	6.3						3404-623	M10
820-04I		M9	9.0	7.1						3404-624	M12
820-05I		M10	10.0	8.0						3404-625	



# Quick Change Tapping Collet



QUICK CHANGE TAP COLLETS

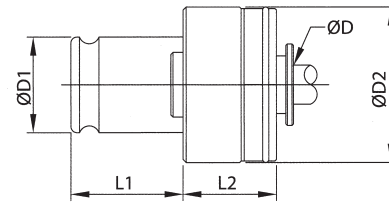

With Overload Safety Collet  
(With Clutch)

## ANSI TYPE

ORDER NO.	Size	TC312 ANSI Tap	Tap Shank				Capacity	L1 L2 (mm)	ØD1 ØD2 (mm)	CODE NO.	ØD x □ Size same as ANSI
			ØD		□						
			inch	mm	inch	mm					
TC312-#5-ANSI	TC312 ANSI	#5	0.141	3.581	0.11	2.794	21.5	Suit for DIA. 19.0	3404-701	UNC1/8",M3,M3.15	
TC312-#6-ANSI		#6	0.141	3.581	0.11	2.794			3404-702	M3.5	
TC312-#8-ANSI		#8	0.168	4.267	0.131	3.327			3404-703	UNC5/32",M4	
TC312-#10-ANSI		#10	0.194	4.928	0.152	3.861			3404-704	UNC3/16",M4.5,M5	
TC312-#12-ANSI		#12	0.220	5.588	0.165	4.191			3404-705		
TC312-#14-ANSI		#14	0.255	6.477	0.191	4.851			3404-706	UNC1/4",M6,M6.3	
TC312-M3-ANSI		M3	0.141	3.581	0.11	2.794	M3~M14	25.0	32.0	3404-707	#5,UNC1/8",M3.15
TC312-M4-ANSI		M4	0.168	4.267	0.131	3.327				3404-708	#8,UNC5/32"
TC312-M5-ANSI		M5	0.194	4.928	0.52	3.861				3404-709	#10,UNC3/16",M4.5
TC312-M6-ANSI		M6	0.255	6.477	0.191	4.851				3404-710	#14,UNC1/4",M6.3
TC312-M8-ANSI		M8	0.318	8.077	0.238	6.045				3404-711	UNC5/16",M7
TC312-M10-ANSI		M10	0.323	8.204	0.242	6.147				3404-712	UNC7/16"
TC312-M12-ANSI		M12	0.367	9.322	0.275	6.985	UNC1/8 ~ UNC3/8	25.0	32.0	3404-713	UNC1/2",M12.5
TC312-M14-ANSI		M14	0.429	10.897	0.322	8.179				3404-714	UNC9/16"
TC312-UNC1/8-ANSI	UNC1/8	0.141	3.581	0.11	2.794	3404-715				#5,M3,M3.15	
TC312-UNC3/16-ANSI	UNC3/16	0.194	4.928	0.152	3.861	3404-716				#10,M4.5,M5	
TC312-UNC1/4-ANSI	UNC1/4	0.255	6.477	0.191	4.851	3404-717				#14,M6,M6.3	
TC312-UNC5/16-ANSI	UNC5/16	0.318	8.077	0.238	6.045	3404-718				M7,M8	
TC312-UNC7/16-ANSI	UNC7/16	0.323	8.204	0.242	6.147	3404-719	M10				
TC312-UNC1/2-ANSI	UNC1/2	0.367	9.322	0.275	6.985	3404-720	M12,M12.5				
TC312-UNC3/8-ANSI	UNC3/8	0.381	9.677	0.286	7.264	3404-721					

## ANSI TYPE

ORDER NO.	Size	TC820 ANSI Tap	Tap Shank				Capacity	L1 L2 (mm)	ØD1 ØD2 (mm)	CODE NO.	ØD x □ Size same as ANSI
			ØD		□						
			inch	mm	inch	mm					
TC820-UNC7/16-ANSI	TC820 ANSI	UNC7/16	0.323	8.204	0.242	6.147	35.0	Suit for DIA. 31.0	3404-731	M10	
TC820-UNC1/2-ANSI		UNC1/2	0.367	9.322	0.275	6.985			3404-732	M12,M12.5	
TC820-UNC9/16-ANSI		UNC9/16	0.429	10.897	0.322	8.179			3404-734	M14	
TC820-UNC5/8-ANSI		UNC5/8	0.480	12.192	0.36	9.144			3404-735	M16	
TC820-UNC11/16-ANSI		UN11/16	0.542	13.767	0.406	10.312			3404-736	M18	
TC820-UNC13/16-ANSI		UNC13/16	0.652	16.561	0.489	12.421	3404-738	M20			

## ISO 529 UNC TYPE

ORDER NO.	Size	TC312 ISO Tap	Tap Shank		Capacity	L1 L2 (mm)	ØD1 ØD2 (mm)	CODE NO.	ØD x □ Size same as
			ØD	□					
			mm	mm					
TC312-UNC1/4-ISO	TC312 ISO529	UNC1/4	4.5	3.55	UNC1/4 ~ UNC1/2	21.5	Suit for DIA. 19.0	3404-751	
TC312-UNC5/16-ISO		UNC5/16	6.3	5				3404-752	
TC312-UNC3/8-ISO		UNC3/8	7.1	5.6				3404-753	
TC312-UNC7/16-ISO		UNC7/16	8	6.3				3404-754	
TC312-UNC1/2-ISO		UNC1/2	9	7.1	3404-755				



# Quick Change Tapping Collet



**QUICK CHANGE TAP COLLETS  
WITHOUT CLUTCH**

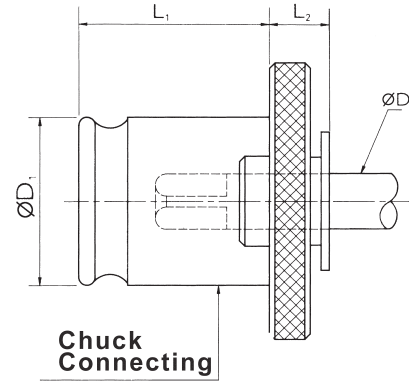

TAPPING CHUCKS

## JIS SYSTEM SIZE

1PC ≅ 0.08kg

Size	Thread	Tap Shank		ØD1	L1	L2	ORDER NO.	CODE NO.	ØD x □ Same JIS inch or mm
		ØD	□						
TC312B (#1)	M3	4	3.2	Suit for DIA. 19	21.5	7	312B-01	3404-300	W1/8"
	M4	5	4				312B-02	3404-301	M4.5
	M5	5.5	4.5				312B-03	3404-302	M5.5, W3/16"
	M6	6	4.5				312B-04	3404-303	W1/4", UNC1/4"
	UNC 5/16	6.1	5				312B-05	3404-304	
	M7/M8	6.2	5				312B-06	3404-305	
	M9/M10	7	5.5				312B-07	3404-306	W3/8", UNC3/8"
	M11	8	6				312B-08	3404-307	W7/16", PT1/8", PS1/8", PF1/8", UNC7/16"
	M12	8.5	6.5				312B-09	3404-308	
	UNC 1/2	9	7				312B-10	3404-309	W1/2"
	M14	10.5	8				312B-11	3404-310	M15, W9/16"
	PT 1/4	11	9				312B-12	3404-311	PS1/4", PF1/4"

1PC ≅ 0.28kg

Size	Thread	Tap Shank		ØD1	L1	L2	ORDER NO.	CODE NO.	ØD x □ Same JIS inch or mm
		ØD	□						
TC820B (#2)	M7/M8	6.2	5	Suit for DIA. 31	35	11	820B-01	3404-330	
	M9/M10	7	5.5				820B-02	3404-331	W3/8", UNC3/8"
	M11	8	6				820B-03	3404-332	W7/16", UNC7/16", PT1/8", PS1/8", PF1/8"
	M12	8.5	6.5				820B-04	3404-333	
	UNC 1/2	9	7				820B-05	3404-334	W1/2"
	M14	10.5	8				820B-06	3404-335	M15, W9/16", UNC9/16"
	PT 1/4	11	9				820B-07	3404-336	PS1/4", PF1/4"
	UNC 5/8	12	9				820B-08	3404-337	W5/8"
	M16	12.5	10				820B-09	3404-338	
	M18	14	11				820B-11	3404-340	W3/4", PT3/8", PS3/8", PF3/8", UNC3/4"
	M20	15	12				820B-12	3404-341	
	M22	17	13				820B-13	3404-342	W7/8", UNC7/8"
	PT 1/2	18	14				820B-14	3404-343	PS1/2", PF1/2"

1PC ≅ 0.8kg

Size	Thread	Tap Shank		ØD1	L1	L2	ORDER NO.	CODE NO.	ØD x □ Same JIS inch or mm
		ØD	□						
TC1433B (#3)	M14/M15	10.5	8	Suit for DIA. 48	55.5	14	1433B-01	3404-360	W9/16", UNC9/16"
	PT 1/4	11	9				1433B-02	3404-361	
	UNC 5/8	12	9				1433B-03	3404-362	
	M16	12.5	10				1433B-04	3404-363	
	M18	14	11				1433B-06	3404-365	W3/4", UNC3/4", PT3/8", PS3/8", PF3/8"
	M20	15	12				1433B-07	3404-366	
	M22	17	13				1433B-08	3404-367	W7/8", UNC7/8"
	PT 1/2	18	14				1433B-09	3404-368	
	M24/M25	19	15				1433B-10	3404-369	PF5/8"
	M26/M27	20	15				1433B-11	3404-370	W1", UNC1"
	M28	21	17				1433B-12	3404-371	
	UNC 1 1/8	22	17				1433B-13	3404-372	
	M30	22	18				1433B-14	3404-373	PT3/4", PS3/4", PF3/4"
	M32	24	19				1433B-15	3404-374	W1-1/4", PF7/8", UNC1-1/4"
	M33	25	20				1433B-16	3404-375	
	M34/M35	26	21				1433B-17	3404-376	W1-3/8", PT1", PS1", PF1", UNC1-3/8"
	M36	28	22				1433B-18	3404-377	PS1-1/8", PF1-1/8"





# Tap Shank Dimensions INT. STD



For Tapping Chuck



FOR TAP Thread	JIS		ISO		DIN 371		DIN 376	
	Ød	□	Ød	□	Ød	□	Ød	□
M3	4	3.2	3.15	2.5	3.5	2.7	2.2	-
M4	5	4	4	3.15	4.5	3.4	2.8	2.1
M5	5.5	4.5	5	4	6	4.9	3.5	2.7
M6	6	4.5	6.3	5	6	4.9	4.5	3.4
M8	6.2	5	8	6.3	8	6.2	6	4.9
M10	7	5.5	10	8	10	8	7	5.5
M12	8.5	6.5	9	7.1			9	7
M14	10.5	8	11.2	9			11	9
M16	12.5	10	12.5	10			12	9
M18	14	11	14	11.2			14	11
M20	15	12	14	11.2			16	12
M22	17	13	16	12.5			18	14.5
M24	19	15	18	14			18	14.5
M27	20	15	20	16			20	16
M30	23	17	20	16			22	18
PT 1/8	8	6						
PT 1/4	11	9						
PT 3/8	14	11						
PT 1/2	18	14						
PT 5/8	19	15						
PT 3/4	23	17						

## JIS STANDARD

METRIC THREAD	INCH THREAD	Ød	□
M3	W 1/8	4	3.2
M4 M4.5		5	4
M5 M5.5		5.5	4.5
M6	W 1/4	6	4.5
	W 5/16	6.1	5
M8 M7		6.2	5
M10 M9	W 3/8	7	5.5
M11	W 7/16	8	6
M12		8.5	6.5
	W 1/2	9	7
M14 M15	W 9/16	10.5	8
	W 5/8	12	9
M16		12.5	10
M17		13	10
M18	W 3/4	14	11
M20		15	12
M22	W 7/8	17	13
M24 M25		19	15
M27 M26	W1	20	15
M28		21	17
	W 1-1/8	22	17
M30		23	17
M32	W1-1/4	24	19
M33		25	19
M35 M34	W1-3/8	26	21
M36 M38		28	21
M39 M40	W1-1/2	30	23
M42	W1-5/8	32	26
M45	W1-3/4	35	26
M48	W1-7/8	38	29

## DIN STANDARD

FOR TAP Thread	DIN 371		DIN 352		DIN 376	
	Ød	□	Ød	□	Ød	□
M1,M1.1,M1.2,M1.4,M1.6,M1.8	2.5	2.1	2.5	2.1		
M2,M2.2,M2.5	2.8	2.1	2.8	2.1		
M3	3.5	2.7	3.5	2.7	2.2	-
M3.5	4	3	4	3		
M4	4.5	3.4	4.5	3.4	2.8	2.1
M5,M6	6	4.9	6	4.9		
M8	8	6.2			6	4.9
M8			6	4.9	6	4.9
M10	10	8			7	5.5
M10			7	5.5	7	5.5
M12			9	7	9	7
M14			11	9	11	9
M16			12	9	12	9
M18			14	11	14	11
M20			16	12	16	12
M22,M24			18	14.5	18	14.5
M27			20	16	20	16
M30			22	18	22	18

## DRILL HOLE SIZE FOR TAP THREAD

TAP THREAD	PITCH(P)	DRILL HOLE (d mm)
M1	0.25	0.75
M1.1	0.25	0.85
M1.2	0.25	0.95
M1.4	0.3	1.1
M1.6	0.35	1.25
M1.8	0.35	1.45
M2	0.4	1.6
M2.2	0.45	1.75
M2.5	0.45	2.05
M3	0.5	2.5
M3.5	0.6	2.9
M4	0.7	3.3
M4.5	0.75	3.75
M5	0.8	4.2
M6	1	5
M7	1	6
M8	1.25	6.75
M9	1.25	7.75
M10	1.5	8.5
M11	1.5	9.5
M12	1.75	10.2
M14	2	12
M16	2	14
M18	2.5	15.5
M20	2.5	17.5
M22	2.5	19.5
M24	3	21
M27	3	24
M30	3.5	26.5
M33	3.5	29.5
M36	4	32

FOR TAP Thread	JIS		ISO		DIN 371		DIN 376	
Thread	Ød	□	Ød	□	Ød	□	Ød	□
W 1/8"	4	3.2						
W 3/16"	5.5	4.5						
W 1/4"	6	4.5						
W 5/16"	6.1	5						
W 3/8"	7	5.5						
W 7/16"	8	6						
W 1/2"	9	7						
W 5/8"	12	9						
W 3/4"	14	11						
W 7/8"	17	13						
W 1"	20	15						

## JIS STANDARD PIPE THREAD

For Tap Style			Tapping Chuck Tap Size	
PT	PS	PF	Ød	□
1/8	1/8	1/8	8	6
1/4	1/4	1/4	11	9
3/8	3/8	3/8	14	11
1/2	1/2	1/2	18	14
		5/8	19	15
3/4	3/4	3/4	23	17
		7/8	24	19
1	1	1	26	21
	1 - 1/8	1 - 1/8	28	21
1 - 1/4	1 - 1/4	1 - 1/4	32	26
1 - 3/8	1 - 3/8	1 - 3/8	35	26
1 - 1/2	1 - 1/2	1 - 1/2	38	29



# Mini Type Arm Type Air Tapping Unit



HIGH TORQUE HIGH EFFICIENCY EASY OPERATION

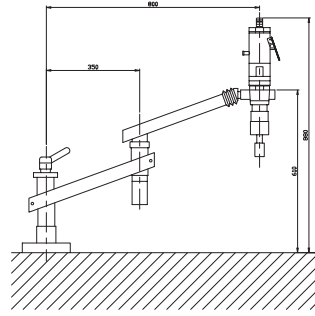

## ACCESSORIES

- Air tapping spindle
  - Parallel arm & Air combination
  - Table mounting column
  - Choose any six safety clutch tapping adapters
  - Radial jib
  - Air pressure: 6~8 kgs/cm<sup>2</sup>
  - VAT-08/12 series require: 5HP compressor
  - VAT-16/20 series require: 10HP compressor
- ※ GUARANTEED FOR 3 MONTHS.  
 ※ MUST INSTALL ON A STABLE / HARD SURFACE FOR PARALLEL WORK.

※ Base not included

ORDER NO.	VAT-708	VAT-712	VAT-716	VAT-720	VAT-722	VAT-724
For Tap	M3~M8	M5~M12	M8~M16	M10~M20	M12~M22	M14~M24
	TC-312	TC-312	TC-820	TC-820	TC-820	TC-820
Speed (rpm)	630/700	350/400	250	200	200	100
Weight (kgs)	13.2	13.1	17.3	20.6	20.6	22.1
Work Range	Rmax 700mm					
CODE NO.	3404-410	3404-411	3404-412	3404-413	3404-413A	3404-413B



# Small Arm Type Air Tapping Unit

HIGH TORQUE HIGH EFFICIENCY EASY OPERATION

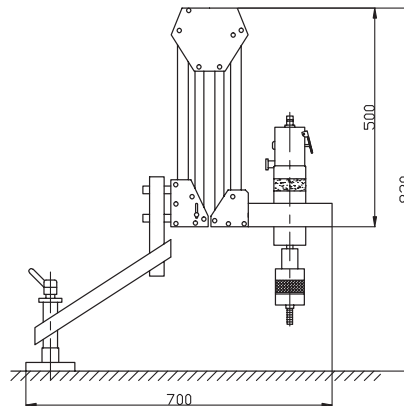

※ Base not included

## ACCESSORIES

- Air tapping spindle
- Parallel arm & Air combination
- Table mounting column
- Choose any six safety clutch tapping adapters
- Radial jib, increases arm reach by 500 mm

- Without stand plate
- Air pressure: 6~8 kgs / cm<sup>2</sup>
- VAT-08/12 series require: 5HP compressor
- VAT-16/20 series require: 10HP compressor

※ GUARANTEED FOR 3 MONTHS.  
 ※ MUST INSTALL ON A STABLE / HARD SURFACE FOR PARALLEL WORK.

ORDER NO.	VAT-1408	VAT-1412	VAT-1416	VAT-1420	VAT-1422	VAT-1424
For Tap	M3~M8	M5~M12	M8~M16	M10~M20	M12~M22	M14~M24
	TC-312	TC-312	TC-820	TC-820	TC-820	TC-820
Speed (rpm)	700	400	250	200	200	100
Weight (kgs)	18.2	18.2	24.6	25.6	25.6	27.1
Work Range	Rmax 1400mm Rmin 200mm					
CODE NO.	3404-415	3404-416	3404-417	3404-418	3404-418A	3404-418B

※ VAT-1424 can be replaced by VAT-1624