



ER Spring Collet Chuck System



Collet Chuck Kit Whit ISO Taper Shank DIN 2080/ISO SHANK
DIN 6499



NT-40

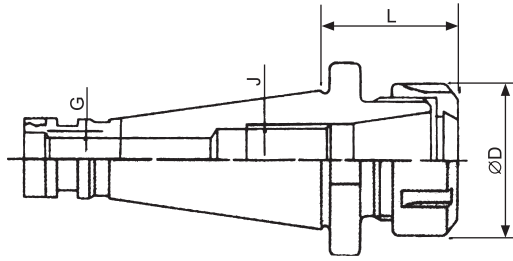

ER



ORDER NO.	TAPER	COLLET TYPE	L	D	G	WEIGHT KGS	CODE NO.
V-101	NT-30	ER-32	55	50	1/2"-12W, M12X1.75P (USA 1/2"-UNC13)	0.7	3020-301
V-102		ER-40	70	63		1.1	3020-302
V-103	NT-40	ER-32	50	60	5/8"-11W or M16X2.0P	1.1	3021-301
V-104		ER-40	60	63		1.3	3021-302
V-105		ER-50	80	78		2	3021-303
V-106	NT-50	ER-32	60	50	1"-8W or M24X3.0P	3.1	3022-301
V-107		ER-40	65	63		3.4	3022-302
V-108		ER-50	80	78		4	3022-303
* V-109	NT-30	ER-25	55	42	1/2"-12W, M12X1.75P	0.7	3020-303
* V-110	NT-40	ER-25	50	42	5/8"-11W, M16X2.0P	1.1	3021-304

Collet Chuck kit With ISO Taper Shank

Including shank, full set of collets, wrench and case.



NT-30

Caution:

Please notify the taper size, collet type, set range, and set numbers when ordering.

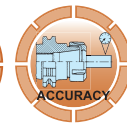

ORDER NO.	TAPER	COLLET TYPE	SET RANGE	SET PCS	WEIGHT KGS	CODE NO.
V-201	NT-30	ER-32	3-20	18	4.2	3020-401
V-202			4-20	11	3.2	3020-402
V-203			6-20	6	2.8	3020-403
V-204	NT-30	ER-40	4-26	23	7.3	3020-404
V-205			4-26	15	6	3020-405
V-206			6-25	7	4.6	3020-406
V-207	NT-40	ER-32	3-20	18	4.8	3021-401
V-208			4-20	11	3.8	3021-402
V-209			6-20	6	3.4	3021-403
V-210	NT-40	ER-40	4-26	23	8.2	3021-404
V-211			4-26	15	6.9	3021-405
V-212			6-25	7	5.2	3021-406
V-213	NT-40	ER-50	12-34	12	10	3021-407
V-214	NT-50	ER-32	3-20	18	6.4	3022-401
V-215			4-20	11	5.4	3022-402
V-216			6-20	6	5.5	3022-403
V-217	NT-50	ER-40	4-26	23	9.8	3022-404
V-218			4-26	15	8.5	3022-405
V-219			6-25	7	7	3022-406
V-220	NT-50	ER-50	12-34	12	11	3022-407
* V-223	NT-30	ER-25	2-16	7	2.8	3020-407
* V-224			4-16	15	2.4	3020-408
* V-225	NT-40	ER-25	2-16	7	3.3	3021-409
* V-226			4-16	15	3.0	3021-410



ER Spring Collet Chuck System



Extended Collet Holder With ISO Shank
DIN 2080/ISO SHANK EXTENDED CHUCK

DIN 6499

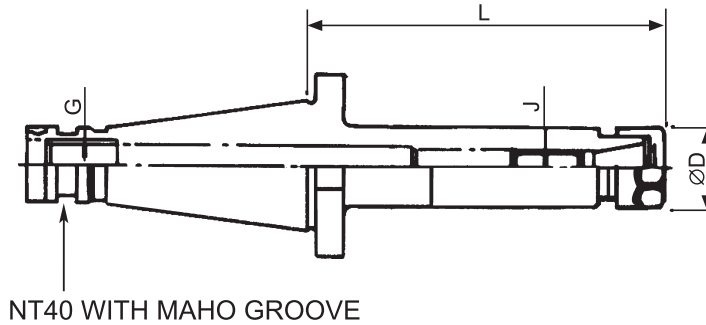

ORDER NO.	TAPER	COLLET TYPE	L	D	G	WEIGHT KG	CODE NO.
V-231	NT-30	ER-16	76	28	1/2"-12W, M12X1.75P (USA 1/2"-UNC13)	0.6	3020-304
V-232	NT-40	ER-16	76	28	5/8"-11W or M16X2.0P	1.1	3021-314
V-233		ER-16	100	28		1.2	3021-305
V-234	NT-40	ER-20	76	34	5/8"-11W or M16X2.0P	1.2	3021-306
V-235		ER-20	100	34		1.4	3021-307



Extended Collet Chuck Kit With ISO Shank

Including shank, full set of collets, wrench and case

Caution:

Please notify the taper size, collet type, set range, and set numbers when ordering.

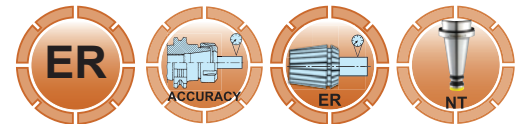

ORDER NO.	TAPER	COLLET TYPE	RANGE	PCS/SET	L	WEIGHT KGS	CODE NO.
V-241	NT-30	ER-16	1-10	10	76	1.9	3020-409
V-242			3-10	8		1.8	3020-410
V-243	NT-40	ER-16	1-10	10	76	2.2	3021-411
V-244			3-10	8		2.1	3021-412
V-245		ER-16	1-10	10	100	2.4	3021-413
V-246			3-10	8		2.3	3021-414
V-247	NT-40	ER-20	2-13	12	76	2.3	3021-415
V-248			4-13	10		2.2	3021-416
V-249		ER-20	2-13	12	100	2.6	3021-417
V-250			4-13	10		2.5	3021-418



ER Spring Collet Chuck System



Collet Holders With R-8 shank

R-8 SHANK

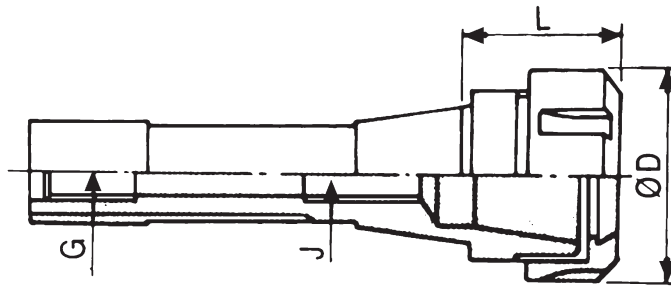

ORDER NO.	TAPER	COLLET TYPE	L	D	G	WEIGHT KG	CODE NO.
V-301	R8	ER-16	38	28	7/16"X20 UNF	0.5	3027-301
V-302		ER-32	40	50	7/16"X20 UNF	0.8	3027-302
V-303		ER-40	70	63	7/16"X20 UNF	1.3	3027-303

Collet Chuck Kit With R-8 Shank

Including shank, full set of collets, wrench and case. (ER16 no Wrench)



Caution:

Please notify the taper size, collet type, set range, and set numbers when ordering.

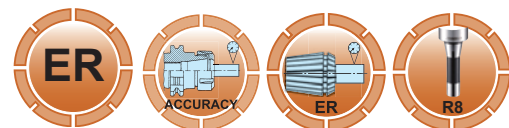

ORDER NO.	TAPER	COLLET TYPE	SET RANGE	SET PCS	WEIGHT KGS	CODE NO.
V-311	R8	ER16	1-10	10	1.5(W)	3027-401
V-312			3-10	8	1.45(P)	3027-402
V-313		ER32	3-20	18	4.3(P)	3027-403
V-314			4-20	11	3.2(P)	3027-404
V-315			6-20	6	2.9(P)	3027-405
V-316		ER40	4-26	23	7.3(P)	3027-406
V-317			4-26	15	6.1(P)	3027-407
V-318			6-25	7	4.6(P)	3027-408



ER Spring Collet Chuck System



Collet Holders With Morse Taper Shank

DIN 6499 DIN 228

MT-SHANK
MT / MK

ER

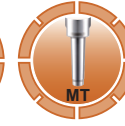
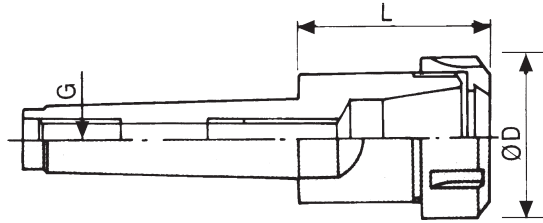

NEW

ORDER NO.	TAPER	COLLET TYPE	L	D	G	WEIGHT KGS	CODE NO.
V-401	MT2	ER16	40	28	3/8"-16W or M10X1.5P	0.2	3023-301
V-402		ER20	43	34		0.3	3023-302
V-403		ER25	47	42		0.4	3023-303
V-404	MT3	ER16	40	28	3/8"-16W or 1/2"-12W M10X1.5P, M12X1.75P USA 1/2"-UNC13	0.3	3024-301
V-405		ER32	70	50		0.8	3024-302
V-406		ER40	80	63		1.1	3024-303
NEW V-451	MT3	ER20	43	34	1/2"-12NC or M12X1.75P	0.3	3024-304
V-452		ER25	47	42		0.5	3024-305
V-407	MT4	ER32	60	50	5/8"-11W or M16X2.0P	1	3025-301
V-408		ER40	82	63		1.4	3025-302
V-409		ER50	85	78		2.2	3025-303
V-410	MT5	ER40	82	63	1"-8W or M24X3.0P	2.1	3026-301
V-411		ER50	85	78		2.9	3026-302

Collet Chuck Kit With Morse Taper Shank

Including shank, full set of collets, wrench and case.

(ER16, ER20 no Wrench)

1. ER16,20,25 Packed in Wooden Box(W)
2. ER32,40,50, Packed in Plastic Box(P)

Caution:

Please notify the taper size, collet type, set range, and set numbers when ordering.



ORDER NO.	TAPER	COLLET TYPE	SET RANGE	SET PCS	WEIGHT KGS.	CODE NO.
V-412	MT2	ER16	1-10	10	1.05	3023-401
V-413			3-10	8	1	3023-402
V-414	MT2	ER20	2-13	12	1.3	3023-403
V-415			4-13	10	1.2	3023-404
V-416	MT2	ER25	2-16	15	2.4	3023-405
V-418			4-16	7	1.3	3023-407
V-419	MT3	ER16	1-10	10	1.5	3024-401
NEW V-420			3-10	8	1.1	3024-402
V-441	MT3	ER20	2-13	12	1.35	3023-408
V-442			4-13	10	1.3	3023-409
V-443	MT3	ER25	2-16	15	2.5	3023-410
V-444			4-16	7	2.1	3023-411
V-421	MT3	ER32	3-20	18	4.1	3024-403
V-422			4-20	11	3	3024-404
V-423			6-20	6	2.7	3024-405
V-424	MT3	ER40	4-26	23	7.2	3024-406
V-425			4-26	15	6	3024-407
V-426			6-25	7	4.5	3024-408
V-427	MT4	ER32	3-20	18	4.3	3025-401
V-428			4-20	11	3.2	3025-402
V-429			6-20	6	2.9	3025-403
V-430	MT4	ER40	4-26	23	7.3	3025-404
V-431			4-26	15	6.1	3025-405
V-432			6-25	7	4.6	3025-406
V-433	MT4	ER50	12-34	12	9	3025-407
V-434	MT5	ER40	4-26	23	8.2	3026-401
V-435			4-26	15	6.9	3026-402
V-436			6-25	7	5.4	3026-403
V-437	MT5	ER50	12-34	12	9.5	3026-404



ER Spring Collet Chuck System



Collet Holders With Straight Shank

DIN6499 STRAIGHT

SHANK

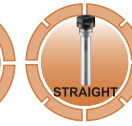
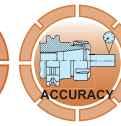
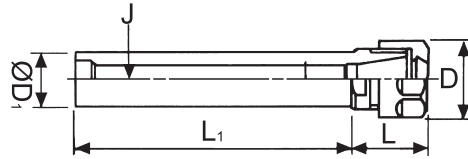

METRIC SIZE

ORDER NO.	COLLET TYPE	SHANK D1XL1	L	D	J	KGS	CODE NO.
V-530	ER11	Ø16X50	21	19	M6	0.1	3007-300
V-531		Ø16X100	21	19	M6	0.2	3007-311
V-532		Ø16X150	21	19	M6	0.3	3007-312
V-501A	ER16	Ø16X100	21	28	M10	0.3	3003-301A
V-501	ER16	Ø20X50	30	28	M10	0.2	3003-301
V-502		Ø20X100	30	28	M10	0.3	3003-302
V-503		Ø20X150	30	28	M10	0.4	3003-303
V-504	ER16	Ø25X100	30	28	M10	0.5	3003-304
V-504A		Ø25X50	30	28	M10	0.3	3003-306
V-505		Ø25X150	30	28	M10	0.7	3003-305
V-505A		Ø25X200	30	28	M10	0.5	3003-307
V-506		ER20	Ø20X50	36	34	M12	0.3
V-507	Ø20X100		36	34	M12	0.3	3004-302
V-508	Ø20X150		36	34	M10	0.5	3004-303
V-509	ER20	Ø25X150	36	34	M10	0.7	3004-304
V-509A		Ø25X100	36	34	M12	0.5	3004-305
V-509B		Ø25X50	36	34	M12	0.3	3004-306
V-510	ER25	Ø20X50	46	42	M12	0.4	3005-301
V-511		Ø20X100	46	42	M12	0.5	3005-302
V-512		Ø20X150	46	42	M12	0.6	3005-303
V-513	ER25	Ø25X100	46	42	M12	0.6	3005-304
V-514		Ø25X150	46	42	M12	0.7	3005-305
V-515		Ø32X60	46	42	M12	0.6	3005-306
V-516	ER32	Ø25X80	54	50	M12	0.8	3006-301
V-517		Ø32X100	54	50	M12	1.1	3006-302
V-517A		Ø32X150	54	50	M12	1.5	3006-305
V-518		Ø40X100	54	50	M12	1.4	3006-303
V-523	ER40	Ø32X100	55	63	M16	1.5	3007-302
V-524		Ø40X100	55	63	M16	1.8	3007-303

With Flat Shank

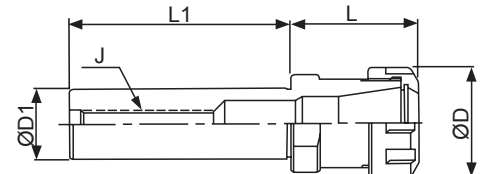
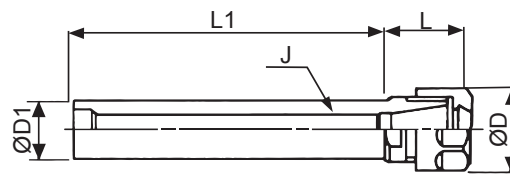

INCH SIZE

ORDER NO.	COLLET TYPE	SHANK D1XL1	L	D	J	KGS	CODE NO.
V-571	ER16	ST 5/8" X 4"	36	28	3/8"-16	0.2	3003-320
V-572		ST 3/4" X 4"	32			0.24	3003-321
V-573		ST 3/4" X 6"	32			0.32	3003-322
V-574		ST 1" X 4"	32			0.35	3003-323
V-575	ER20	ST 3/4" X 4"	34	34	3/8"-16	0.25	3004-320
V-576		ST 3/4" X 6"	34			0.33	3004-321
V-577		ST 1" X 4"	34			M12	0.36
V-578	ER32	ST 1" X 3"	58	50	M12	0.5	3006-320
V-579		ST 1-1/4" X 4"	58			0.6	3006-321





ER Spring Collet Chuck System



DIN 6499 STRAIGHT SHANK



Collet Chuck Kit With Straight Shank

Including shank, full set of collets,
wrench and case.

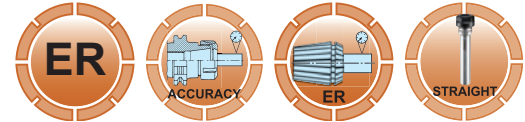
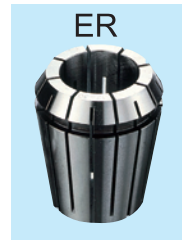

COLLET CHUCK SETS

ORDER NO.	SHANK D1XL1	COLLET TYPE	SET RANGE	SET PCS	KGS	CODE NO.
V-601	Ø20X50L	ER16	1-10	10	0.9	3003-401
V-602	Ø20X50L		3-10	8	0.8	3003-402
V-603	Ø20X100L		1-10	10	1	3003-403
V-604	Ø20X100L		3-10	8	0.9	3003-404
V-605	Ø20X150L		1-10	10	1.1	3003-405
V-606	Ø20X150L		3-10	8	0.5	3003-406
V-607	Ø25X100L	ER16	1-10	10	1.1	3003-407
V-607A	Ø25X50L		1-10	10	1.1	3003-411
V-608	Ø25X100L		3-10	8	1.1	3003-408
V-608A	Ø25X50L		3-10	8	1.1	3003-412
V-609	Ø25X150L		1-10	10	1.3	3003-409
V-610	Ø25X150L		3-10	8	1.3	3003-410
V-611	Ø20X50L	ER20	2-13	12	1.2	3004-401
V-612	Ø20X50L		4-13	10	1.2	3004-402
V-613	Ø20X100L		2-13	12	1.2	3004-403
V-614	Ø20X100L		4-13	10	1.2	3004-404
V-615	Ø20X150L		2-13	12	1.4	3004-405
V-616	Ø20X50L		4-13	10	1.3	3004-406
V-615A	Ø25X50L	ER20	2-13	12	1.3	3004-409
V-616A	Ø25X50L		4-13	10	1.3	3004-410
V-617	Ø25X100L		2-13	12	1.4	3004-407
V-617A	Ø25X150L		2-13	12	1.5	3004-411
V-618	Ø25X100L		4-13	10	1.4	3004-408
V-618A	Ø25X150L		4-13	10	1.5	3004-412
V-619	Ø20X50L	ER25	2-16	15	2.2	3005-401
V-621	Ø20X50L		4-16	7	1.7	3005-403
V-622	Ø20X100L		2-16	15	2.3	3005-404
V-624	Ø20X100L		4-16	7	1.8	3005-406
V-625	Ø20X150L		2-16	15	2.4	3005-407
V-627	Ø20X150L		4-16	7	2	3005-409
V-628	Ø25X100L	ER25	2-16	15	2.3	3005-410

ORDER NO.	SHANK D1XL1	COLLET TYPE	SET RANGE	SET PCS	KGS	CODE NO.
V-681	Ø16X50L	ER11	1-7	13	0.5	3002-401
V-682	Ø16X50L		1-7	7	0.5	3002-402
V-683	Ø16X100L	ER11	1-7	13	0.6	3002-403
V-684	Ø16X100L		1-7	7	0.5	3002-404

ORDER NO.	SHANK D1XL1	COLLET TYPE	SET RANGE	SET PCS	KGS	CODE NO.
V-630	Ø25X100L	ER25	6-16	7	2	3005-412
V-631	Ø25X150L		2-16	15	2.6	3005-413
V-633	Ø25X150L		6-16	7	1.9	3005-415
V-634	Ø32X60L	ER25	2-16	15	2.5	3005-416
V-636	Ø32X60L		6-16	7	1.9	3005-418
V-637	Ø25X80L	ER32	3-20	18	4.1	3006-401
V-638	Ø25X80L		4-20	11	3	3006-402
V-639	Ø25X80L		3-20	6	2.7	3006-403
V-640	Ø32X100L	ER32	4-20	18	4.3	3006-404
V-641	Ø32X100L		6-20	11	3.2	3006-405
V-642	Ø32X100L		6-20	6	2.9	3006-406
V-643	Ø40X100L	ER32	3-20	18	4.6	3006-407
V-644	Ø40X100L		4-20	11	3.5	3006-408
V-645	Ø40X100L		6-20	6	3.2	3006-409
V-646	Ø1"X3L	ER32	3-20	18	4.1	3006-410
V-647	Ø1"X3L		4-20	11	3	3006-411
V-648	Ø1"X3L		6-20	6	2.9	3006-412
V-658	Ø32X100L	ER40	4-26	23	7.3	3007-404
V-659	Ø32X100L		4-26	15	6.1	3007-405
V-660	Ø32X100L		6-25	7	4.6	3007-406
V-661	Ø40X100L	ER40	4-26	23	7.6	3007-407
V-662	Ø40X100L		4-26	15	6.5	3007-408
V-663	Ø40X100L		6-25	7	5	3007-409

- V-603, V-604 are the most popular item.
- THE ER-20/25/32/40 ARE TO BE CONTINUED
- V-613, V-614 are the most popular item.

ER SYSTEM



ER Spring Collet Chuck System



MINI TYPE STRAIGHT SHANK HOLDER

DIN 6499 MINI STRAIGHT SHANK

NEW

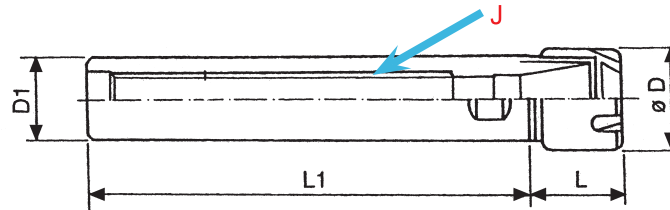

MINI TYPE NUT

COLLET HOLDER (MINI TYPE)

ORDER NO.	COLLET TYPE	SHANK D1XL1	D	L	J	KGS	CODE NO.
V-541	ER8M	ST08X50L	12	24		0.04	3001-290
V-542		ST10X50L		19		0.05	3001-291
V-543		ST10X80L		19		0.07	3001-292
V-544	ER8M	ST12X50L	12	14		0.05	3001-293
V-545		ST12X100L		14		0.09	3001-294
V-546		ST12X150L		14		0.12	3001-295
V-551	ER11M	ST16X50L	16	22	M6	0.1	3011-301
V-552		ST16X100L				0.2	3011-302
V-552A		ST16X150L				0.3	3011-303
V-553	ER16M	ST20X50L	22	32	M10	0.2	3012-301
V-554		ST20X100L				0.3	3012-302
V-555		ST20X150L				0.4	3012-303
V-555A		ST20X200L				0.4	3012-307
V-556	ER20M	ST20X50L	28	33	M12	0.2	3013-301
V-557		ST20X100L				0.3	3013-302
V-558		ST20X150L				0.4	3013-303
V-559	ER20M	ST25X100L	28	33	M12	0.4	3013-304
V-560		ST25X150L				0.6	3013-305
V-561	ER16M	ST16X100L	22	22	M10	0.2	3012-304
V-562	ER16M	ST25X100L	22	22	M10	0.4	3012-305
V-563		ST25X150L				0.6	3012-306
V-563A		ST25X200L				0.5	3012-308
V-557A	ER20M	ST20X200L	28	35	M12	0.4	3013-306
V-560A		ST25X200L				0.5	3013-307

Collet Chuck Kit With Straight Shank

Including shank, full set of collets, wrench and case.

※ For the 50L A side of the shank is milled has flate surface.

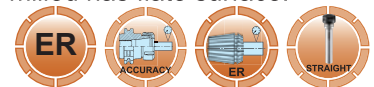

MINI TYPE

ORDER NO.	SHANK D1XL1	COLLET TYPE	SET RANGE	SET PCS	KGS	CODE NO.
V-691A	ST16X50L	ER11M	1-7	7	0.5	3011-401
V-691B	ST16X50L		1-7	13	0.5	3011-402
V-692A	ST16X100L	ER11M	1-7	7	0.6	3011-403
V-692B	ST16X100L		1-7	13	0.6	3011-404
V-693A	ST20X50L	ER16M	1-10	10	0.7	3012-401
V-693B	ST20X50L		3-10	8	1.0	3012-402
V-693C	ST16X100L	ER16M	1-10	10	0.6	3012-407
V-694A	ST20X100L	ER16M	1-10	10	0.9	3012-403
V-694B	ST20X100L		3-10	8	1.1	3012-404
V-695A	ST20X150L		1-10	10	1.3	3012-405
V-695B	ST20X150L		3-10	8	1.2	3012-406
V-695C	ST25X100L	ER16M	1-10	10	1.2	3012-408
V-695D	ST25X150L		1-10	10	1.4	3012-409
V-696A	ST20X50L	ER20M	2-13	12	1.3	3013-401
V-696B	ST20X50L		4-13	10	1.2	3013-402
V-697A	ST20X100L		2-13	12	1.1	3013-403
V-697B	ST20X100L		4-13	10	1.1	3013-404
V-698A	ST20X150L	ER20M	2-13	12	1.2	3013-405
V-698B	ST20X150L		4-13	10	1.2	3013-406
V-698C	ST25X100L		2-13	12	1.4	3013-407
V-698D	ST25X150L		2-13	12	1.5	3013-408



MINI TYPE NUT



Clamping Nuts For Collets



ER CLAMPING NUT SYSTEM

DIN 6499



ER20M



ER16M



ER11MS



ER40KM
WITH A BEARING



ER40UM



ER16UM

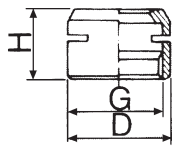

FIG.1 ER11,16,20MS

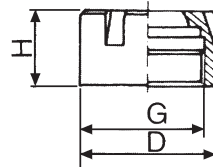

FIG.2 ER11,16,20M
ER8M, 25M

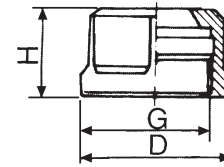

FIG.3 ER11,16,20UM

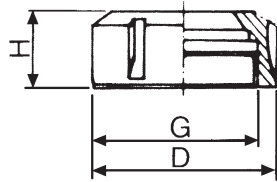

FIG.4 ER25,32,40,50UM

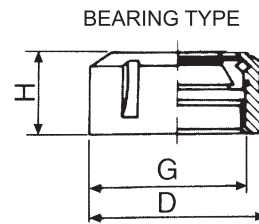

FIG.5 ER40,50KM



CLAMPING NUTS

ORDER NO.	Fig.	COLLET TYPE	D	H	G	WEIGHT KG.	CODE NO.
V-800	3	ER11UM	19	11.5	M14X0.75P	0.04	3015-001
V-801	3	ER16UM	28	17	M22X1.5P	0.05	3015-002
V-802	3	ER20UM	34	19	M25X1.5P	0.09	3015-003
V-803	4	ER25UM	42	20	M32X1.5P	0.13	3015-004
V-804	4	ER32UM	50	23	M40X1.5P	0.14	3015-005
V-805	4	ER40UM	63	25	M50X1.5P	0.25	3015-006
V-806	4	ER50UM	78	35	M64X2.0P	0.5	3015-007
V-807	1	ER11MS	16	12	M13X0.75P	0.008	3015-008
V-808	2	ER16M	22	18	M19X1.0P	0.03	3015-009
V-809	2	ER20M	28	19	M24X1.0P	0.045	3015-010
V-810A	5	ER40KM	63	29	M50X1.5P	0.3	3015-011
V-810B	5	ER50KM	78	40	M64X2.0P	0.58	3015-012
V-810C	2	ER11M	16	12	M13X0.75P	0.02	3015-013
V-810D	2	ER8M	12	10.8	M10X0.75P	0.05	3015-014
V-810E	2	ER25M	35	20	M30X1.0P	0.05	3015-015
V-811A		ER16MS	22	18	M19X1.0P	0.02	3015-016
V-811B		ER20MS	28	19	M24X1.0P	0.035	3015-017



Clamping Wrench For Collets



ER WRENCH SYSTEM

DIN6499



ERMS

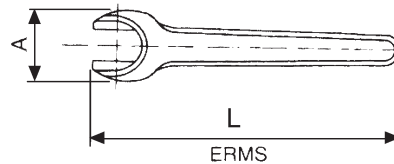

ERM

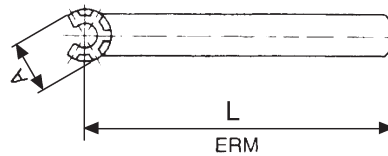

ERUM11, 16, 20

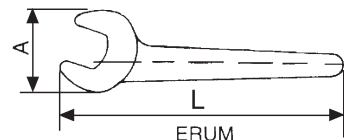

ERUM25, 32, 40, 50

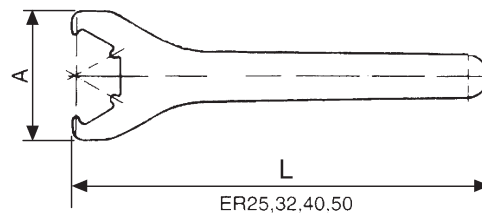

ORDER NO.	TYPE	A	L	KGS	CODE NO.
V-820	ER11UM	35	135	0.07	3015-100
V-821	ER11MS	22	100	0.07	3015-101
V-822	ER11M	17	95	0.05	3015-102
V-823	ER16M	22.5	118	0.06	3015-103
V-815	ER16UM	44	140	0.08	3015-104
V-824	ER20M	28	130	0.08	3015-105
V-816	ER20UM	53	170	0.1	3015-106
V-811	ER25UM	65	210	0.2	3015-107
V-812	ER32UM	75	250	0.4	3015-108
V-813	ER40UM	90	290	0.5	3015-109
V-814	ER50UM	110	350	0.9	3015-110
V-817	ER8M	13	75	0.04	3015-111
V-818	ER25M	36.5	135	0.1	3015-112
V-825	ER40KM	90	290	0.5	3015-113
V-826	ER50KM	110	350	0.9	3015-114
V-827	ER16MS	32	120	0.12	3015-115
V-828	ER20MS	38	150	0.15	3015-116



ER Spring Collet Chuck System



Collet Holders With BT Taper Shank
(For CNC Machine Center)
ER-32 ER-40

MAS403 BT-SHANK



BT-40-ER32



BT-40-ER20M

ACCURACY
RUNOUT 0.005mm
TAPER SHANK AT-3
R.P.M. 7000

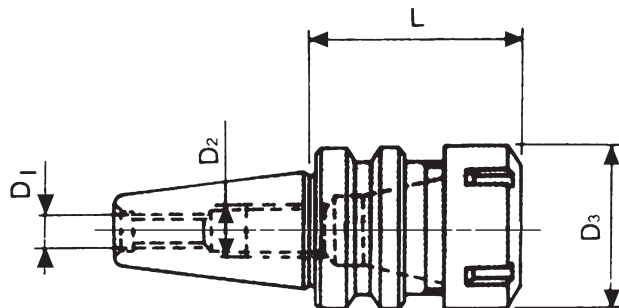

ER SYSTEM

ORDER NO.	TAPER	COLLET TYPE	D1	D2	D3	L	KGS	CODE NO.
V-700	BT30	ER32	M12	M12X1.75P	50	60	0.7	3031-303
V-703A	BT40	ER32	M16X2.0P	M22X1.5P	50	70	1.4	3032-305
V-703B		ER32	M16X2.0P	M22X1.5P	50	100	1.7	3032-306
V-704		ER40	M16X2.0P	M22X1.5P	63	80	1.7	3032-307
V-704B		ER40	M16X2.0P	M22X1.5P	63	100	2	3032-421
V-705	BT50	ER32	M24X3.0P	M28X1.5P	50	100	4.5	3033-305
V-706		ER40	M24X3.0P	M28X1.5P	63	100	4.6	3033-306
V-706B		ER40	M24X3.0P	M28X1.5P	63	150	5.7	3033-307
V-707		ER50	M24X3.0P	M36X1.5P	78	100	5.1	3033-308
V-710	BT30	ER11	M12	M12X1.75P	19	60	0.5	3033-311
V-711		ER11	M12	M12X1.75P	19	100	0.6	3033-312
V-712		ER11M	M12	M12X1.75P	16	100	0.9	3033-313
V-713		ER16	M12	M12X1.75P	28	100	0.8	3033-314
V-714		ER16M	M12	M12X1.75P	22	100	0.7	3033-315
V-715		ER20	M12	M12X1.75P	34	60	0.6	3033-316
V-716		ER20	M12	M12X1.75P	34	100	0.9	3033-317
V-717		ER20M	M12	M12X1.75P	28	100	0.9	3033-318
V-718		ER25	M12	M12X1.75P	42	60	0.7	3033-319
V-719		ER40	M12	M12X1.75P	63	70	1	3033-320
V-720		BT40	ER11	M16	M22X1.5P	19	70	1.2
V-721	ER11		M16	M22X1.5P	19	100	1.5	3033-322
V-722A	ER11M		M16	M22X1.5P	16	100	1.05	3033-323
V-722B	ER11M		M16	M22X1.5P	16	150	1.3	3033-323A
V-723A	ER16M		M16	M22X1.5P	22	100	1.3	3033-324
V-723B	ER16M		M16	M22X1.5P	22	150	1.5	3033-330
V-724A	ER20M		M16	M22X1.5P	28	100	1.6	3033-325
V-724B	ER20M		M16	M22X1.5P	28	150	1.6	3033-331
V-725	ER25		M16	M22X1.5P	42	70	1.3	3033-326
V-726	ER25		M16	M22X1.5P	42	100	1.6	3033-327
V-727	ER50		M16	M22X1.5P	78	90	2.2	3033-328