



Permanent Magnetic Lifter (ON/OFF Type)



Convenient and efficiency for makes more profit
Light weight
Less dimension
Lower price

Safety coefficient 3.5 times!

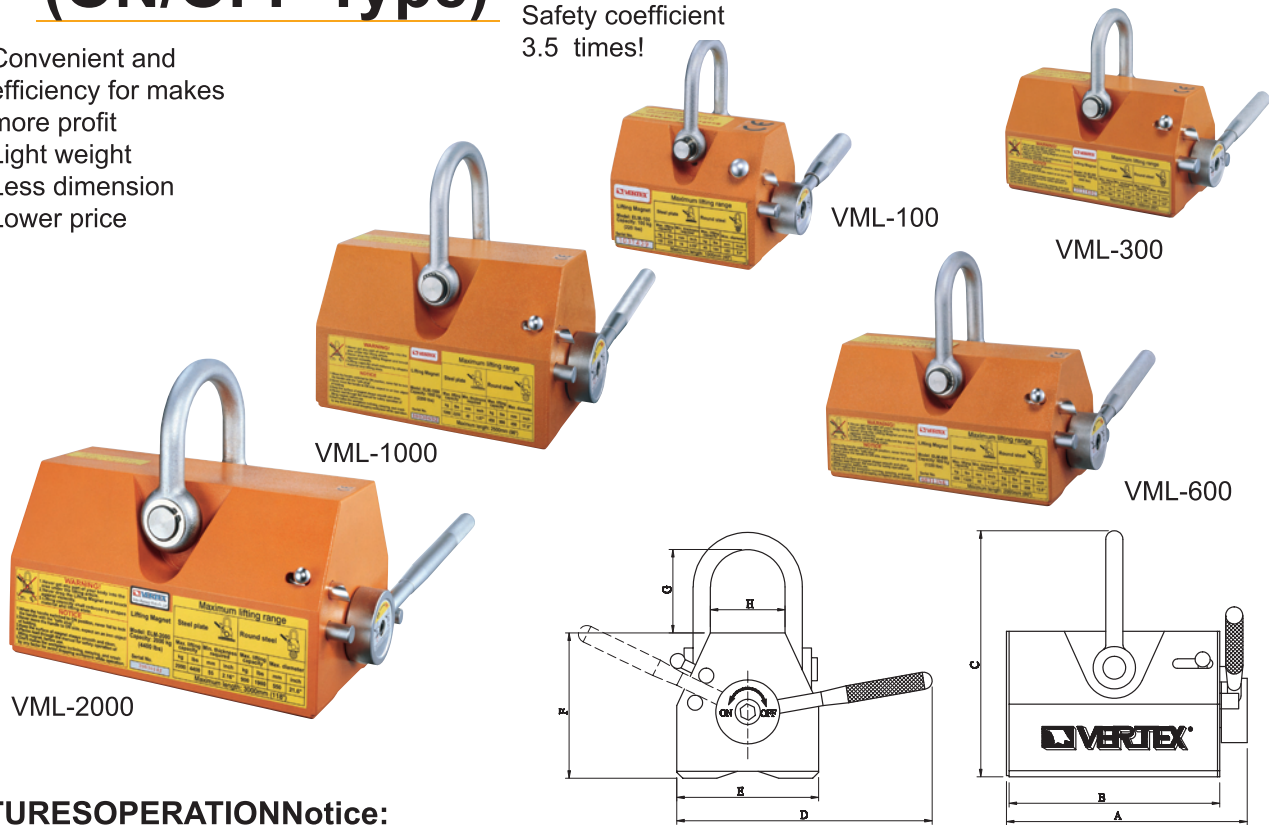

FEATURES OPERATION Notice:

- Each size suit for plate type & round type steel using.
- All new models with “light weight” less dimension” and “lower price”.
- Made by permanent magnet, require no power supply, thus eliminating hazards due to failure wiring system as electric type.
- It features powerful magnetic force, with 3.5 times safety coefficient makes more safety in use.

OPERATION

With ON/OFF switch, it is very easy and convenient to operate.

See as the example pictures as below

Notice:

Never moves the handle to “ON” side, except on an iron object of holding.

- Never operate over human’s head.

ON

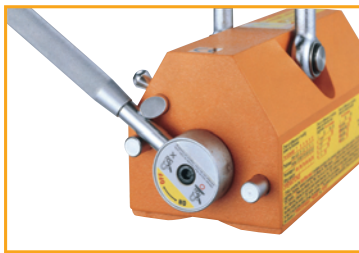

OFF

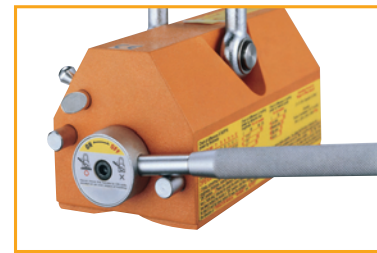

DIMENSIONS

ORDER NO.	Capacity	A	B	C	D	E	F	G	H	Weight	SAFETY COEFFICIENT	CODE NO.
	kg lbs	mm inch	mm inch	mm inch	mm inch	mm inch	mm inch	mm inch	mm inch			
VML-100	100 220	107 4.2	84 3.3	120 4.7	125 4.9	60 2.4	71 2.8	41 1.6	30 1.2	2.7 5.5	x3.5 times	2018-060
VML-300	300 660	180 7.1	155 6.1	156 6.1	185 7.3	90 3.6	93 3.7	51 2.0	41 1.6	9.1 18.9		2018-061
VML-600	600 1320	255 10	224 8.8	212 8.3	260 10.2	115 4.5	120 4.7	77 3.0	52 2.0	21.5 46		2018-062
VML-1000	1000 2200	280 11	245 9.6	286 11.3	371 14.6	165 6.5	169 6.7	97 3.8	87 3.4	53.4 101		2018-063
VML-2000	2000 4400	422 16.6	380 15	348 13.7	512 20.2	216 8.5	215 8.5	105 4.1	121 4.8	127.8 259		2018-064
VML-3TH	3000 6600	566 22.3	530 20.9	400 15.7	770 30.3	216 8.5	222 8.7	147 5.8	80 3.2	181 399	x3.0 times	2018-065



Permanent Magnetic Lifter (ON/OFF Type)



APPLICATIONS

- Suitable for move plate steel, block steel and round steel, such as machine parts, press molds, plastic molds and iron materialetc.

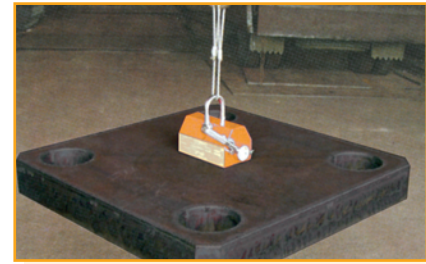
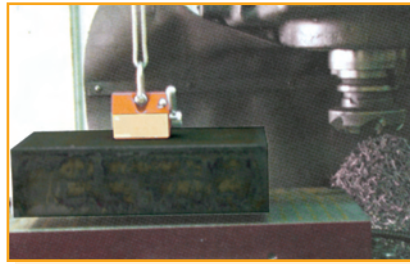

MAGNETIC LIFTER

LOAD OF HOLDING POWER

- The load of holding power will changes depending on the thickness, attractive face roughness and quality of material and clearance between the workpiece with magnet.

	Thickness		Percentage of lifting capacity					
	mm	inch	VML-3000	VML-2000	VML-1000	VML-600	VML-300	VML-100
T1	up 60	up 2.36"	100%	100%	100%	100%	100%	100%
T2	55	2.16"	95%					
T3	50	1.97"	90%					
T4	45	1.77"	85%					
T5	40	1.57"	80%	85%	90%	90%	90%	
T6	35	1.38"	70%	75%				
T7	30	1.18"	60%	65%	80%	90%	90%	
T8	25	0.98"	50%	55%	70%	90%	90%	
T9	20	0.79"	40%	45%	60%	75%	90%	
T10	15	0.59"	30%	35%	50%	60%	70%	
T11	10	0.39"	20%	25%	35%	45%	50%	70%
T12	5	0.20"	10%	15%	20%	25%	30%	40%

Table of difference in holding power by attractive face roughness For all models

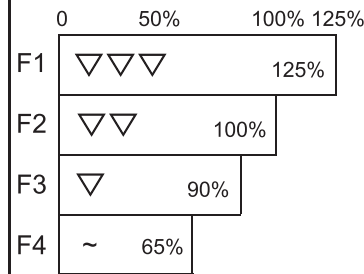
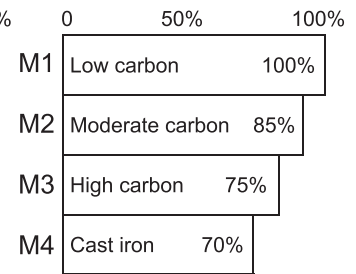

Table of difference in holding power by material quality For all models



Calculating Formula for "Range of Lifting Capacity" → (Tx Fx M x Capacity of Lifter)

Example:

Terms of workpiece: T8, F1 and M2



90% x 125% x 85% x 600kgs (VML-600)=573kgs

SAFETY COEFFICIENT x 3.5 times

The capacity of magnet indicated as 1/3.5 of holding power, it means the real holding power is 3.3 times of capacity. For example the capacity of VML-600 is 600kgs (1320lbs) but the real holding power is 1980kgs (4350lbs).

The large safety coefficient is consideration for ensuring the use in safety.

MAXIMUM LIFTING RANGE

FORM OF MATERIAL	STEEL PLATE 		ROUND STEEL 			Maximum length
	Max.lifting capacity	Min.thickness required	Max.lifting capacity	Min Dia	Max.diameter	
ORDER NO.	kg lbs	mm inch	kg lbs	mm	mm inch	mm inch
	VML-100	100 220	15 0.59"	58 125	80	150 5.9"
VML-300	300 660	25 0.98"	175 380	100	250 9.8"	1500 60"
VML-600	600 1320	30 1.18"	345 760	180	350 13.8"	2000 80"
VML-1000	1000 2200	40 1.57"	570 1255	230	450 17.8"	2500 98"
VML-2000	2000 4400	55 2.16"	1140 2510	260	550 21.6"	3000 118"
VML-3TH	3000 6600	60 2.36"	1710 3675	300	650 25.6"	3500 138"

Magnetic Lifter



CAM TYPE

FEATURES

- Normal operation is not influenced on power off or system breakdown, as there is permanent magnet.
- Cam mechanism, easy operation.
- Ground surface of workpiece may be attracted to be scrap occasionally, please be careful.

LOADING

- Take the magnetic table on the workpiece, and move it at the vertical position.

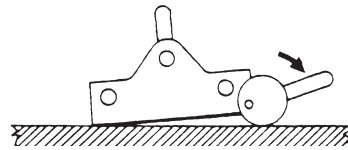
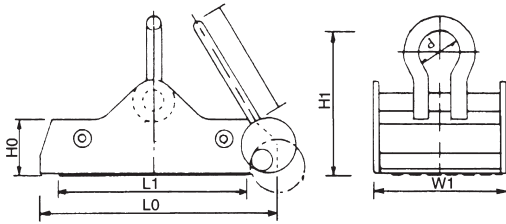
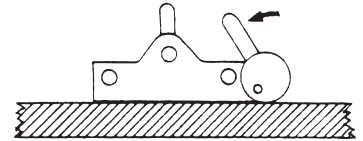

UNLOADING

- Move the level at the horizontal position, the workpiece will be separated.

- Never operate over human's head.

ORDER NO.	CAPACITY	W1	L1	L0	H0	H1	d	l	NET WEIGHT (KGS)	CODE NO.
VGP-100	1000kg	204	298	366	65	125	50	135	25.8	2018-040
VGP-200	2000kg	330	380	445	130				46.8	2018-041

Magnetic Holder

HANDLE TYPE

FEATURES

- Work is held and released very smoothly.
- Most suitable to move materials or semi-finished products such as black steel plate, flat iron and other materials etc.

HOLDING POWER

It depends on the attractive face, quality and thickness of material and clearance between the material and magnet.

MAXIMUM HOLDING POWER

Workpiece must be thick enough and the surface must be free of dust. magnetic attraction is best and with low carbon-soft steels.



VML-80

VML-140

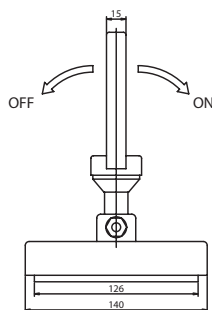
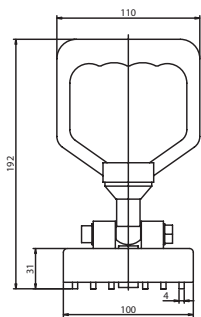

VML-150

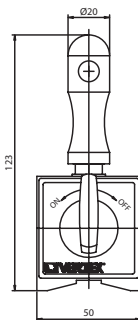

VML-80

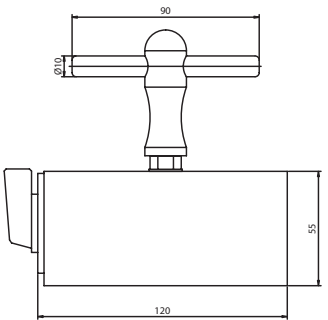
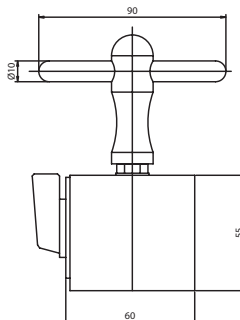

VML-140

Unit:mm

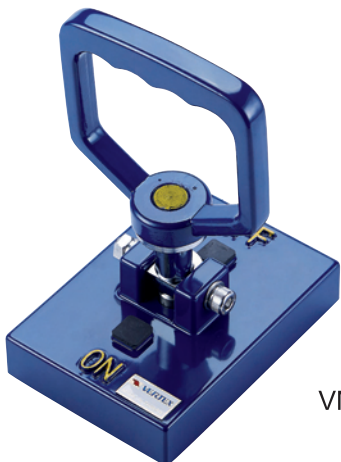

VML-150

ORDER NO.	CAPACITY	L	W	H	N.W (KGS)	CODE NO.
VML-80	80kgf	60	50	55	1.23	2018-054
VML-140	140kgf	120	50	55	2.2	2018-055
VML-150	150kgf	140	100	192	2.5	2018-056

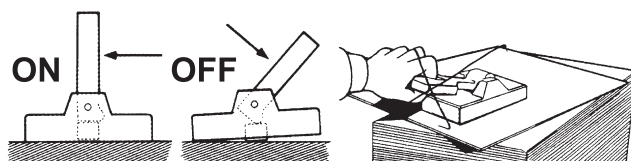



Demagnetizer



- Suit for drill, end mill, hard ware, cutting tool...etc.
- Handy type, it can also use the cutting tool.
- ※ Guaranteed for 3 months.

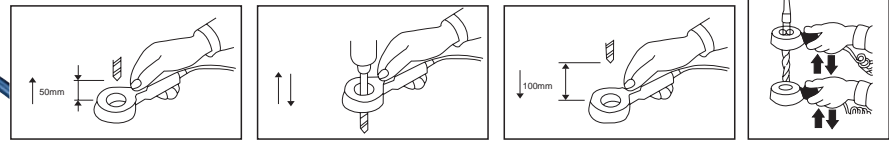

ORDER NO.	INPUT VOLTAG	CURRENT	POWER	DUTY CYCLE	HOLE CAPACITY	WEIGHT KGS	CODE NO.
VDM-40	AC110V/220V	0.5A	80W	20%	Ø40MM	1.3	2019-030



- Handy Type**
For Bigger Or Heavy Workpiece
- ※ Light Duty Only
 - ※ Guaranteed for 3 months.
 - ※ Built-in over-heat safety Stop

- Suit for molding.
- Work perfectly in the narrow place.
- No need to remove the workpiece.

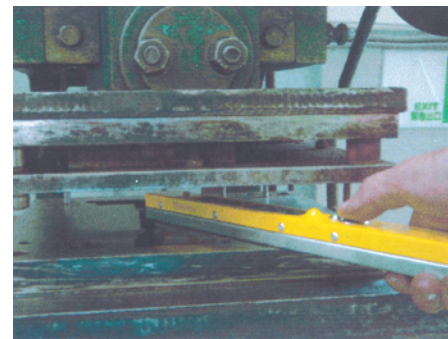

ORDER NO.	INPUT VOLTAGE (SINGLE PHASE)	CURRENT	※ USING TIME	DIMENSION			WEIGHT KGS	CODE NO.
				L	M	H		
VDM-50	110V/220V/1PH	1.2A	Demagnetize 1 minute waiting 4 minutes	345	35	25	1.2	2019-031



Demagnetizer

Demagnetizer one way only →

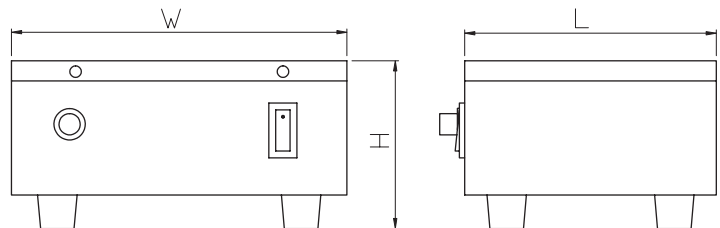

FEATURES

- Suitable for general component spare parts, attachments, tools, etc, for fixed way demagnetization.
- Suitable for longtime use; be able to use continuously for 24 hours. Rest 10 Min Per 3 hrs.
- With the design of double coils inside to avoid heat release.
- ※ Guaranteed for 3 months.
- ※ If operate ↔ will cause item magnetized

DELUXE TYPE

ORDER NO.	INPUT VOLTAGE	CAPACITY	DUTY CYCLE	DIMENSION			NW KGS	CODE NO.
				L	W	H		
VDM-68	110V/220V	AC-330VA	100%	140	195	110	7.4	2019-001

Unit:mm



Demagnetizer



VDM-8



VDM-11



VDM-14

FEATURES

- Input voltage 110-220 Volts AC.
- With On-Off switch.
- Quickly Demagnetizes tools, drills punches, dies, etc. Held by magnetic chucks. Parts are demagnetized by drawing across surface.
- Voltage 200-240 should be ordered.
- ※ Guaranteed for 3 months.

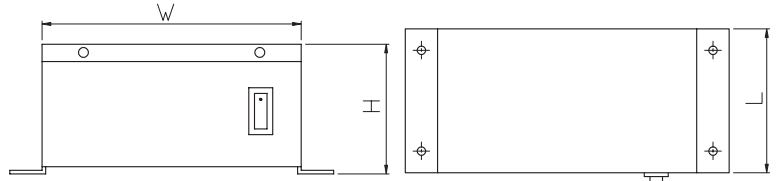

Unit:mm

ORDER NO.	INPUT VOLTAGE	CAPACITY	WORKING SURFACE	HEIGHT	WEIGHT (KGS)	DUTY CYCLE	CODE NO.
VDM-8	AC 110V 220V	210VA	160X110	100	4.5	50%	2019-011
VDM-11	AC 110V 220V	550VA	200X280	130	16	100%	2019-021
VDM-14	AC 220V 380V	8A	585x335	120	40		2019-013



Mini Type Demagnetizer

FOR HANDY AND CAN NOT BE MOVED OBJECT

- Suitable for large type workpiece.
- ※ Guaranteed for 3 months.

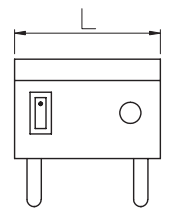
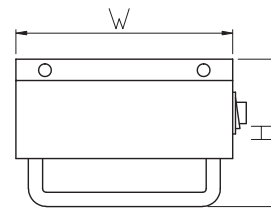
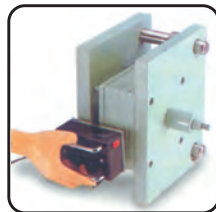
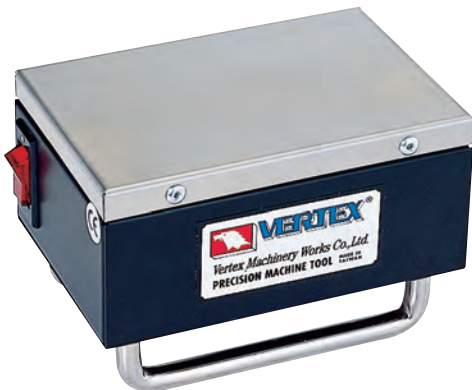

Unit:mm

ORDER NO.	INPUT VOLTAGE	CAPACITY	WORKING SURFACE	HEIGHT	WEIGHT (KGS)	DUTY CYCLE	CODE NO.
VDM-9	AC 110V 220V	110VA	123X83	83	1.8	90%	2019-020



Tunnel Type Demagnetizer And Magnetizer

FEATURES

- Merely using tools to pass through or move into a tunnel will cause a good demagnetizing effect.
- Suitable for planned automatic process; be adapted for delivery belts to proceed in order to increase productivity.
- Suitable for hand manual tools, etc. for filling magnetism.
- Suitable for large production of component spare parts, attachments, tools...etc.
- Suitable for longtime use; be able to use continuously for 24 hours.
- Super efficacy in demagnetizing and magnetizing; suitable for many kinds of metals.
- Attached a fan inside for dissipating heat.
- ※ Guaranteed for 3 months.

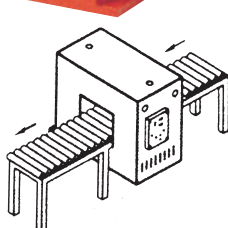
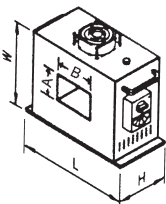
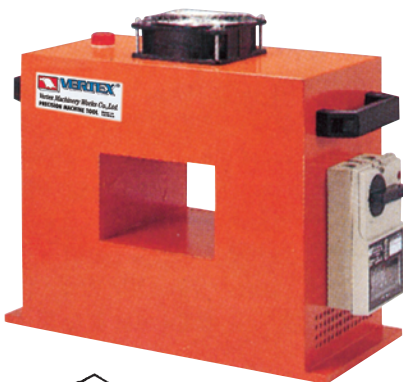

ORDER NO.	POWER SOURCE	CAPACITY	DIMENSION			THROUGH HOLE		NET WEIGHT KGS	DUTY CYCLE	CODE NO.
			L	W	H	A	B			
VDM-150	AC 220/380V (single phase)	3520 VA	370	370	200	100	150	33	100%	2019-025
VDM-250		4840 VA	470	370	200	150	250			52
VDM-450	AC 220/380V (3 phase)	4400 VA	700	500	200	250	450	80		2019-027



Chip Collector Mini Handy Type



NEW



- Pull the trigger to drop attracted items easily.
 - Permanent magnet.
 - Light and handy design fitting ergonomics.
 - Easy to pick up various kinds of hand of hand tools and small iron or steel parts for office, house and factory.
 - Impact-proof plastic materials.
- ※ Need normal work temp

Unit:mm

ORDER NO.	PACKING	HOLDING MASS	CUFT	DIMENSION			WEIGHT KGS	CODE NO.
				L	W	H		
VCC-16	Color BOX	0.65	0.09'	110	110	190	0.7	2019-040



Chip Collector With Adjustable Arm Type

NEW



- Work perfectly in the narrow space.
- Pick up ferrous metal items such as tools, bolt, paper clips, nails, etc.
- Deluxe handle for comfort.
- Easy to use, safe, practical and time saving.
- Permanent magnet.
- Weight : 2 kgs

ORDER NO.	MAGNETIC BASE	HOLDING MASS	CUFT	TOTAL LENGTH	CODE NO.
VCC-17A	120x70mm	0.7	0.4'	700 mm	2019-041A



Chip Collector With Wheels

NEW



- Easy to use, safe and practical time saving device.
- Release magnetic pick up tool has a magnetic device which enable to attract any metal items and spare parts laying on the floor without the trouble to pick them up one by one.
- Pull the trigger to release magnetic force.
- Permanent magnet.

ORDER NO.	PACKING	HOLDING MASS	kgf	CUFT	LENGTH	WEIGHT KGS	TOTAL WIDTH	CODE NO.
VCC-19	In Bulk	0.85	83	1.15'	720~1035mm	1.5	377 mm	2019-043



Chip Collector With Flexible Arm

Flexible Magnetic Pick-Up Tool

WEIGHT:0.4kg

NEW

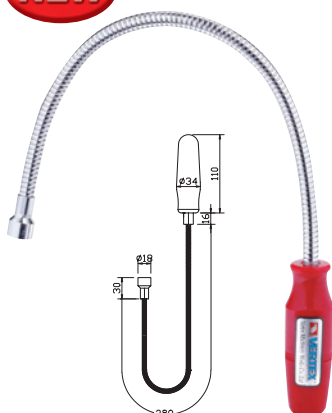

ORDER NO.	VCC-20
PACKING	Tied On Card
HOLDING MASS	0.11
CUFT	0.04'
LENGTH	533 mm
CAPACITY	1.2 lbs / 0.54kgs / 50kgf
CODE NO.	2019-044



Chip Collector With LED

Lighted Flexible Magnetic Pick-Up Tool

WEIGHT:0.2kg

NEW



ORDER NO.	VCC-21
PACKING	Tied On Card
HOLDING MASS	0.08
CUFT	0.04'
LENGTH	533 mm
CAPACITY	0.7 lbs / 0.31kgs / 30kgf
CODE NO.	2019-045

With 2pc 1.5V batteries



Magnetic V Block



1 PCS

- For round / square workpiece
- For checking on surface plate during the production.
- For measuring
- V ANGLE 90°
- ※ Not for LABORATORY.

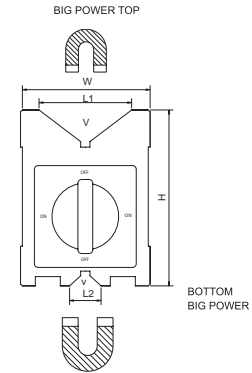
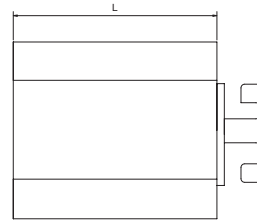
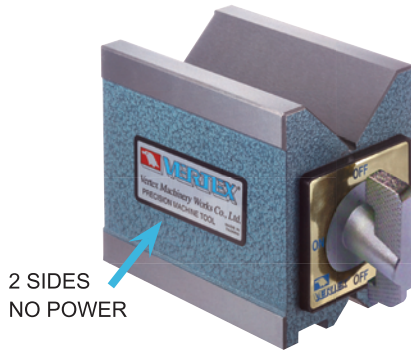

ORDER NO.	Magnetic Power(pull)	V	v	Dimension					Wt. kgs	CODE NO.
				H	W	L	L1	L2		
VCP-25	70kgf	ø7~ø60	ø7~ø25	95.3 3.75"	70 2.76"	101.6 4"	45 1.97"	18 0.75"	3.9	2015-501



Magnetic V Block

1 PCS

- For round / square workpiece
- For checking on surface plate during the production.
- For measuring
- V ANGLE 90°
- ※ Not for LABORATORY.

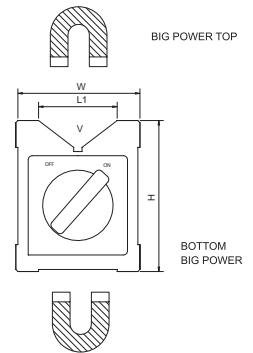
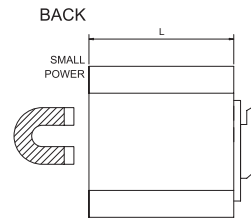
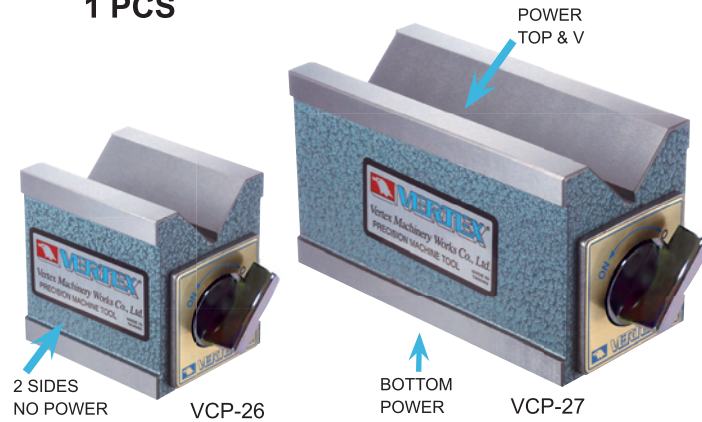

ORDER NO.	Magnetic Power(pull)	V	Dimension				Wt. kgs	CODE NO.
			H	W	L	L1		
VCP-26	50kgf	ø8~ø50	73 2.87"	60 2.13"	70 2.76"	37 1.5"	1.8	2015-510
VCP-27	70kgf	ø8~ø50	73 2.87"	60 2.36"	125 4.29"	38 1.5"	3.3	2015-511



Magnetic V Block

PAIR

Magnetic V-Block

- Two pieces finished to the same dimension and accuracy are used together as a set.
- For round / square workpiece
- For checking on surface plate during the production.
- V ANGLE 90°
- ※ Not for LABORATORY.

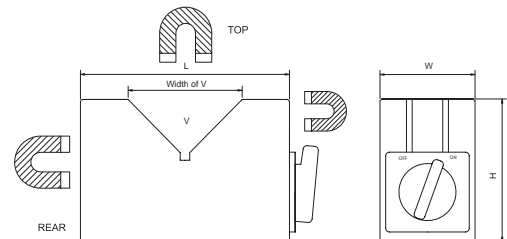
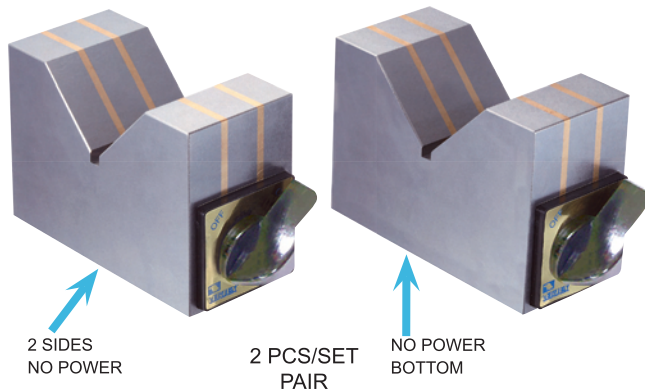

ORDER NO.	Magnetic Power(pull)	V	Dimension			Width of V	Wt. kgs	CODE NO.
			H	W	L			
VCP-28	15kgf	ø8~ø34	50	40	70	ø50	2.0	2015-520
VCP-29	17kgf	ø8~ø80	74 2.91"	48 1.77"	110 4.33"	60 2.36"	4.9	2015-521
VCP-30	23kgf	ø8~ø120	100 3.94"	50 1.97"	150 5.91"	90 3.54"	8.9	2015-522



Magnetic Square Block



FOR MEASURING

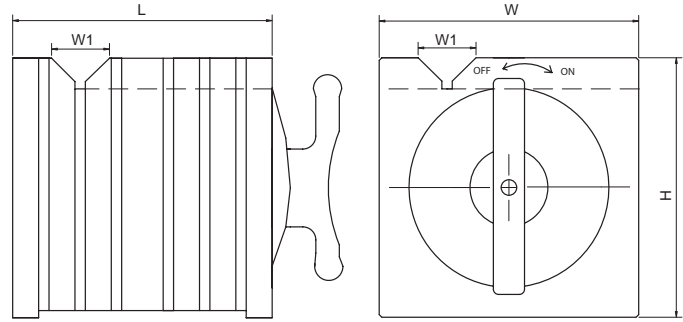
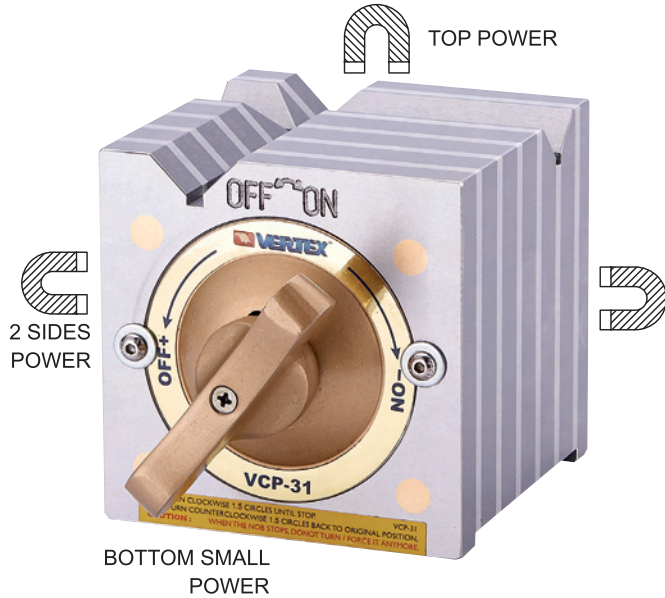

MAGNETIC BLOCK

- The V-Blocks and Parallels transfer the magnetism from permanent magnetic chucks.
- The steel used in all V-Blocks and Parallels is selected for the highest magnetic transfer and is cast integrally with aluminum.
- For measuring
 - V ANGLE 90°
- ※ Not for LABORATORY

ORDER NO.	Mag. Power of V groove	Mag. Power of base	V	H	W	L	W1	Wt. kgs	CODE NO.
VCP-31	25kgf	50kgf	ø7~ø22	100 3.94"	100 3.94"	100 3.94"	23 1.02"	6.5	2015-530
VCP-32	50kgf	140kgf	ø7~ø29	150 5.91"	150 5.91"	150 5.91"	29 1.26"	20.3	2015-531



Magnetic Square Holder

NEW

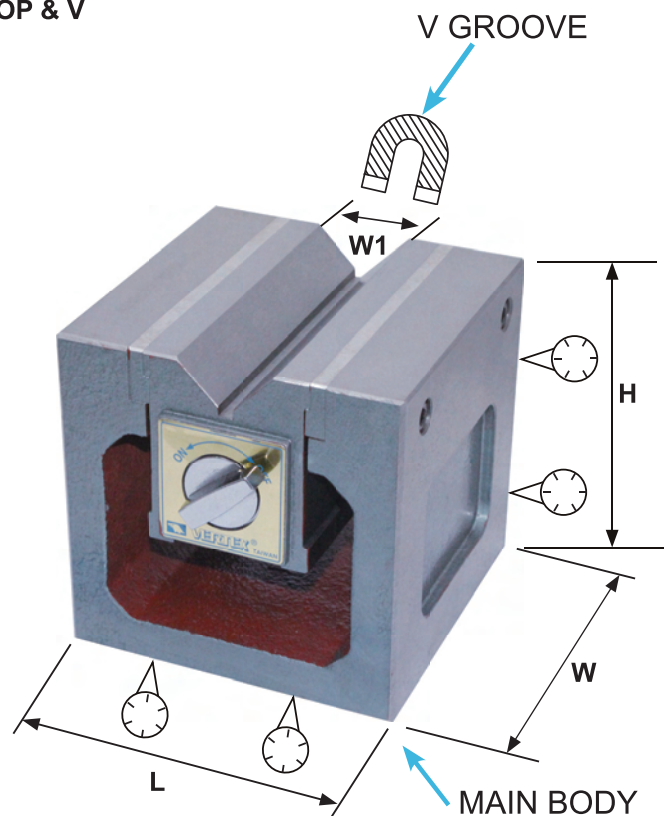
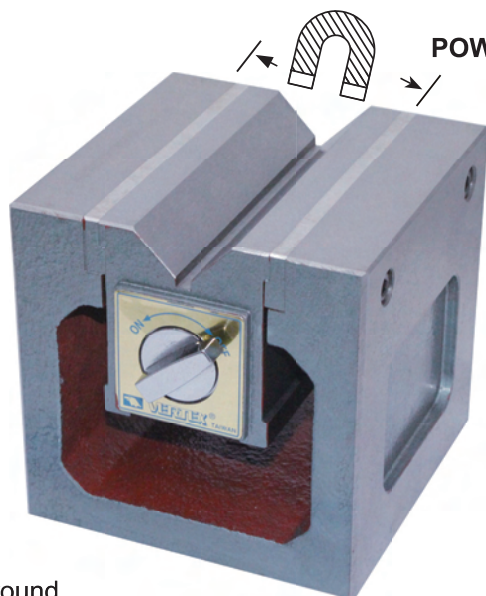

- Precision ground
- Base & V groove parallelism : 0.02 / 100 mm
- Magnetic power : V groove only
- MAIN BODY : CAST IRON
- Light duty, for measuring
- Easy movement
- Multi - type
- V ANGLE 90°
- ※ Not for LABORATORY.

ORDER NO.	Mag. Power of V groove	V	H	W	L	W1	Wt. kgs	CODE NO.
VCP-40	70kgf	ø8~ø50	125	125	125	37	8.54	2015-540



Magnetic Tools FOR DIAL GAUGE, INDICATORS



FIXED ARM TYPE VMB-B,01,02 THE DIAL CLAMP HOLE Ø6.5 & Ø8

MAGNETIC BASE CENTER HOLE THREAD M8x1.25P

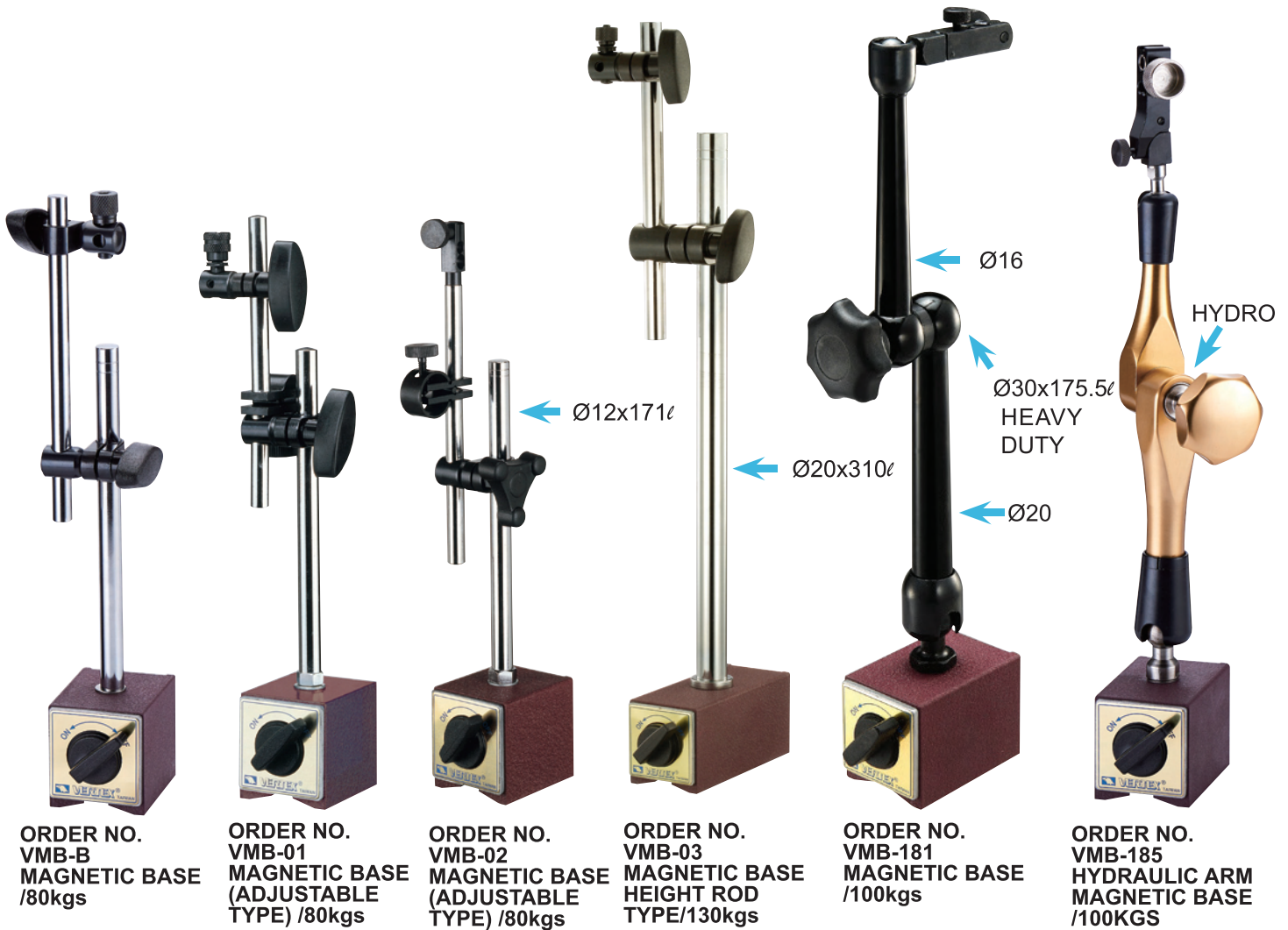

※knob may vary & shape & color

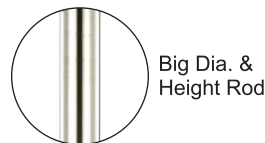

- If you would like to turn around the ARM of VMB series, don't rotate the ARM directly, because the thread in the base will be disintegrated, please loose the knob first (in the middle of ARM), then the ARM will be rotated, thanks! After you set the position, Fix the Knob.
- Before you set the new position, you must loose the knob. Hold at the connection between Rod & Base to prevent thread breaking.

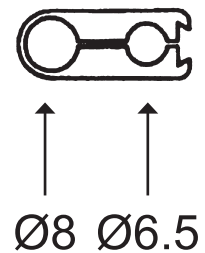

ORDER NO.	BASE SIZE LxWxH(MM)	HOLDING POWER	MAIN ROD O.D X L	SUB ROD O.D X L	WEIGHT (KGS)	CODE NO.
VMB-B	60x50x55	80KGS	Ø12X173	Ø10X162	1.6	2015-601
VMB-01	60x50x55	80KGS	Ø12X176	Ø10X150	1.6	2015-602
VMB-02	60x50x55	80KGS	Ø12X171	Ø10X153	1.6	2015-603
VMB-03	115x50x55	130KGS	Ø20X310	Ø14X200	3.9	2015-607
VMB-181	73x50x55	100KGS	Ø30X175.5	Ø21x137	1.9	2015-609A
VMB-185	73x50x55	100KGS	Ø31X124.5	Ø28x113	2.0	2015-609B



Magnetic Tools FOR DIAL GAUGE, INDICATORS



UNIVERSAL ARM TYPE
THE DIAL CLAMP HOLE Ø6.5 & Ø8

※knob may vary [& shape & color]

MAGNETIC BASE CENTER HOLE THREAD M8x1.25P

WITHOUT DIAL
INDICATOR

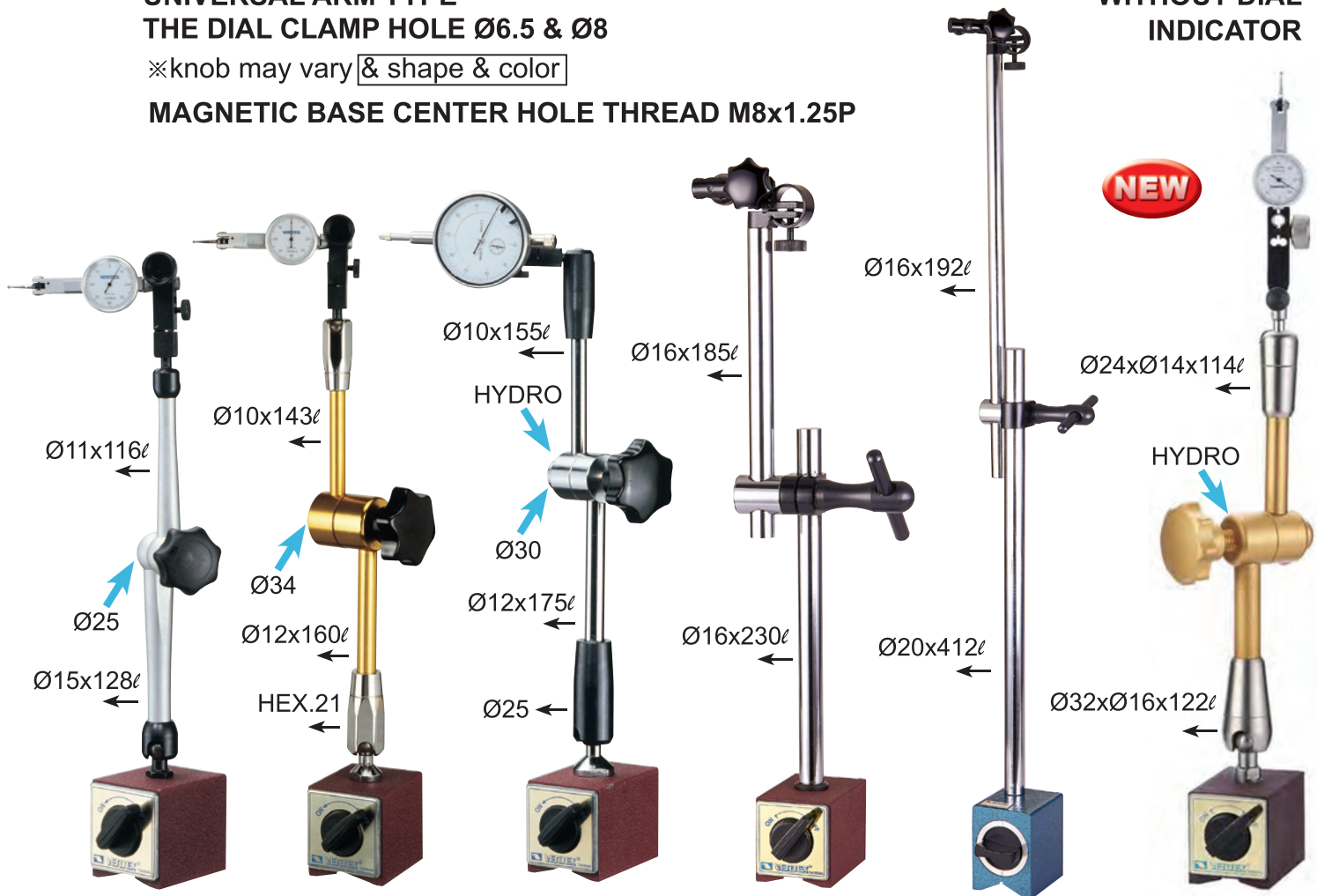

ORDER NO.
VMB-70
DELUXE UNIVERSAL
MAGNETIC BASE/
100kgs

ORDER NO.
VMB-106
MECHANICAL ARM
MAGNETIC BASE/
100kgs

ORDER NO.
VMB-106H
HYDRAULIC ARM
MAGNETIC BASE/
100kgs

ORDER NO.
VMB-160
MAGNETIC BASE
HEIGHT ROD
TYPE (Adj.)
100kgs

ORDER NO.
VMB-180
MAGNETIC BASE
HEIGHT ROD
TYPE (Adj.)
100kgs

ORDER NO.
VMB-182H
HYDRAULIC ARM
MAGNETIC BASE/
100kgs

- If you would like to turn around the ARM of VMB series, don't rotate the ARM directly, because the thread in the base will be disintegrated, please loose the knob first (in the middle of ARM), then the ARM will be rotated, thanks! After you set the position, Fix the Knob.
- Before you set the new position, you must loose the knob.
Hold at the connection between Rod & Base to prevent thread breaking.
- Hold the Mag. Base while moving & lifting

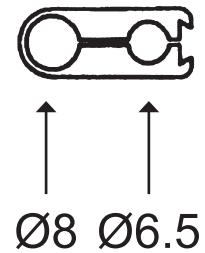

ORDER NO.	BASE SIZE LxWxH(MM)	HOLDING POWER	MAIN ROD O.D X L	SUB ROD O.D X L	WEIGHT (KGS)	CODE NO.
VMB-70	73x50x55	100KGS	Ø15X128	Ø11X116	1.7	2015-604
VMB-106	73x50x55	100KGS	Ø12X160	Ø10X143	1.9	2015-605
VMB-106H	75x50x55	100KGS	Ø12X175	Ø10X155	2.2	2015-606
VMB-160	73x50x55	100KGS	Ø16x230	Ø16x185	2.1	2015-608
VMB-180	75x60x80	100KGS	Ø20x412	Ø16x192	3.8	2015-609
VMB-182H	73x50x55	100KGS	Ø32xØ16x122	Ø24xØ14x114	1.75	2015-600