



# Super-High Jaw MC Vise



SAME HEIGHT GUARANTEE

**NEW**



**VQHJ-5  
STANDARD TYPE**

**VQHJ-6  
STANDARD TYPE**

### Features

- High jaw allows bigger clamping capacity.
- Strong clamping jaw plates.
- Compact design. Great clamping capacity & rigid.
- Large jaw stroke range.
- Exclusive Power Vise provide same height same position for horizontal and vertical MC, NC, machine.
- Body is made of FCD60 high quality ductile cast iron, resists deflection or bending.
- Sliding bed ways flame hardened and ground.
- Concealed spindle for protection against chips and dirt.
- Quick of clamping & locking and easy of operation.
- Clamping power will reduce 20% while clamping at higher position.
- Hydro line-one scale indicate 1/3 of the max. clamp force.

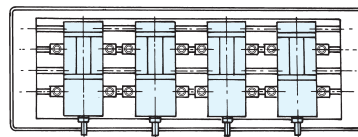
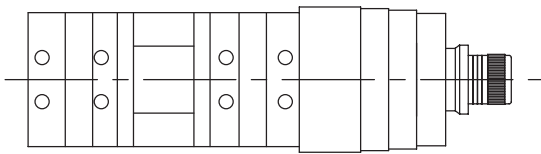

Aligned Performance

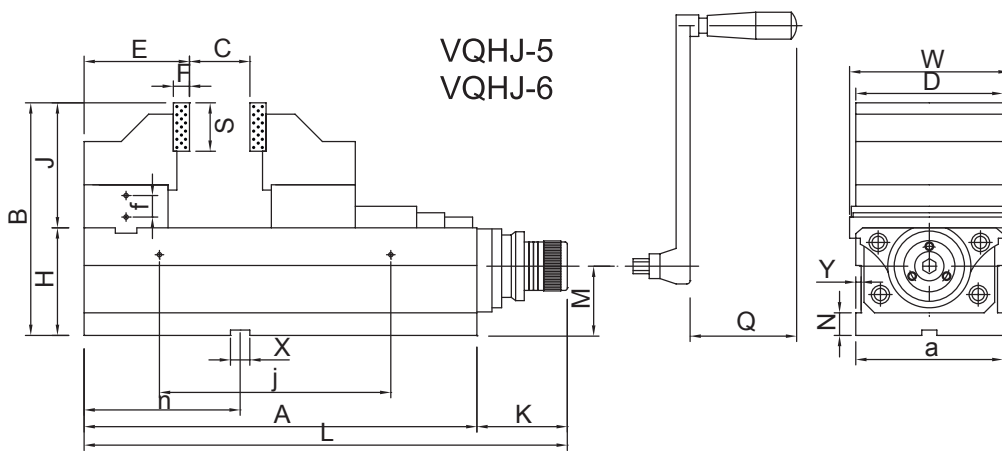

### MAX. CLAMPING FORCE

| ORDER NO. | FORCE (KN) |
|-----------|------------|
| VQHJ-5    | 24         |
| VQHJ-6    | 36         |
| VQHJ-V130 | 24         |
| VQHJ-V160 | 36         |
| VQHJ-S130 | 24         |
| VQHJ-S160 | 36         |

※ VQHJ-S130, VQHJ-S160 ARE PLAIN JAW PLATE TYPE



| ORDER NO. | A   | B   | C open | a   | D   | E   | F  | H   | J   | K     | L     | M  | N  | Q  | W   | X  | S         | Y | f  | j   | n   | P  | WEIGHT (kgs) | CODE NO. |
|-----------|-----|-----|--------|-----|-----|-----|----|-----|-----|-------|-------|----|----|----|-----|----|-----------|---|----|-----|-----|----|--------------|----------|
| VQHJ-5    | 365 | 223 | 160    | 124 | 124 | 99  | 15 | 100 | 123 | 113.5 | 478.5 | 65 | 21 | 73 | 135 | 18 | 45        | 7 | 20 | 215 | 145 | 86 | 51.8         | 4005-201 |
| VQHJ-6    | 455 | 249 | 225    | 160 | 160 | 108 | 18 | 120 | 129 | 125.5 | 580.5 | 78 | 21 | 93 | 170 | 18 | 54        | 7 | 20 | 285 | 145 | 86 | 85.8         | 4005-202 |
| VQHJ-V130 | 365 | 220 | 180    | 124 | 124 | 90  | 80 | 100 | 120 | 113.5 | 478.5 | 65 | 21 | 73 | 135 | 18 | ∅12~∅90   | 7 | 20 | 215 | 145 | 86 | 51.8         | 4005-203 |
| VQHJ-V160 | 455 | 245 | 250    | 160 | 160 | 98  | 85 | 120 | 125 | 125.5 | 580.5 | 78 | 21 | 93 | 170 | 18 | ∅16~∅120  | 7 | 20 | 285 | 145 | 86 | 85.8         | 4005-204 |
| VQHJ-S130 | 365 | 220 | 180    | 124 | 124 | 90  | /  | 100 | 120 | 113.5 | 478.5 | 65 | 21 | 73 | 135 | 18 | PLAIN JAW | 7 | 20 | 215 | 145 | 86 | 51.8         | 4005-205 |
| VQHJ-S160 | 455 | 245 | 250    | 160 | 160 | 98  | /  | 120 | 125 | 125.5 | 580.5 | 78 | 21 | 93 | 170 | 18 | PLAIN JAW | 7 | 20 | 285 | 145 | 86 | 85.8         | 4005-206 |



# Super-High Jaw MC Vise



SAME HEIGHT GUARANTEE

**NEW**

SOFT JAW

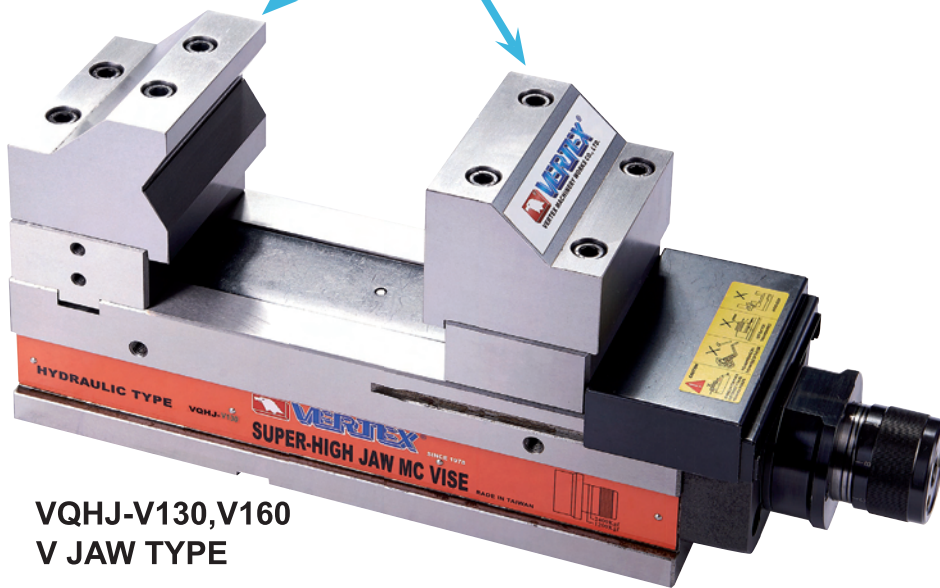

**VQHJ-V130, V160  
V JAW TYPE**



※ VQHJ-S130, VQHJ-S160  
ARE PLATIN JAW PLATE TYPE

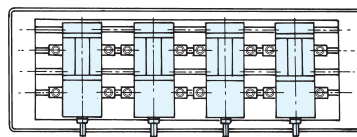

Aligned Performance

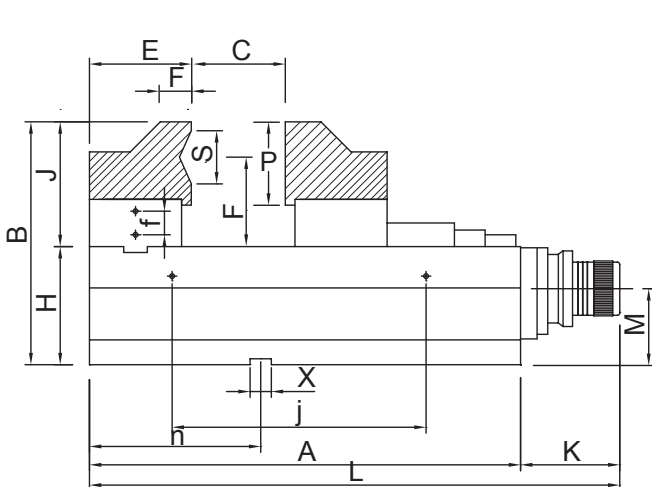
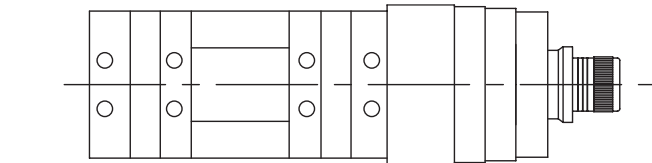

## VQHJ-V130 / V160

- V Shape High Jaw For Round Workpiece.
- Clamping Power Will Reduce When Clamping Round Workpiece.
- Always Remove Handle After Workpiece Is Tightened.

## Features

- High jaw allows bigger clamping capacity.
- Strong clamping jaw plates.
- Compact design. Great clamping capacity & rigid.
- Large jaw stroke range.
- Exclusive Power Vise provide same height same position for horizontal and vertical MC, NC, machine.
- Body is made of FCD60 high quality ductile cast iron, resists deflection or bending.
- Sliding bed ways flame hardened and ground.
- Concealed spindle for protection against chips and dirt.
- Quick of clamping & locking and easy of operation.
- Clamping power will reduce 20% while clamping at higher position.
- Hydro line-one scale indicate 1/3 of the max. clamp force.

**VQHJ-S160 60V 120° FOR  $\phi 16\sim\phi 120$   
ROUND WORK PIECE**

**VQHJ-S130 46V 120° FOR  $\phi 12\sim\phi 90$   
ROUND WORK PIECE**

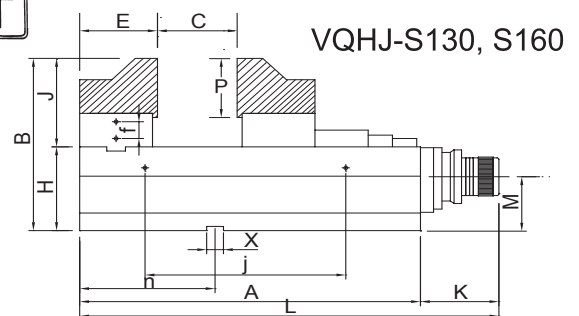

VQHJ-S130, S160

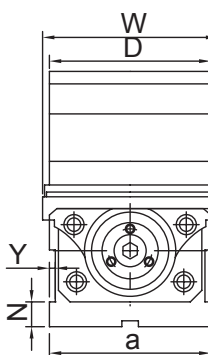

VQHJ-V130  
VQHJ-V160

SUPER-HIGH JAW MC VISE



# MC Hyper Super Open Vise



HYDRAULIC TYPE

SAME HIGH GUARANTEE

- VMCH - 4 JAW OPENED 200 mm
- VMCH - 5 JAW OPENED 265 mm
- VMCH - 6 JAW OPENED 350 mm

**NEW**



**COMPARE WITH SAME WIDTH VISE JAW, THE BIGGEST OPENING CAPACITY.**

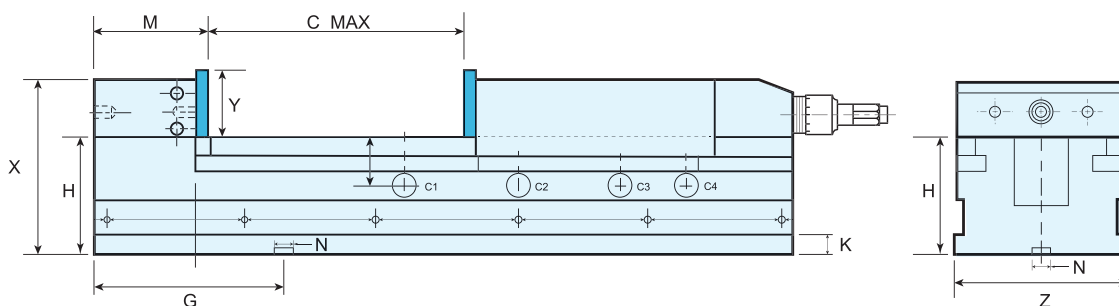
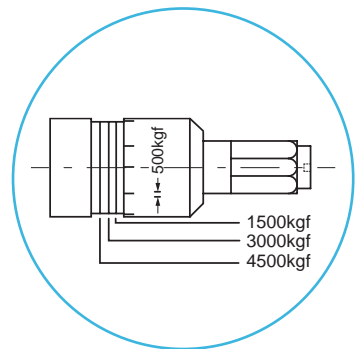
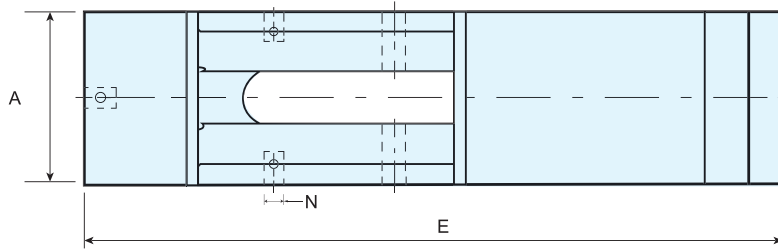

## Features

- Hydro-booster system for maximum clamping pressure with minimum force.
- Sliding bed ways flame hardened and ground.
- Compact design. Great clamping capacity. Light & smooth operation.
- Body is made of FCD60 ductile cast iron, High deflection / bending resistant.
- Constructed for machining center, milling, drilling, grinding and many other machine shop applications.
- Hydro line - one scale indicate about 500 kgf of the clamp force.

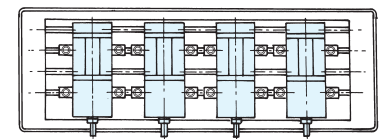

Aligned Performance

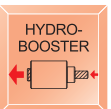
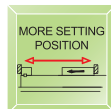
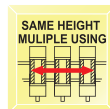

## Specifications

| ORDER NO. | A   | C MAX | Opening Size For Capacity |         |         |         | E   | G   | H   | K  | M   | N  | X   | Y  | Z   | MAX. Clamp Force (kgf) | N.W. (kgs) | CFT (cm) | CODE NO. |
|-----------|-----|-------|---------------------------|---------|---------|---------|-----|-----|-----|----|-----|----|-----|----|-----|------------------------|------------|----------|----------|
|           |     |       | C1                        | C2      | C3      | C4      |     |     |     |    |     |    |     |    |     |                        |            |          |          |
| VMCH-4    | 110 | 200   | 0-58                      | 58-115  | 115-170 | 150-200 | 435 | 132 | 85  | 15 | 88  | 16 | 118 | 36 | 112 | 2500                   | 26         |          | 1002-225 |
| VMCH-5    | 134 | 265   | 0-70                      | 70-145  | 145-215 | 200-265 | 550 | 160 | 95  | 21 | 98  | 18 | 140 | 48 | 136 | 4500                   | 45.5       |          | 1002-226 |
| VMCH-6    | 154 | 350   | 0-100                     | 100-200 | 200-300 | 300-350 | 618 | 165 | 105 | 21 | 103 | 18 | 156 | 54 | 155 | 4500                   | 63.5       |          | 1002-227 |





# Precision Pneumatic Ang-Fixed Power Vise



SAME HEIGHT GUARANTEE

Suitable for Mass production and to be used on machine centers, milling machines, drilling machines and special purpose machines.

ANG-FIXED POWER VISE

The greatest safety distance of clamping:  
The switch speed is only 1.5 seconds, and the safety distance of clamping can be up to 8mm. We design the hand wheel safety line in addition for anyone to distinguish the clamping safety distance of tools from exceeding the limit easily by eyes.

Down trust "semi-spherical segment" mechanism eliminates jaw lifting and work-piece lifting.

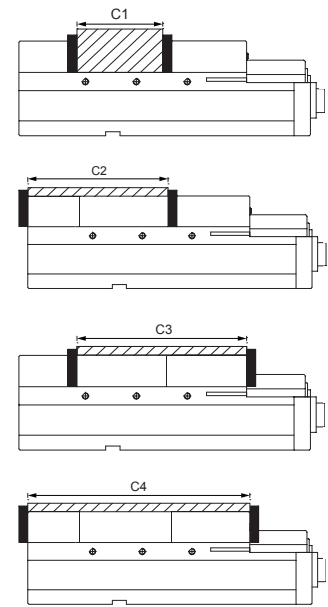
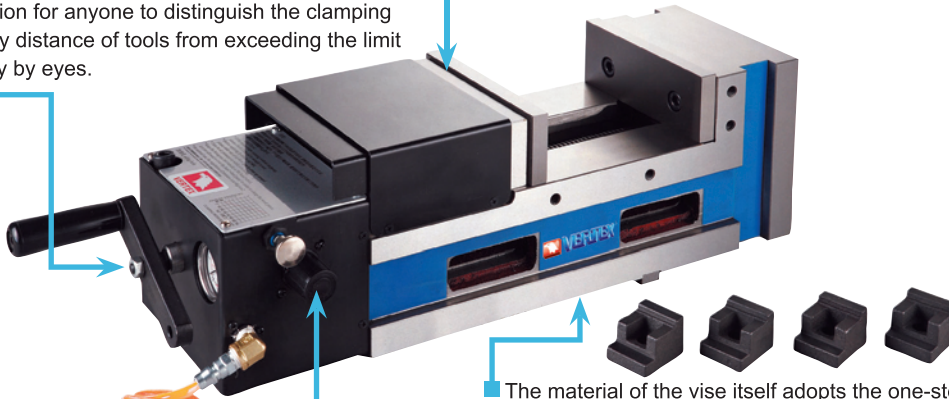

The material of the vise itself adopts the one-step design of high ductility graphitized casting iron (FCD-60), and the Bottom rail of the two sides has heating treatment (HRC-45°) that can assure good performance on Accuracy, wear-resisting, and tension-resisting.

Regulator: If the air pressure is low, 8 kgf/cm<sup>2</sup>, it can still achieve the super strong clamping capacity of 9000 kg/cm<sup>2</sup>. The clamping capacity from 0-9000 kg/cm<sup>2</sup> can be set freely and adjust via pressure regulator. Automatically seeking the highest source of air pressure: When the required pressure was set, it will not loose under low air pressure.

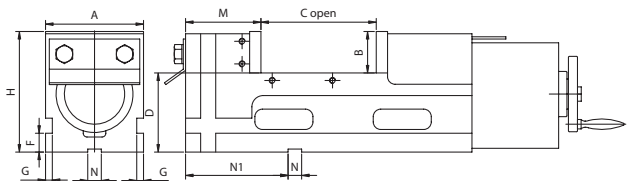
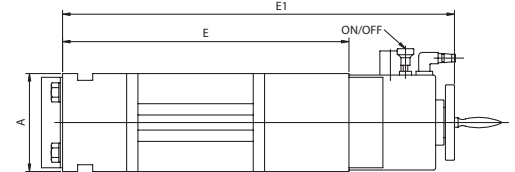

**SAME HEIGHT MULTIPLE USING**

**ACCURACY GUARANTEE**

0.01/100 MM 0.02/50

**TABLE HARDNESS**

**BENDING PROOF**

**MECHANICAL**

**PNEUMATIC**

**HEAVY DUTY**

| ORDER NO. | A   | B  | C OPEN | D   | E   | E1  | F  | G  | H   | M   | N  | N1  | Max. Clamp Force (kgf) | N.W. (kgs) | CODE NO. |
|-----------|-----|----|--------|-----|-----|-----|----|----|-----|-----|----|-----|------------------------|------------|----------|
| VMC-4P    | 100 | 48 | 100    | 100 | 320 | 450 | 25 | 8  | 148 | 100 | 16 | 145 | 3200                   | 27         | 4005-076 |
| VMC-5P    | 130 | 55 | 150    | 105 | 380 | 520 | 25 | 9  | 160 | 100 | 18 | 145 | 6000                   | 38         | 4005-070 |
| VMC-6P    | 160 | 58 | 160    | 105 | 400 | 540 | 25 | 9  | 163 | 100 | 18 | 145 | 6000                   | 48         | 4005-071 |
| VMC-6PL   | 160 | 58 | 250    | 105 | 490 | 630 | 25 | 9  | 163 | 100 | 18 | 145 | 6000                   | 51         | 4005-072 |
| VMC-7P    | 180 | 63 | 200    | 110 | 460 | 600 | 25 | 12 | 173 | 108 | 18 | 180 | 9000                   | 65         | 4005-073 |
| VMC-8P    | 200 | 63 | 200    | 110 | 470 | 610 | 25 | 12 | 173 | 108 | 18 | 180 | 9000                   | 74         | 4005-074 |
| VMC-8PL   | 200 | 63 | 300    | 110 | 570 | 710 | 25 | 12 | 173 | 108 | 18 | 180 | 9000                   | 79         | 4005-075 |

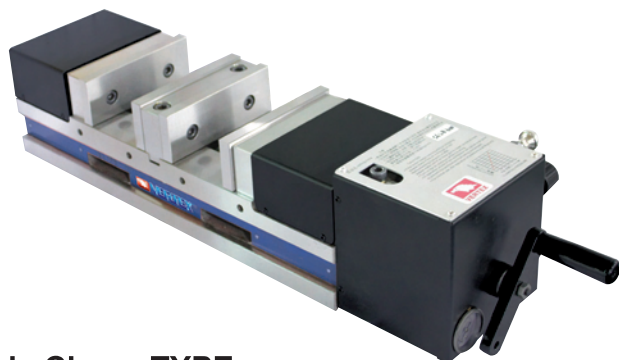

### Feature:

Double clamp function for massive production.

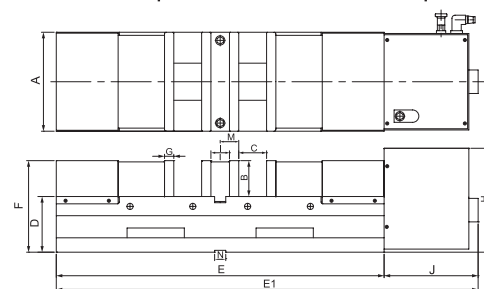

Unit:mm

### Double Clamp TYPE

| ORDER NO. | A   | B  | C OPEN | D  | E   | E1  | F   | G  | H   | I  | J   | N  | Max. Clamp Force (kgf) | N.W. (KG) | G.W. (KG) | CODE NO. |
|-----------|-----|----|--------|----|-----|-----|-----|----|-----|----|-----|----|------------------------|-----------|-----------|----------|
| VMC-6PD   | 160 | 58 | 0-100  | 90 | 530 | 682 | 148 | 15 | 168 | 30 | 152 | 18 | 4000                   | 63        | 66        | 4005-085 |





# Convenient Type Machine Vise



**NEW**

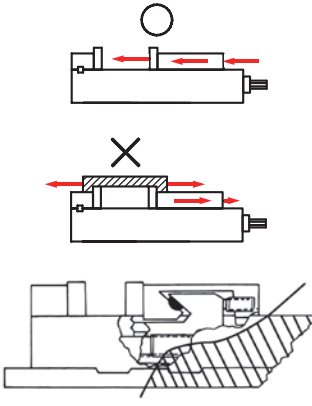
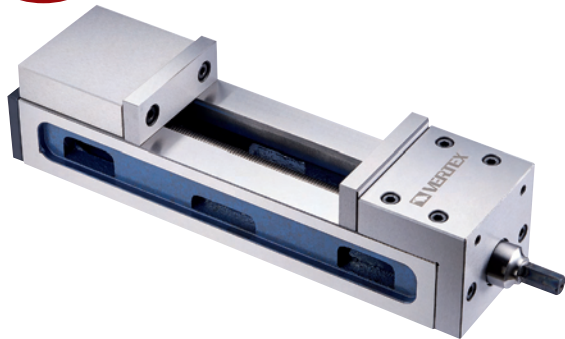

- Moveable jaw located at outer end and align surface for workpiece is in front of operator. It is convenient for loading or unloading workpiece on such design of vise.
- The overall length of this vise is shorter than other similar vises, but keep the more jaw opening. Save space on work table.
- Extra opened Semi-spherical segment eliminates jaw lifting and workpiece tilting.
- Time & energy saving
- Width 100 mm opened 180 mm.

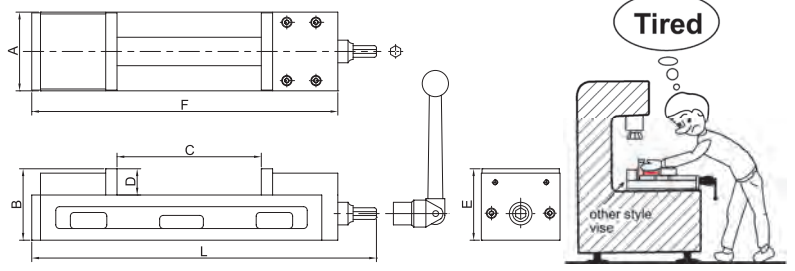
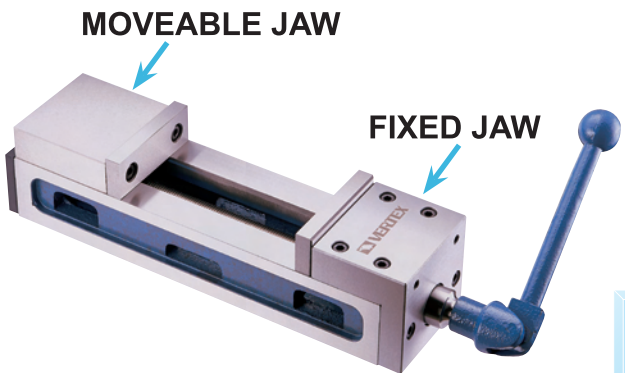

|                       |                         |                                  |  |                           |                          |                       |
|-----------------------|-------------------------|----------------------------------|--|---------------------------|--------------------------|-----------------------|
| <b>LIGHT DUTY</b><br> | <b>JAW DOWNWARD</b><br> | <b>MORE SETTING POSITION</b><br> | <b>ACCURACY GUARANTEE</b><br>0.01/100 MM 0.02/50 | <b>TABLE HARDNESS</b><br> | <b>BENDING PROOF</b><br> | <b>MECHANICAL</b><br> |
|-----------------------|-------------------------|----------------------------------|--|---------------------------|--------------------------|-----------------------|

| ORDER NO. | A   | B  | C OPEN | D  | E  | F   | L   | Max. Clamp Force (kgf) | Weas (kgs) | CODE NO. |
|-----------|-----|----|--------|----|----|-----|-----|------------------------|------------|----------|
| VCM-47    | 108 | 98 | 180    | 36 | 62 | 420 | 470 | 450                    | 17.7       | 4005-080 |



# Super Open Ang-Fixed Machine Vise

**NEW**

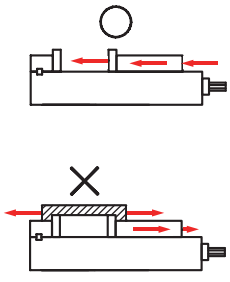

- The overall length of this vise is shorter than other similar vises, but keep the more jaw opening. Save space on work table.
- Semi-spherical segment eliminates jaw lifting and workpiece tilting.
- Vise bed flame hardend to HRC up is capable to obtain low weariness and last the high accuracy for long.
- Chip covers is applied on this vise to prevent from chips falling to leadscrew and inside of vise.
- Width 100 mm opened 210 mm super open.

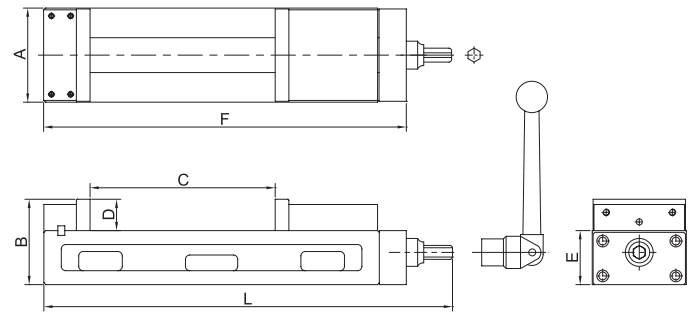
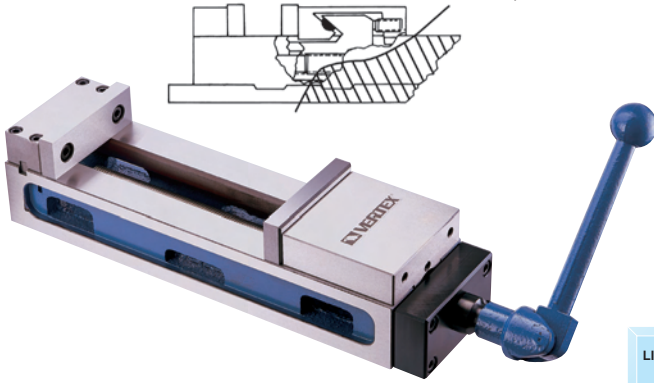

|                       |                         |                                  |  |                           |                          |                       |
|-----------------------|-------------------------|----------------------------------|--|---------------------------|--------------------------|-----------------------|
| <b>LIGHT DUTY</b><br> | <b>JAW DOWNWARD</b><br> | <b>MORE SETTING POSITION</b><br> | <b>ACCURACY GUARANTEE</b><br>0.01/100 MM 0.02/50 | <b>TABLE HARDNESS</b><br> | <b>BENDING PROOF</b><br> | <b>MECHANICAL</b><br> |
|-----------------------|-------------------------|----------------------------------|--|---------------------------|--------------------------|-----------------------|

| ORDER NO. | A   | B  | C OPEN | D  | E  | F   | L   | Max. Clamp Force (kgf) | Weas (kgs) | CODE NO. |
|-----------|-----|----|--------|----|----|-----|-----|------------------------|------------|----------|
| VMC-4L    | 108 | 98 | 203    | 36 | 62 | 420 | 470 | 450                    | 17.3       | 4005-095 |



# Horizontal Moving Quick Vise



## 2 WAY MOVING

**NEW**

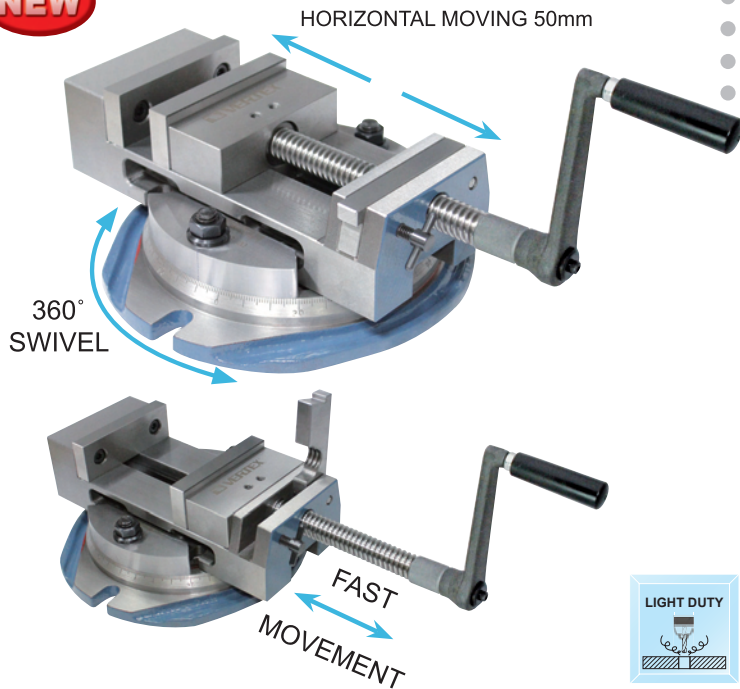

- Special design, for milling M/C, drilling M/C.
- Easy & quick to find process position.
- For round table drilling machine. If it don't have cross table.
- 360° rotation

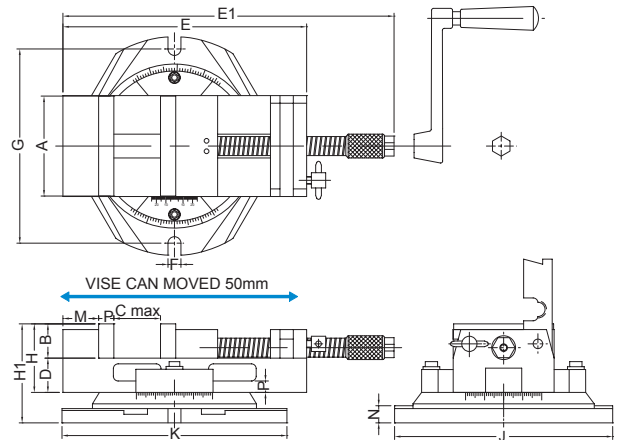

|                   |                  |  |                       |                      |                   |                    |
|-------------------|------------------|--|-----------------------|----------------------|-------------------|--------------------|
| <b>LIGHT DUTY</b> | <b>FAST MOVE</b> | <b>ACCURACY GUARANTEE</b><br>0,01/100 MM 0,02/50 | <b>TABLE HARDNESS</b> | <b>BENDING PROOF</b> | <b>MECHANICAL</b> | <b>patent PAT.</b> |
|-------------------|------------------|--|-----------------------|----------------------|-------------------|--------------------|

| ORDER NO. | A   | B  | C max. | D  | E   | E1  | F  | G   | H  | H1  | J   | K   | M  | N  | P  | MAX.Clamp Force kgf | G.W. | CODE NO. |
|-----------|-----|----|--------|----|-----|-----|----|-----|----|-----|-----|-----|----|----|----|---------------------|------|----------|
| VQW-80    | 81  | 34 | 85     | 36 | 230 | 374 | 14 | 214 | 70 | 100 | 242 | 230 | 28 | 30 | 12 | 700                 | 13.5 | 1002-245 |
| VQW-100   | 105 | 36 | 104    | 36 | 256 | 422 | 16 | 264 | 72 | 106 | 303 | 272 | 37 | 34 | 16 | 800                 | 15.8 | 1002-246 |
| VQW-130   | 131 | 36 | 125    | 38 | 297 | 490 | 16 | 264 | 74 | 108 | 303 | 272 | 38 | 34 | 29 | 800                 | 22.7 | 1002-247 |



# Quick Setting Vise

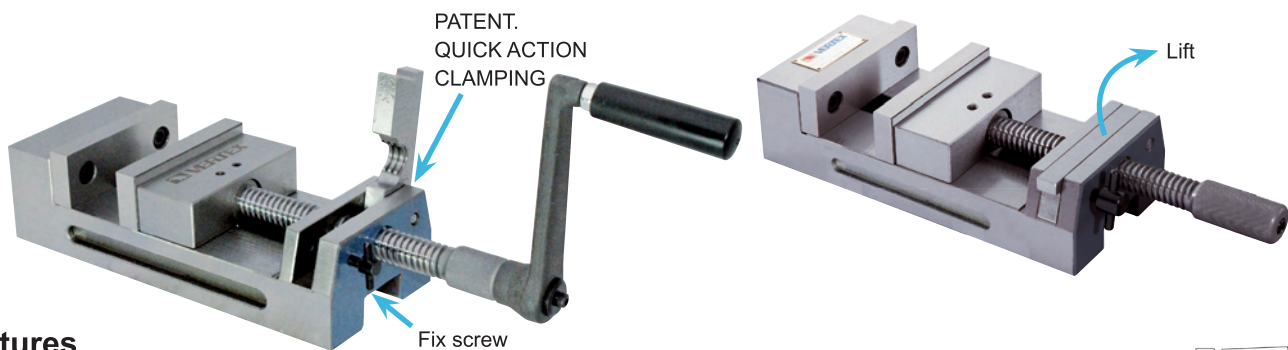

### Features

- Special design for quick clamping. (From the acme thread shaft stationly)
- Quick setting by sliding movement. Big clamping capability.
- Operating very quick and easy, can increase so much working efficiency than you can image.
- Good for short term and massive production or proto type work.
- Suit for milling machine, grinder machine, precision drilling machine using.
- Accurate grounded and assembled.
- Precision cut acme thread, it can get 800kgs high clamping force.
- Horizontal & vertical
- Accuracy 0.02 / 100 mm

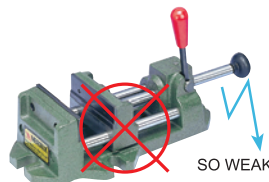
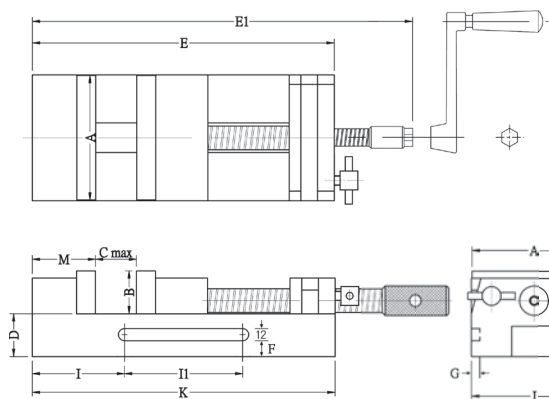

|                   |                  |  |                       |                      |                   |                    |
|-------------------|------------------|--|-----------------------|----------------------|-------------------|--------------------|
| <b>LIGHT DUTY</b> | <b>FAST MOVE</b> | <b>ACCURACY GUARANTEE</b><br>0,01/100 MM 0,02/50 | <b>TABLE HARDNESS</b> | <b>BENDING PROOF</b> | <b>MECHANICAL</b> | <b>patent PAT.</b> |
|-------------------|------------------|--|-----------------------|----------------------|-------------------|--------------------|

| ORDER NO. | A   | B  | C max. | D  | E   | E1  | F  | G | H  | I  | I1  | J   | K   | M  | MAX.Clamp Force kgf | G.W. | CODE NO. |
|-----------|-----|----|--------|----|-----|-----|----|---|----|----|-----|-----|-----|----|---------------------|------|----------|
| VQS-3     | 81  | 34 | 85     | 36 | 230 | 374 | 12 | 5 | 70 | 51 | 128 | 82  | 230 | 50 | 700                 | 7    | 1002-262 |
| VQS-4     | 105 | 36 | 104    | 36 | 256 | 422 | 12 | 5 | 72 | 54 | 148 | 106 | 256 | 54 | 800                 | 9.5  | 1002-263 |
| VQS-5     | 131 | 36 | 125    | 38 | 297 | 490 | 13 | 5 | 74 | 59 | 178 | 132 | 297 | 67 | 800                 | 14.5 | 1002-264 |



# Machine Vise For Shaping & Milling Use

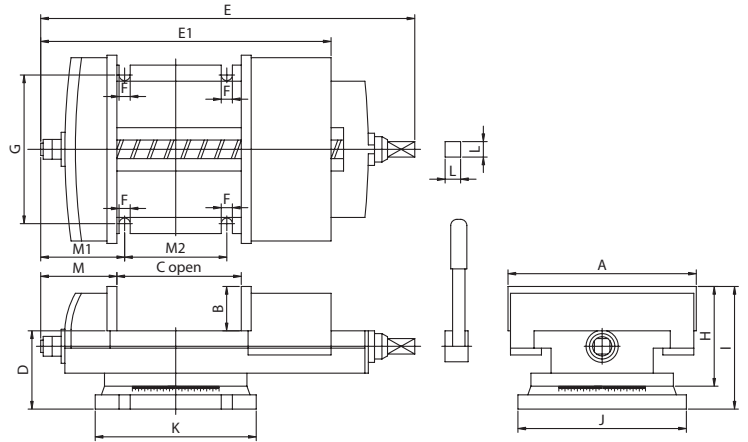

The vise is made of the high tension cast iron, rigidity, large range of clamping spans and more bigger clamping force at press down jaws, especially suitable for the heavy duty cutting and the heavy duty planner milling machine to clamp large workpiece.

Unit:mm



| ORDER NO. | A   | B  | C OPEN | D   | E   | E1  | F  | G   | H   | I   | J   | K   | L  | M   | M1  | M2  | Max. Clamp Force (kgf) | G.W. (kgs) | CUFT (cm) | CODE NO. |
|-----------|-----|----|--------|-----|-----|-----|----|-----|-----|-----|-----|-----|----|-----|-----|-----|------------------------|------------|-----------|----------|
| VSM-12    | 304 | 72 | 290    | 126 | 604 | 560 | 18 | 240 | 161 | 198 | 272 | 260 | 25 | 123 | 135 | 165 | 800                    | 84         | 67x35x23  | 1002-270 |
| VSM-16    | 405 | 96 | 415    | 145 | 763 | 738 | 20 | 292 | 200 | 241 | 336 | 336 | 25 | 135 | 143 | 248 | 1000                   | 142        | 84x45x27  | 1002-271 |
| VSM-20    | 508 | 95 | 505    | 150 | 902 | 871 | 21 | 288 | 204 | 245 | 336 | 336 | 25 | 169 | 211 | 246 | 1200                   | 200        | 97x56x28  | 1002-272 |



## B-Type Milling Vise

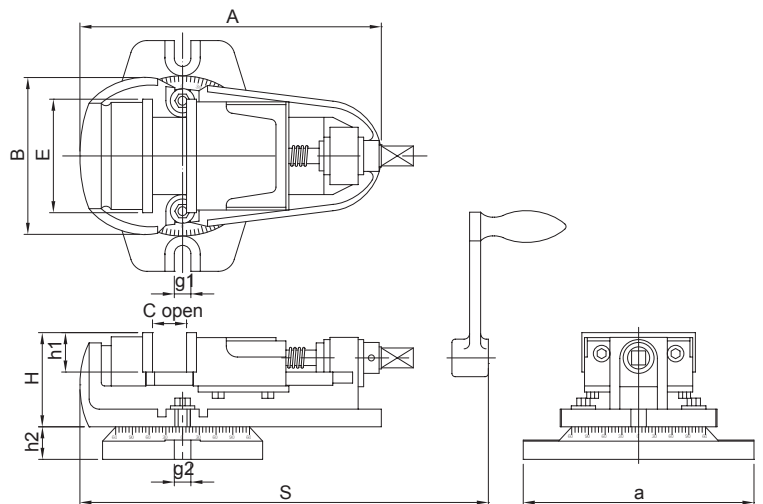
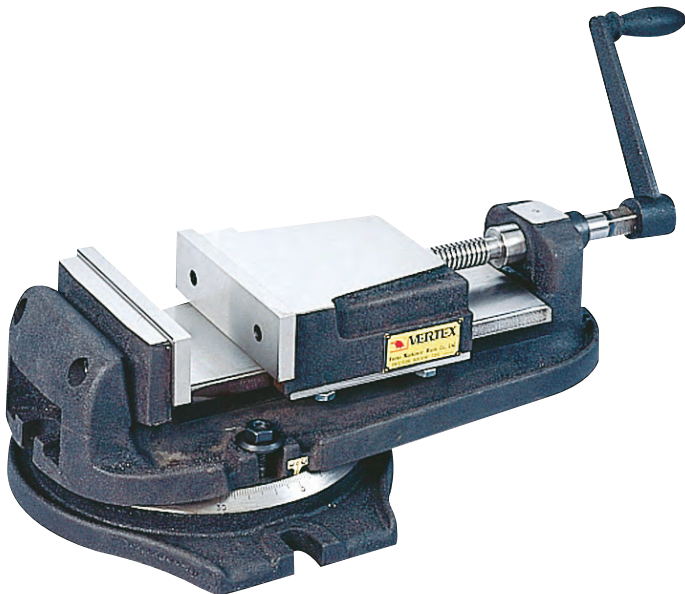

- A wider bottom to increase clamping force.
- Groove device to collect cutting oil.
- Full 360° swivel base with line, accurate graduation.
- In order to ensure the accuracy when using it' better that don't put swivel base together

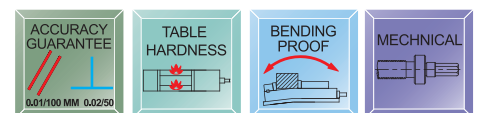

| ORDER NO. | A   | B   | E   | H   | C OPEN | S   | a   | h1 | h2 | g1 | g2 | Max. Clamp Force (kgf) | G.W. kgs | CODE NO. |
|-----------|-----|-----|-----|-----|--------|-----|-----|----|----|----|----|------------------------|----------|----------|
| VBV-4     | 270 | 140 | 100 | 79  | 65     | 305 | 212 | 33 | 28 | 12 | 12 | 900                    | 13       | 1002-280 |
| VBV-5     | 350 | 180 | 125 | 96  | 100    | 410 | 280 | 37 | 35 | 15 | 15 | 900                    | 21.5     | 1002-281 |
| VBV-6     | 452 | 218 | 160 | 103 | 132    | 483 | 317 | 48 | 40 | 16 | 16 | 1000                   | 41       | 1002-282 |





# Super Open Drill Vise



**NEW**

EURO TYPE

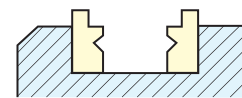
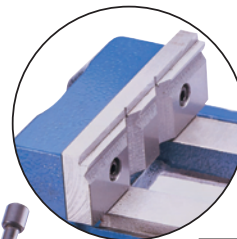

DESIGN FOR THIN & ROUND WORKPIECE

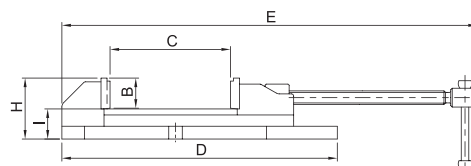
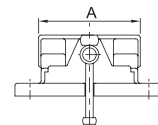
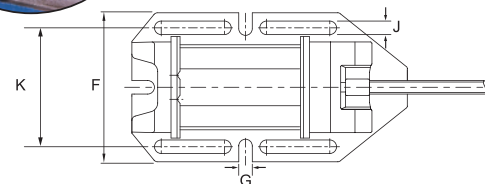

Unit:mm

- Big opened.
- Big clamping capacity.
- With prisma jaw for round workpiece.
- For drilling & milling using.



| ORDER NO. | A   | B  | C OPEN | D   | E   | F   | G  | H  | I  | J  | K   | V    | MAX.Clamp Force kgf | G.W. (kgs) | CFT (cm)           | CODE NO. |
|-----------|-----|----|--------|-----|-----|-----|----|----|----|----|-----|------|---------------------|------------|--------------------|----------|
| VRV-4     | 110 | 32 | 128    | 316 | 471 | 177 | 16 | 73 | 40 | 16 | 144 | 5-32 | 450                 | 9.8        | 32.3 x 13.3 x 12.9 | 1002-320 |
| VRV-5     | 135 | 40 | 165    | 366 | 552 | 207 | 16 | 81 | 40 | 16 | 168 | 6-40 | 650                 | 14.0       | 32.3 x 13.3 x 12.9 | 1002-321 |
| VRV-6     | 160 | 50 | 218    | 447 | 693 | 227 | 16 | 96 | 45 | 16 | 208 | 7-48 | 900                 | 25.7       | 32.3 x 13.3 x 12.9 | 1002-322 |



# Free Vise

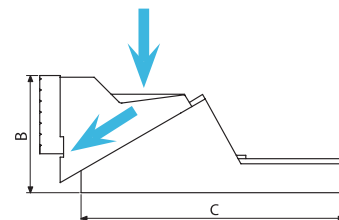
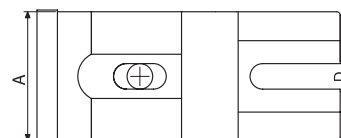
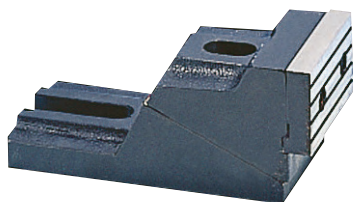

- FV type is light duty.
- Free style clamping For big workpiece.
- Adjustable distance 15mm For clamping.



Unit:mm

| ORDER NO. | DIMENSION (WxHxL) | CLAMPING CAPACITY (HxL) | ACCESSORIES BOLT SIZE               | MAX.Clamp Force kgf | WEIGHT (kgs/2PCS) | CODE NO. |
|-----------|-------------------|-------------------------|-------------------------------------|---------------------|-------------------|----------|
| FV-350    | 75x67x150mm       | 140x350mm               | M12 x 75L x 2PCS. M12 x 125L x 2PCS | 900                 | 7.5               | 1002-290 |
| FV-450    | 100x90x200mm      | 180x450mm               | M12 x 75L x 2PCS. M12 x 125L x 2PCS | 900                 | 14                | 1002-291 |
| FV-550    | 125x120x250mm     | 250x550mm               | M16 x 75L x 2PCS. M16 x 125L x 2PCS | 900                 | 23                | 1002-292 |

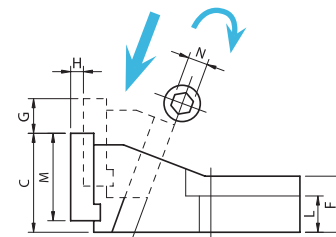
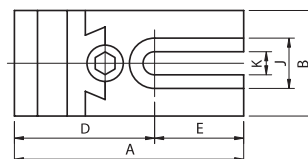
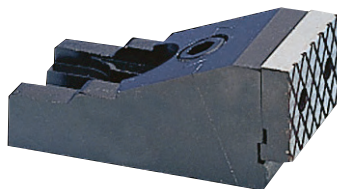

- Free style clamping For big workpiece.
- Heavier duty.
- Adjustable distance 10mm For clamping.



Unit:mm

| ORDER NO. | A   | B    | C    | D   | E  | F    | G  | H  | J    | K  | L    | M    | N  | MAX.Clamp Force kgf | ACCESSORIES BOLT SIZE | N.W. (kgs) | CODE NO. |
|-----------|-----|------|------|-----|----|------|----|----|------|----|------|------|----|---------------------|-----------------------|------------|----------|
| SV-62     | 139 | 64   | 59.5 | 85  | 54 | 33.5 | 21 | 9  | 30.5 | 18 | 22   | 52.5 | 12 | 1800                | M12 x 75L x 4PCS      | 5.8        | 1002-293 |
| SV-85     | 192 | 86.5 | 86   | 115 | 77 | 53   | 24 | 10 | 36   | 18 | 25.5 | 59.5 | 12 | 1800                | M16 x 75L x 4PCS      | 11         | 1002-294 |
| SV-125    | 218 | 127  | 84   | 124 | 94 | 51.5 | 33 | 18 | 45.5 | 20 | 23.5 | 73   | 12 | 1800                | M16 x 75L x 4PCS      | 21         | 1002-295 |



# Drill Vise



**NEW**

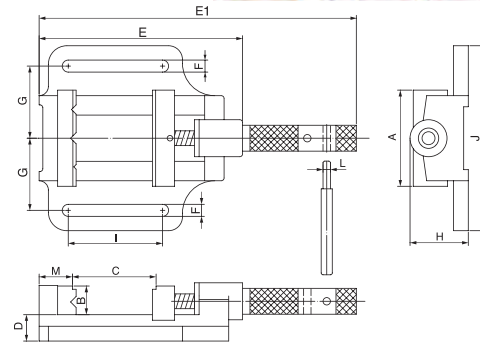

- Designed with solid structure, main body is made of FC15, assemble a pair of heat treated steel jaws with hardness HRC 45°~50°
- Suitable for clamping work piece on drill press machine & milling machine
- Jaw pair and handle are surface treated by black oxide finish
- Front fixed prismatic jaw with cross V-grooves is designed for clamping work piece firmly in both vertical & horizontal directions



| ORDER NO. | A   | B  | C OPEN | D    | E   | E1  | F  | G  | H  | I   | J   | L   | M  | WEIGHT | CODE NO. |
|-----------|-----|----|--------|------|-----|-----|----|----|----|-----|-----|-----|----|--------|----------|
| DV-85     | 84  | 25 | 85     | 27   | 182 | 287 | 12 | 64 | 56 | 80  | 167 | 8   | 32 | 3.5    | 1015-041 |
| DV-100    | 104 | 31 | 100    | 28.5 | 220 | 343 | 13 | 78 | 63 | 102 | 200 | 8   | 36 | 5.7    | 1015-042 |
| DV-120    | 132 | 38 | 120    | 32   | 250 | 395 | 14 | 91 | 71 | 127 | 226 | 9.5 | 45 | 8.2    | 1015-043 |



# Steel Bench Vise With Base

**NEW**

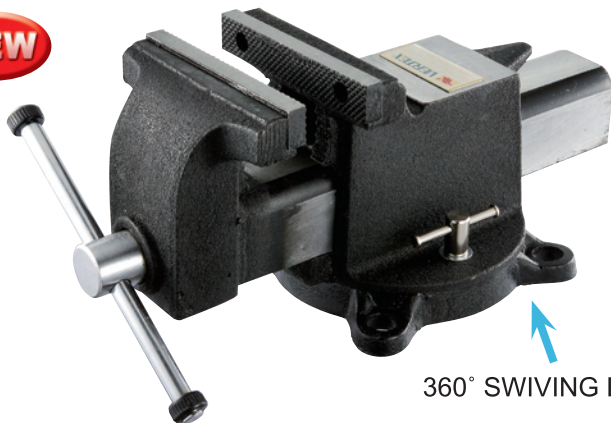

360° SWIVING BASE

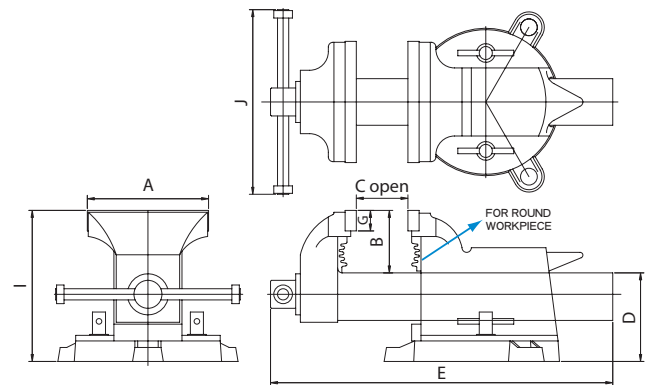

mm

| ORDER NO. | A   | B   | C OPEN | D   | E   | G  | I   | J   | Clamp Force (kgf) | WEIGHT (kgs) | CODE NO. |
|-----------|-----|-----|--------|-----|-----|----|-----|-----|-------------------|--------------|----------|
| BVV-3     | 79  | 51  | 75     | 87  | 280 | 18 | 138 | 178 | 1300              | 6            | 1002-330 |
| BVV-4     | 104 | 61  | 100    | 87  | 310 | 18 | 148 | 178 | 1800              | 7            | 1002-331 |
| BVV-5     | 127 | 68  | 125    | 93  | 370 | 22 | 165 | 198 | 2300              | 10.5         | 1002-332 |
| BVV-6     | 154 | 78  | 150    | 108 | 420 | 22 | 183 | 228 | 2800              | 14           | 1002-333 |
| BVV-8     | 205 | 87  | 200    | 115 | 500 | 22 | 202 | 238 | 3000              | 18           | 1002-334 |
| BVV-10    | 253 | 100 | 250    | 114 | 570 | 22 | 220 | 263 | 3000              | 24           | 1002-335 |



# Quick Bench Vise

ORDER NO.VQS-40 CODE NO.1002-096

**NEW**

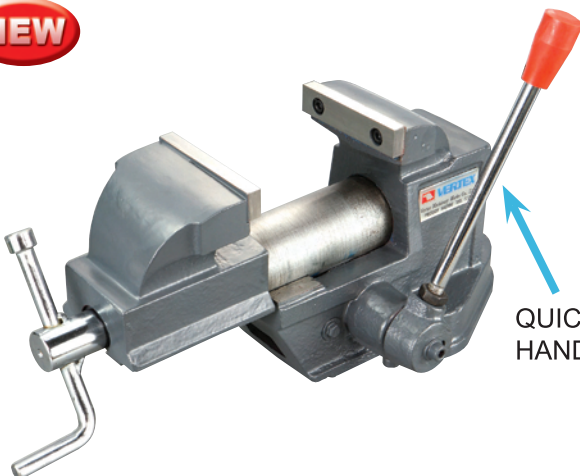

QUICK ACTION HANDLE

- Hardened & Ground Jaw
- Jaw Width 100 mm
- Jaw Height 29 mm
- Opened Capacity 100 mm
- 8 mm Distance of Quick Clamping System
- Can Be Move By Handle & By Quick Action Arm
- Weight: 13.3 kgs

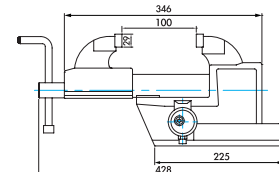
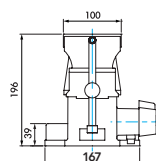
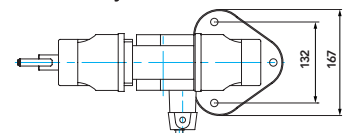



# Universal Work Stopper

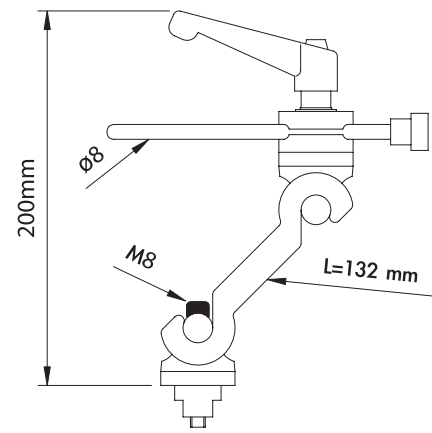

**NON TEETH TYPE**  
**ORDER NO. VWS-123**  
**CODE NO. 1002-105**  
**WEIGHT: 0.9kg**  
**T-SLOT: 16mm**

**TEETH TYPE**  
**ORDER NO. VWS-125**  
**CODE NO. 1002-106**  
**WEIGHT: 1.1kg**  
**T-SLOT: 16mm**

| ORDER NO. | CODE NO. |
|-----------|----------|
| VWS-123   | 1002-105 |
| VWS-125   | 1002-106 |

- It is fixed and secured by its rigid serration without skid. (300kg bump is permanent)

The locking lever can be put into different positions around its own axis-360°

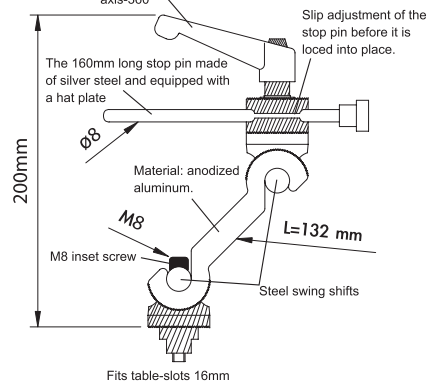

WORK STOPPER



# T Slot Clamps

PATENT

For Thin Work Piece

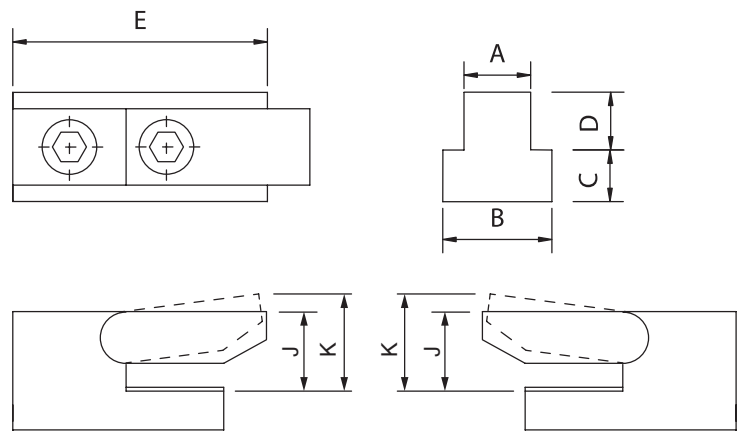

- 1 Set consist of 4 vices.
- For thin or small workpiece.
- Good clamping force.
- Quick setting
- Suit for light duty cutting on the milling drilling / EDM machine.

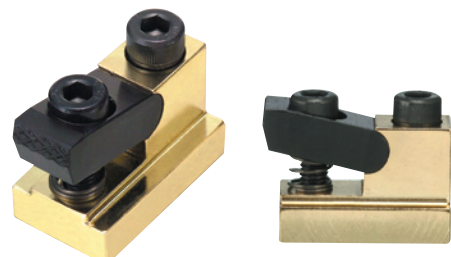
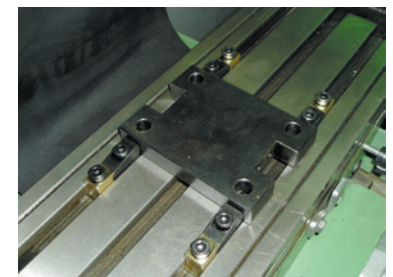

| ORDER NO. | A    | B  | C  | D  | E  | J  | K  | N.W. | CODE NO. |
|-----------|------|----|----|----|----|----|----|------|----------|
| CK-3712   | 11.5 | 18 | 7  | 16 | 42 | 16 | 20 | 0.6  | 1002-311 |
| CK-3714   | 13.5 | 22 | 8  | 18 | 42 | 18 | 22 | 0.7  | 1002-312 |
| CK-3716   | 15.5 | 25 | 10 | 20 | 45 | 20 | 24 | 0.9  | 1002-313 |
| CK-3718   | 17.5 | 28 | 11 | 24 | 45 | 24 | 26 | 1.1  | 1002-314 |
| CK-3720   | 19.5 | 32 | 12 | 26 | 53 | 26 | 28 | 1.5  | 1002-315 |