



2-Way Angle Milling Vise



TW PAT.

MECHANICAL TYPE

NEW

SUPER OPEN CAPACITY:
VWT-4B JAW OPENED 220mm
VWT-6B JAW OPENED 350mm



VWT-4B

VWT-6B

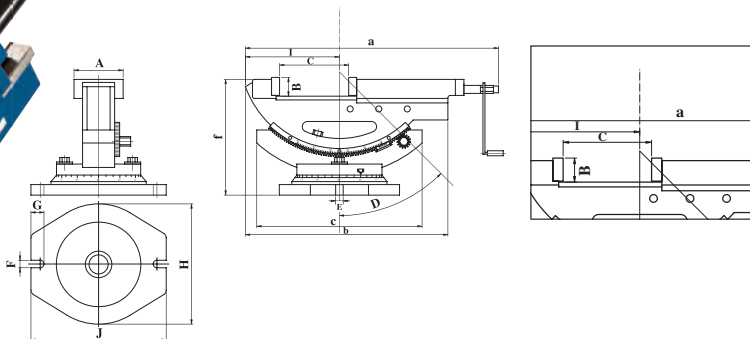

- Tilting seat set by two locking screws, works in high stability.
- Angle setting ranges from 0°~50°. Tilting degrees graduated for easy reading. Swivel base graduated to 360° and fixable in any position.

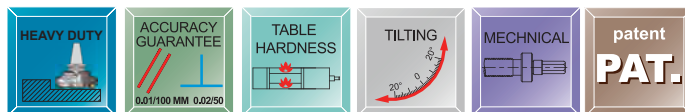

Order No. & Dimensions

ORDER NO.	A	B	C OPEN	D	E	F	G	H	I	J	a	b	c	f	Max. Clamp Force (kgf)	G.W. (kgs)	Meas CFT	CODE NO.
VWT-4B	110	36	220	50°	15	15	26	240	185	270	500	404	335	230	1200	(C) 33.3	1.2	1002-060B
VWT-6B	152	54	350	50°	20	19	28	300	246	330	800	585	415	290	1600	(W) 79.7	4.4	1002-061B



2-Way Machine Vise

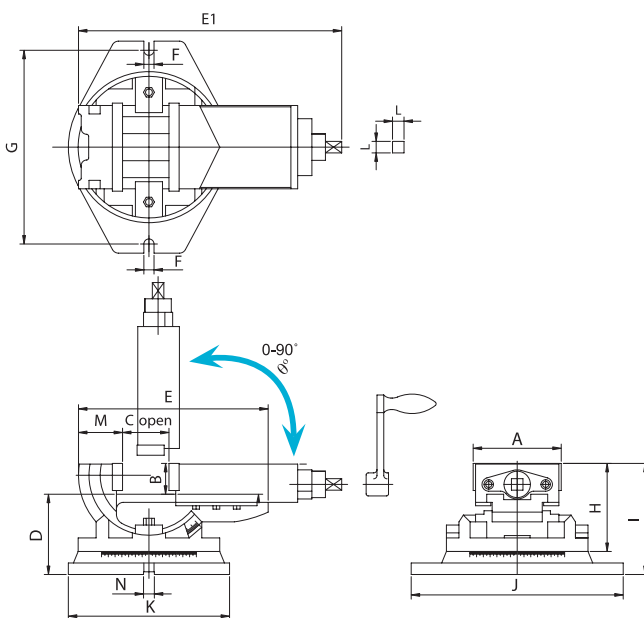

- Heavy cast iron structure
- Scales in both axis
- 360° swivel around Z-axis
- 90° vertical and horizontal swivel

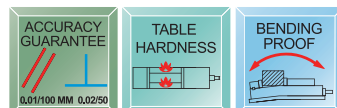

Order No. & Dimensions

ORDER NO.	A	B	C OPEN	D	E	E1	F	G	H	I	J	K	L	M	N	θ	Clamp Force(kgf)	Meas CFT	CODE NO.
VWT-5	130	46	100	118	280	415	15	286	130	164	313	238	17	65	16	0°~90°	900	31.7	1002-090
VWT-6A	160	51	120	140	360	510	17	293	150	191	328	252	17	83	16	0°~90°	1600	47	1002-091



3-Way Angle Milling Vise



ANGLE MILLING VISE

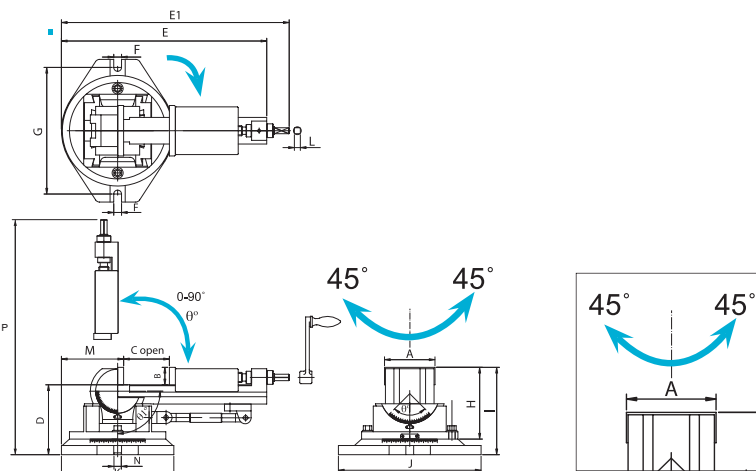
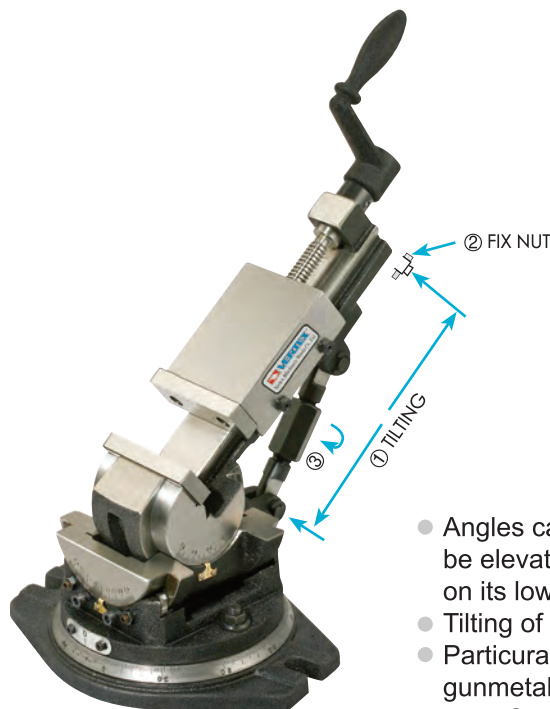

- Angles can be set in 3 dimensions. Swivels 360° around base. The vise can be elevated through 90° from the horizontal to vertical. And also can be tilted on its lower angle base up to 45° in both right and left.
- Tilting of any angle all keep the workpiece steady, smooth.
- Particularly the clamping part of screw is strengthened by a bush made of gunmetal.
- Turn ① to adjust tilting angle. fix ② to lock.



Specifications

ORDER NO.	A	B	C OPEN	D	E	E1	F	G	H	I	J	K	L	M	N	P	□	□1	MAX. Clamp Force (kgf)	G.W. (kgs)	Meas CFT	CODE NO.
VW-3	80	31	85	126	335	370	15	210	127	157	240	185	10	95	16	405	-45°~45°	-0°~90°	800	16.7	40x21x19	1002-080
VW-4	110	38	116	152	448	497	17	276	157	190	311	245	13	135	16	500	-45°~45°	-0°~90°	1000	32.7	56x27x23	1002-081
VW-5	135	40	145	170	530	580	17	310	173	210	358	271	13	140	16	600	-45°~45°	-0°~90°	1600	49.4	66x31x25	1002-082

Quick Index Holder

NEW

VFV-40H

- SHANK HEX. TYPE
- FOR CUTTING 6 DIVISION TYPE
- EACH 60° FOR 1 DIVISION
- ✳ FOR CUTTING HEX. & SQUARE SHAPE ON ROUND BAR & ROD
- ✳ THROUGH HOLE

ORDER NO.	WEIGHT KGS	CODE NO.
VFV-40H-D	1.34	1001-103
VFV-41S-D	1.19	1001-104

VFV-41S

- SHANK SQUARE TYPE
- FOR CUTTING 4 DIVISION
- EACH 90° FOR 1 DIVISION

patent
PAT.



VFV-40H-D



VFV-41S-D



60° DIVIDING FOR PUT ON THE VISE

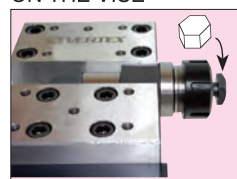

HORIZONTAL

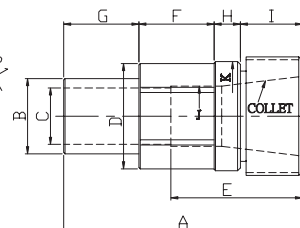
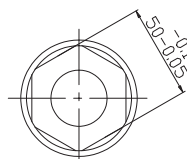

90° DIVIDING FOR PUT ON THE VISE

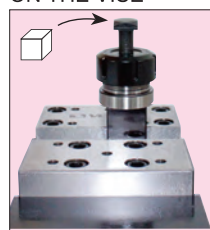

VERTICAL

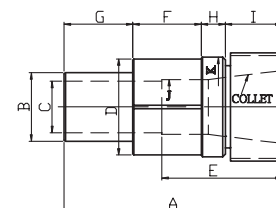
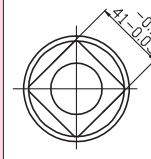

mm

ORDER NO.	A	B	C	D	E	F	G	H	I	J	K	COLLET SIZE	WEIGHT KGS	CODE NO.
VFV-40H	127	40	30	56	70	40	40	14	33	32	58	ER-40 7 PCS/SET	4.8	1001-101
VFV-41S	127	40	30	56	70	40	40	14	33	32	58	ER-40 7 PCS/SET	5.2	1001-102



Self Centering Vise



PAT.

SAME HEIGHT GUARANTEE

NEW

4 / 5 AXIS VISE

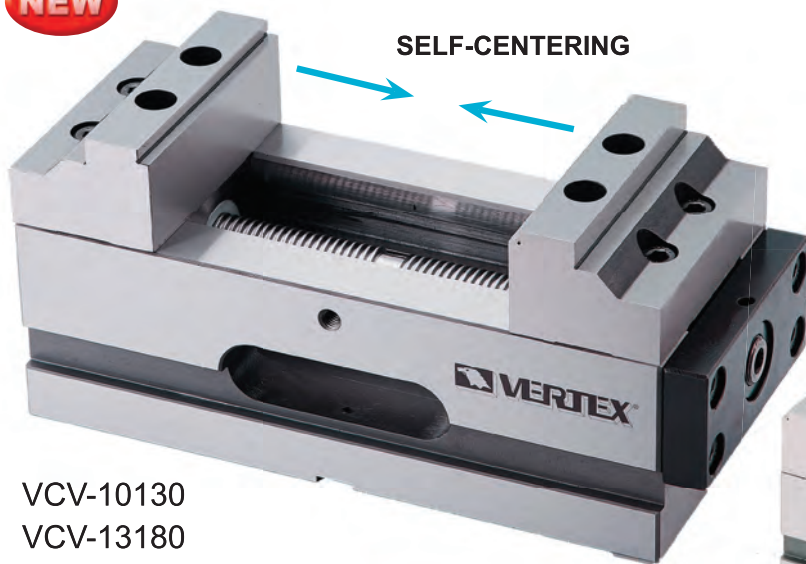

VCV-10130
VCV-13180
VCV-15180

INTER-CHANGEABLE JAW

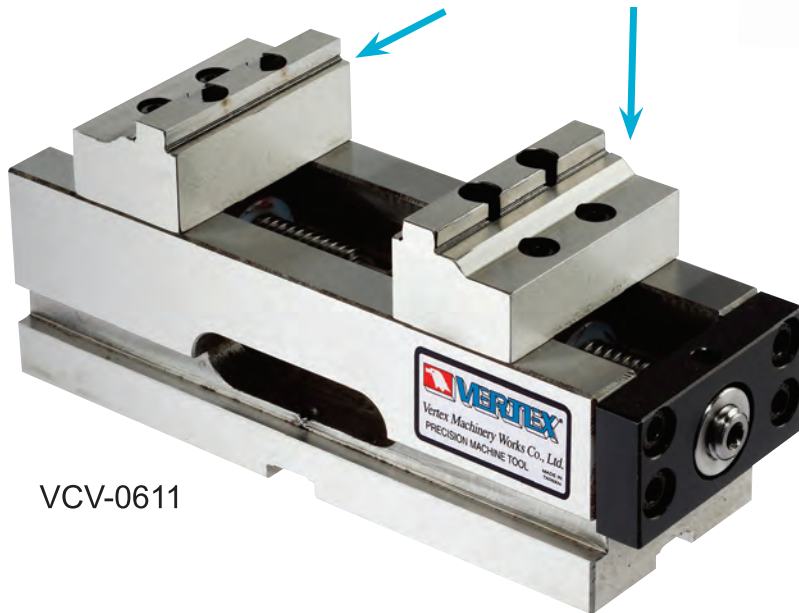

VCV-0611

Features

- Reversible Jaw :Remove 4 Fixed Screw to Re-install Jaws.
- Suit for 4/5 axis CNC machine
- Repeat clamping tolerance $\pm 0.01\text{mm}$
- Material: high tension cast iron
- Slide way hardness: HRC 45°
- Inter changeable jaw: heat treatment HRC 50°
- Lock down-drawing force: keep work piece from lifting

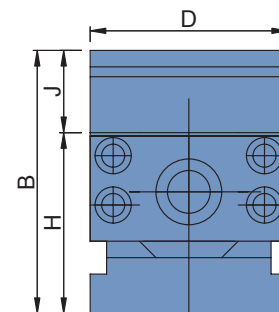
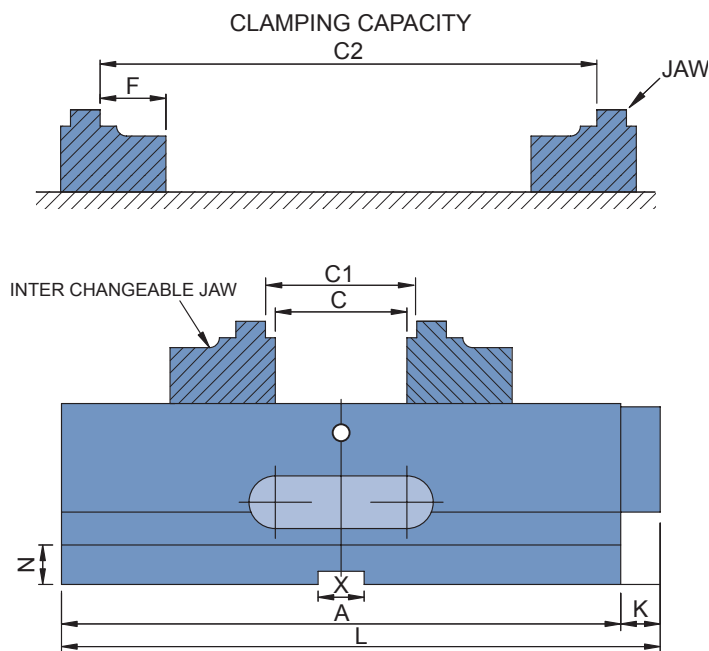

VCV-0611, 10130, 13180, 15180



Self Centering Vise



PAT.

SAME HEIGHT GUARANTEE

4 / 5 AXIS VISE

SELF CENTERING VISE



VCV-1090



VCV-13180D
VCV-15180D

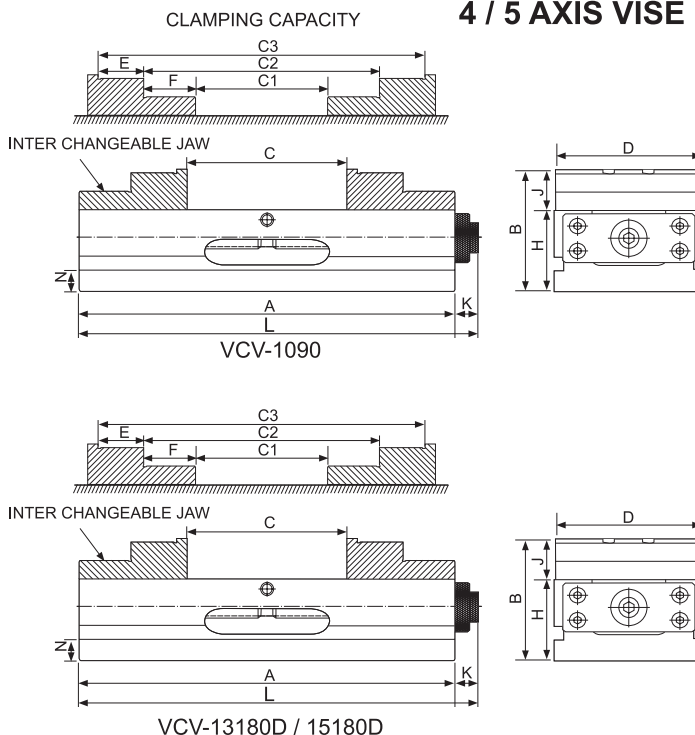

Features

- Reversible Jaw :Remove 4 Fixed Screw to Re-install Jaws.
- Suit for 4/5 axis CNC machine
- Repeat clamping tolerance $\pm 0.01\text{mm}$
- Material: high tension cast iron
- Slide way hardness: HRC 45°
- Inter changeable jaw: heat treatment HRC 50°
- Lock down-drawing force: keep work piece from lifting

Specifications

ORDER NO.	A	B	C OPEN	Clamping Capacity			D	F	H	J	K	N	P	R	X	L	MAX. Clamp Force (kgf)	Torque For Clamp	Weight (kgs)	CODE NO.
				C1	C2	C3														
VCV-0611	170	80	106	112	45-140		61	20	55	25	15	14			14	185	500	1.8m/kgs	5	1002-107
VCV-10130	240	120	132	140	62-192		101	30	80	40	20	21			16	260	1000	2.6m/kgs	18.5	1002-109
VCV-1090	240	120	90	90	70-160	134-222	101	35	80	40	20	22				260	800	2.6m/kgs	17	1002-108
VCV-13180	290	120	180	188	62-242		131	30	80	40	22	21			16	312	1000	2.6m/kgs	21	1002-115
VCV-15180	290	120	180	188	62-242		151	30	80	40	22	21			16	312	1000	2.6m/kgs	24.5	1002-116
VCV-13180D	290	120	180	188	62-242		131	30	80	40	22	21	76	28	16	312	1000	2.6m/kgs	22	1002-117
VCV-15180D	290	120	180	188	62-242		151	30	80	40	22	21	76	28	16	312	1000	2.6m/kgs	25.7	1002-118

With Swivel Base Type

INTER-CHANGEABLE JAW
JAW CLAMPING SCREWS
(EACH JAW 4 PCS)

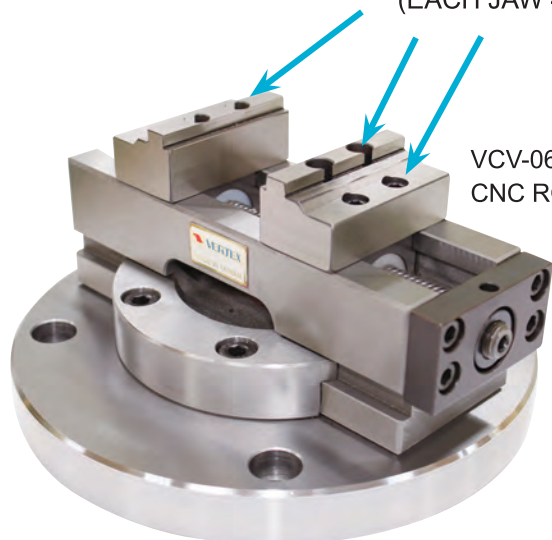
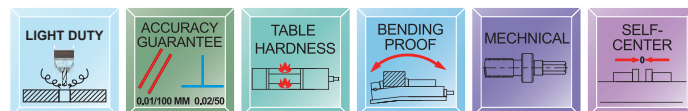

VCV-0611S FOR CNC ROTARY TABLE

ORDER NO.	BASE SIZE	kgs	CODE NO.
VCV-0611S	Ø200 x 22 Thickness	11.1	1002-107S
VCV-10130S	Ø248 x 22 Thickness	26	1002-109S
VCV-1090S	Ø248 x 22 Thickness	27.5	1002-108S
VCV-13180S	Ø296 x 22 Thickness	35	1002-115S
VCV-15180S	Ø316 x 22 Thickness	40	1002-116S
VCV-13180DS	Ø296 x 22 Thickness	36	1002-117S
VCV-15180DS	Ø316 x 22 Thickness	41.5	1002-118S



5-Axis Self Centering Vice



SAME HEIGHT GUARANTEE

NEW!

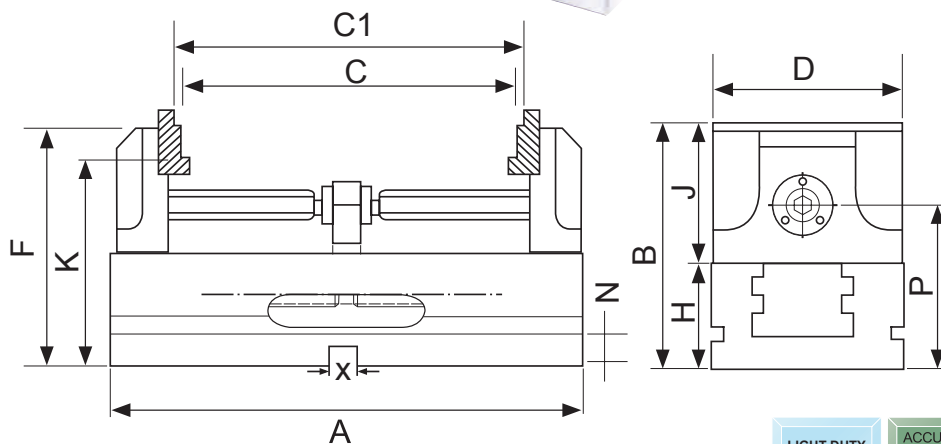
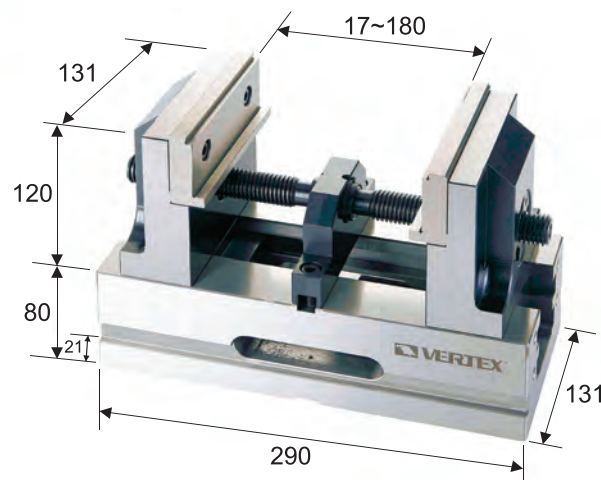
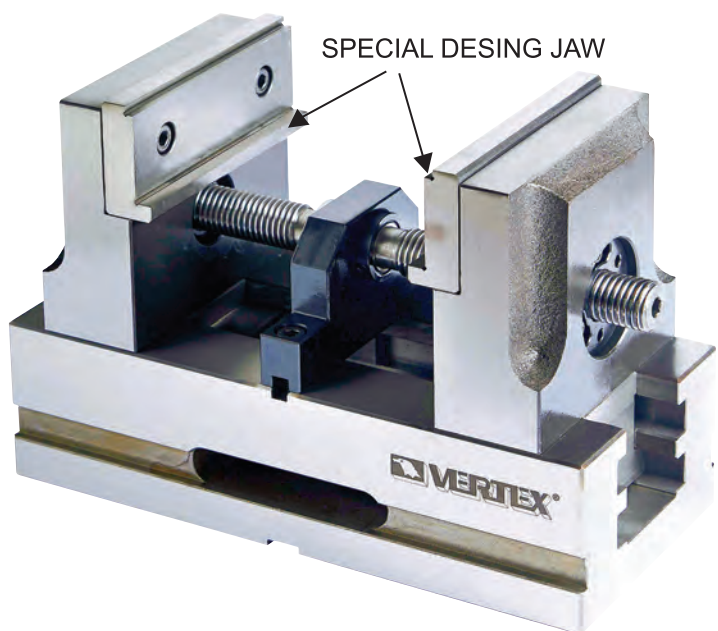

Features

- Special jaw design. can for thin workpiece & can for parallel plate workpiece.
- Suit for 5 axis CNC machine
- Repeat clamping tolerance $\pm 0.01\text{mm}$
- Material: high tension cast iron
- Slide way hardness: HRC 45°
- Inter changeable jaw: heat treatment HRC 50°
- Lock down-drawing force: keep work piece from lifting

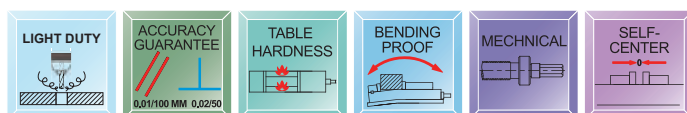

ORDER NO.	A	B	Clamping Capacity		D	F	H	J	K	N	P	X	MAX Clamp Force (kgf)	Torque For Clamp	Weight (kgs)	CODE NO.
			C open	C1 open												
VCV-0507H	290	200	17~180	25-188	131	196	80	120	154	21	126	16	1500	2.6mm/kgs	31.5	1002-401



Modular Precision Machine Vise



SAME HEIGHT GUARANTEE

MACHINE VISE

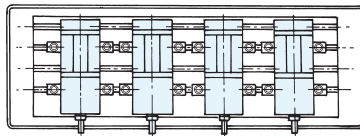
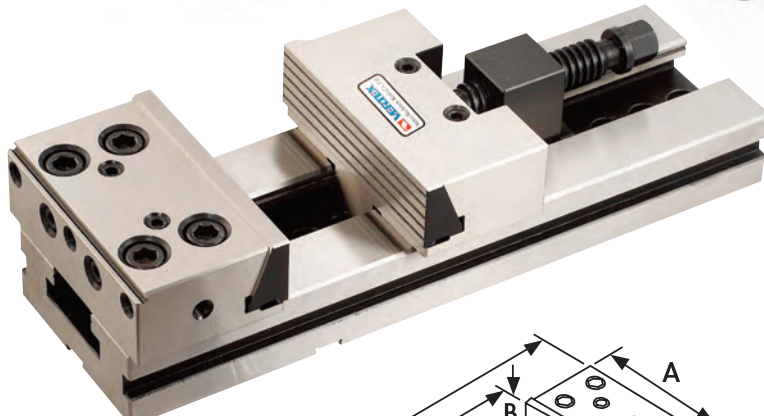

Aligned Performance

Features

- High Accuracy 0.01/100 mm
- Unlimited Clamping Range
- High Quality Alloy Steel with HRC 59
- High Clamping Pressure
- EACH ONE IS SAME AS HEIGHT.
- CAN BE USED IN MULTIPLE STYLE.
- No Length of Height Limitation
- No Jaw Lift
- Low Profile
- All Vises are Matched parallelism $\pm 0.01/100$ mm
- Optional : Swivel base

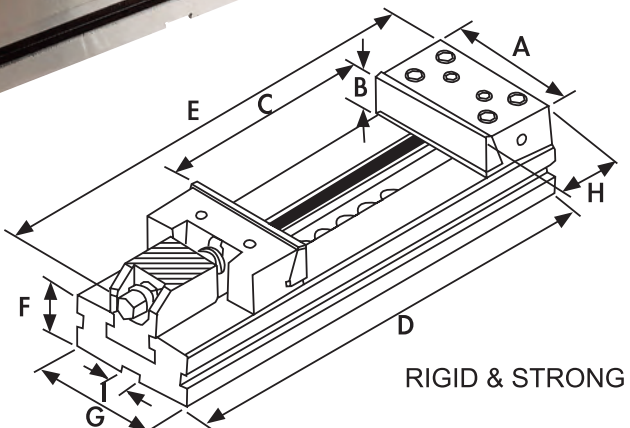

RIGID & STRONG

SAME HEIGHT MULTIPLE USING

ACCURACY GUARANTEE

0.01/100 MM Q.02/50

TABLE HARDNESS

BENDING PROOF

MECHANICAL

ORDER NO.	VMP -4	VMP -5	VMP -6	VMP -6B	VMP -6C	VMP -7A	VMP -7B	VMP -7C	VMP -8A	VMP -8B	VMP -8C	VMP -8D
A	100	125	150	150	150	175	175	175	200	200	200	200
B	30	40	50	50	50	60	60	60	65	65	65	65
C OPEN	100	150	200	300	400	200	300	400	200	300	400	500
D	270	345	420	520	620	455	555	655	495	595	695	795
E	325	360	530	600	700	540	640	740	593	693	793	880
F	35	40	50	50	50	58	58	58	70	70	70	70
G	75	96	125	125	125	145	145	145	170	170	170	170
H	78	78	90	89.4	89.4	97	97	97	114	114	114	113.4
I	16	16	16	16	16	16	16	16	16	16	16	16
Max. Clamp Force (kgf)	900	1300	2000	2000	2000	2000	2000	2000	2000	2000	2000	2000
KGS	9.2	16	28.5	34.8	38.1	43.7	48.3	53.5	66.3	73.2	81.3	87.2
CODE NO.	1002-190	1002-191	1002-192	1002-201	1002-202	1002-193	1002-194	1002-195	1002-196	1002-197	1002-198	1002-203



Modular Precision Hydraulic Machine Vise



PAT.

SAME HEIGHT GUARANTEE

NEW

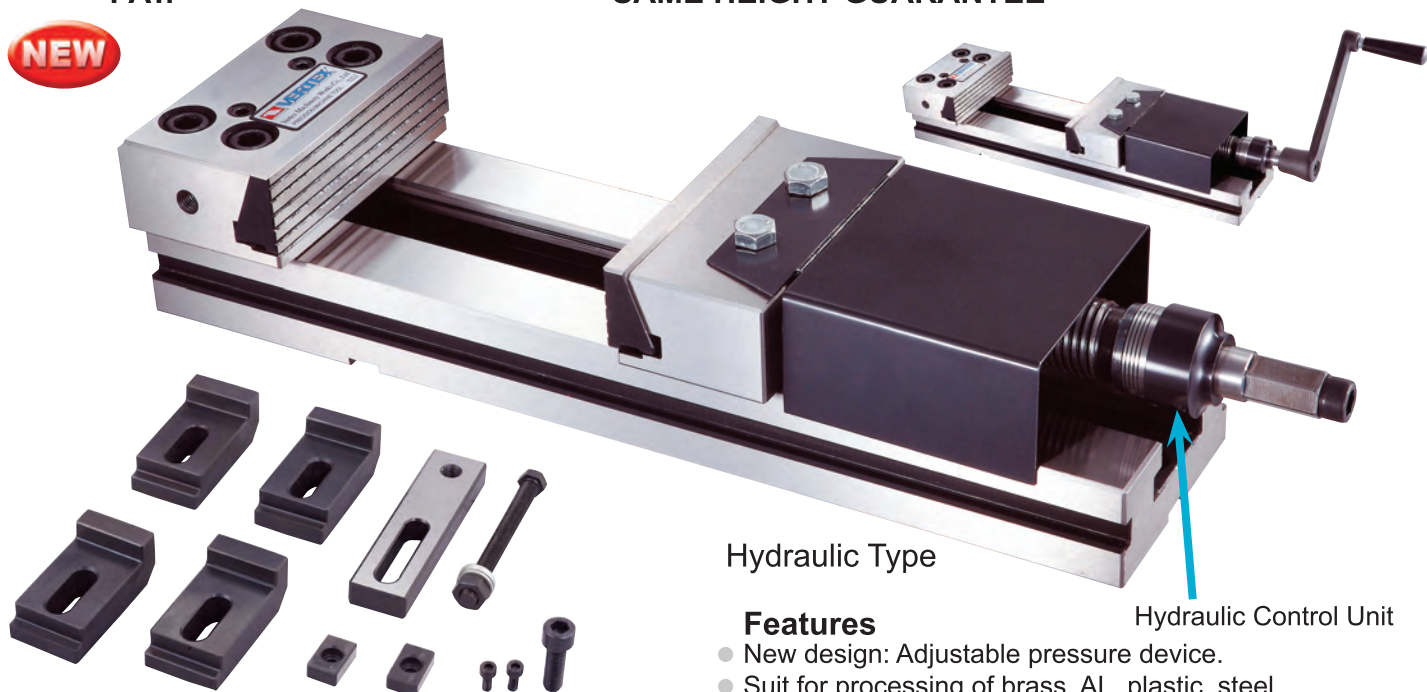

Hydraulic Type

Hydraulic Control Unit

Features

- New design: Adjustable pressure device.
- Suit for processing of brass, AL, plastic, steel.
- New design: super open jaw size, smallest open jaw size.
- lock proof system: prevent wrong clamping force sticks the vise.
- Hydraulic clamping force 4500kg for heavy duty cutting. The screw mechanism type clamping force is 2200 kgs
- Smooth & light operation for the handle.
- High accuracy 0.01/100 mm
- Unlimited clamping range
- High quality alloy steel with HRC 59
- High clamping pressure
- Each one is same as height.
- Can be used in multiple style.
- No length of height limitation
- No jaw lift
- Low profile, strong & rigid.
- All vises are matched parallelism $\pm 0.01/100$ mm

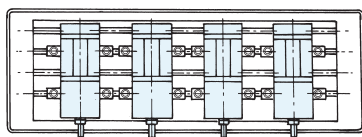
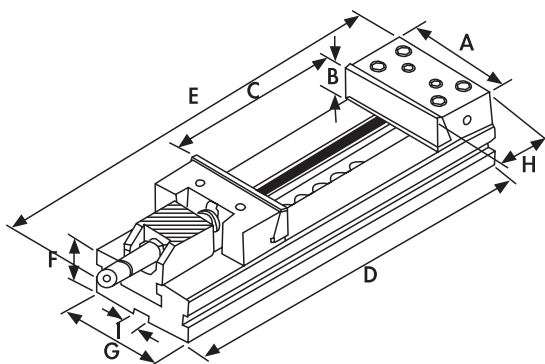

Aligned Performance

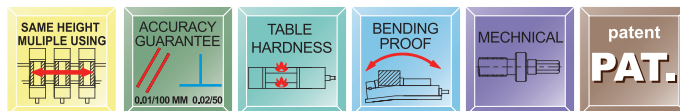

ORDER NO.	VMP -6BH	VMP -6CH	VMP -7AH	VMP -7BH	VMP -7CH	VMP -8AH	VMP -8BH	VMP -8CH	VMP -8DH
A	150	150	175	175	175	200	200	200	200
B	50	50	60	60	60	65	65	65	65
C OPEN	300	400	200	300	400	200	300	400	500
D	520	620	455	555	655	573	595	695	795
E	700	800	635	735	835	738	760	860	960
F	50	50	58	58	58	70	70	70	70
G	125	125	145	145	145	170	170	170	170
H	89.4	89.4	97	97	97	114	114	114	113.4
I	16	16	16	16	16	16	16	16	16
Max. Clamp Force (kgf)	4500	4500	4500	4500	4500	4500	4500	4500	4500
KGS	29	33	38	43	48	65	69	74	90
CODE NO.	1002-201H	1002-202H	1002-193H	1002-194H	1002-195H	1002-196H	1002-197H	1002-198H	1002-203H



Modular Machine Free Vise



MODULAR VISES are manufactured under rigid quality control. Only the most suitable materials are used, and the accuracy of even the smallest components is assured. As a result of the high standard construction MODULAR VISES can be depended upon to maintain their accuracy under the most severe operating conditions.

MACHINE FREE VISE

L TYPE VISE

VMP-4L, 5L, 6L, 7L

NEW

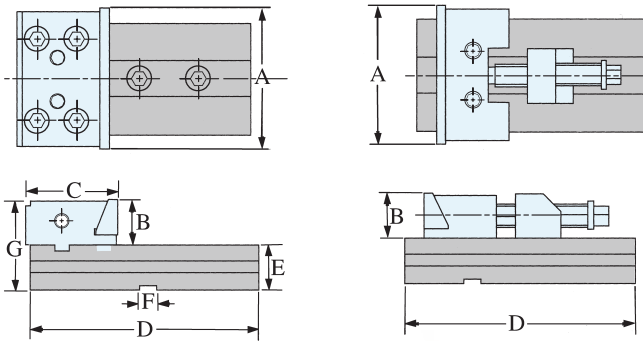
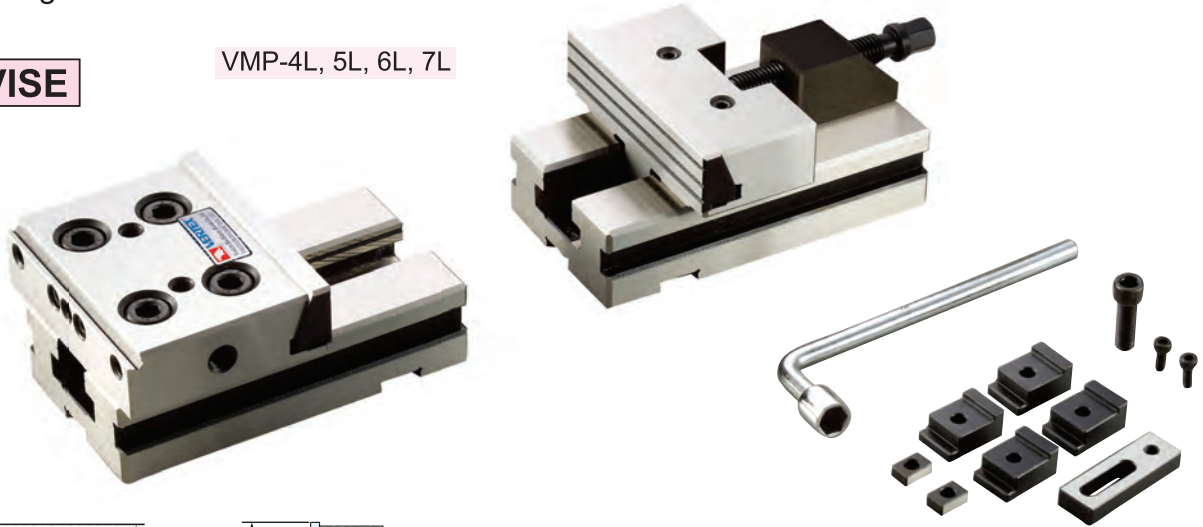

VMP-4L, 5L, 6L, 7L



Free head stock & fixed stock can for large wider workpiece use.

D TYPE VISE

VMP-44D / 55D / 66D / 77D

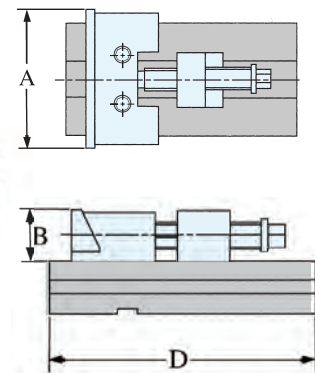
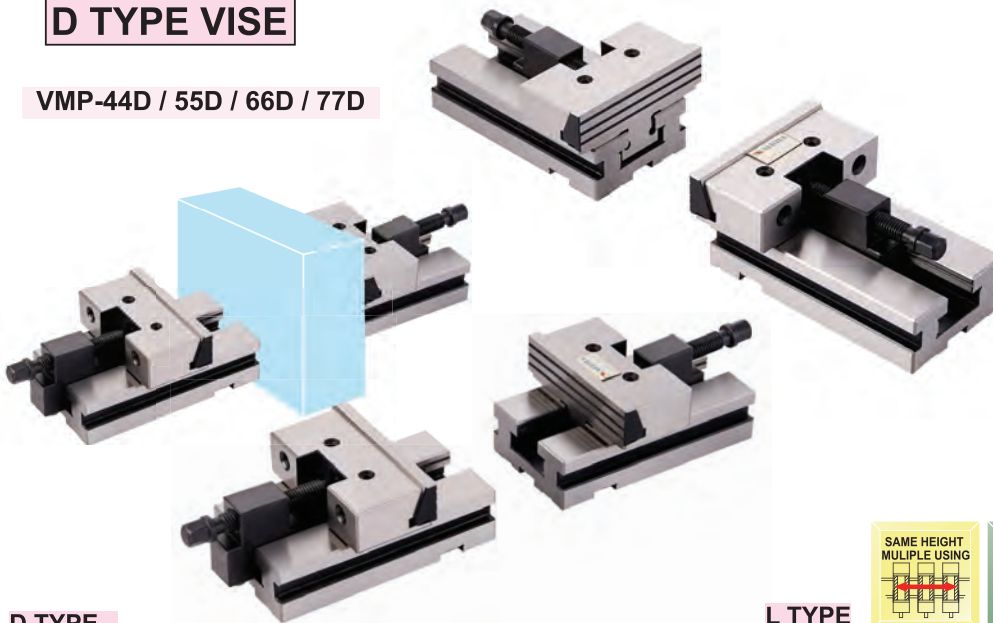

D TYPE

L TYPE

ORDER NO.	VMP-44D	VMP-55D	VMP-66D	VMP-77D
A	100	125	150	175
B	30	40	50	60
C	78	78	90	97
D	140	160	230	240
E	35	40	50	58
F	16	16	16	16
G	65	80	100	118
KGS	8.5	14.5	30.1	42.4
CODE NO.	1002-206D	1002-207D	1002-208D	1002-209D

ORDER NO.	VMP-4L	VMP-5L	VMP-6L	VMP-7L
A	100	125	150	175
B	30	40	50	60
C	78	78	90	97
D	140	160	230	240
E	35	40	50	58
F	16	16	16	16
G	65	80	100	118
KGS	8.5	14.5	30.1	42.4
CODE NO.	1002-206	1002-207	1002-208	1002-209



Lock-Fixed II Precision Machine Vise



ORDER NO.VMC-4
VMC-6

Performed sided vertically.



- With the ability of lock-fixed III 2, 3, 4, 5.
- Use the semi-sphere segment principle.
- When operate several vises (in a row) put on one machine bed, the operating situation is as shown.

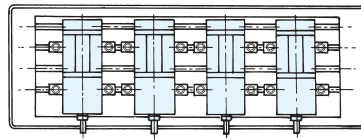
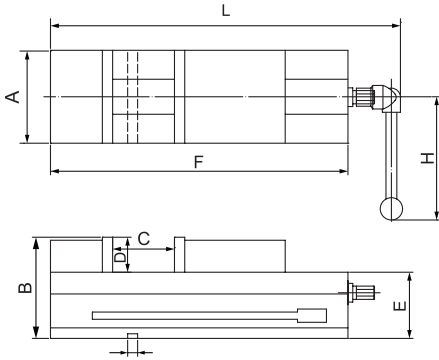
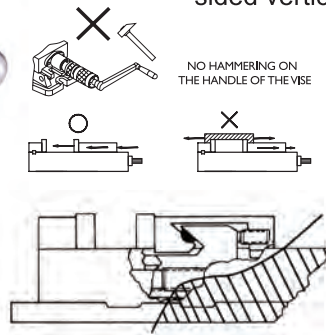

Aligned Performance

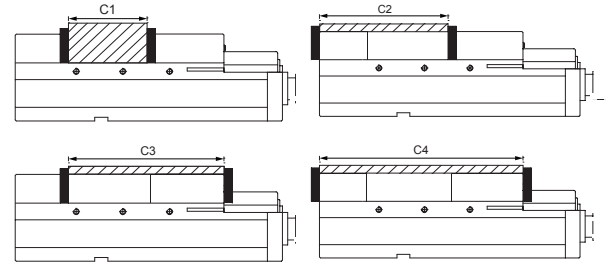

LIGHT DUTY

JAW DOWNWARD

SAME HEIGHT MULTIPLE USING

MORE SETTING POSITION

ACCURACY GUARANTEE

0.01/100 MM 0.02/50

TABLE HARDNESS

BENDING PROOF

MECHANICAL

ORDER NO.	A	B	C OPEN	D	E	F	G	L	H	Max. Clamp Force (kgf)	Meas CUFT	Weight (kgs)	CODE NO.
VMC-4	108	100	103	36	63	283	16	374	202	1500	0.4	14.2	1002-185
VMC-6	156	120	150	46	74	370	16	472	221	2500	1.1	29.8	1002-186



Free Angle Vise

NEW

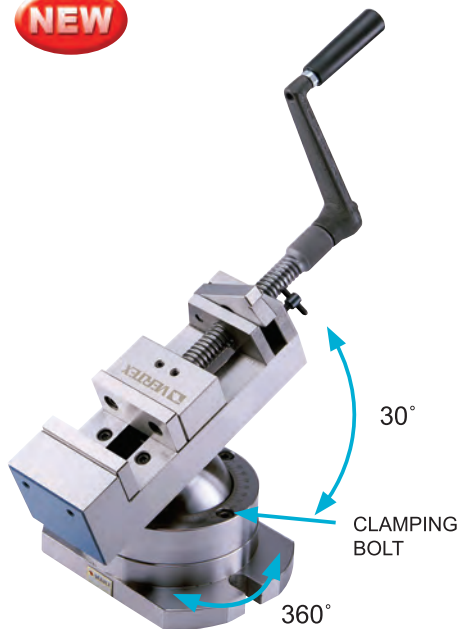

Features

ANY TILTING ANGLE

- Special design for quick clamping. (From the acme thread shaft stationly)
- Quick setting by sliding movement. Big clamping capability.
- Operating very quick and easy, can increase so much working efficiency than you can image.
- 360° Rotation, Tilting 30°
- Most free angle vise
- For non-normal angle setting.
- Its swivelling and tilting features with clamping make this unit for straight or inclined surface, angular drilling machining on various machine tools or for bench work table.

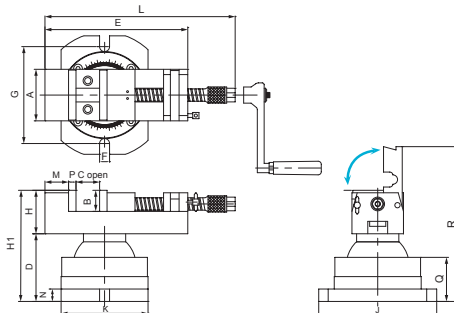

LIGHT DUTY

ACCURACY GUARANTEE

0.01/100 MM 0.02/50

MECHANICAL

patent

PAT.

ORDER NO.	A	B	C OPEN	D	E	F	G	H	H1	J	K	L	M	N	P	Q	R	MAX. Clamp Force (kgf)	Weight (kgs)	CODE NO.
VAV-3	82	34	85	110	230	17	158	70	194	190	140	374	38	20	12	72	268	700	17.6	1002-214
VAV-4	106	36	104	120	256	17	158	72	206	190	140	422	38	20	16	72	280	800	21.4	1002-215



Double Clamp Vise



NEW

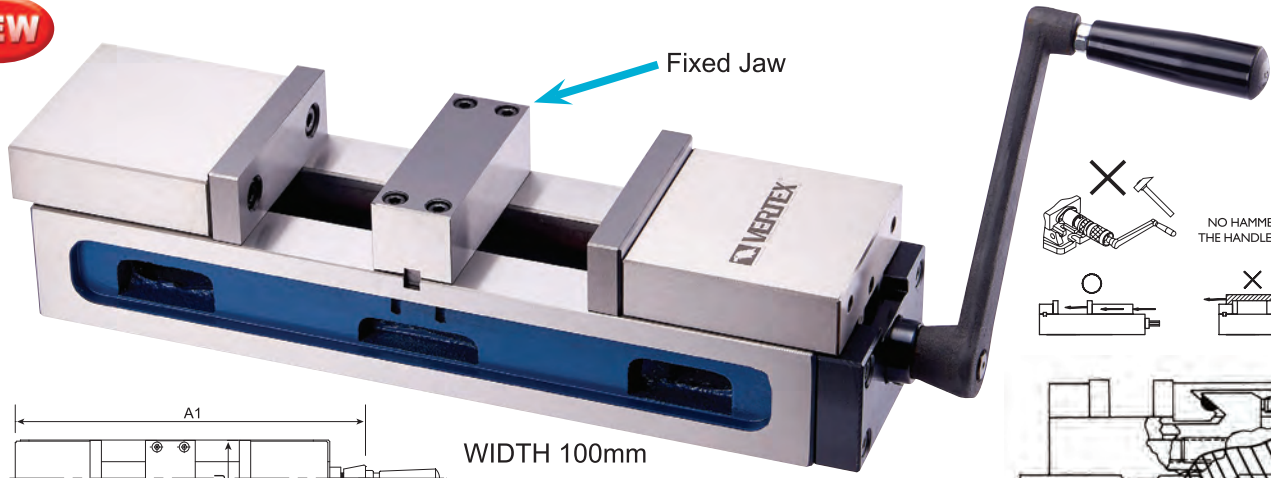

Fixed Jaw

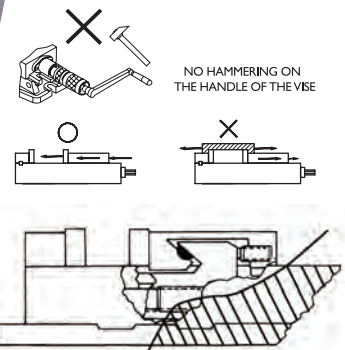

DOUBLE CLAMP VISE

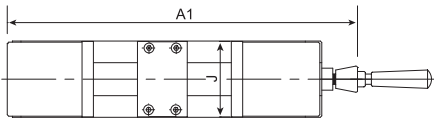

WIDTH 100mm

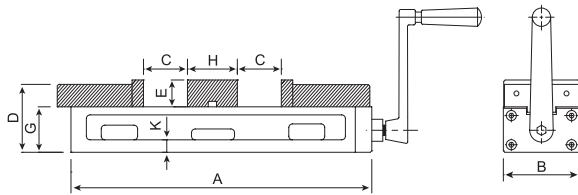

- Opened 50mm each side.
- Accept 3mm workpiece different length.
- The slide ways are hardened.
- Precision made.
- One handle can operate two movable jaws and clamps 2 pieces of workpiece of similar size, for 3mm space.
- Lift Proof : Press down design.

LIGHT DUTY	JAW DOWNWARD	SAME HEIGHT MULTIPLE USING	MORE SETTING POSITION	ACCURACY GUARANTEE 0.01/100 MM 0.02/50	TABLE HARDNESS	BENDING PROOF	MECHANICAL	SELF-CENTER
-------------------	---------------------	-----------------------------------	------------------------------	--	-----------------------	----------------------	-------------------	--------------------

Unit:mm

ORDER NO.	A	A1	B	C OPEN	D	E	G	H	J	K	MAX. Clamp Force (kgf)	Weight kgs	CODE NO.	
VCV-4D	410	469	108	0~50	0~50	92	36	62	40	107	16	450	18.2	1002-236



Compound Precision Vise

NEW

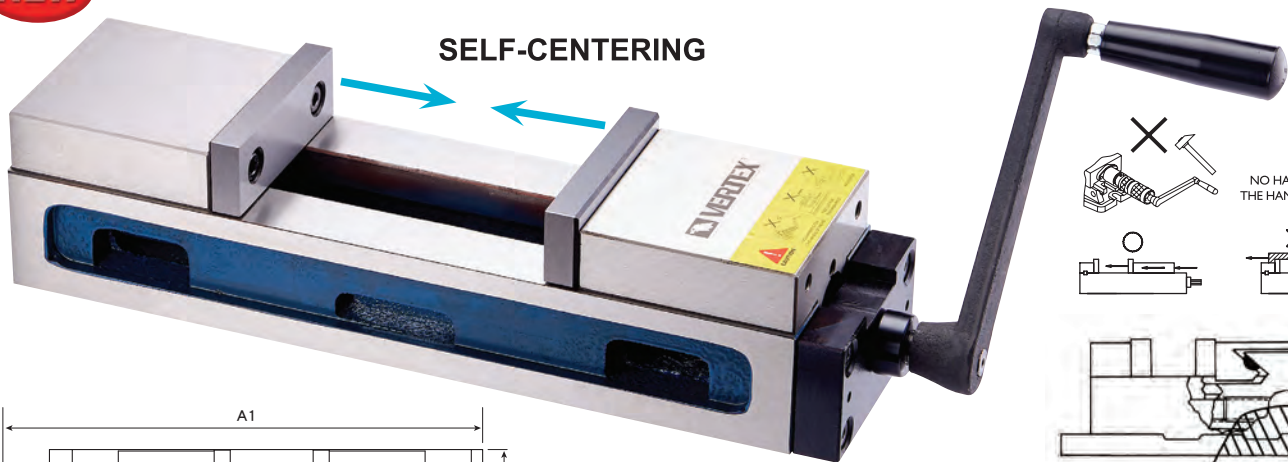

SELF-CENTERING

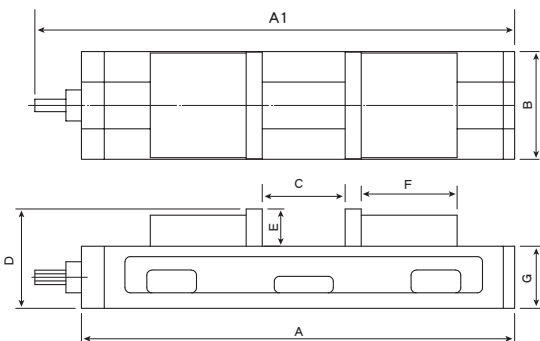
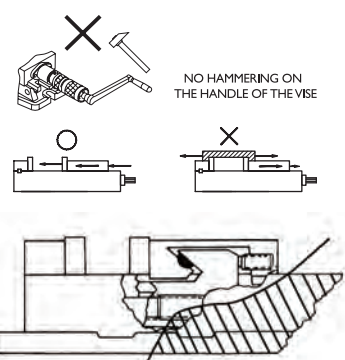

- Self centering. Suit for rough or irregular workpiece.
- Compact design, 185mm super opened.
- High Accuracy
- Super open capacity=190mm
- Rapid and convenient centralizing.
- Lift Proof : Press down design.

LIGHT DUTY	JAW DOWNWARD	SAME HEIGHT MULTIPLE USING	ACCURACY GUARANTEE 0.01/100 MM 0.02/50
TABLE HARDNESS	BENDING PROOF	SELF-CENTER	MECHANICAL

ORDER NO.	A	A1	B	C OPEN	D	E	F	G	MAX. Clamp Force (kgf)	Weight (kgs)	CODE NO.
VCV-44	420	469	108	185	98	36	102	62	450	17.7	1002-240