



Dustproof Halogen Lamp Beam



WITH TRANSFORMER & MAGNETIC BASE

● IP20

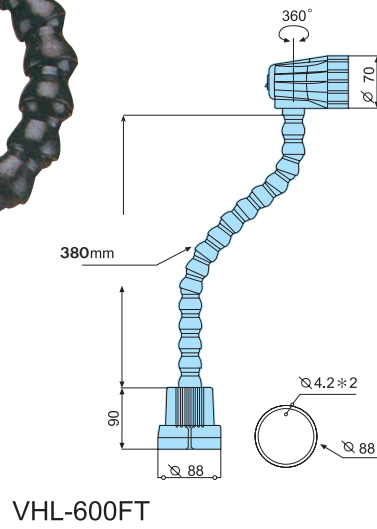

VHL-600FT

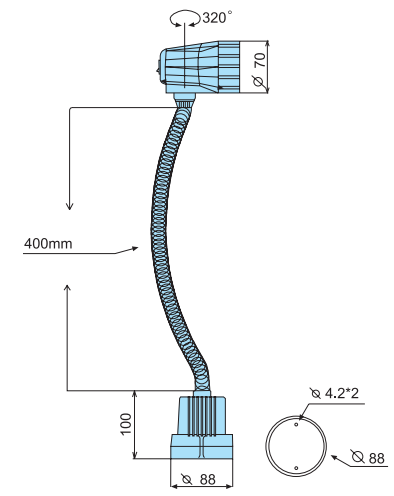

VHL-700FT

Features

- VHL-600FT, VHL-700FT type ideal for work-place lighting if bright concentrated light is required in performance not too large area illumination. Built in transformer.
- Suitable for use at small machine such as CNC engraving machine, sewing machine, lathe machine, working benches and working table.....etc.
- VHL-700FT with flexible arm.

※ Please confirm voltage & phase when order.

ORDER NO.	VOLTAGE	BULB	ARM LENGTH L x l	OPTIONAL ACCESSORIES	WEIGHT N.W.(KGS)	CODE NO.
VHL-600FT	110V - 220V	12V 20W	380	M-23	1.7	1025-109
VHL-700FT	110V - 220V	12V 20W	400	M-23	1.7	1025-110

V-B15		12V 50W / 24V 50W			0.009	1025-111
V-B16		12V 55W / 24V 70W			0.009	1025-112
V-T17	415V - 12 / 415V - 24 380V - 12 / 380V - 24 230V - 12 / 230V - 24				1.47	1025-113
V-T18	415V - 12 / 415V - 24 380V - 12 / 380V - 24 230V - 12 / 230V - 24				1.4	1025-114

V-T17



TRADITIONAL
TRANSFORMER V-T17
SUITABLE FOR
VHL-400 SERTES
VHL-500 SERTES

V-T18

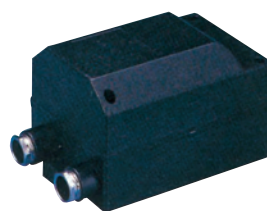

EXTERIOR DUST-FREE
TRANSFORMER V-T18
Voltage below 415V. Can
be installed anywhere.
Dust-Free, leakage-proof
and oil-proof.

V-B15



V-B15
12V/50W, 24V/50W
Those bulb for VHL-400,
VHL-500 series

V-B16



V-B16
24V/70W, 12V/55W
Those bulb for VHL-400,
VHL-500 series



Water Proof LED Lamp



NEW

ENERGY SAVING

UNIVERSAL TYPE

LED TYPE



LAMP BEAM

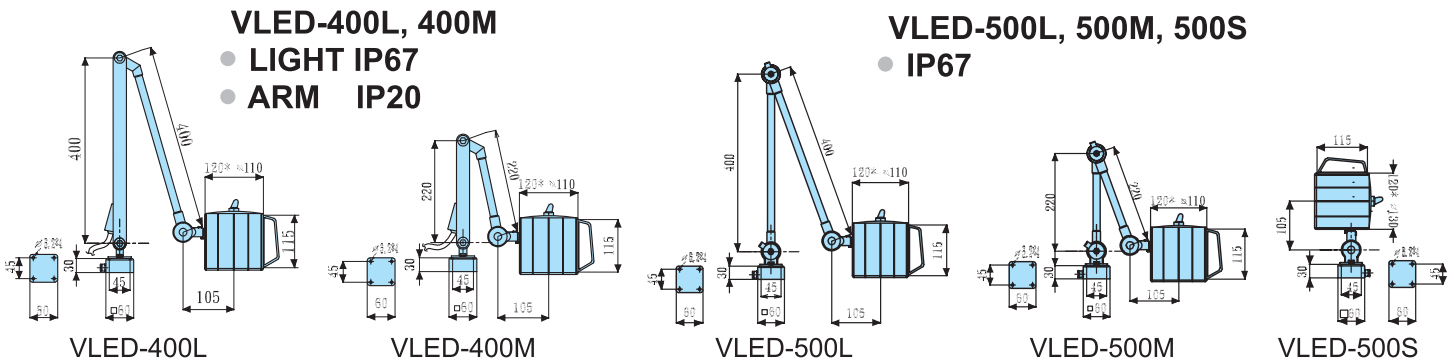

Features

- Energy saving
- Luminous flux: 780~800 lumen
- LED light long service life
- 1 year guarantee
- 1.8 meter coil
- White light
- No high heat produce
- Dust/water proof
- Specify voltage when ordering
- For any working place, stable quality
- Suit for CNC, engraving, drill press machine, lathe, wood and mold industry

※ Please confirm voltage & phase when order.

ORDER NO.	VOLTAGE	BULB	ARM		WEIGHT N.W.(KGS)	CODE NO.
			L x l	TUBE STYLE		
VLED-400L	110V / 220V	9W	400 X 400	SQUARE	2.12	1025-130
VLED-400M	110V / 220V	9W	220 X 220	SQUARE	1.96	1025-131
VLED-500S	110V / 220V	9W	JOINT	ROUND	1.6	1025-132
VLED-500L	110V / 220V	9W	400 X 400	ROUND	2.42	1025-136
VLED-500M	110V / 220V	9W	220 X 220	ROUND	2.3	1025-137

●OPTIONAL●

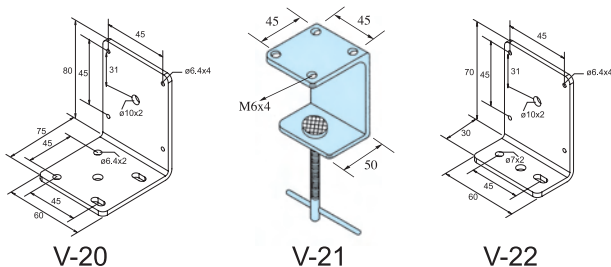

Totally enclosed lighting head provides well prevention for explosion, dust, coolant, and lubricants.

- LED9W High lumen 780~800 Led light bulb

OPTIONAL ACCESSORIES		
ORDER NO.	WEIGHT (kg)	CODE NO.
V-20	0.28	1025-106
V-21	0.48	1025-107
V-22	0.16	1025-119
LED9W	0.19	1025-141A



Concentrate LED Lamp



UNIVERSAL TYPE



NEW



Features

- Energy saving
- LED light long service life
- 1 year guarantee
- Luminous flux: 250~330 lumen
- No high heat produce
- Dust proof
- Flexible & folding arm
- Built-in transformer
- Suit for small CNC, engraving, sewing machine, drill press, lathe, and working table
- IP20

※ Please confirm voltage & phase when order.

ORDER NO.	VOLTAGE	BULB	ARM L x ℓ	WEIGHT N.W.(KGS)	CODE NO.
VLED-30L	INPUT: 220V OUTPUT: AC / DC 12V	12V 6W	400 X 310 mm	2	1025-125
VLED-30L	INPUT: 110V OUTPUT: AC / DC 12V	12V 6W	400 X 310 mm	2	1025-126
VLED-30M	INPUT: 220V OUTPUT: AC / DC 12V	12V 6W	220 X 310 mm	1.8	1025-127
VLED-30M	INPUT: 110V OUTPUT: AC / DC 12V	12V 6W	220 X 310 mm	1.8	1025-128

OPTIONAL

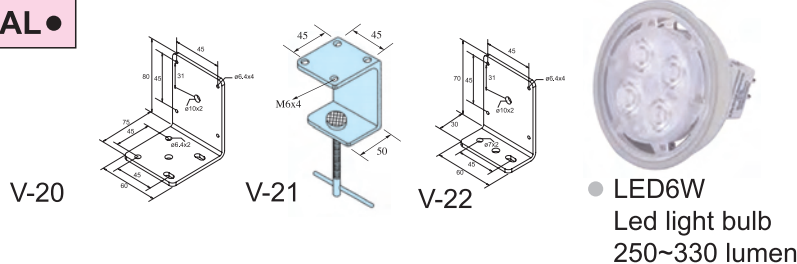

OPTIONAL ACCESSORIES

ORDER NO.	WEIGHT (kg)	CODE NO.
V-20	0.28	1025-106
V-21	0.48	1025-107
V-22	0.16	1025-119
LED6W	0.14	1025-140



Wide Range Halogen Lamp Beam

NEW

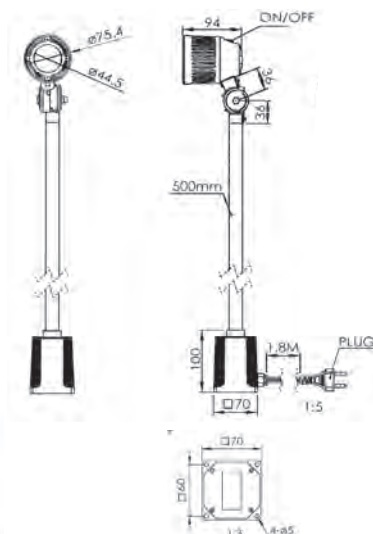

Features

- Power consumption :21.5W
- Angle:36°
- Color temperature:2800K
- Lumens value:210 lm
- Voltage:AC 220V power 12V
- With transformer built-in
- IP20

OPTIONAL



ORDER NO.	VOLTAGE	BULB	ARM L x ℓ	WEIGHT N.W.(KGS)	CODE NO.	ORDER NO.	WEIGHT (kg)	CODE NO.
VHL-50FT	AC 220V	12V / 20W	500 mm	1.69	1025-151	V-51	0.52	1025-161
						V-52	0.27	1025-162



1/8 HP. Under Water Coolant Pump



Features

This is the pump in best quality with anti-rust treatment, use high grade material for the complete set and has been duly inspected in five steps by precision electron device.

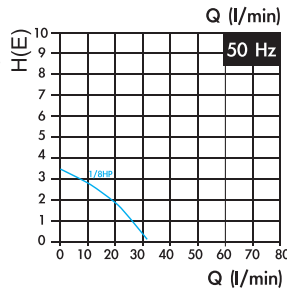

220V 1PH
380V 3PH

Unit:mm

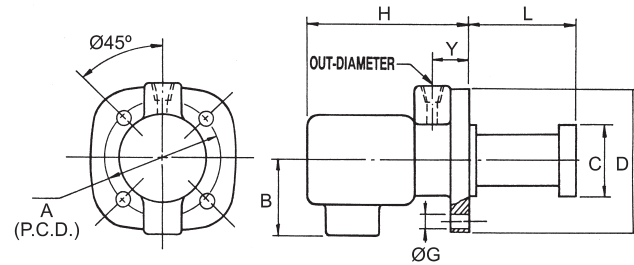

※ Please confirm voltage & phase when order.

Unit:mm

POWER	A	B	C	D	G	H	Y	OUT-DIAMETER
1/8 HP	128±0.2	105	Ø90	Ø150	Ø8	160	19	PT 3/8

ORDER NO.	TYPE	POWER	L mm	PUMPING WATER		WEIGHT (kg)	CODE NO.
				1 mm	2 mm		
WVP-0810	UNDER WATER	1/8 HP	100	27ℓ-28ℓ	25ℓ-26ℓ	5.5	1026-001
WVP-0813			130				
WVP-0815			150				
WVP-0818			180				



1/4 HP. Under Water Coolant Pump

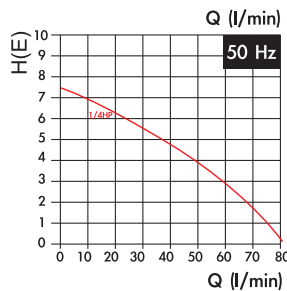

220V 1PH
380V 3PH

Unit:mm

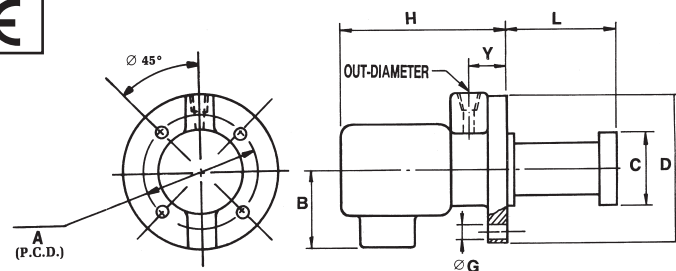

※ Please confirm voltage & phase when order.

Unit:mm

POWER	A	B	C	D	G	H	Y	OUT-DIAMETER
1/4 HP	158±0.2	125	Ø122	Ø180	Ø8	180	26	PT 1/2

ORDER NO.	TYPE	POWER	L mm	PUMPING WATER		WEIGHT (kg)	CODE NO.
				1 mm	2 mm		
WVP-0415	UNDER WATER	1/4 HP	160	74ℓ-76ℓ	71ℓ-72ℓ	11.1	1026-010
WVP-0418			180				
WVP-0420			200				
WVP-0424			240				
WVP-0427			270				



Self Priming Coolant Pump 1/8 HP. 1/4 HP

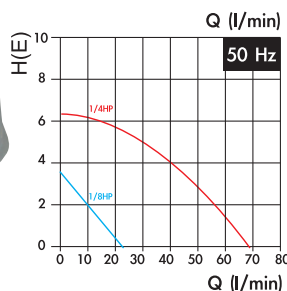

220V 1PH
380V 3PH

Unit:mm

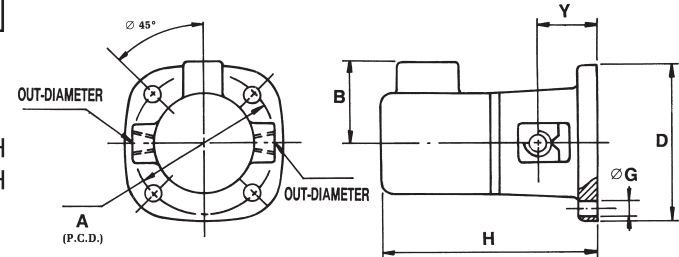

※ Please confirm voltage & phase when order.

Unit:mm

POWER	A	B	D	G	H	Y	IN-DIAMETER	OUT-DIAMETER
1/8 HP	140±0.2	105	165	Ø8	195	50±0.5	PT 3/8	PT 3/8
1/4 HP	185±0.2	125	225	Ø8	240	65±0.5	PT 1/2	PT 1/2

ORDER NO.	TYPE	POWER	PUMPING WATER		WEIGHT (kg)	CODE NO.
			1 mm	2 mm		
WVP-089	SELF PRIMING	1/8 HP	26ℓ-27ℓ	24ℓ-25ℓ	5.9	1026-020
WVP-049		1/4 HP	73ℓ-75ℓ	70ℓ-71ℓ		



Coolant Pump Kit



1/8 HP & 1/4 HP



220V 1PH
380V 3PH



SET INCLUDING



- Coolant pump
- Coolant tank
- Connecting cable (w/plug for 1 ph)
- Coolant hose kit w/magnetic base
- Flexible conveying hose
- Drain hose
- Tool kits
- ON/OFF switch (for 1ph)

※ Please confirm voltage & phase when order.

COOLANT PUMP

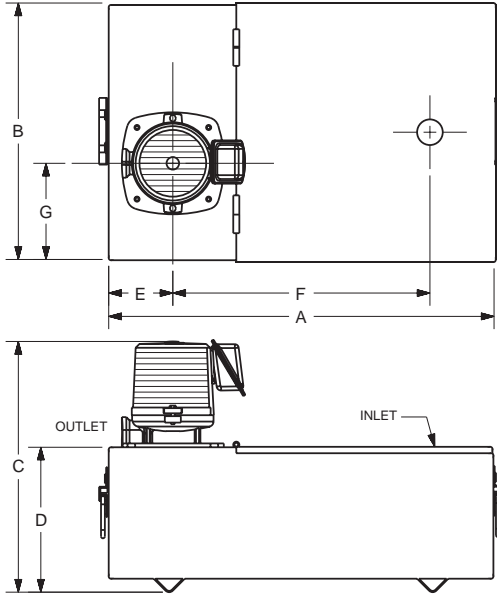

Type	A mm	B mm	C mm	D mm	E mm	F mm	G mm	Volume litre
VWP-81-150K	352	260	350	190	68	232	102	15ℓ
VWP-41-180K	600	400	400	230	100	500	150	45ℓ

ORDER NO.	VWP-81-150K	VWP-41-180K
ITEM		
Coolant pump (HPxH)	1/8 HP x 150mm	1/4 HP x 180mm
Tank size (LxWxH)	350x250x185mm	600x400x230mm
Volume of coolant tank	15	45ℓ
Connecting cable	1500mm	1500mm
Coolant hose kits w/magnetic base (ØxL)	1/4" x 300mm	1/2" x 300mm
Flexible conveying hose (ØxL)	3/8" x 1500mm	1/2" x 1500mm
Drain hose (ØxL)	1" x 300mm	1" x 300mm
Weight(kgs)	10.8	33
CODE NO.	1026-030	1026-031



Under Water Type Multi-stage High Pressure Coolant Pump

220V 1PH
380V 3PH

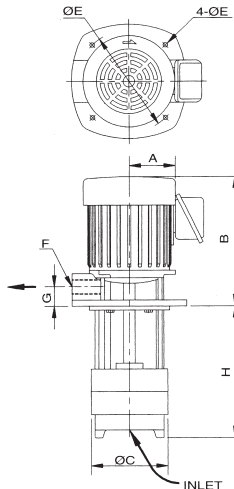

Special Features

- Discharge available in either N.P.T / P.T.
- Heavy duty bearings greased for long life and easy maintenance.
- Multi-stages., up to 6 stages for pressure over 9kg/cm² staggered discharge ports equalize radial loads for increasing pump life.
- Stainless steel made enclosed impeller., increasing pump efficiency and flow volumn.
- Rigid and strong one-piece shaft.

※ Please confirm voltage & phase when order.

SPECIFICATION

ORDER NO.	STAGE	HP	A	B	C	D	E	F	G	H	PRESSURE kg/cm ² (PSI)	VOLUMETRIC DELIVERY (ℓ/min)		DELIVERY HEAD (m)	WEIGHT (kg)	CODE NO.
												EMULSION	COOLING OIL			
VWP-MS2-180	2	3/4	135	255	135	9	170	3/4" or 1" (option)	28	180	3 (42)	140	116	30	15	1026-040
VWP-MS2-250																
VWP-MS3-200	3	1	135	275	135	9	170	3/4" or 1" (option)	28	200	4.5 (64)	140	116	45	16	1026-042
VWP-MS3-250																
VWP-MS4-230	4	1 1/4	135	275	135	9	170	3/4" or 1" (option)	28	230	6 (85)	140	116	60	18	1026-044
VWP-MS4-180																
VWP-MS5-210	5	1 1/2	135	275	135	9	170	3/4" or 1" (option)	28	210	7.5 (106)	140	116	75	20	1026-046



Hand Lubrication Pump



LT-4

● **Rattling hand pump LT model**

Rattle the lever of the pump reiteratively and the oil will be pressured into the main pipe. When the lever is released, it will return to the original position automatically.

ORDER NO.	Discharged amount (c.c/st)	Max. discharged pressure (kg/cm ²)	capacity (c.c)	Efficient capacity (c.c)	WEIGHT (kg)	CODE NO.
LT-4	4	15	230	200	0.7	1026-050

● **Rattling hand pump LT model**

The discharged amount and pressure are higher than those of LT-4 and the operation method is just the same.

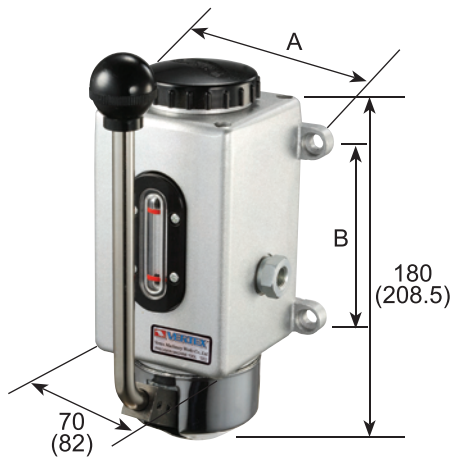

LT-6

ORDER NO.	LT-6	LT-18	LT-18A
Size (AxB)	85x85	100x110	98x107
Weight	1.2kg	1.6kg	1.6kg

ORDER NO.	Discharged amount (c.c/st)	Max. discharged pressure (kg/cm ²)	capacity (c.c)	Efficient capacity (c.c)	CODE NO.
LT-6	6	15	350	250	1026-061
LT-18	8	15	600	400	1026-062
LT-18A	8	15	650	450	1026-063



EA-8R

● **Pulling type hand pump EA model**

Pull the lever of the pump reiteratively and the oil will be discharged at the up or down port.

ORDER NO.	Discharged amount (c.c/st)	Max. discharged pressure (kg/cm ²)	capacity (c.c)	Efficient capacity (c.c)	WEIGHT (kg)	CODE NO.
EA-8 R	8	3.5	600	500	1	1026-070
EA-8 L						1026-071

The installation machine could be selected either the right side marked "R" or the left side marked "L"



Hand Lubrication Pump

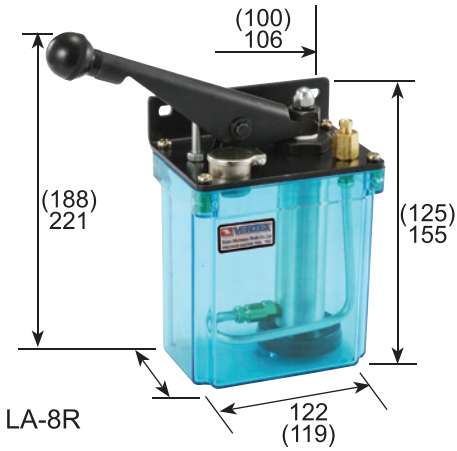

LA-8R

● Depressing type hand-pump model LA

Depress the lever repeatedly, first. The oil will be pressured out when it's depressed. Only after the lever is released, the pressured oil will be discharged.

ORDER NO.	Discharged amount (c.c/st)	Max. discharged pressure (kg/cm ²)	capacity (c.c)	Efficient capacity (c.c)	WEIGHT (kg)	CODE NO.
LA-8 R	1~8	5	1000	800	1.4	1026-082
LA-8 L						1026-083

The installation position of a machine could be selected either the right side marked "R" or the left side marked "L"

● Operation Instructions:

When move the operating rod, the plunger (iron core) will be moved simultaneously so as to make cylinder become under negative pressure. Then, due to closed air pressure of the tank, the grease will get into the cylinder from the suction port. Now, operate the rod to extrude out the grease through pipe in the cylinder by principle of the plunger pushing open the check valve. When inside pressure reaches to the specific pressure of 100kg/cm², down pressure valve will start to return the grease to the oil tank. The operating rod is to use of a spring to link on the injector, while the oil tank is tightly fixed on the injector as a round storage tank to prevent from oil leaking.

Advantages:

- Has smooth stickness to the lubricating surface with proper oiling capacity, so no surplus oil will be leaked out to stain with the surface of bench.
- No need to worry about the dirt & impurities entered into the oiling port, so it is more clean than other ways of lubrication.
- Manual type pump. Use of single pipe, so no need of pipe return device. With simple piping for best effect.



LA-1403

LA-2403

ORDER NO.	A	B	C	OIL	c.c./stoke	VOLUME c.c.	PRESSURE kg/cm ²	VALVE	SPRAY MOUTH	CODE NO.
LA-1403	290	150	70	MACHINE OIL	2	300	60	SD	60 □	1026-100
LA-1408	310	205	90			800				1026-101
LA-2403	290	150	70	GREASE	2	300	100	SD	60 □	1026-102
LA-2408	310	205	90			800				1026-103



Electrical Automatic Pump SMA Model



SMA MODEL (AUTOMATIC)

● Electrical automatic pump SMA model

The outstanding performances of SMA models belong to intermittent oil supply pumps whose specification are classed into four kinds by the frequency and the discharged amount is adjustable within the range of 1~3c.c.

ORDER NO.	Frequency (time / min)	Discharged amount (c.c/st)	Max. discharged pressure (kg/cm ²)	Capacity (ℓ)	WEIGHT (kg)	CODE NO.
SMA-3	Choose to pump every 5 or 10 or 15 or 30 or 60 min.	1~3	3	2	1.8	1026-090
SMA-6		3~	3	2	1.8	1026-091
SMA-8.5		4~8.5	3	2	1.9	1026-092

Motor's voltage is AC 110V or 220V

※Please choose FREQUENCY when order.



Chamfering & Deburring For R Dual Angle Unit



ORDER NO. VCF-500R

CODE NO. 1023-008

NEW



ADJUSTABLE SCREW FOR CUTTER





S.A. ORDER NO. VCF-500R-RMC
Machine Unit With 2R Blade Insert

FEATURES

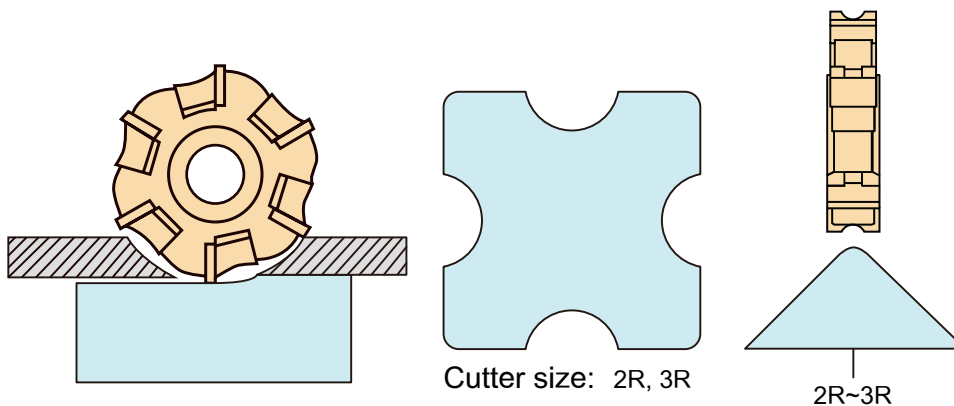
- Easy chamfering any length of steel, iron, casting iron and non-metal materials.
- Adjustable cutting point of C angle to make the full using of side knife.
- Accessories: R side mill cutter. specification form 2R, 3R.

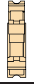

STANDARD ACCESSORIES

ORDER NO.	DESCRIPTION CUTTER / INSERT	CODE NO.
VCF-500R-RMC	ROUND INSERT SIDE MILL CUTTER 	1023-039
VCF-500R-2R	2R BLADE INSERT / 10pcs 	1023-040
VCF-500R-3R	3R BLADE INSERT / 10pcs 	1023-041

TECHNICAL DATA

Machine Size	L500xW400xH320mm
Voltage	3Ø, 220V-400V, or 1Ø, 110V/220V ; 50Hz/60Hz
Motor	1HP, 3500 r.p.m. (Standard)
Height of bevel	2R, 3R
N.W. / G.W.	28kgs / 31kgs
Packing	55x46x32cm, 3 Cuft



Power Tilting Vise

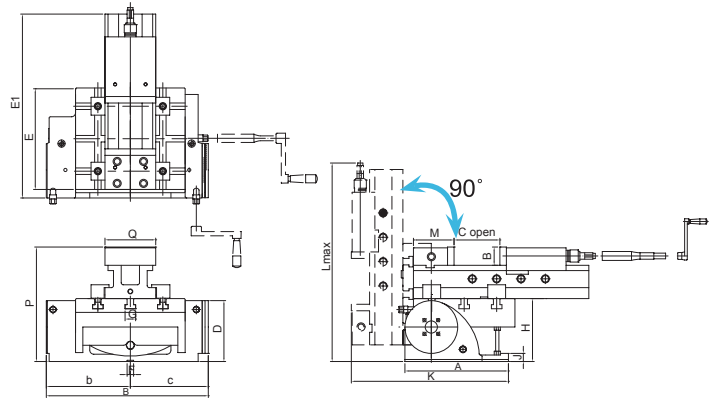
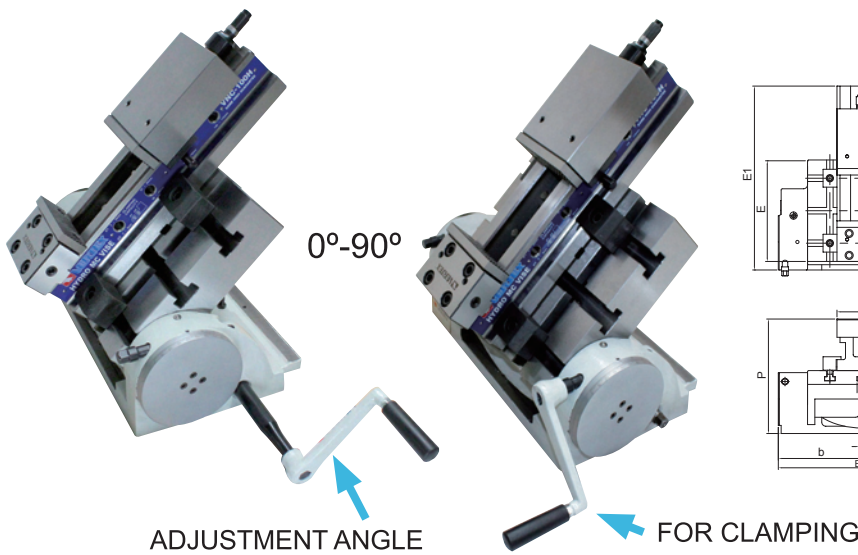

- Tilting by rigid & strong design, 2 supporter & rigid clamping system construction.
- Minimum set-up time.
- Tilting angle can adjusted by worm & worm gear system.
- Accurate and built for use in milling, boring and other machines.
- Worm shafts are hardened and ground.
- Tilting plate with slots enable Multi-position work fixing.
- Strong structure.
- Hydro-booster system for maximum clamping pressure with minimum force.
- Sliding bed ways flame hardened and ground.
- Compact design. Great clamping capacity. Light & smooth operation.
- Body is made of FCD60 ductile cast iron, High deflection/ bending resistant.
- Constructed for machining center, milling, drilling, grinding and many other machine shop applications.

ORDER NO.	A	B	C open	D	E	E1	F	G	H	J	K	L max.	M	P	Q	b	C	CODE NO.
VUT-4NC	180	285	205	156	150	390	16	20	115	16	292	502	80	264	100	143	125	1002-251
VUT-5NC	255	399	225	270	258	442	16	22	155	20	386	619	100	397	124	210	187	1002-252
VUT-6NC	300	449	310	320	298	560	16	26	169	25	453	757	120	469	159	235	212	1002-253



Tilting Quick Vise

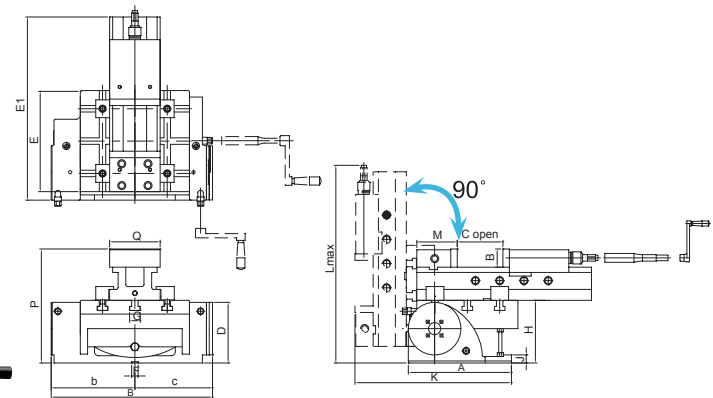
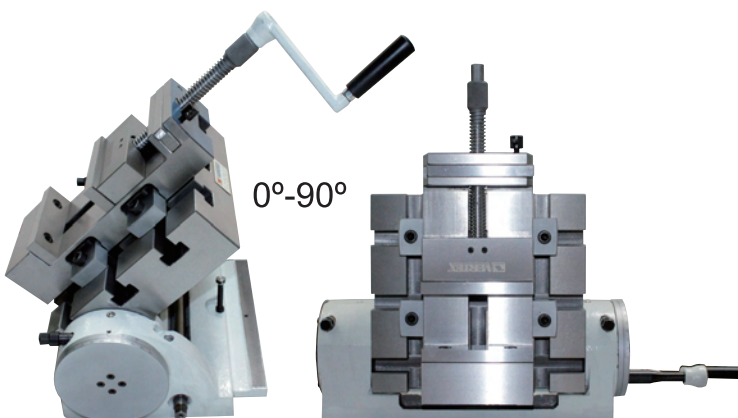

- THE FEATURE IS SAME AS VUT-4NC
- Special design for quick clamping. (From the acme thread shaft stationly)
- Quick setting by sliding movement. Big clamping capability.
- Operating very quick and easy, can increase so much working efficiency than you can image.
- Good for short term and massive production or proto type work.
- Suit for milling machine, grinding machine, precision drilling machine.
- Accurate grounded and assembled.
- Precision cut acme thread.
- Horizontal & vertical

ORDER NO.	A	B	C open	D	E	E1	F	G	H	J	K	L max.	M	P	Q	b	C	CODE NO.
VUT-3QS	180	34	85	113	150	240	16	20	115	16	255	412	28	185	81	143	125	1002-258
VUT-4QS	255	36	104	150	258	266	16	22	155	20	332	485	55	227	105	210	187	1002-259
VUT-5QS	300	36	125	169	298	307	16	26	169	25	379	563	60	243	131	235	212	1002-260