

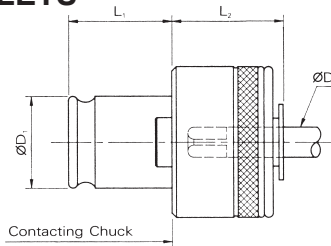

# Quick Change Tapping Chucks



**QUICK CHANGE TAP COLLETS**  
(with overload clutch)



## JIS SYSTEM SIZE

1PC ≅ 0.18kg

Size	Thread	Tap Shank		Ø D1	L1	L2	ORDER NO.	CODE NO.
		ØD	□					
TC 312 (#1)	M3	4	3.2	19	22	25	312-01	3404-200
	M4	5	4				312-02	3404-201
	M5	5.5	4.5				312-03	3404-202
	M6	6	4.5				312-04	3404-203
	M7	6.2	5				312-05	3404-204
	M8	6.2	5				312-06	3404-205
	M9	7	5.5				312-07	3404-206
	M10	7	5.5				312-08	3404-207
	M11	8	6				-312-09	3404-208
	M12	8.5	6.5				312-10	3404-209
	•M14	10.5	8				•312-11	3404-210
	•M15	10.5	8				•312-12	3404-211
	UNC 1/4	6	4.5				312-13	3404-212
	UNC 5/16	6.1	5				-312-14	3404-213
	UNC 3/8	7	5.5				312-15	3404-214
	UNC 7/16	8	6				312-16	3404-215
	UNC 1/2	9	7				312-17	3404-216
	•UNC 9/16	10.5	8				•312-18	3404-217
	PT 1/8	8	6				312-19	3404-218
	PT 1/4	11	9				312-20	3404-219

- Torque is factory-set to protect the tap for which a particular collet is designed. Small adjustments can be made by a trained user to accommodate tap strength and material variations.
- Collet stops driving when set torque is exceeded.
- A collet is necessary for each tap shank diameter.

1PC ≅ 1.8kg

1PC ≅ 0.6kg

Size	Thread	Tap Shank		Ø D1	L1	L2	ORDER NO.	CODE NO.
		ØD	□					
TC 820 (#2)	M7	6.2	5	31	36	30.5	820-01	3404-230
	M8	6.2	5				820-02	3404-231
	M9	7	5.5				820-03	3404-232
	M10	7	5.5				820-04	3404-233
	M11	8	6				820-05	3404-234
	M12	8.5	6.5				820-06	3404-235
	M14	10.5	8				820-07	3404-226
	M15	10.5	8				820-08	3404-237
	M16	12.5	10				820-09	3404-238
	M17	13	10				820-10	3404-239
	M18	14	11				820-11	3404-240
	M20	15	12				820-12	3404-241
	M22	17	13				820-13	3404-242
	UNC 3/8	7	5.5				820-14	3404-243
	UNC 7/16	8	6				820-15	3404-244
	UNC 1/2	9	7				820-16	3404-245
	UNC 9/16	10.5	8				820-17	3404-246
	UNC 5/8	12	9				820-18	3404-247
	UNC 3/4	14	11				820-19	3404-248
	UNC 7/8	17	13				820-20	3404-249
	PT 1/8	8	6				820-21	3404-250
	PT 1/4	11	9				820-22	3404-251
	PT 3/8	14	11				820-23	3404-252
	PT 1/2	18	14				820-24	3404-253
	M24	19	15				820-25	3404-254

Size	Thread	Tap Shank		Ø D1	L1	L2	ORDER NO.	CODE NO.
		ØD	□					
TC 1433 (#3)	M14	10.5	8	48	56	45	1433-01	3404-260
	M15	10.5	8				1433-02	3404-261
	M16	12.5	10				1433-03	3404-262
	M17	13	10				1433-04	3404-263
	M18	14	11				1433-05	3404-264
	M20	15	12				1433-06	3404-265
	M22	17	13				1433-07	3404-266
	M24	19	15				1433-08	3404-267
	M25	19	15				1433-09	3404-268
	M26	20	15				1433-10	3404-269
	M27	20	15				1433-11	3404-270
	M28	21	17				1433-12	3404-271
	M30	23	17				1433-13	3404-272
	M32	24	19				1433-14	3404-273
	M33	25	19				1433-15	3404-274
	M34	26	21				1433-16	3404-275
	M35	26	21				1433-17	3404-276
	M36	28	21				1433-18	3404-277
	UNC 9/16	10.5	8				V433-19	3404-278
	UNC 5/8	12	9				1433-20	3404-279
	UNC 3/4	14	11				1433-21	3404-280
	UNC 7/8	17	13				1433-22	3404-281
	UNC 1	20	15				1433-23	3404-282
	UNC 1 1/8	22	17				1433-24	3404-283
	UNC 1 1/4	24	19				1433-25	3404-284
	UNC 1 3/8	26	21				1433-26	3404-285
	UNC 1/4	11	9				1433-27	3404-286
	PT 3/8	14	11				1433-28	3404-287
	PT 1/2	18	14				1433-29	3404-288
	PT 3/4	23	17				1433-30	3404-289
	PT 1	26	21				1433-31	3404-290



# Quick Change Tapping Chucks



**QUICK CHANGE TAP COLLETS**  
(without overload clutch)

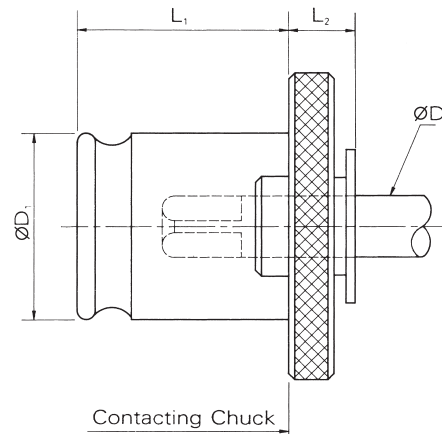

Contacting Chuck

1PC ≅ 0.8kg

## JIS SYSTEM SIZE

1PC ≅ 0.08kg

Size	Thread	Tap Shank		Ø D1	L1	L2	ORDER NO.	CODE NO.
		ØD	□					
TC312B (#1)	M3	4	3.2	19	21.5	7	312B-01	3404-300
	M4	5	4				312B-02	3404-301
	M5	5.5	4.5				312B-03	3404-302
	M6	6	4.5				312B-04	3404-303
	UNC 5/16	6.1	5				312B-05	3404-304
	M7/M8	6.2	5				312B-06	3404-305
	M9/M10	7	5.5				312B-07	3404-306
	M11	8	6				312B-08	3404-307
	M12	8.5	6.5				312B-09	3404-308
	UNC 1/2	9	7				312B-10	3404-309
	M14	10.5	8				312B-11	3404-310
	PT 1/4	11	9				312B-20	3404-311

Size	Thread	Tap Shank		Ø D1	L1	L2	ORDER NO.	CODE NO.
		ØD	□					
TC1433B (#3)	M14/M15	10.5	8	48	55.5	14	1433B-01	3404-360
	PT 1/4	11	9				1433B-02	3404-361
	UNC 5/8	12	9				1433B-03	3404-362
	M16	12.5	10				1433B-04	3404-363
	M17	13	10				1433B-05	3404-364
	M18	14	11				1433B-06	3404-365
	M20	15	12				1433B-07	3404-366
	M22	17	13				1433B-08	3404-367
	PT 1/2	18	14				1433B-09	3404-368
	M24/M25	19	15				1433B-10	3404-369
	M26/M27	20	15				1433B-11	3404-370
	M28	21	17				1433B-12	3404-371
	UNC 1 1/8	22	17				1433B-13	3404-372
	M30	23	17				1433B-14	3404-373
	M32	24	19				1433B-15	3404-374
	M33	25	19				1433B-16	3404-375
	M34/M35	26	21				1433B-17	3404-376
	M36/M38	28	21				1433B-18	3404-377

1PC ≅ 0.28kg

Size	Thread	Tap Shank		Ø D1	L1	L2	ORDER NO.	CODE NO.
		ØD	□					
TC820B (#2)	M7/M8	6.2	5	31	35	11	820B-01	3404-330
	M9/M10	7	5.5				820B-02	3404-331
	M11	8	6				820B-03	3404-332
	M12	8.5	6.5				820B-04	3404-333
	UNC 1/2	9	7				820B-05	3404-334
	M14	10.5	8				820B-06	3404-335
	PT 1/4	11	9				820B-07	3404-336
	UNC 5/8	12	9				820B-08	3404-337
	M16	12.5	10				820B-09	3404-338
	M17	13	10				820B-10	3404-339
	M18	14	11				820B-11	3404-340
	M20	15	12				820B-12	3404-341
	M22	17	13				820B-13	3404-342
	PT 1/2	18	14				820B-14	3404-343

### Tapping Collet Reducer Adapter

This adapter is for transforming  
This adapter allows the vat-tapping spindle to use smaller size.  
Transforming the big tapping size to smaller one.  
large range type for tap M3~M24, TC312, TC820, TC1433 COST SAVING!



### SIZE CONVERTER

ORDER NO.	TRANSFORMING SIZE	WIGHT	CODE NO.
TC312/TC820-AD	TC820 TO TC312	0.2	3404-461
TC820/TC1433-AD	TC1433 TO TC820	0.6	3404-462

● A collet is necessary for each tap shank diameter.

TAPPING CHUCKS



# Quick Change Tapping Chucks



**VERTEX®**

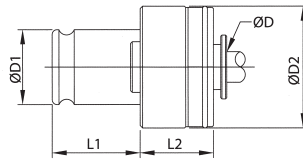
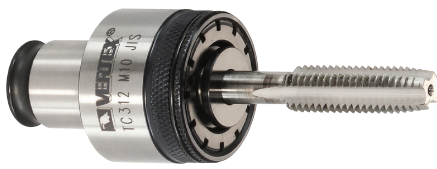

- Torque is factory-set to protect the tap for which a particular collet is designed. Small adjustments can be made by a trained user to accommodate tap strength and material variations.
- Collet stops driving when set torque is exceeded.
- A collet is necessary for each tap shank diameter.

## DIN 371 Type

ORDER NO.	Size	TC312 DIN 371 Tap	Tap Shank		Capacity	L1 (m/m)	L2 (m/m)	ØD1 (m/m)	ØD2 (m/m)	CODE NO.
			ØD	□						
312-01D	TC 312 DIN 371	M1~M1.8	2.5	2.1	M3~M14	22.5	25	19	32	3404-501
312-02D		M2~M2.5	2.8	2.1						3404-502
312-03D		M3	3.5	2.7						3404-503
312-04D		M3.5	4.0	3.0						3404-504
312-05D		M4	4.5	3.4						3404-505
312-06D		M4.5	6.0	4.9						3404-506
312-07D		M5	6.0	4.9						3404-507
312-08D		M6	6.0	4.9						3404-508
312-09D		M8	8.0	6.2						3404-509
312-10D		M10	10.0	8.0						3404-510

ORDER NO.	Size	TC820 DIN 371 Tap	Tap Shank		Capacity	L1 (m/m)	L2 (m/m)	ØD1 (m/m)	ØD2 (m/m)	CODE NO.
			ØD	□						
820-01D	TC 820 DIN 371	M5	6.0	4.9	M8~M24	35	30.5	31	50	3404-521
820-02D		M6	6.0	4.9						3404-522
820-03D		M8	8.0	6.2						3404-523
820-04D		M10	10.0	8.0						3404-524

\*Custom-built products are available on request.

## DIN 376 Type

ORDER NO.	Size	TC312 DIN 376 Tap	Tap Shank		Capacity	L1 (m/m)	L2 (m/m)	ØD1 (m/m)	ØD2 (m/m)	CODE NO.
			ØD	□						
312-21D	TC 312 DIN 376	M3.5	2.5	2.1	M3~M14	22.5	25	19	32	3404-531
312-22D		M4	2.8	2.1						3404-532
312-23D		M4.5	3.5	2.7						3404-533
312-24D		M5	3.5	2.7						3404-534
312-25D		M6	4.5	3.4						3404-535
312-26D		M7	5.5	4.3						3404-536
312-27D		M8	6.0	4.9						3404-537
312-28D		M10	7.0	5.5						3404-538
312-29D		M12	9.0	7.0						3404-539
312-30D		M14	11.0	9.0						3404-540

ORDER NO.	Size	TC820 DIN 376 Tap	Tap Shank		Capacity	L1 (m/m)	L2 (m/m)	ØD1 (m/m)	ØD2 (m/m)	CODE NO.
			ØD	□						
820-21D	TC 820 DIN 376	M8	6.0	4.9	M8~M24	35	30.5	31	50	3404-551
820-22D		M10	7.0	5.5						3404-552
820-23D		M12	9.0	7.0						3404-553
820-24D		M14	11.0	9.0						3404-554
820-25D		M16	12.0	9.0						3404-555
820-26D		M18	14.0	11.0						3404-556
820-27D		M20	16.0	12.0						3404-557
820-28D		M22	18.0	14.5						3404-558
820-29D		M24	18.0	14.5						3404-559

ORDER NO.	Size	TC1433 DIN 376 Tap	Tap Shank		Capacity	L1 (m/m)	L2 (m/m)	ØD1 (m/m)	ØD2 (m/m)	CODE NO.
			ØD	□						
1433-01D	TC 1433 DIN 376	M14	11.0	9.0	M14~M36	55.5	45	48	72	3404-571
1433-02D		M16	12.0	9.0						3404-572
1433-03D		M18	14.0	11.0						3404-573
1433-04D		M20	16.0	12.0						3404-574
1433-05D		M22	18.0	14.5						3404-575
1433-06D		M24	18.0	14.5						3404-576
1433-07D		M27	20.0	16.0						3404-577
1433-08D		M30	22.0	18.0						3404-578
1433-09D		M33	25.0	20.0						3404-579
1433-10D		M36	28.0	22.0						3404-580



# Quick Change Tapping Chucks



# VERTEX®

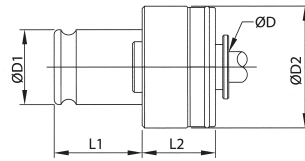

## ISO 529 Type

ORDER NO.	Size	TC312 ISO 529 Tap	Tap Shank		Capacity	L1 (m/m)	L2 (m/m)	ØD1 (m/m)	ØD2 (m/m)	CODE NO.
			ØD	□						
312-01I	TC 312 ISO 529	M1~M2	2.5	2.0	M3~M14	22.5	25	19	32	3404-601
312-02I		M2.2~M2.5	2.8	2.24						3404-602
312-03I		M3	3.15	2.5						3404-603
312-04I		M3.5	3.55	2.8						3404-604
312-05I		M4	4.0	3.15						3404-605
312-06I		M4.5	4.5	3.55						3404-606
312-07I		M5	5.0	4.0						3404-607
312-08I		M6	6.3	5.0						3404-608
312-09I		M7	7.1	5.6						3404-609
312-10I		M8	8.0	6.3						3404-610
312-11I		M9	9.0	7.1						3404-611
312-12I		M10	10.0	8.0						3404-612

ORDER NO.	Size	TC820 ISO 529 Tap	Tap Shank		Capacity	L1 (m/m)	L2 (m/m)	ØD1 (m/m)	ØD2 (m/m)	CODE NO.
			ØD	□						
820-01I	TC 820 ISO 529	M6	6.3	5.0	M8~M24	35	30.5	31	50	3404-621
820-02I		M7	7.1	5.6						3404-622
820-03I		M8	8.0	6.3						3404-623
820-04I		M9	9.0	7.1						3404-624
820-05I		M10	10.0	8.0						3404-625

\*Custom-built products are available on request.

## ISO 529/2283 Type

ORDER NO.	Size	TC312 ISO 529/2283 Tap	Tap Shank		Capacity	L1 (m/m)	L2 (m/m)	ØD1 (m/m)	ØD2 (m/m)	CODE NO.
			ØD	□						
312-21I	TC 312 ISO 529/2283	M3	2.24	1.8	M3~M14	22.5	25	19	32	3404-631
312-22I		M3.5	2.5	2.0						3404-632
312-23I		M4	3.15	2.5						3404-633
312-24I		M4.5	3.55	2.8						3404-634
312-25I		M5	4.0	3.15						3404-635
312-26I		M6	4.5	3.55						3404-636
312-27I		M7	5.6	4.5						3404-637
312-28I		M8	6.3	5.0						3404-638
312-29I		M9	7.1	5.6						3404-639
312-30I		M10	8.0	6.3						3404-640
312-31I		M12	9.0	7.1						3404-641
312-32I		M14	11.2	9.0						3404-642

ORDER NO.	Size	TC820 ISO 529/2283 Tap	Tap Shank		Capacity	L1 (m/m)	L2 (m/m)	ØD1 (m/m)	ØD2 (m/m)	CODE NO.
			ØD	□						
820-21I	TC 820 ISO 529/2283	M8	6.3	5.0	M8~M24	35	30.5	31	50	3404-651
820-22I		M9	7.1	5.6						3404-652
820-23I		M10	8.0	6.3						3404-653
820-24I		M12	9.0	7.1						3404-654
820-25I		M14	11.2	9.0						3404-655
820-26I		M16	12.5	10.0						3404-656
820-27I		M18	14.0	11.2						3404-657
820-29I		M20	14.0	11.2						3404-658
820-30I		M22	16.0	12.5						3404-659
820-31I		M24	18.0	14.0						3404-660

ORDER NO.	Size	TC1433 ISO 529/2283 Tap	Tap Shank		Capacity	L1 (m/m)	L2 (m/m)	ØD1 (m/m)	ØD2 (m/m)	CODE NO.
			ØD	□						
1433-01I	TC 1433 ISO 529/2283	M14	11.2	9.0	M14~M36	55.5	45	48	72	3404-671
1433-02I		M16	12.5	10.0						3404-672
1433-03I		M18	14.0	11.2						3404-673
1433-04I		M20	14.0	11.2						3404-674
1433-05I		M22	16.0	12.5						3404-675
1433-06I		M24	18.0	14.0						3404-676
1433-07I		M27	20.0	16.0						3404-677
1433-08I		M30	20.0	16.0						3404-678
1433-09I		M33	22.4	18.0						3404-679
1433-10I		M36	25.0	20.0						3404-680

TAPPING CHUCKS

