

1

2

3

4

5

6

Type 3864



- Standard accessories**
- 1 Set of hard outside solid jaws
 - 1 Set of hard inside solid jaws
 - 1 Wrench
- Spare parts see pages 80-93**
Technical data see pages 94-98

Code No.	Type	A	B	C	DH7	E	F	Q	G	J	kg
353864030100	3864-125	125	71,5	15	55,000	35	108,0	3	M8	20	6,2
353864040300	3864-160	160	68,6	18	86,000	42	140,0	3	M10	32	10,5
353864050500	3864-200	200	78,0	20	110,000	55	176,0	3	M10	29	17,5
353864060700	3864-250	250	89,0	20	145,000	76	224,0	3	M12	34	33,0
353864070900	3864-315	315	96,2	20	180,000	103	286,0	3	M16	41	56,0
353864080000	3864-400	400	123,0	22	299, 237	136	171,5	6	M16	55	99,0
353864090200	3864-500	500	144,0	30	407,160	190	235,0	6	M20	60	180,0
353864100700	3864-630	630	150,0	30	407,160	252	330,2	6	M20	70	326,0
353864110900	3864-800	800	156,0	34	635,000	320	368,3	6	M24	70	550,0
353864120000	3864-1000	1000	185,0	34	635,000	408	463,6	6	M24	88	750,0

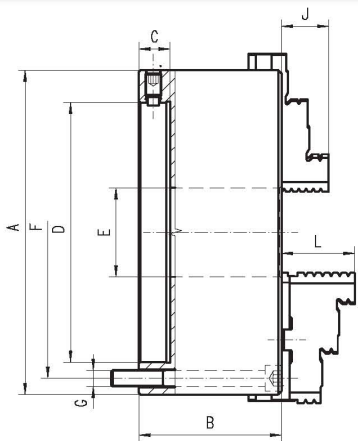

- Steel body material provides higher rigidity and wear resistance, enabling the chuck to withstand higher machining forces
- Hardened and ground working surfaces prolong life while ensuring continuous accuracy and repeatability
- Balanced scroll plate allows higher rotation speeds without excess vibration
- Repeatability: 0,015 mm
- Superior accuracy: small screws on the outside enable the chuck to be adjusted to position with nearly zero run-out (adjusting accuracy within 0,005 mm)
- The clamped workpiece is adjusted to the required concentricity by means of 4 (8 for sizes 400 mm, 500 mm, 630 mm) radially arranged adjusting screws
- This precision chuck, with increased gripping accuracy, is made for universal use, but particularly advantageous for grinding machines, indexing heads and lathes
- Mounted on the machine tool spindle from the back of the chuck by using an adapter plate

Q - Number of mounting screws

Type 3865



- Standard accessories**
- 1 Set of hard top jaws
 - 1 Set of hard master jaws
 - 1 Wrench
- Spare parts see pages 80-93**
Technical data see pages 94-98

Code No.	Type	A	B	C	DH7	E	F	Q	G	L	kg
353865030000	3865-125	125	71,5	15	55,000	35	108,0	3	M8	40,0	6,2
353865040100	3865-160	160	68,6	18	86,000	42	140,0	3	M10	43,0	10,5
353865050300	3865-200	200	78,0	20	110,000	55	176,0	3	M10	45,0	17,5
353865060500	3865-250	250	89,0	20	145,000	76	224,0	3	M12	53,0	33,0
353865070700	3865-315	315	96,2	20	180,000	103	286,0	3	M16	56,0	56,0
353865080900	3865-400	400	123,0	22	299, 237	136	171,5	6	M16	67,0	99,0
353865090000	3865-500	500	144,0	30	407,160	190	235,0	6	M20	79,0	180,0
353865100500	3865-630	630	150,0	30	407,160	252	330,2	6	M20	87,0	326,0
353865110700	3865-800	800	156,0	34	635,000	320	368,3	6	M24	87,0	550,0
353865120900	3865-1000	1000	185,0	34	635,000	408	463,6	6	M24	99,5	750,0