

| Code No.     | Type     | A   | B     | C min | D   | E min | F   | Q | G   | J    | kg   |
|--------------|----------|-----|-------|-------|-----|-------|-----|---|-----|------|------|
| 353264002300 | 3264-80  | 80  | 59,0  | 3     | 56  | 16    | 67  | 3 | M6  | 13,0 | 2,8  |
| 353264000800 | 3264-100 | 100 | 69,0  | 4     | 70  | 20    | 83  | 3 | M8  | 17,0 | 3,5  |
| 353264010000 | 3264-125 | 125 | 70,0  | 5     | 95  | 32    | 108 | 3 | M8  | 20,0 | 5,6  |
| 353264020100 | 3264-160 | 160 | 80,5  | 5     | 125 | 42    | 140 | 3 | M10 | 32,0 | 10,0 |
| 353264030300 | 3264-200 | 200 | 91,0  | 5     | 160 | 55    | 176 | 3 | M10 | 29,0 | 17,2 |
| 353264040500 | 3264-250 | 250 | 103,0 | 6     | 200 | 76    | 224 | 3 | M12 | 34,5 | 34,5 |
| 353264050700 | 3264-315 | 315 | 120,0 | 6     | 260 | 103   | 286 | 3 | M16 | 41,3 | 57,5 |

**Standard accessories**

1 Set of hard outside solid jaws



1 Set of hard inside solid jaws



1 Wrench

Spare parts see pages 80-93

Technical data see pages 94-98

**Type 3264**

- Ground working surfaces ensure sustained accuracy and repeatability
- Repeatability: 0,015 mm
- Superior accuracy: small screws on the outside enable the chuck to be adjusted to position with nearly zero run-out (adjusting accuracy within 0,005 mm)
- The clamped workpiece is adjusted to the required concentricity by means of 3 tangentially arranged adjusting screws
- Hardened adjusting screws
- This chuck is made for universal use, but is particularly advantageous for grinding machines
- Mounted on the machine tool spindle from the back of the chuck by using an adapter plate

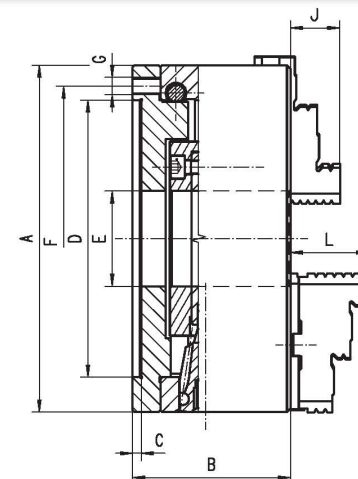

Q - Number of mounting screws

| Code No.     | Type     | A   | B     | C min | D   | E min | F   | Q | G   | L    | kg   |
|--------------|----------|-----|-------|-------|-----|-------|-----|---|-----|------|------|
| 353265010800 | 3265-125 | 125 | 70,0  | 5     | 95  | 32    | 108 | 3 | M8  | 40,0 | 6,0  |
| 353265020000 | 3265-160 | 160 | 80,5  | 5     | 125 | 42    | 140 | 3 | M10 | 43,0 | 10,5 |
| 353265030100 | 3265-200 | 200 | 91,0  | 5     | 160 | 55    | 176 | 3 | M10 | 45,0 | 18,0 |
| 353265040300 | 3265-250 | 250 | 103,0 | 6     | 200 | 76    | 224 | 3 | M12 | 52,6 | 36,0 |
| 353265050500 | 3265-315 | 315 | 120,0 | 6     | 260 | 103   | 286 | 3 | M16 | 56,9 | 59,0 |

**Standard accessories**

1 Set of hard top jaws



1 Set of hard master jaws



1 Wrench

Spare parts see pages 80-93

Technical data see pages 94-98

**Type 3265**

Type of mounting



Material of chuck body



Number of jaws



Type of jaws

1

2

3

4

5

6

3264

3265

67