

1
2
3
4
5
6

Type 8730

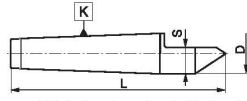

■ 60° dead centres external with chamfer

Code No.	K MT	L	D	S
800002867	0	70	9,2	5,6
800002868	1	80	12,2	7,6
800002869	2	100	18,0	11,0
800002870	3	125	24,1	15,0
800002871	4	160	31,6	20,8
800002872	5	200	44,7	29,3
800002873	6	270	63,8	42,6

Type 8731

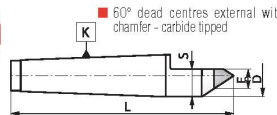

■ 60° dead centres external with chamfer - carbide tipped

Code No.	K MT	L	D	E	S
800002874	0	70	9,2	5	7,8
800002875	1	80	12,2	7	10,3
800002876	2	100	18,0	7	13,0
800002877	3	125	24,1	11	18,3
800002878	4	160	31,6	14	23,5
800002879	5	200	44,7	18	32,0
800002880	6	270	63,8	18	41,7

Type 8735

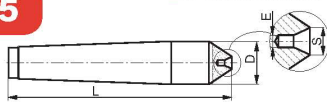

■ 60° dead centres internal

Code No.	K MT	L	D	E	S
800002881	0	66	9,2	1,0	2,12
800002882	1	74	12,2	1,6	3,35
800002883	2	94	18,0	2,5	5,30
800002884	3	115	24,1	4,0	8,50
800002885	4	146	31,6	6,3	13,20

Type 8740

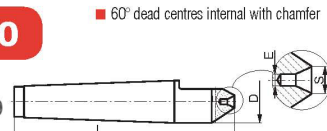

■ 60° dead centres internal with chamfer

Code No.	K MT	L	D	E	S
800002886	0	66	9,2	1,0	2,20
800002887	1	74	12,2	1,6	3,35
800002888	2	94	18,0	2,5	5,30
800002889	3	115	24,1	4,0	8,50

Type 8809



■ Live centres internal tipped

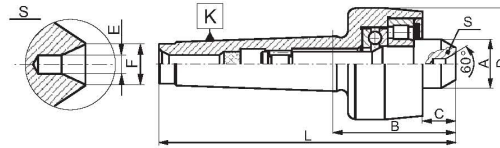

K MT	Max. workpiece weight [kg]	RPM	Max. concentr. error precision	Code No.		A	B	C	D	L	E	F	
				Max. concentr. error standard	Code No.								
1	50	5000	0,005	800002890	0,008	800002891	15	44,0	11,5	38	97,5	1,6	3,35
2	100	5000	0,003	800002892	0,008	800002893	18	51,0	16,0	40	115	2,5	5,3
3	200	4000	0,003	800002894	0,008	800002895	25	66,0	18,5	56	147	4,0	8,5
4	400	3000	0,003	800002896	0,008	800002897	32	71,0	19,5	64	173	6,3	13,2
5	1000	2500	0,005	800002898	0,010	800002899	40	94,5	31,0	85	224	6,3	13,2
6	2000	2000	0,005	800002900	0,010	800002901	62,4	131,0	44,0	130	313	10,0	21,2

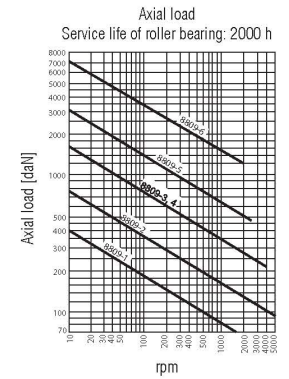
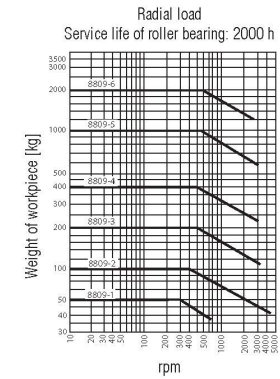

Type 8810



■ Live centres carbide tipped

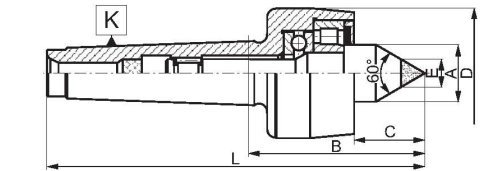

K MT	Max. workpiece weight [kg]	RPM	Max. concentr. error precision	Code No.		A	B	C	D	E	L	
				Max. concentr. error standard	Code No.							
1	60	5000	0,005	800002477	0,008	800002478	15	49,5	17,0	38	7	103,0
2	120	5000	0,003	800002479	0,008	800002480	18	56,5	21,5	40	7	120,5
3	320	4000	0,003	800002481	0,008	800002482	25	75,0	27,5	56	11	156,0
4	500	3000	0,003	800002483	0,008	800002484	32	85,0	33,5	64	14	187,0
5	1250	2500	0,005	800002485	0,010	800002486	40	108,0	44,0	85	18	237,0
6	2200	2000	0,005	800002487	0,010	800002488	62,4	151,5	64,0	130	18	333,5

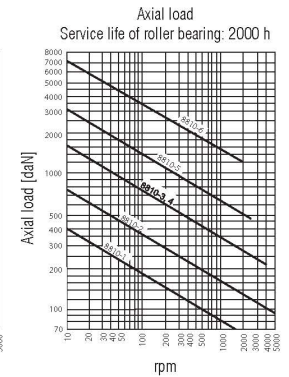
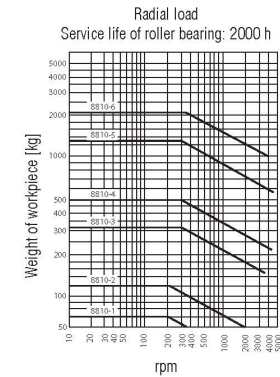

8730
8809
8731
8735
8810
8740