

Code No.	Type	A	B	C	D H7	E	F	Q	G	J	P	kg
353574010600	3574-80-P	80	44,0	3	56	16,0	67	3	M6	13	M6	1,5
353574020800	3574-100-P	100	50,0	3	70	20,0	83	3	M8	17	M8	2,8
353574030000	3574-125-P	125	59,5	4	95	35,5	108	3	M8	20	M8	5,0
353574040100	3574-160-P	160	68,0	4	125	42,0	140	6	M10	32	M10	10,0
353574050300	3574-200-P	200	78,0	4	160	55,0	176	6	M10	29	M10	17,5
353574060500	3574-250-P	250	89,0	5	200	76,0	224	6	M12	34	M12	29,0
353574070700	3574-315-P	315	97,2	5	260	103,0	286	6	M16	43	M16	50,0
353574080900	3574-400-P	400	109,0	5	330	136,0	362	6	M16	55	M16	85,0
353574151700	3574-500-P	500	119,0	5	420	190,0	458	6	M16	60	M16	85,0
353574160600	3574-630-P	630	129,0	7	545	252,0	586	6	M16	70	M16	250,0
353574180000	3574-800-P	800	140,0	7	710	281,4	760	6	M20	70	M20	515,0
353574190100	3574-1000-P	1000	171,0	7	910	408,0	950	6	M24	88	M24	730,0

Larger diameters available upon request!

**Standard accessories**

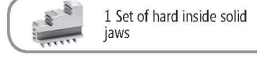
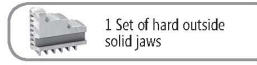

Spare parts see pages 80-93

Technical data see pages 94-98

**Type 3574-P**



- 1
- 2
- 3
- 4
- 5
- 6

- BISON PREMIUM chucks are characterized by exceptionally high accuracy values for all operations that require maximum precision - specially designed for our most demanding customers
- Steel body material provides higher rigidity and wear resistance, enabling the chuck to withstand higher machining forces
- Hardened and ground working surfaces prolong life while ensuring continuous accuracy and repeatability
- Balanced scroll plate allows higher rotation speeds without excess vibration
- Chucks with diameters 500 mm and above are equipped with additional T-slots
- Flexible mounting system: mounting from the back or front of the chuck by using an adapter plate

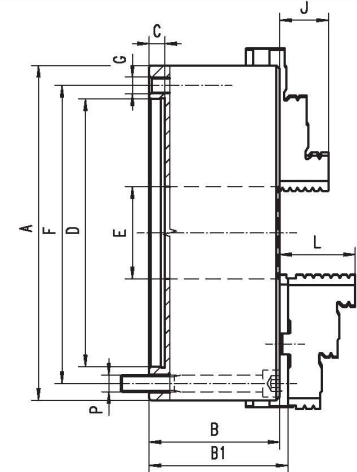

Q - Number of mounting screws

Code No.	Type	A	B	B1	C	D H7	E	F	Q	G	L	P	kg
353575030800	3575-125-P	125	59,5	64,3	4	95	35,5	108	3	M8	40,0	M8	5,0
353575040000	3575-160-P	160	68,0	72,8	4	125	42,0	140	6	M10	43,0	M10	10,0
353575050100	3575-200-P	200	78,0	82,8	4	160	55,0	176	6	M10	45,0	M10	17,5
353575060300	3575-250-P	250	89,0	92,8	5	200	76,0	224	6	M12	53,0	M12	29,0
353575070500	3575-315-P	315	97,2	101,3	5	260	103,0	286	6	M16	57,0	M16	50,0
353575080700	3575-400-P	400	109,0	116,8	5	330	136,0	362	6	M16	67,0	M16	85,0
353574150200	3575-500-P	500	119,0	129,8	5	420	190,0	458	6	M16	79,0	M16	85,0
353574160400	3575-630-P	630	129,0	140,3	7	545	252,0	586	6	M16	87,0	M16	250,0
353575180800	3575-800-P	800	140,0	151,3	7	710	281,4	760	6	M20	87,0	M20	515,0
353575190000	3575-1000-P	1000	171,0	179,8	7	910	408,0	950	6	M24	99,5	M24	730,0

Larger diameters available upon request!

**Standard accessories**

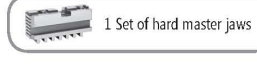
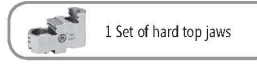

Spare parts see pages 80-93

Technical data see pages 94-98

**Type 3575-P**



- 3574-P
- 3575-P



Type of mounting



Material of chuck body



Number of jaws



Type of jaws