

Radialbelastung
Lebensdauer des Wälzlagers: 2000 Std.
 Radial load
 Service life of roller bearing: 2000 h

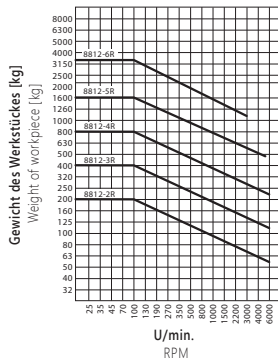

Axialbelastung
Lebensdauer des Wälzlagers: 2000 Std.
 Axial load
 Service life of roller bearing: 2000 h

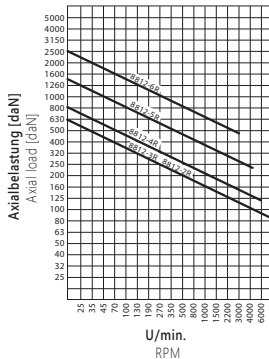

8812 R

- Mitlaufende Körnerspitze mit verjüngtem Körper
- Revolving tailstock centres with smaller body diameter

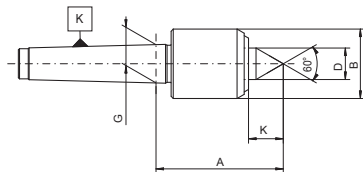

| K MK | Gewicht max. | U/min. | Rundlaufabweichung | Artikel Nr. | A | B | D | G | K |
|------|--------------|--------|----------------------|-------------|------|----|----|--------|----|
| K MT | Max. weight | RPM | Max. concentr. error | Code No. | | | | | |
| 2 | 200 | 7000 | 0,005 | 800006024 | 62 | 32 | 15 | 17,780 | 18 |
| 3 | 400 | 7000 | 0,005 | 800006705 | 62 | 34 | 15 | 23,825 | 18 |
| 4 | 800 | 6300 | 0,005 | 800006706 | 75,5 | 42 | 20 | 31,267 | 25 |
| 5 | 1600 | 4300 | 0,01 | 800006707 | 104 | 58 | 30 | 44,399 | 34 |
| 6 | 3500 | 3000 | 0,02 | 800006708 | 143 | 80 | 42 | 63,348 | 49 |