

Radialbelastung Lebensdauer des Wälzlagers: 2000 Std.

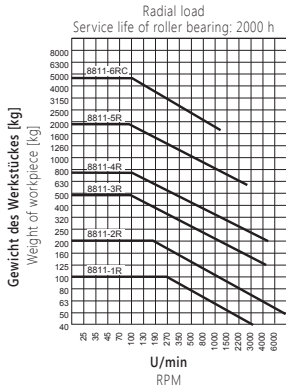

Axialbelastung Lebensdauer des Wälzlagers: 2000 Std.

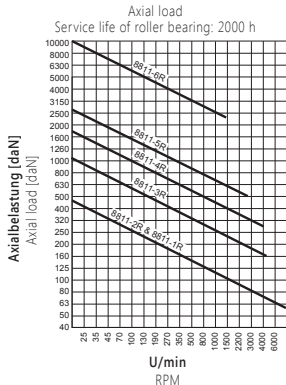

8811 R

- Mitlaufende Körnerspitze
- Revolving tailstock centres with 60° angle tip

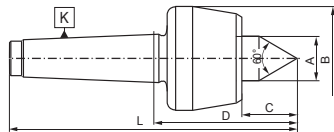

K MK	Gewicht max.	U/min.	Rundlaufabweichung		Rundlaufabweichung		A	B	C	D	L
			Max. concentr. error	Code No.	Max. concentr. error	Code No.					
			Präzision • Precision		Standard • Standard						
1	100	7000	-	-	0,005	800006761	15	36,0	17,0	60,5	114
2	200	7000	0,003	800006762	0,005	800006763	20	45,0	23,5	64,5	128,5
3RL*	400	6300	0,003	800006766	0,005	800006623	22	50,0	27,5	70,0	151
3	500	5000	0,003	800006764	0,005	800006765	25	60,0	30,5	79,0	160
4	800	3800	0,003	800006767	0,005	800006624	32	70,0	40,0	101,5	204
5	2000	3000	0,003	800006768	0,005	800006625	40	90,0	49,5	128	257,5
6	3500	2600	-	-	0,010	800006769	50	105,0	57,5	152	334
6RC**	5000	1500	-	-	0,010	800006770	62,4	140,0	67,0	194	376

* Verjüngter Körper *Slim body design ** Schwerlast **Heavy duty