

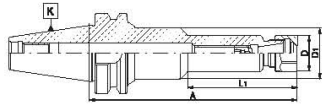

**Type 7626-S**

■ Collet chucks ER for tools with cylindrical shank



Code No.	K 7:24	T*	A	Z**	L1	D	D1	Image	Image
800002461	40	ER16	100	2-10	—	28	—	9833-16D	M12x1,5x14LH
800002462	40	ER16	150	2-10	85	28	40	9833-16D	M12x1,5x14LH
800002463	50	ER16	100	2-10	—	28	—	9833-16D	M12x1,5x14LH
800002464	50	ER16	150	2-10	85	28	40	9833-16D	M12x1,5x14LH

\* Collet \*\* Capacity



**Type 7626-S AD+B**

■ Collet chucks ER for tools with cylindrical shank

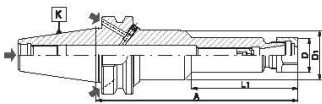

Code No.	K 7:24	T*	A	Z**	L1	D	D1	Image	Image
800002465	40	ER16	100	2-10	—	28	—	9833-16D	M12x1,5x14LH
800002466	40	ER16	160	2-10	86	28	40	9833-16D	M12x1,5x14LH
800002467	50	ER16	100	2-10	—	28	—	9833-16D	M12x1,5x14LH
800002468	50	ER16	160	2-10	86	28	40	9833-16D	M12x1,5x14LH

\* Collet \*\* Capacity



**Type 9883 A**

■ Pull studs to MAS 403-BT

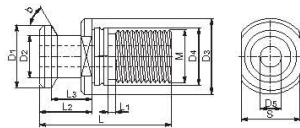

Code No.	W*	L	b	M	L1	L2	L3	D1	D2	D3	D4	D5	S
800003007	40	60	45°	M16	4	35	28	15	10	23	17	4	19
800003008	40	60	60°	M16	4	35	28	15	10	23	17	4	19
800003009	40	60	90°	M16	4	35	28	15	10	23	17	4	19
800003010	50	85	45°	M24	8	45	35	23	17	38	25	6	30
800003011	50	85	60°	M24	8	45	35	23	17	38	25	6	30
800003012	50	85	90°	M24	8	45	35	23	17	38	25	6	30

\* Size



**Type 7656**

■ Keyless drill chucks with shank

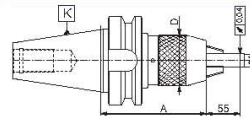

Code No.	K 7:24	d1	A	D
800002394	40	1-13	95	50
800002395	40	3-16	100	57
800002396	50	1-13	105	50
800002397	50	3-16	110	57

\* Collet \*\* Capacity



**Type 7606**

■ Collet chucks (DIN 6388-B) for tools with cylindrical shank

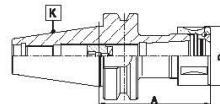

Code No.	K 7:24	T*	A	Z**	D	Image	Image
800003449	40	16	70	5-16	43	9835-16	M18x1,5x19LH
800003451	40	25	70	16-25	60	9835-25	M28x1,5x10LH
800003453	40	32	90	10-32	72	9835-32	M28x1,5x10LH
800003454	50	25	85	6-25	60	9835-25	M35x1,5x12LH
800003455	50	32	90	10-32	72	9835-32	M35x1,5x12LH

\* Collet \*\* Capacity

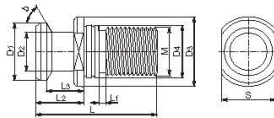

**Type 9883 B**

■ Pull studs to MAS 403-BT

Code No.	W*	L	b	M	L1	L2	L3	D1	D2	D3	D4	S
800003465	30	43	45°	M12	2	23	18	11	7	16,5	12,5	13
800003466	30	43	60°	M12	2	23	18	11	7	16,5	12,5	13
800003013	40	60	45°	M16	4	35	28	15	10	23	17	19
800003014	40	60	60°	M16	4	35	28	15	10	23	17	19
800003015	40	60	90°	M16	4	35	28	15	10	23	17	19
800003016	40	120	45°	M12	64	35	28	15	10	23	17	19
800003017	40	120	60°	M12	64	35	28	15	10	23	17	19
800003018	40	120	90°	M12	64	35	28	15	10	23	17	19
800003019	40	125	45°	M16	69	35	28	15	10	23	17	19
800003020	40	125	60°	M16	69	35	28	15	10	23	17	19
800003021	40	125	90°	M16	69	35	28	15	10	23	17	19
800003022	50	85	45°	M24	8	45	35	23	17	38	25	30
800003023	50	85	60°	M24	8	45	35	23	17	38	25	30
800003024	50	85	90°	M24	8	45	35	23	17	38	25	30
800003025	50	125	45°	M24	48	45	35	23	17	38	25	30
800003026	50	125	60°	M24	48	45	35	23	17	38	25	30
800003027	50	125	90°	M24	48	45	35	23	17	38	25	30

\* Size



**Type 7626 AD+B**

■ Collet chucks ER - set for tools with cylindrical shank

Code No.	K 7:24	T*	A	Z**	Full set pieces
<b>Type 7626</b>					
800002469	30	ER16	60	2-10	8
800002470	30	ER32	60	2-20	18
800002471	40	ER25	60	2-16	14
800002472	40	ER32	70	2-20	18
800002314	40	ER32	130	2-20	18
800002315	40	ER40	70	2-26	24
800002316	50	ER32	70	2-20	18
800002317	50	ER32	130	2-20	18
800002318	50	ER40	80	2-26	24
800002319	50	ER40	130	2-26	24
<b>Type 7626-PL</b>					
800002324	30	ER32	60	3-20	8
Collets Ø 4,5,6,8,10,12,16,20					
800002325	40	ER32	70	3-20	8
Collets Ø 4,5,6,8,10,12,16,20					
800002326	50	ER32	70	3-20	8
Collets Ø 4,5,6,8,10,12,16,20					
<b>Type 7626-S</b>					
800002320	40	ER16	100	2-10	8
800002321	40	ER16	150	2-10	8
800002322	50	ER16	100	2-10	8
800002323	50	ER16	150	2-10	8

\* Collet \*\* Capacity



**Type 7629**

■ End mill adapters type Whistle-Notch for tools with cylindrical shank and inclined flat DIN 1835-E

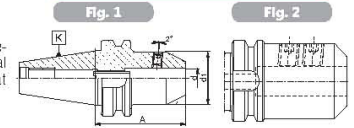

Code No.	K 7:24	d	d1	A	Fig.	Image	Image
800002369	40	6	25	50	1	U-4131/0	U-1599/0
800002370	40	8	28	50	1	U-4132/0	U-6317/0
800002371	40	10	35	63	1	U-4133/0	U-0293/0
800002372	40	12	42	63	1	U-4134/0	U-0757/0
800002373	40	14	44	63	1	U-4135/0	U-6318/0
800002374	40	16	48	63	1	U-4135/0	U-6318/0
800002375	40	18	50	63	1	U-4136/0	U-6793/0
800002376	40	20	52	63	1	U-4136/0	U-6793/0
800002377	40	25	65	90	2	U-4137/0	U-6794/0
800002378	40	32	72	100	2	U-4138/0	U-6794/0
800002379	50	6	25	63	1	U-4131/0	U-1599/0
800002380	50	8	28	63	1	U-4132/0	U-6317/0
800002381	50	10	35	63	1	U-4133/0	U-0293/0
800002382	50	12	42	63	1	U-4134/0	U-0757/0
800002383	50	14	44	80	1	U-4135/0	U-6318/0
800002384	50	16	48	80	1	U-4135/0	U-6318/0
800002385	50	18	50	80	1	U-4136/0	U-6793/0
800002386	50	20	52	80	1	U-4136/0	U-6793/0
800002387	50	25	65	100	2	U-4137/0	U-6794/0
800002388	50	32	72	105	2	U-4138/0	U-6794/0
800002389	50	40	90	120	2	U-5870/0	U-6794/0

1  
2  
3  
4  
5  
6  
7626 AD+B  
7656  
7626-S  
7626-S AD+B  
7606  
9883 A  
9883 B  
7629