

## Type 3514, 3515

### 3 JAWS, STEEL BODY (DIN 55026)

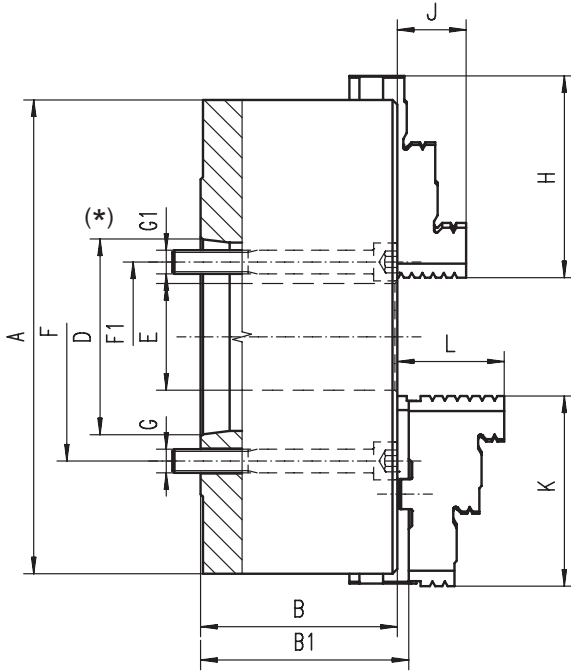

(\*) Screws inside taper type A1



- Balanced scroll plate allows higher rotation speeds without excess vibration
- Mounted directly to "A" type machine-tool spindles

#### Application:

- This chuck is designed for all types of workshop machining operations on conventional lathes and grinders

#### Options:

- Hard solid jaws (type 3514) or hard two-piece jaws (type 3515)
- Chuck design: our engineers can work with you to implement any product design changes you may require

#### Features:

- 3 jaw, self-centering scroll chuck with manual gripping
- Steel body extends machine life while providing higher rigidity and greater wear resistance, enabling the chuck to withstand higher machining forces
- Hardened and ground working surfaces ensure longer life with maintained accuracy and repeatability

Chuck size A	160	200				250			315		400		
Short taper 1:4	*5	4	*5	*6	5	*6	*8	6	*8	6	8	*11	
B	68	78				89			96,2		108		
B1	72,8	82,8				92,8			101,3		116,8		
D	min.	82,563	63,513	82,563	106,375	82,563	106,375	139,719	106,375	139,719	106,375	139,719	196,869
	max.	82,578	63,526	82,578	106,390	82,578	106,390	139,734	106,390	139,734	106,390	139,734	196,887
E	42	42	42	55	76	55	76	103	80	103	136	130	
F1	61,9	-	61,9	82,6	-	82,6	111,1	-	111,1	-	-	165,1	
G1	M10	-	M10	M12	-	M12	M16	-	M16	-	-	M 20	
F	-	82,6	-	-	104,8	-	-	133,4	-	133,4	171,4	-	
Qty. of mounting screws	3	3				3	6		6		6		
G	-	M10	-	-	M10	-	-	M12	-	M12	M16	-	
H	70	85	85	85	105	105	105	125	125	145	145	145	
J	32	29	29	29	34	34	34	43	43	55	55	55	
K	67	80	80	80	95	95	95	110	110	127	127	127	
L	43	45	45	45	53	53	53	57	57	67	67	67	
Approx. weight [kg]	10,0	19,0				32,0			55,0		92,0		

Type	Standard accessories	1 set of outside hard solid jaws	1 set of inside hard solid jaws	1 wrench	Optional accessories	1 set of soft solid jaws
Type 3514						
Type 3515						